



Service Kit 753-06469

Date: June 11, 2010 (Revised 6/14/2010)

Subject: Replacement Rubber Paddles and Hardware.

Models: 2010 Model Year and Later - 21"
Affected: Single Stage High Performance Models

Read and understand these instructions thoroughly before proceeding.

PURPOSE: Use this service kit when it becomes necessary to replace the 2 rubber paddles on the 684-04364 auger.

NOTE: These materials are prepared for use by trained technicians who are experienced in the service and repair of equipment of the kind described in this publication, and are not intended for use by untrained or inexperienced individuals. Such individuals should seek the assistance of an authorized service technician or dealer.

NOTE: Save this Instruction Sheet. Refer to it when ordering replacement parts.

Service Kit Contents

(See Figure 1)

ITEM NO.	PART NUMBER	QTY	DESCRIPTION
1	*	2	PADDLE:AUGER:RUBBER
2	710-05058	12	SCREW:AB:1/4"-14 X .75" HXINDWSH
	*	1	THIS INSTRUCTION SHEET

* - Not Available Separately

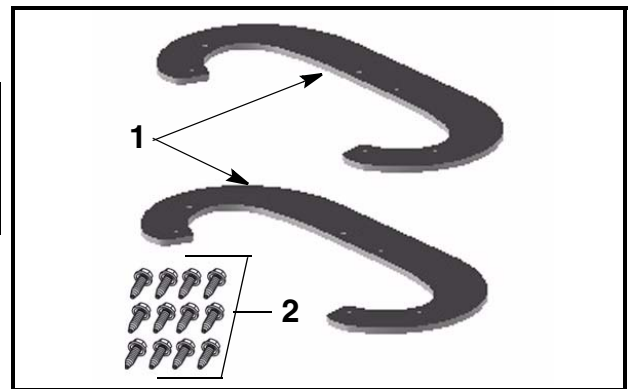

FIGURE 1

Pre-Service Preparation:

1. Place the snow thrower on a flat and level surface.
2. Turn off the engine and remove the ignition key.
3. Allow the engine and muffler to cool before proceeding.
4. Remove the spark plug wire from the spark plug and ground the wire to the engine block.
5. If the unit is equipped with an electric starter, make sure the electric cord is disconnected from the starter box on the snow thrower.
6. Drain the fuel tank.
7. Tip the handlebar down until it is resting on the ground and the auger is in an upward position. Secure the unit in this position. See Figure 2.

NOTE: Support the snow thrower in the tipped position with jack stand(s) set under the shave plate. See Figure 2 inset.

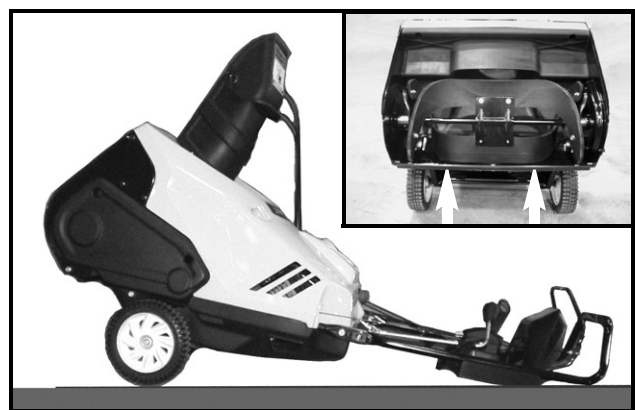

FIGURE 2

(Continued on Page 2)

Auger Paddles Removal and Installation:

7. Note how the existing paddles are mounted to the auger frame. Refer to Figure 3.

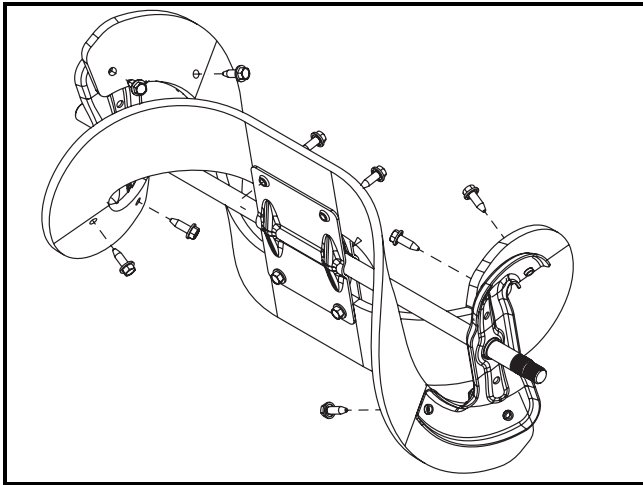

FIGURE 3

8. Using a 3/8" socket and ratchet remove and discard the six (6) screws securing one of the paddles to the auger frame. Discard the old rubber paddle.

NOTE: *If the paddle is too tightly trapped by the center bracket, loosen the two screws securing the other paddle to allow the free half center bracket to move.*

9. Install a new Rubber Paddle (Item 1) onto the auger frame where the previous paddle was removed.

10. Using six (6) new self-tapping 1/4"-14 AB Screws (Item 2), hand start all six screws aligning holes in the rubber paddle with the holes in auger frame.

11. Tighten the screws securely so that the washer head of the screw slightly compresses the rubber. Do not over tighten so as to cut into the rubber paddle.

12. Repeat steps 8 through 11 for the other paddle.

13. Recheck all paddle mounting hardware to ensure they are tight.

14. Set the unit onto its' normal operating position.

15. Replace the spark plug wire onto the spark plug.

16. Refuel the unit.

17. Start the snow thrower and engage the auger to ensure the auger functions properly.

This completes the installation of this service kit.