



Service Kit 753-05977

Date: 8/04/2008

Subject: Service Replacement for the
684-0024 Idler Axle Assembly

Models Affected: N/A

Read through and understand these instructions completely before proceeding with repair.

PURPOSE: This kit provides the service parts needed when necessary to replace the track drive snow thrower 684-0024 Idler Axle Assembly which is no-longer-available. A new frame cover is supplied due to the clearance offset in the new idler axle.

NOTE: These materials are prepared for use by trained technicians who are experienced in the service and repair of equipment of the kind described in this publication, and are not intended for use by untrained or inexperienced individuals. Such individuals should seek the assistance of an authorized service technician or dealer.

NOTE: Save this Instruction Sheet. Refer to it when ordering replacement parts.

Service Kit Contents

(See Figure 1)

ITEM NO.	PART NUMBER	QTY	DESCRIPTION
1	684-04240	1	AXLE ASSEMBLY: IDLER: 700 SNOW
2	784-5648A-0637	1	COVER: FRAME: TRACK
3	712-0346	3	NUT: JAM LOCK: 1/2"-20: GR5: NYLON
4	712-04063	4	NUT: FLGLK: 5/16"-18: GRF: NYLON
5	*	1	THIS INSTRUCTION SHEET

* - Not Available Separately

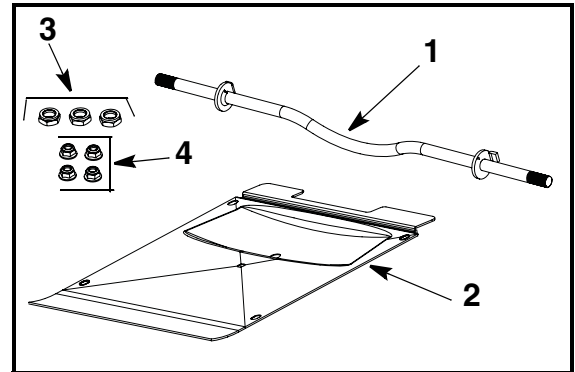

FIGURE 1

Pre-Service Preparation:

- Place the snow thrower on a flat and level surface, turn off engine and allow muffler and engine to cool before proceeding.
- Remove spark plug wire from the spark plug and ground to the engine block.
- Drain the fuel tank (Preferred).
Optional - Remove the fuel cap. Place a piece of thin plastic sheet over the fuel tank opening and replace the cap tightly. Ensure that the oil dipstick is tight.
- Stand the snow thrower up onto the front of the auger housing. Place the transport handle in NORMAL.

Disassembly Instructions:

NOTE: Right (RH) and left (LH) sides are determined from the operator's position behind the handle bars facing the engine.

- Using a 3/8" socket and ratchet, remove the four self-tapping screws securing the bottom cover on the frame. Discard the cover, retain the screws.
- Using a 1/2" deep socket and ratchet, remove the hex flange lock nuts on both of the idler axle tensioning eye bolts. Remove both eyebolts. Discard both flange lock nuts. See Figure 2.

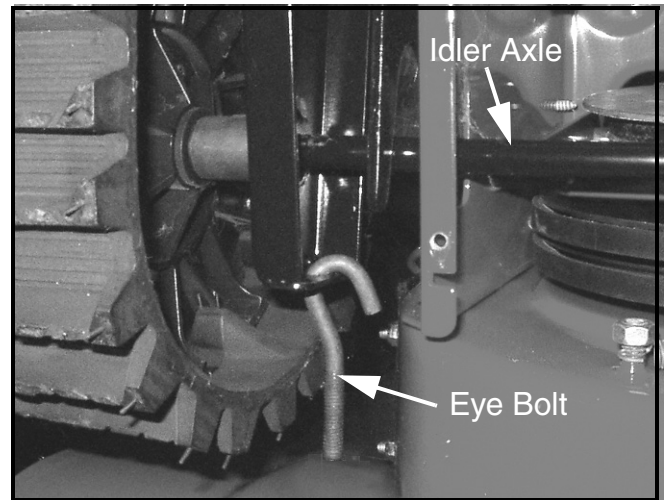

FIGURE 2

- Using a 3/4" socket and ratchet, remove the 1/2"-20 jam lock nuts and flat washers securing the forward track idler wheels to the idler axle. Discard the jam lock nuts only.
- Lifting the track up and away from the frame, remove both track idler wheels from the idler axle and tracks. See Figure 3. Do not remove the tracks at this time.

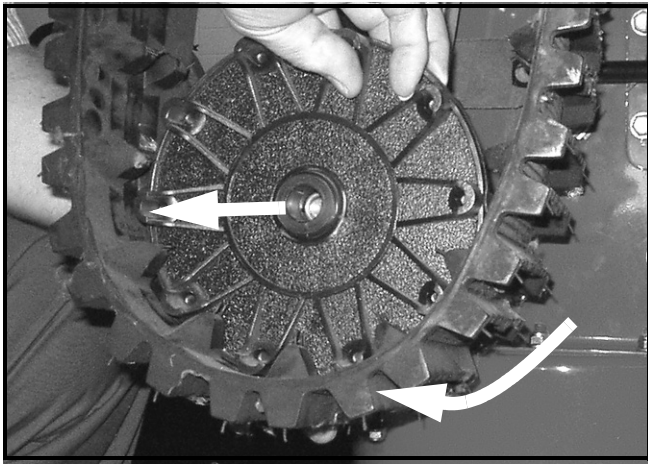

FIGURE 3

9. Remove both idler track wheel spacers from each side of the idler axle. See Figure 4.

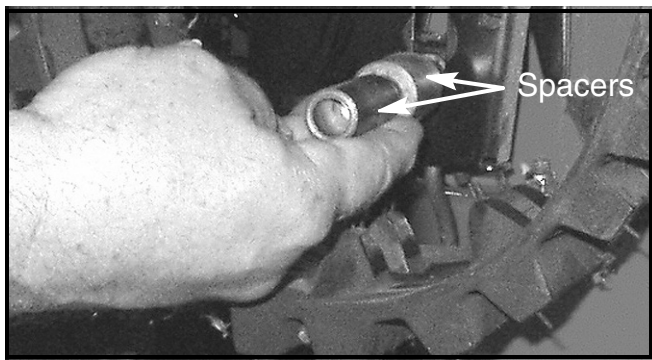

FIGURE 4

10. While holding the LH track and drive wheel and using a 3/4" socket and ratchet, remove the 1/2"-20 jam lock nut and flat washer securing the RH track drive wheel. Discard the jam lock nut only.

11. Remove the RH track drive wheel and track.

12. Using a 5/8" socket and ratchet and a 1/2" box wrench, remove the two shoulder bolts, flat washers and flange lock nuts securing the RH track side plate to the track hub assembly. Remove the RH track side plate. Discard the flange lock nuts only. See Figure 5.

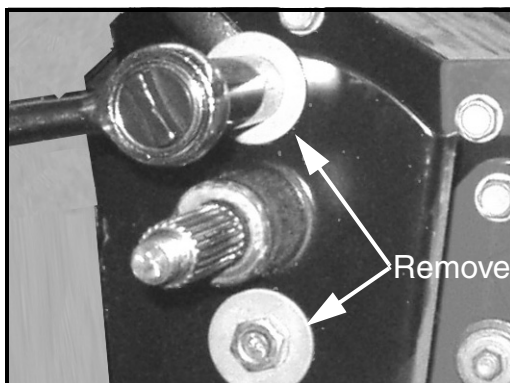

FIGURE 5

13. Remove the idler axle from the unit by sliding the idler axle out through the RH track side plate. Move the

LH track side plate as required to provide clearance as the idler axle is removed. See Figure 6.

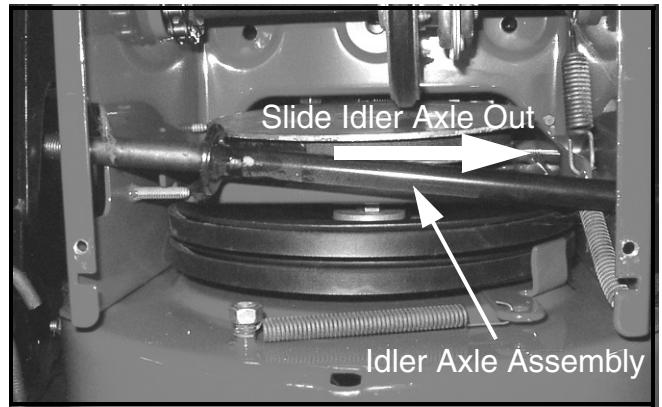

FIGURE 6

Installation Instructions:

14. Install the new Idler Axle Assembly, Item 1, in the reverse of the removal procedure in Step 13. Ensure that the curved section is towards the frame bottom and the locking tabs are in the track side plate slots.

15. Reassemble both eyebolts, RH track drive side plate, RH track drive wheel, both idler wheels, and tracks in the reverse order of disassembly. **Use the new lock nuts supplied.**

NOTE: Apply grease to the splined area of the track drive axle before assembling the splined drive wheel.

16. When replacing the RH track, ensure that the track's cleats are oriented as shown in Figure 7.

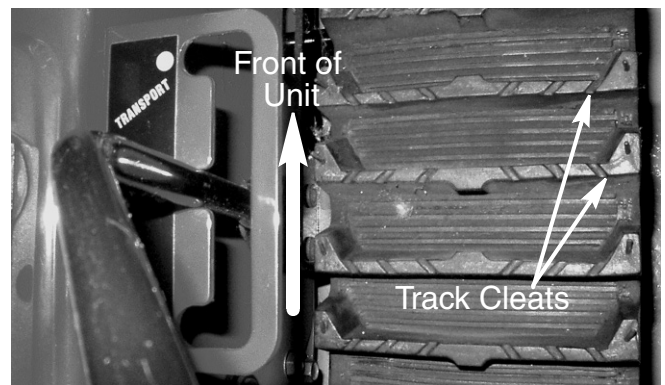

FIGURE 7

17. Tighten all hardware securely except the eye bolts.

18. Install the new frame cover ensuring that the embossment is under the new idler axle's offset midsection.

19. **Refer to the Operator's Manual for proper track tension adjustment with the eye bolts.**

20. Return the snow thrower to its' normal position, remove the plastic sheet from under the fuel cap or refill the fuel tank and replace the spark plug wire onto the spark plug.

This completes this service kit.