



# Service Advisory

## ZT SERIES

W-142

Models Affected: ZT 22 (17AA5A7P790)  
ZT 50 (17BA5A7P790)

Serial Number Range Affected: 2004 and 2005 Production.

Date: **August 23, 2006**

Subject: **50" DECK SHELL HOUSING REPLACEMENT FOR 603-04153 or 603-04284**

PURPOSE: To notify dealers of the discontinued deck shell housings **603-04153** & **603-04284** and the additional parts required when installing the replacement deck shell housings **603-04328**.

# IMPORTANT

## ATTENTION PARTS MANAGER

## ATTENTION SERVICE MANAGER

When replacing the 50" deck shell housing (**603-04153-0650**) on a ZT 22 (2004 Production) or 50" deck shell housing (**603-04284-0650**) on a ZT 50 (2005 Production), the parts listed below will also need to be ordered to install the substitute 50" deck shell housing (**603-04328-0650**).

### ADDITIONAL PARTS NEEDED WHEN REPLACING DECK SHELL 603-04153-0650

ITEM NO.	PART NUMBER	QTY	DESCRIPTION
1	703-05825-0650	1	Idler Arm
2	756-04129	3	Idler Pulley
3	710-3005	1	Bolt 3/8-16 x 1.25"
4	738-04162A	1	Shoulder Spacer
5	736-0407	1	Bell Washer
6	712-04065	1	Flange Lock Nut
7	703-3511-0637	1	Finger Guard
8	710-3168	1	Carriage Bolt 3/8-16x1.0"
9	710-3178	2	Carriage Bolt 3/8-16x.75"
10	712-04065	3	3/8-16 Nylon Flange Nut

### ADDITIONAL PARTS NEEDED WHEN REPLACING DECK SHELL 603-04284-0650

ITEM NO.	PART NUMBER	QTY	DESCRIPTION
1	703-05825-0650	1	Idler Arm
2	756-04129	3	Idler Pulley
3	710-3005	1	Bolt 3/8-16 x 1.25"
4	738-04162A	1	Shoulder Spacer
5	736-0407	1	Bell Washer
6	712-04065	1	Flange Lock Nut

This Advisory is being released for informational purposes only.

SERVICE MANAGER	PARTS MANAGER	SALES MANAGER	SERVICE TECH.	SERVICE TECH.

Circulate and Initial

All parts from old deck can be transferred to the new deck shell housing except for the parts shown in Figure 1 and additional parts not shown when replacing a 603-04153-0650 Deck Shell. Refer to chart and note below.

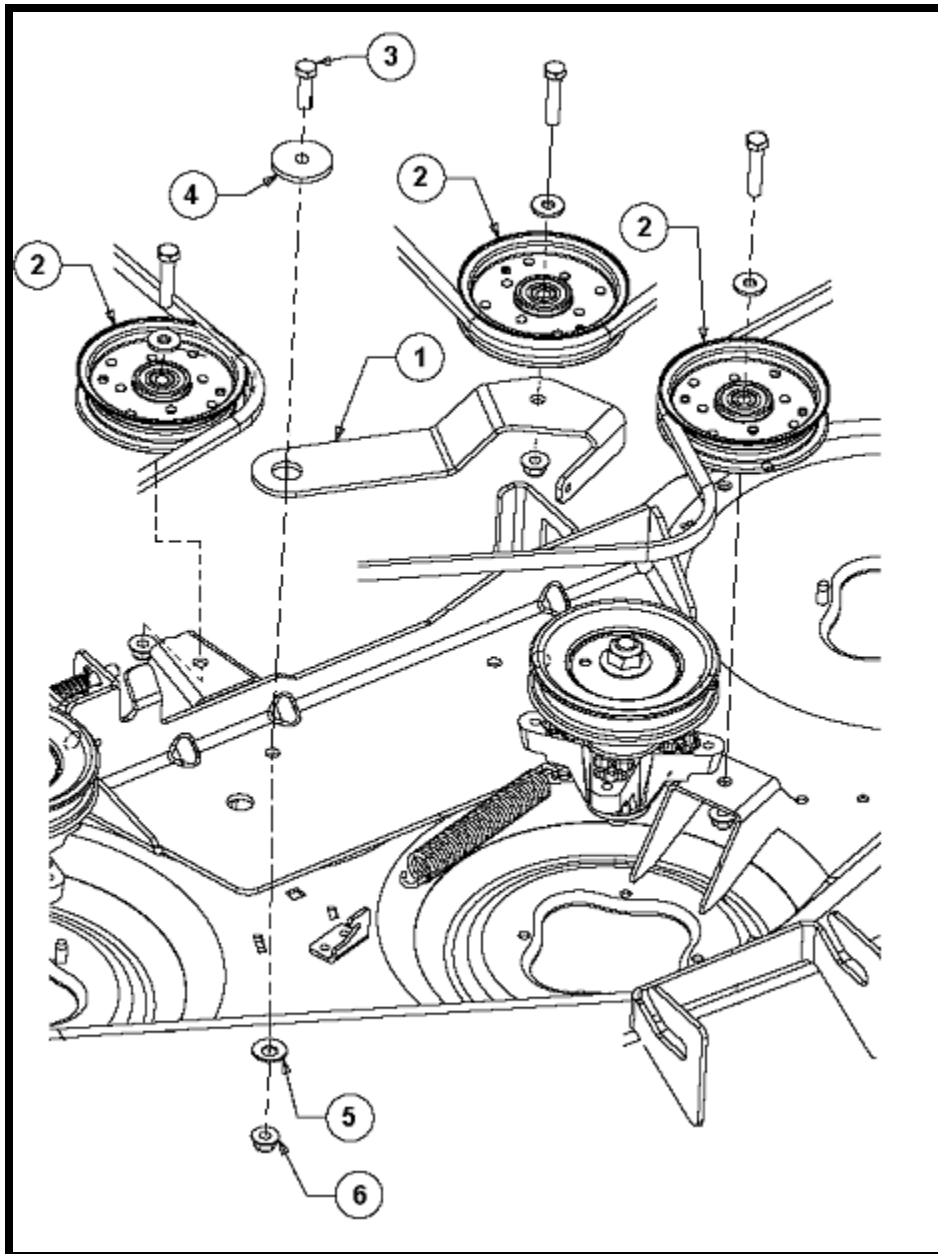

FIGURE 1

ITEM NO.	PART NUMBER	QTY	DESCRIPTION
1	703-05825-0650	1	Idler Arm
2	756-04129	3	Idler Pulley
3	710-3005	1	Bolt 3/8-16 x 1.25"
4	738-04162A	1	Shoulder Spacer
5	736-0407	1	Bell Washer
6	712-04065	1	Flange Lock Nut

**NOTE:** Finger Guard and mounting hardware not shown for 603-04153-0650 Deck Shell.