



Service Kit

753-04862

Date: 9/9/2004

Subject: 2-Way Chute Control Lever Knob Replacement

Models Affected: 2004-2005 and later 2 Stage Snow Thrower models with 2-Way Discharge Chute Control

PURPOSE: Use this service kit when repairing the 2-way Chute Control Lever Knob.

NOTE: These materials are prepared for use by trained technicians who are experienced in the service and repair of equipment of the kind described in this publication, and are not intended for use by untrained or inexperienced individuals. Such individuals should seek the assistance of an authorized service technician or dealer.

NOTE: Save this Instruction Sheet. Refer to it when ordering replacement parts.

Service Kit Contents (See Figure 1)

ITEM NO.	PART NUMBER	QTY	DESCRIPTION
1	710-04352	2	SCREW: #6 X .375": PLASTITE
2	710-04353	1	SCREW: #8 X 1.0": PLASTITE
3*	----	1	RH KNOB: CONTROL JOYSTICK
4*	----	1	LH KNOB: CONTROL JOYSTICK
5*	769-01366	1	THIS INSTRUCTION SHEET

* - Items so designated are not available separately.

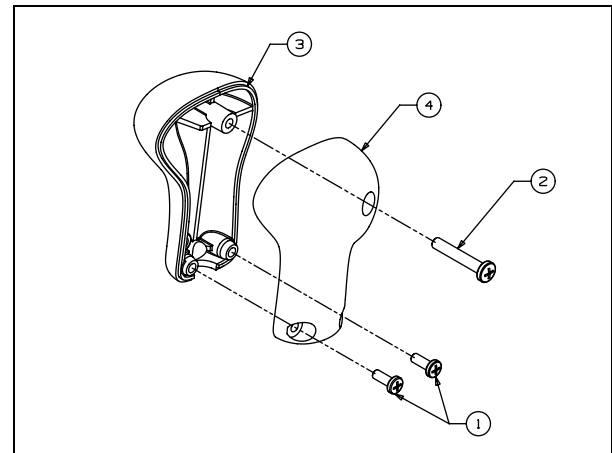

FIGURE 1

Replacement Instructions:

1. Remove the three (3) screws from the left side of the the knob assembly using a #2 Phillips head screw driver.
2. Remove both halves of the knob from the control lever.
3. Position the new knob halves, Items 3 and 4, onto the control lever. Ensure that the locating bosses on the knob halves are properly seated in the control lever holes.
4. Install the three (3) new screws, Items 1 and 2, from the left side of the knob assembly and tighten. Do not over tighten as this can result in damage to the knob.