



# Service Advisory

## ZT SERIES

W-133

Models Affected: ZT 17 (17AA5A4G790), ZT 42 (17BA5A4G790)  
ZT 22 (17AA5A7P790), ZT 50 (17BA5A7P790)

Serial Number Range Affected: B165 and Prior (2 Kits Per Unit).  
B175 and After (4 Kits Per Unit).

Date: April 13, 2005

Subject: Deck Cable Hardware Kit (759-04085)

A running change has been made to the deck lift hardware. These parts are available in the Deck Cable Hardware Kit (759-04085).

When replacing 738-04100 shoulder screw on units with serial numbers B165 and Prior, order quantity of (2) 759-04085 Deck Cable Hardware Kits. You will need to enlarge the 1/4" hole on the left and right deck lift arm 703-05401 to 3/8".

When replacing 710-0805 cap screw on units with serial numbers B175 and After, order quantity of (4) 759-04085 Deck Cable hardware Kits. You will need to enlarge the 5/16" hole on the left and right deck lift arm 703-05793 to 3/8". Also remove the 3/8" hex cap screw, hex jam nut and hex flange insert lock nut that secures the cables to the deck lift shaft assembly and replace with the 759-04085 deck cable hardware kit. The complete instructions for both serial number ranges can be found on the service kit instructions.

Service replacement part **Deck lift shaft assembly with weld pins** is no longer available. If one is required, order 603-04160 shaft assembly and quantity (4) 759-04085 deck cable hardware kits. You will need to enlarge the hole on the left and right deck lift arm 703-05401 to 3/8".

\*\* Example of a serial number (1A023H00001) and how to read it.

1 = ENGINEERING LEVEL INDICATOR

A = MONTH OF PRODUCTION; A = January, B = February... H = August... K = November, L = December

02 = DAY OF THE MONTH; 01 = 1<sup>ST</sup> day of the month, 08 = 8<sup>TH</sup> day of the month, etc.

3 = YEAR OF PRODUCTION; 2 = 2002; 3 = 2003

H = PLANT CODE.

0 = ASSEMBLY LINE NUMBER.

0001 = DAILY SEQUENCE NUMBER; 0001 = 1st unit produced that day.

This Advisory is being released for Informational purposes only.

SERVICE MANAGER	PARTS MANAGER	SALES MANAGER	SERVICE TECH.	SERVICE TECH.

Circulate and Initial



# Service Kit

## 759-04085

Date: April 13, 2005

Subject: Deck Cable Hardware Kit

Models Affected: RZT 17 (17AA5A4G710)  
RZT 42 (17BA5A4G709,710)  
RZT 22 (17AA5A7P710)  
RZT 50 (17BA5A7P709,710,712)  
ZT 17 (17AA5A4G790)  
ZT 42 (17BA5A4G790)  
ZT 22 (17AA5A7P790)  
ZT 50 (17BA5A7P790)

Serial Number Ranges: B165 and Prior, (2 Kits Per Unit). B175 and After, (4 Kits Per Unit).

PURPOSE: To replace hardware for the deck lift cable on the RZT units.

**NOTE:** These materials are prepared for use by trained technicians who are experienced in the service and repair of equipment of the kind described in this publication, and are not intended for use by untrained or inexperienced individuals. Such individuals should seek the assistance of an authorized service technician or dealer.

**NOTE:** Save this Instruction Sheet. Refer to it when ordering replacement parts.

### Service Kit Contents

ITEM NO.	PART NUMBER	QTY	DESCRIPTION
1	736-0300	1	Flat Washer .406 x .875 x .059
2	714-0474	1	Cotter Pin: .125 OD x .75
3	711-0173	1	Clevis Pin: .375 Dia. x .969

Remove the 703-05401 left and right deck lift arms by removing the shoulder bolts 738-0143 and hex flange lock nuts 712-0431 from the unit to enlarge the 1/4" hole.

Using a 3/8" drill bit, enlarge the existing 1/4" holes in the deck lift arms 703-05401 as shown in (FIGURE 2.)

### Installation Instructions For B165 and Prior:

Disconnect the negative battery cable terminal from the battery. Next disconnect the positive battery cable terminal from the battery.

Remove the deck from under the unit. Refer to Operators Manual for proper procedure.

Remove the shoulder bolts 738-04100 and the hex flange lock nuts 712-0380 and discard from both left and right deck lift arms 703-05401. (FIGURE 1.)

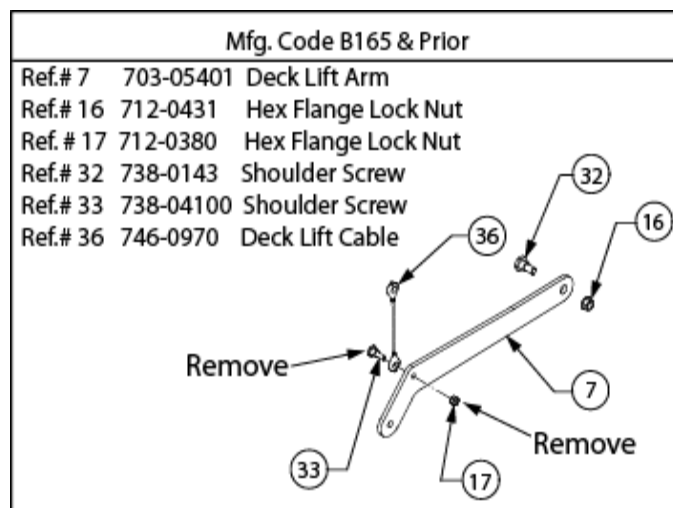

FIGURE 1

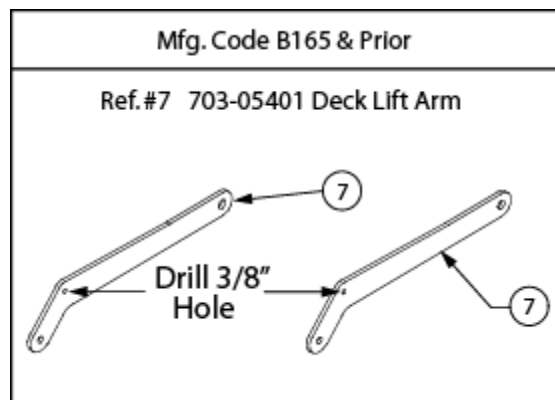

FIGURE 2

Reinstall the deck lift arms 703-05401 back on the unit using the existing shoulder bolts 738-0143 and hex flange lock nuts 712-0431 previously removed.

Reattach the cables using the clevis pin, washer and cotter pin provided in each of the Deck Cable Hardware Kits 759-04085. Use the clevis pins in place of the discarded 738-04100 shoulder bolts, and the washers and cotter pins to retain the cables to the deck lift arms.

Reinstall the deck under the unit. Refer to Operators Manual for proper set up instructions.

Reconnect the positive battery cable terminal to the battery positive post. Reconnect the negative battery terminal to the negative battery post.

If replacing cable also order Deck Cable Hardware Kit (759-04085). Quantity 2 per unit required.

#### Installation Instructions For B175 and After:

Disconnect the negative battery cable terminal from the battery. Next disconnect the positive battery cable terminal from the battery.

Remove the deck from under the unit. Refer to Operators Manual for proper procedure.

Remove the hex cap screws 710-0805, the hex jam nuts 712-3007 and the hex flange insert lock nuts 712-04063 and discard from both left and right deck lift arms 703-05401. (FIGURE 3.) Discard all removed hardware.

Remove the hex cap screws 710-0520, the hex jam nuts 712-3008 and the hex flange insert lock nuts 712-04065 from the deck lift shaft assembly 603-04160. Retain the left and right cables 746-0970 and discard all other removed hardware. (FIGURE 3).

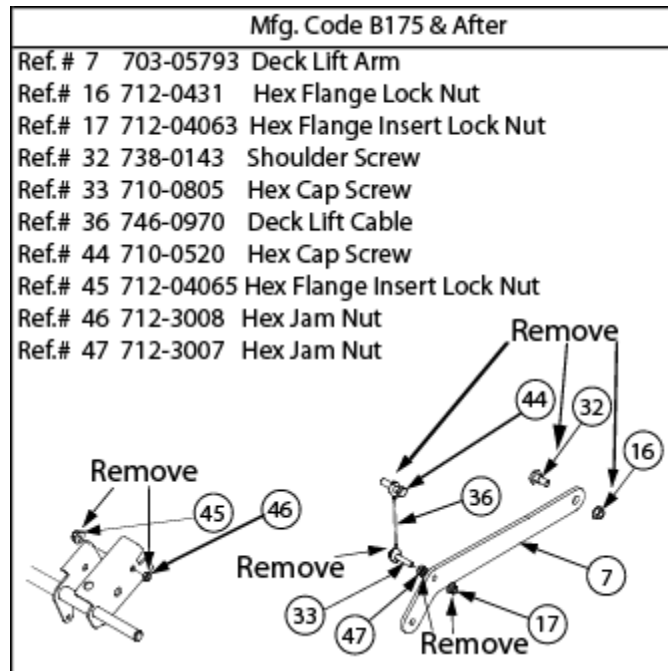

**FIGURE 3**

Remove the 703-05401 left and right deck lift arms by removing the shoulder bolts 738-0143 and hex flange lock nuts 712-0431 from the unit to enlarge the 5/16" hole.

Using a 3/8" drill bit, enlarge the existing 5/16" holes in the deck lift arms 703-05401 as shown in (FIGURE 4.)

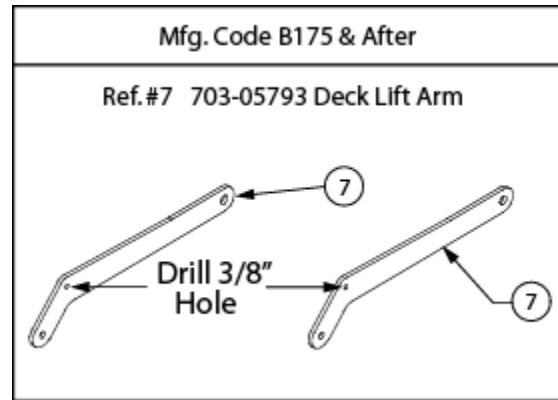

**FIGURE 4**

Reinstall the deck lift arms 703-05401 back on the unit using the existing shoulder bolts 738-0143 and hex flange lock nuts 712-0431 previously removed.

Reinstall the cables using the clevis pin, washer and cotter pin provided in each of the Deck Cable Hardware Kits 759-04085 (Qty. 4 needed). Use the clevis pins in place of the discarded 738-0805 hex cap screws and the 710-0520 hex cap screws. Use the washers and cotter pins to retain the cables to the deck lift arms and the deck lift shaft assembly.

Reinstall the deck under the unit. Refer to Operators Manual for proper set up instructions.

Reconnect the positive battery cable terminal to the battery positive post. Reconnect the negative battery terminal to the negative battery post.

If replacing cable also order Deck Cable Hardware Kit (759-04085). Quantity 4 per unit required.