



Service Advisory W-112

Model: Z16, Z180, Z200, Z180L

Date: JULY 31, 1998

Subject: SPEED CONTROL KIT

A product improvement has been made to the speed control on the Z series. Parts ordering and warranty information can be found at the end of this two page advisory. Installation instructions follow. Position the unit on level surface, block all wheels, and make sure the parking brake is not engaged.

1. Remove bellows from bellow retaining bracket. See Figure 1.
2. Remove handles from the control bellcranks by removing nut and carriage bolt fastening.
3. Remove the four 1/4-20 x .75 hex washer screws holding the bellow retaining bracket down.
4. Lift the plastic console off of the control tower.
5. Clamp the template (703-3115) to the plastic console. Be sure to position the template on the console by using the tabs centrally located. Push the template down to insure proper position. See Figure 2.
6. With a drill and a 1/4" drill bit, route out the two bottom holes on the template. See Figure 2.
7. Once the two bottom holes are routed out, use the 7/16-14 screws and nuts, and snug the template to the plastic console. (Hand Tighten)
8. Route out the two slots on the plastic console as shown. See Figure 2.
9. Remove the 7/16-14 screw, nuts and clamps from the console.
10. Insert the control tube mounting bracket in the plastic console aligning with the holes.
11. Mount the speed control bar using the appropriate hardware onto the plastic console. See Figure 3.
12. Place the plastic console onto the unit over the control tower.
13. Mount the bellow retaining bracket to the console and replace bellows.
14. Mount the new handles to the bellcranks using the 5/16-18 carriage bolts and nuts.
15. Place bottom of bellows around the bellow retaining bracket.
16. Adjust speed control bar to desired location.

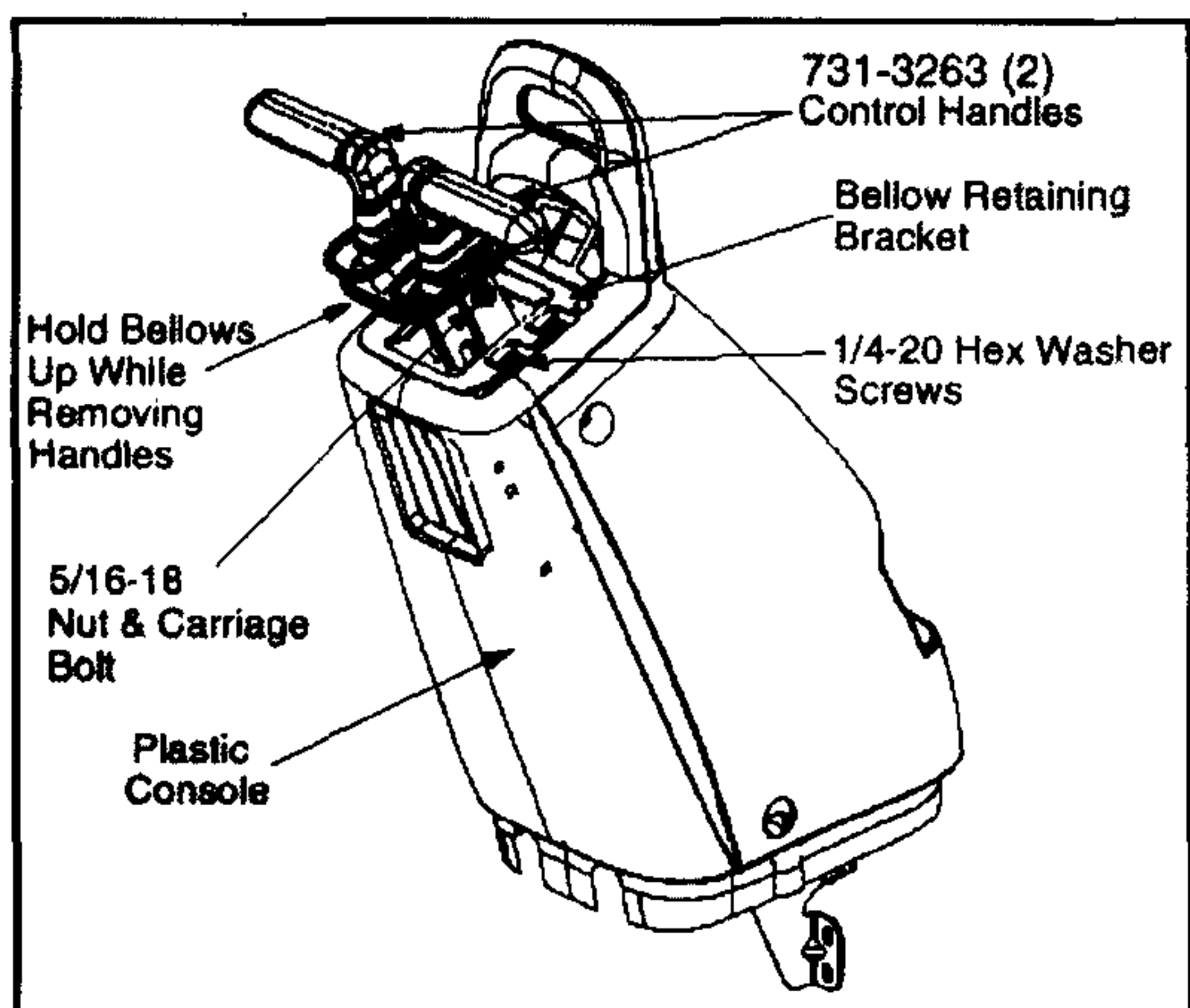

Figure 1

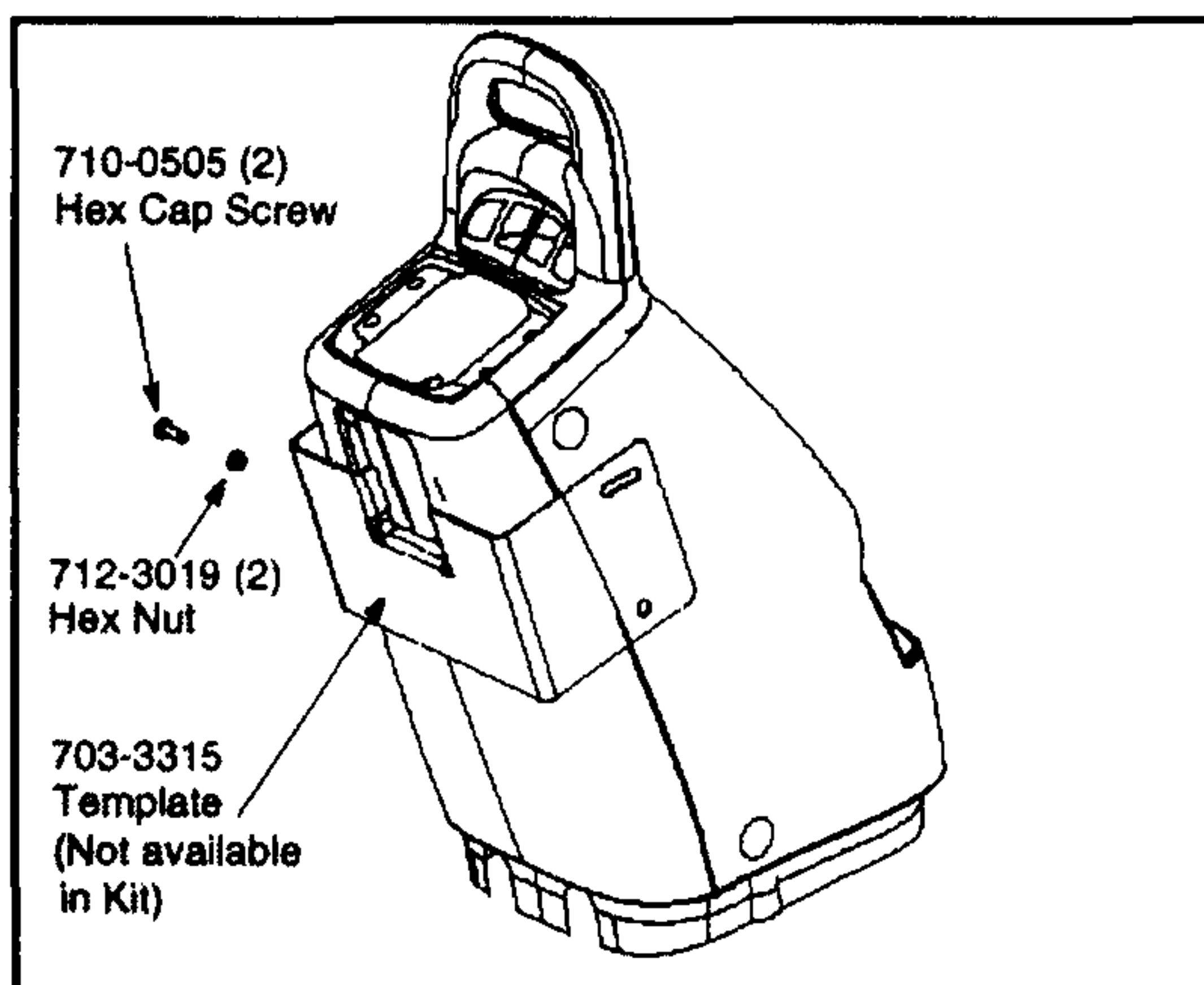

Figure 2

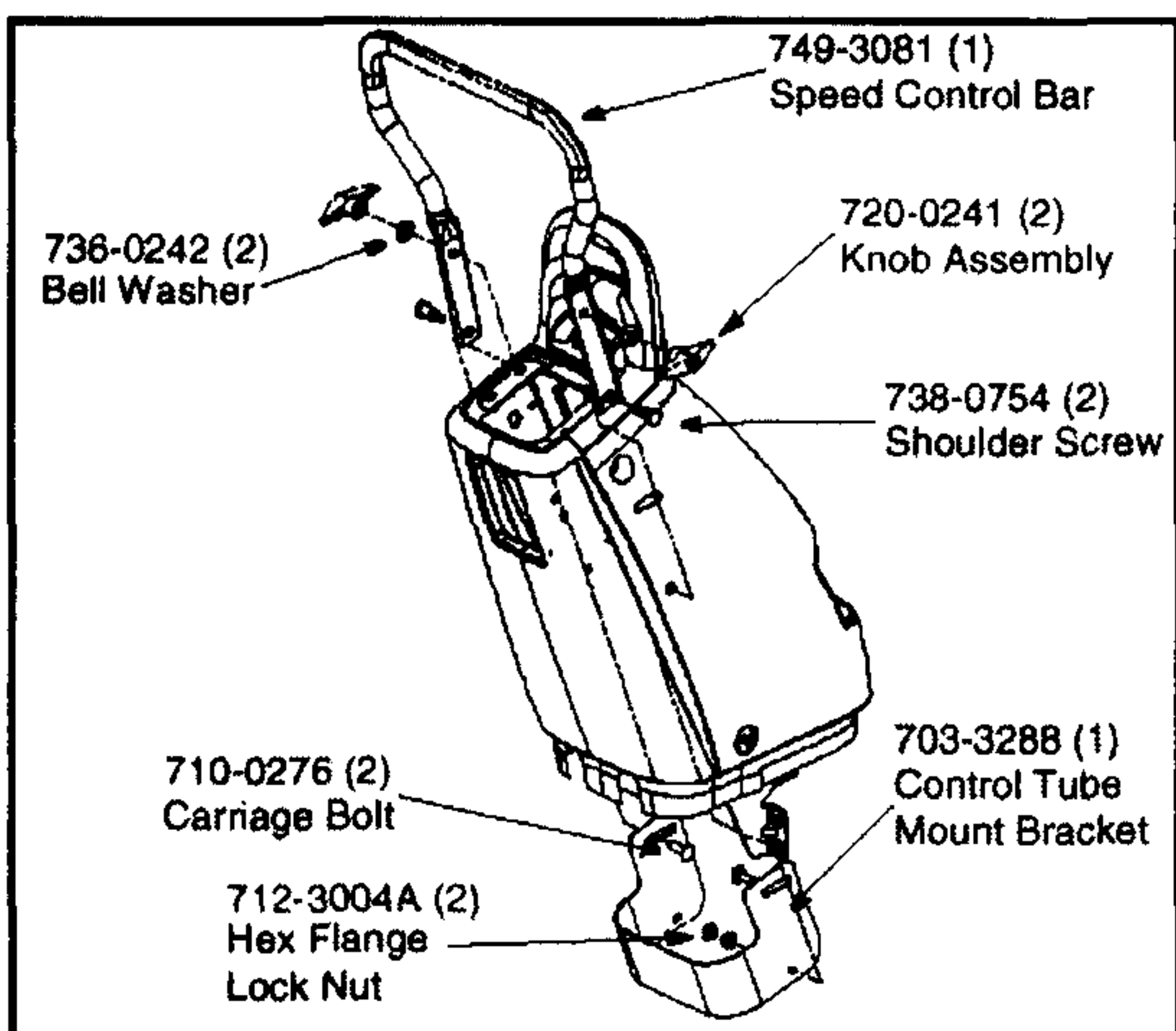

Figure 3

Warranty Allowance: NONE. Speed Control Kit (part number **759-3866**) will be available from Shelby Parts Distribution. Reuseable **template** (part number **703-3315**), as shown in figure 2, must be ordered with the first kit. Speed Control Kits and one template per dealer are being offered *NO CHARGE* (parts only - no warranty claim required) on retailed (customer must request) and in dealer stock units.

Service Manager	Parts Manager	Service Tech.	Service Tech.	Service Tech.

Circulate and Initial