



Service Advisory Code: W-100

Models Z Series Mowers with 42, 48, and 54 inch decks

Date October 14, 1997

Subject MOWER DECK ADJUSTMENTS

The mower deck must be adjusted for even cutting and proper belt alignment

In addition to the deck adjustment, correct installation of rear lift links (P/N 703-2780) is essential. The rear lift link, as shown in figure 1, must be installed in the lower frame hole. NOTE: Rear lift links may have been inadvertently mislocated on units built before serial number 1H207G9005*

Use these instructions instead of those found in the Owner's Manual when adjusting deck

- 1 Check rear tire pressure for proper inflation and tracking
- 2 Position the Z-series on a hard and level surface. Engage parking brake
- 3 Turn ignition switch to OFF position and remove key. Place PTO switch in OFF position. Remove spark plug wires from the spark plugs
- 4 Deck leveling adjustment. NOTE: Raise lift handle to the highest setting (7) to measure settings. Lower mower deck to the L(lock) position to make adjustments
 - a Adjust LH and RH retaining arm to a starting length of 11 1/8 inches. Refer to figure 2
 - b Position mower blades so the ends of each blade point to the front and to the rear of the unit
 - c The height of the rear cutting edge to the ground of each blade, from a hard level surface to the outermost edge, should measure 4 5/8 inches
 - d To adjust the height of the rear blades, adjustment of each deck hanger link is required. Refer to figure 3. Remove the nut and bolt (A) that holds the deck hanger link to the hanger bracket. Adjust the length of the link up or down by turning the hanger link until proper measurements are obtained. NOTE: one full turn = 1/16 inch
 - e Reconnect deck hanger links to hanger brackets with nuts and bolts previously removed. Tighten. Recheck rear blade measurement described in step c
 - f The height of the front cutting edge to the ground of each blade should measure 4 1/2 inches

g. To adjust the height of the front blades, adjustment of each retaining arm is required. Refer to figure 2. Adjust the length of retaining arm until proper measurements are obtained. NOTE: one full turn = 1/16 inch.

6. Next, raise the mower deck front gauge wheels to its highest setting. NOTE: Front gauge wheels and rollers prevent scalping and are not meant to set the mower height.

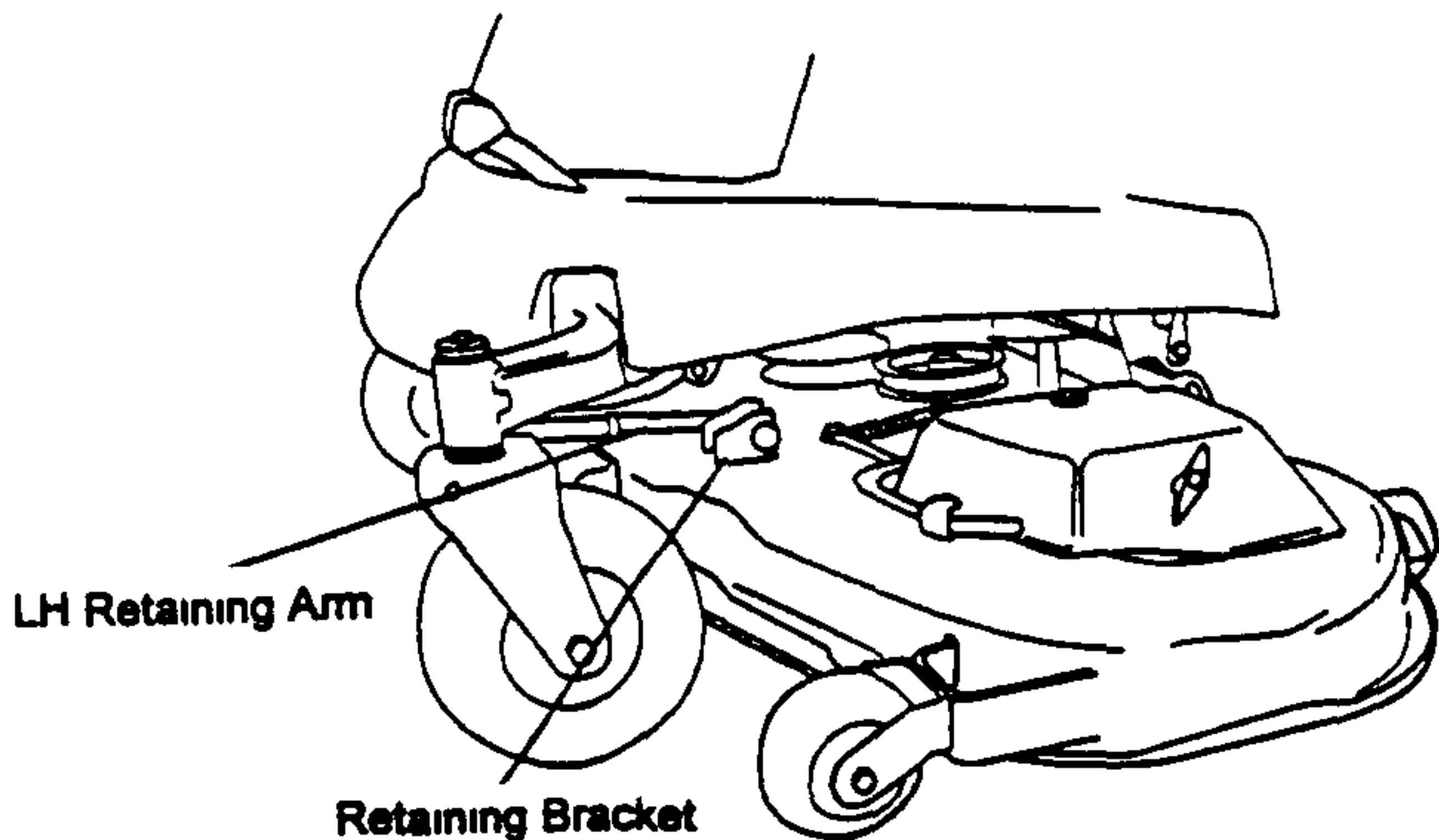
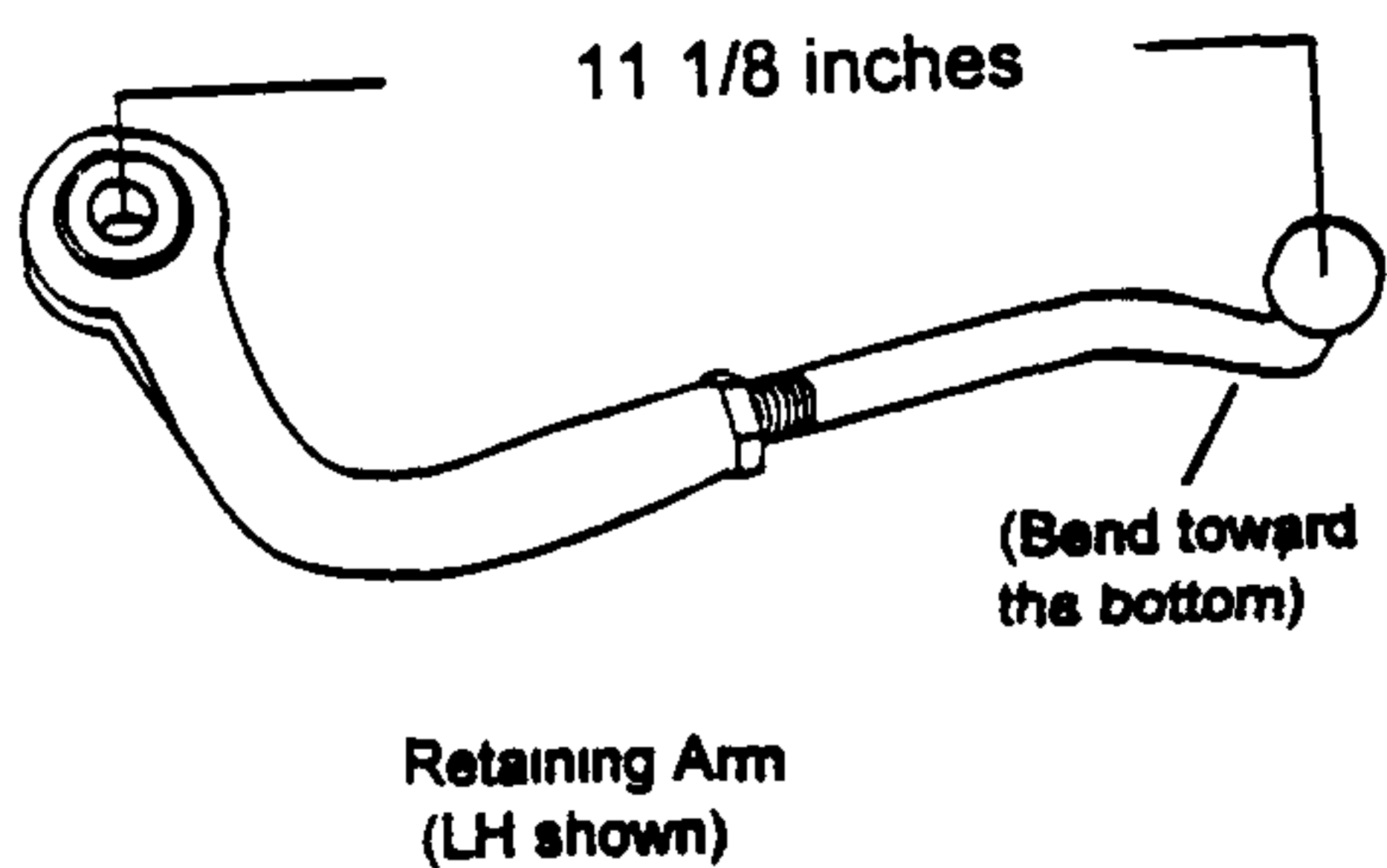
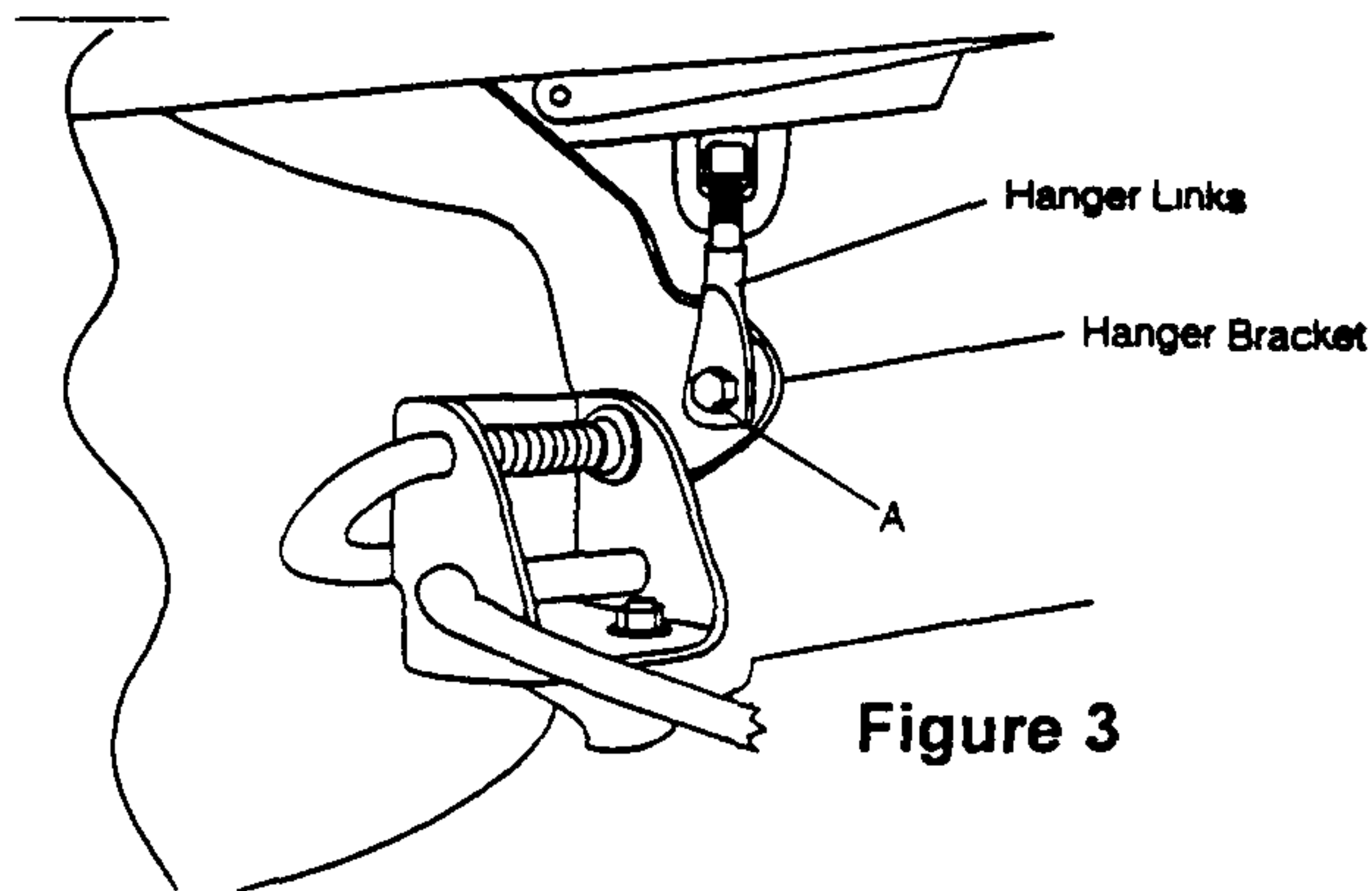
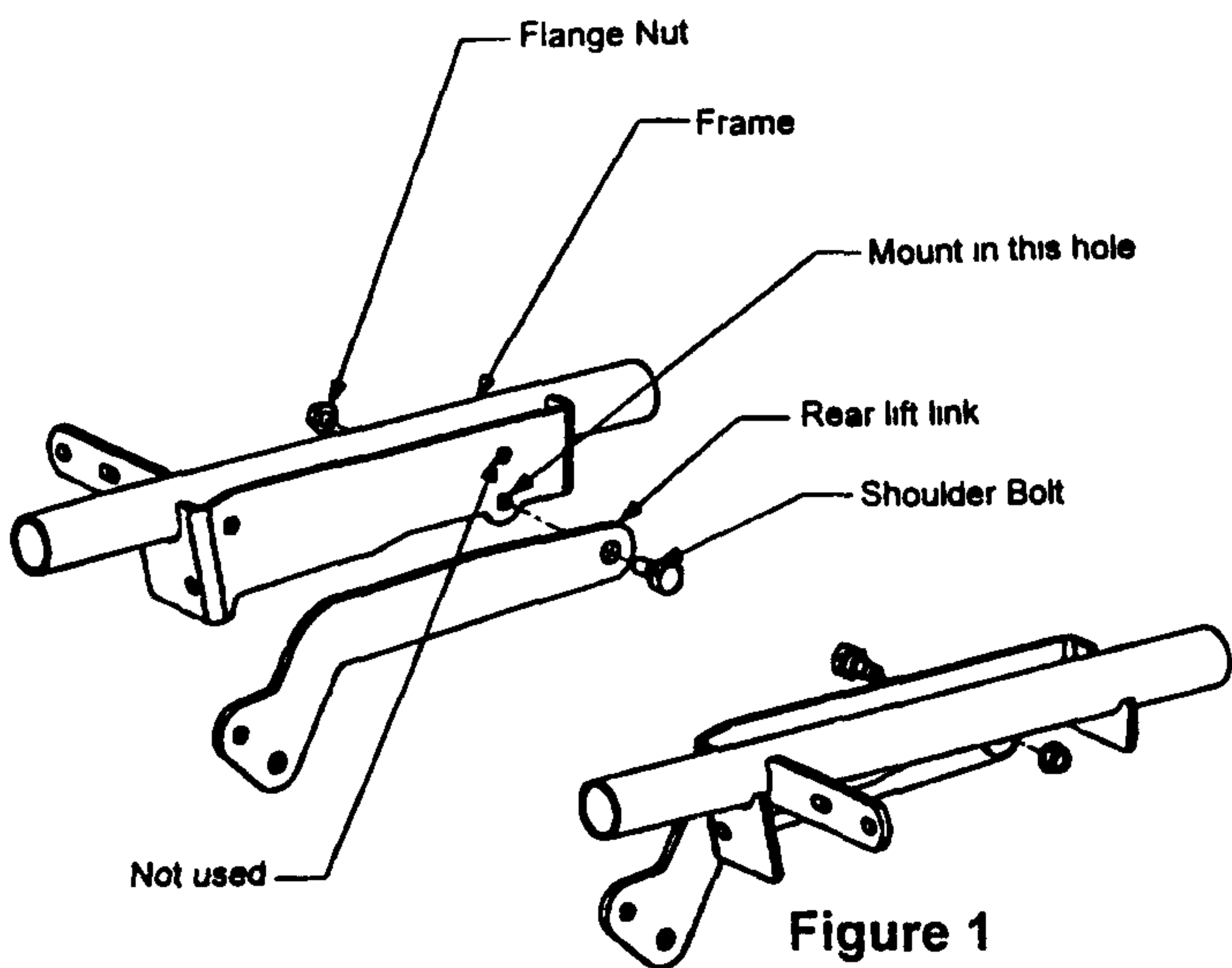

* Refer to the 1997 Service Update Seminar Book for serial number/manufacturing code information.

Warranty Allowance: None. This is being released for informational purposes only.

Service Manager	Parts Manager	Service Tech.	Service Tech.	Service Tech.

Circulate and Initial