



Service Kit 753-06060

Date: 2/16/2009

Subject: Service Replacement for the Drive Engage Control Lever Assembly for Walk Behind Self Propelled Mowers

Models Affected: N/A

Read through and understand these instructions completely before proceeding with repair.

PURPOSE: This kit replaces the 753-05096 and 753-05096A service kits which are no longer available.

NOTE: These materials are prepared for use by trained technicians who are experienced in the service and repair of equipment of the kind described in this publication, and are not intended for use by untrained or inexperienced individuals. Such individuals should seek the assistance of an authorized service technician or dealer.

NOTE: Save this Instruction Sheet. Refer to it when ordering replacement parts.

Service Kit Contents

(See Figure 1)

ITEM NO.	PART NUMBER	QTY	DESCRIPTION
1	710-04793	4	SCREW: #10-16 x 1.0: CSKPHI
2	731-05873	1	LEVER: ENGAGE:DRIVE
3	*	1	COVER:CONTROL:SQUEEZEBOX:LOWER
4	*	1	COVER:CONTROL:SQUEEZEBOX:UPPER
5	*	1	THIS INSTRUCTION SHEET

* - Not Available Separately

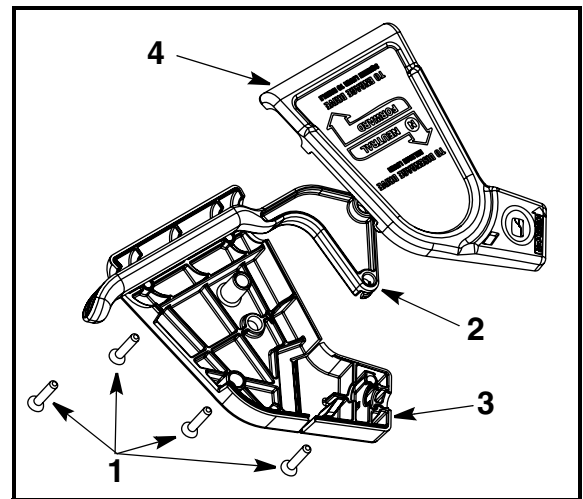

FIGURE 1

Pre-Service Preparation:

1. Place mower on a flat and level surface, turn off the engine and allow muffler and engine to cool before proceeding.

2. Remove spark plug wire from the spark plug and ground the wire to the engine block.

Removal Instructions:

3. From the underside of the Drive Engage Control Lever Assembly housing, with a #1 phillips head screw driver, remove and discard the five screws that hold the two halves of the housing together and to the handle.

4. Discard the existing control lever, cable mounting cap and upper and lower housings.

Installation Instructions:

5. Locate the new Upper Half Control Cover, Item 4.

6. Install the new Drive Engage Lever, Item 2, onto the lever's post in the upper cover half as shown in Figure 2.

7. Take the existing drive engage and install the barrel end into the Control Lever socket as shown in Figure 2.

NOTE: To facilitate assembly, pull on the metal barrel end of the cable to ensure as much of the metal cable is extended from the cable sheath.

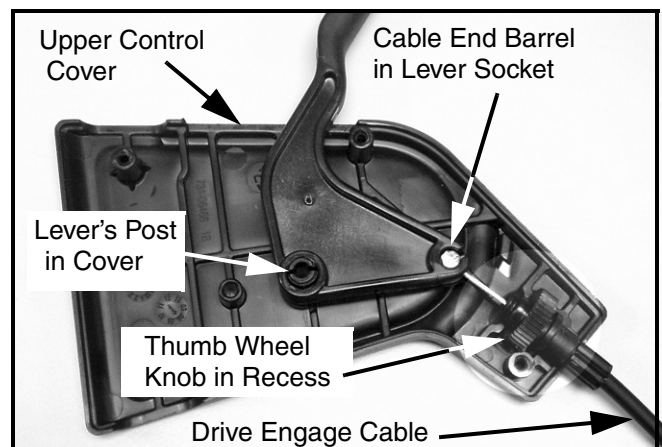

FIGURE 2

8. Place the drive engage cable's thumb wheel knob into the Upper Control Cover recess as shown in Figure 2.

9. Attach the small hinged portion of the new Lower Control Cover, Item 3, to the upper control cover with one (1) Screw, Item 2. Tighten screw. See Figure 3.

NOTE: Ensure that the drive engage cable thumb wheel is set correctly in both upper and lower cover halves.

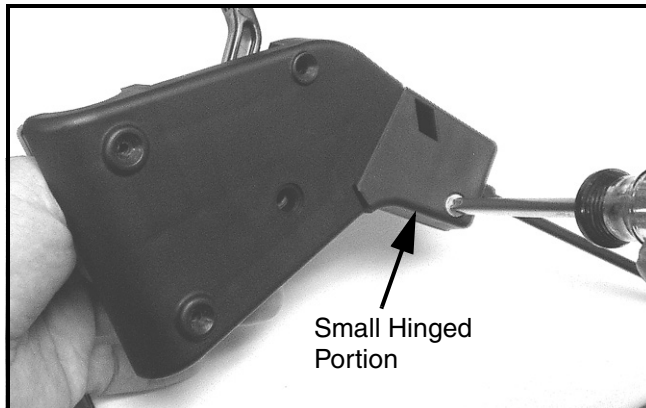

FIGURE 3

NOTE: Do not close Lower Control Cover half onto the Upper Control Cover half until assembly is installed onto the upper mower handle.

10. While ensuring that the drive engage control lever remains seated in the upper control cover, carefully place the drive engage control assembly onto the upper mower handle with the upper control cover's mounting tabs inserted into the two holes in the upper mower handle.

NOTE: Carefully close the two halves together, while aligning the three (3) posts in the upper cover half with the sockets in the lower cover half. See Figure 4.

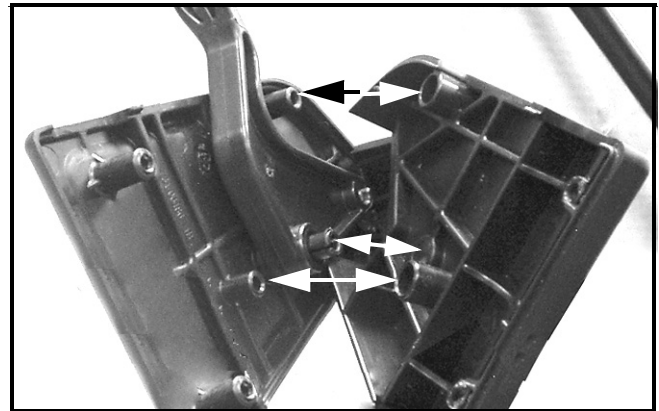

FIGURE 4

11. Install and tighten three (3) Screws, Item 2, into the Lower Control Cover to hold the Drive Engage Control Assembly to the upper mower handle.

12. Test operation of the Drive Engage Control Assembly to insure that the Drive Control Lever pivots freely.

13. Replace spark plug wire onto the spark plug and start the engine. Test the Drive Engage Control for proper operation. Refer to the Operator's Manual to adjust the thumb wheel cable adjuster as needed.

This completes the installation of this service kit.