



Service Kit 753-05884

Date: 4/4/2008

Subject: Drive Wheel Noise

Models Affected: 2008 Model Year 800 (XP) Series
High Wheel Self Propelled Walk Behind Mower

REFERENCE: S/A MTD-081

Read through and understand these instructions completely before proceeding with repair.

PURPOSE: This service kit supplies the hardware and the instructions to install the hardware. The supplied hardware will reduce operational noise from the wheel drive gears.

NOTE: These materials are prepared for use by trained technicians who are experienced in the service and repair of equipment of the kind described in this publication, and are not intended for use by untrained or inexperienced individuals. Such individuals should seek the assistance of an authorized service technician or dealer.

NOTE: *Save this Instruction Sheet. Refer to it when ordering replacement parts.*

Service Kit Contents

(See Figure 1)

ITEM NO.	PART NUMBER	QTY	DESCRIPTION
1	732-04557	2	SPRING: COMPRESSION
2	736-0514	2	WASHER: FLAT: .885 x 1.850 x .060
3	736-3084	2	WASHER: FLAT: .51 x 1.12 x .06 HT
4	736-0160	2	WASHER: FLAT: .53 x .93 x .050
5	736-3068	2	WASHER: FLAT: .531 x .875 x .060
6	712-04065	4	NUT: FLANGE LOCK: 3/8"-16:GRF:NYLON
7	*	1	THIS INSTRUCTION SHEET

* - Not Available Separately

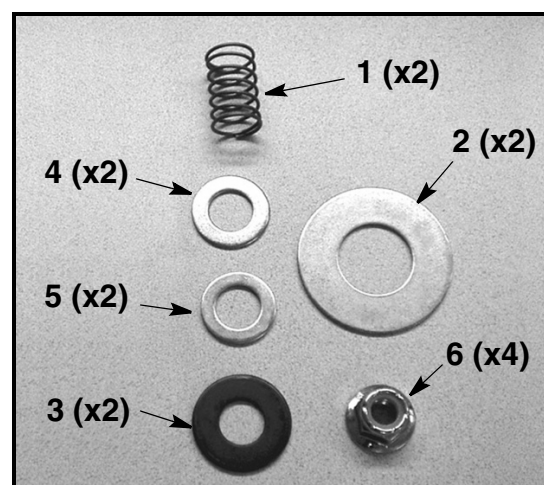

FIGURE 1

Pre-Service Preparation:

1. Place mower on a flat and level surface, turn off the engine and allow engine and muffler to cool before proceeding with the upgrade.
2. Remove the spark plug wire from the spark plug and ground wire to the engine block.

Installation Instructions:

NOTE: Left and right are determined from the operator's position at the rear of the mower and facing forward.

3. On the left hand (LH) side of the mower, place a 3"- 4" wood block under the deck side just forward of the rear wheel.
4. Remove the hub cap from the wheel by using a flat blade screw driver to pull the edge of the hub cap away from the wheel. Using your fingers, pull the hub cap off of the wheel hub. The hub cap's "snap-on" retaining feature is on a inner diameter hub. See Figure 2.

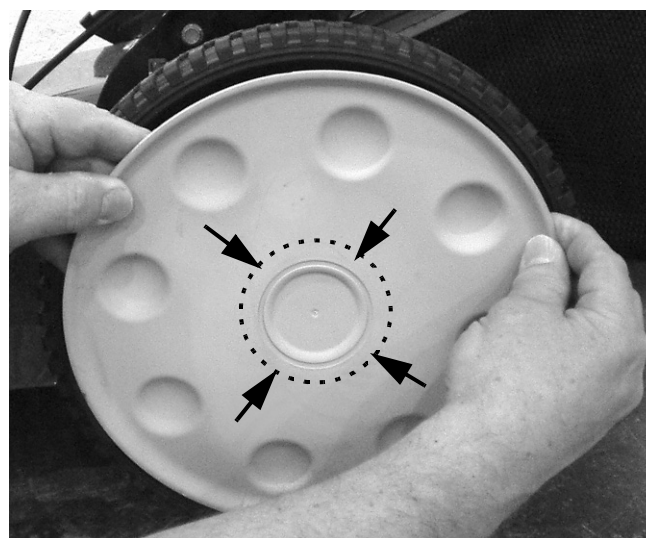

FIGURE 2

5. Using a 9/16" socket and ratchet, remove and discard the hex flange lock nut securing the wheel to the axle. Remove the wheel.

6. Using a pair of vise grip pliers, securely clamp onto the transmission's drive axle as shown in Figure 3.



FIGURE 3

7. Using a T30 Torx bit and ratchet **and holding the vise grip pliers to keep the transmission axle from rotating**, remove the Torx head screw retaining the spur gear to the transmission's output shaft. Note the assembly sequence as you remove the spur gear, dowel pin, flat washer and wheel dust cover. See Figure 4.

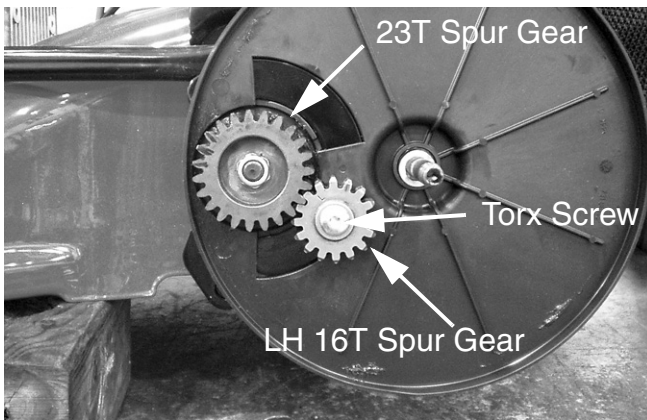

FIGURE 4

8. Using a 9/16" socket and ratchet, remove the hex flange lock nut retaining the 23T spur gear. Remove the 23T spur gear.

9. Remove the dust cover.

10. Assemble a Compression Spring, Item 1, and a Flat Washer, Item 4, onto the transmission's output shaft end. See Figure 5.

11. Assemble a Flat Washer, Item 2, onto the wheel axle shoulder. See Figure 5.

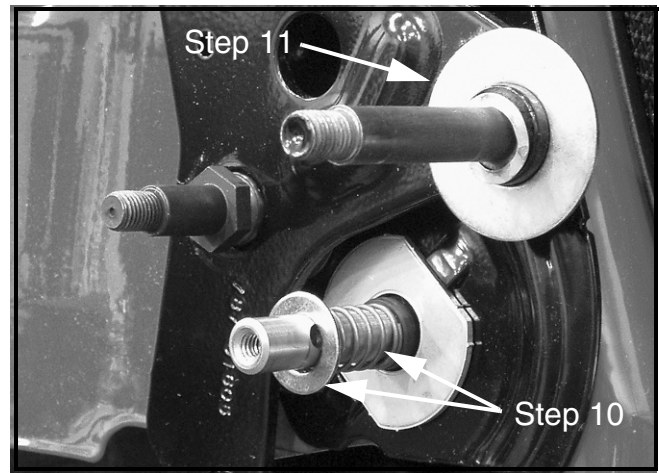

FIGURE 5

12. Re-install the dust cover onto the three shafts/axles.

13. Assemble one (1) Flat Washer, Item 5, and one (1) Flat Washer (HT), Item 3, onto the transmission output shaft, as shown in Figure 6.



FIGURE 6

14. Using a light lithium or silicone base grease, lubricate dowel pin (removed in Step 7) and the dowel pin facing side of the 736-3084 HT washer.

15. Install the dowel pin as shown in Figure 6.

16. Using a light lithium or silicone base grease, lubricate the end of the transmission's output shaft.

17. Reassemble the LH 16T spur gear onto the end of the output shaft.

18. Clean off the threads of old locking compound from the Torx screw. Apply Loctite 242 (Blue) or 246 (Red) or equivalent to the clean Torx screw.

19. Using a T30 Torx bit and ratchet **and holding the vise grip pliers to keep the transmission axle from rotating**, secure the 16T spur gear to the transmission's output shaft with the prepared Torx screw. Tighten securely.

20. Using a lithium or silicone base grease, lubricate the 23T spur gear shaft. Refer to Figure 6.

21. Assemble the 23T spur gear onto the shaft.

22. Using a 9/16" socket and ratchet, assemble a new 3/8"-16 Flange Lock Nut, Item 6, securing the 23T spur gear onto the shaft.

23. Re-assemble the wheel onto the wheel axle. Using a 9/16" socket and ratchet, assemble a new 3/8"-16 Flange Lock Nut, Item 6.

24. Re-install the wheel hub cap.

25. Perform Steps 3 through 24 for the right hand side rear wheel drive gears.

NOTE: *Remove the vise grip pliers from the transmission axle shaft.*

NOTE: *Replace the spark plug wire onto the spark plug.*

This completes the installation of this service kit.