

# AERATOR ATTACHMENT

OEM-290-262 / 290-262-081 for the VersaTiller™

## Installation and Operation Instructions

**THANK YOU!**

*Thank you for ordering the Aerator Attachment for your VersaTiller™. To ensure safe and proper installation of the attachment, please read and carefully follow all instructions.*

### Parts Listing

The shipping carton contains four aerator tines (see Figure 1) and the installation hardware. If any tines or hardware are missing or damaged, be sure to contact your local Authorized Dealer or the Factory right away.

If you have any questions or concerns regarding the installation procedure, be sure to contact the factory Technical Service Department.

NOTE: If you ever need to replace a worn or damaged aerator tine or a hardware component, refer to the part numbers listed below.

#### Contents of Shipping Carton

Ref. No.	Part No.	Description	Qty.
A	1911420	Aerator Tine.....	4
B	GW-9380	Clevis Pin .....	4
C	GW-9338	Hair Pin Clip .....	4

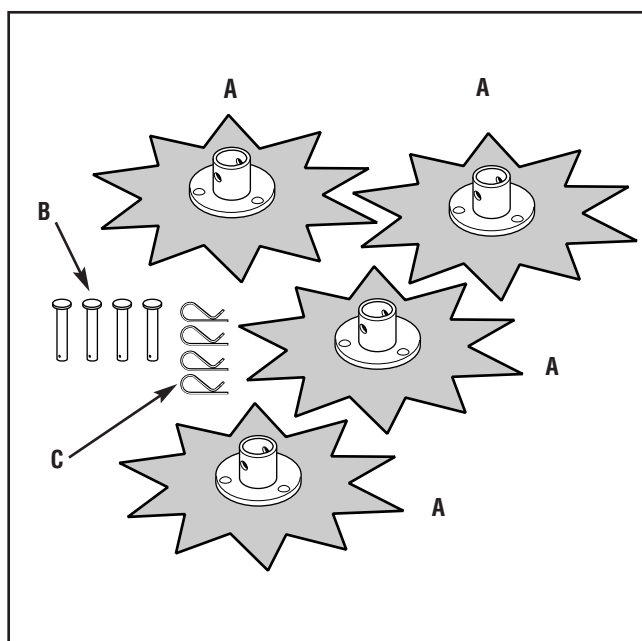

Figure 1

### Safety

Before installing or using this attachment, carefully review the “Safety Rules” and “Operation” instructions in your VersaTiller Owner’s Manual. Doing so will provide you with safe operating practices that must be followed at all times.



#### CAUTION

##### TO AVOID INJURY:

- When using the aerator attachment the tine hood must be properly and securely attached.
- Your machine must be set up in the rear tine tiller mode (handlebar swiveled over tine hood—see Owner’s Manual).
- Read the Owner’s Manual thoroughly.
- Know the location and function of all controls.
- Keep all safety devices and shields in place and working.
- Never allow children or uninstructed adults to operate the machine.
- Shut off engine and disconnect spark plug wire before unclogging tines or making repairs.
- Keep bystanders away from machine.
- Keep away from rotating parts.
- Use extreme caution when reversing or pulling the machine toward you.

### Installation Steps



#### WARNING

##### TO AVOID INJURY:

- Before installing or removing the attachment, shut the engine off, allow it to cool, disconnect the spark plug wire and prevent it from touching the spark plug.
- Wear gloves when near tines. Tines may be sharp.

1. Move the unit to a flat, level work surface (swivel handlebar over the engine to “freewheel” the machine).
2. Disconnect the spark plug wire and move it away from the spark plug to prevent the possibility of accidental engine starting.

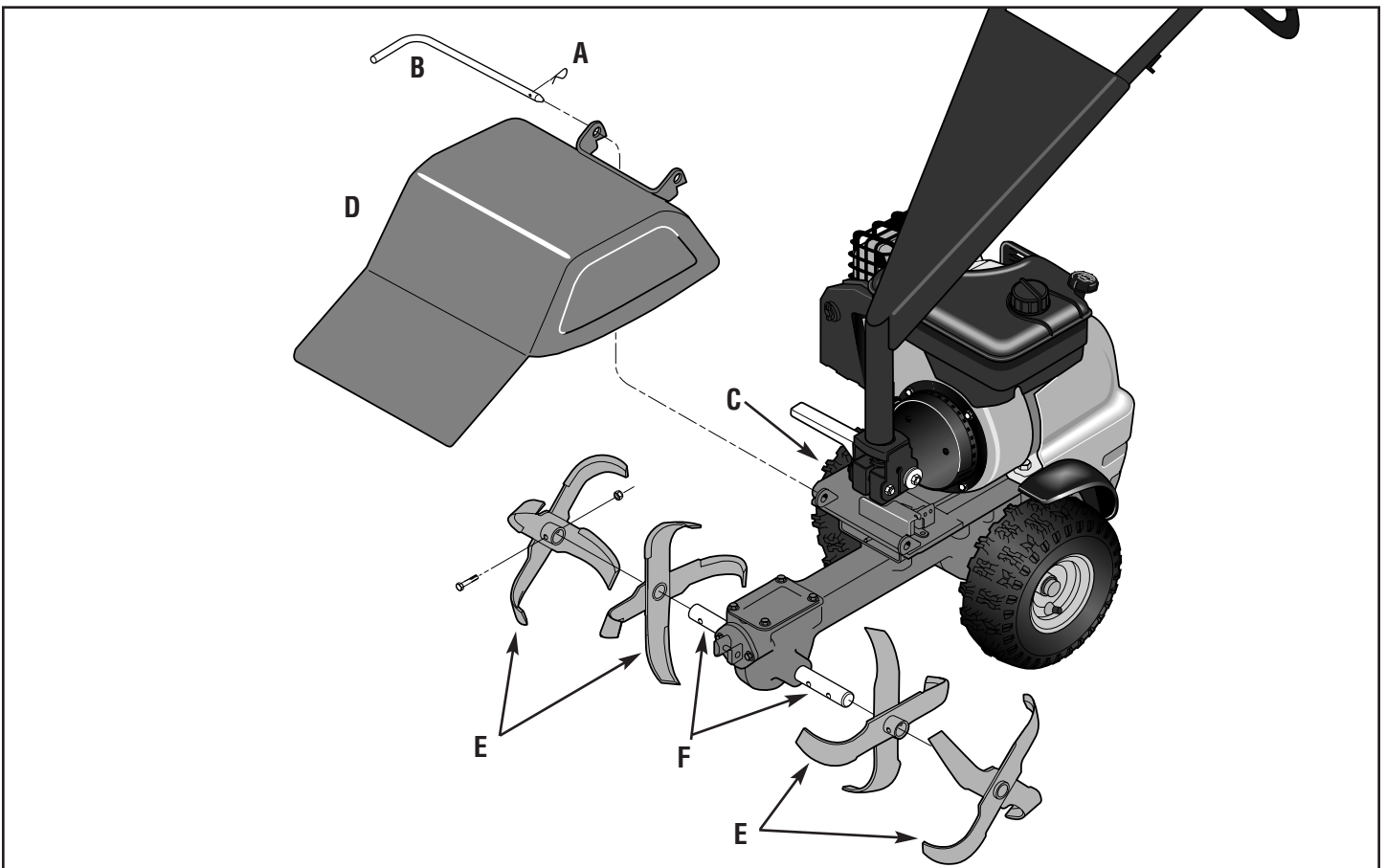

**Figure 2: Remove the tine hood, then take off the tine sets and put them aside.**

**3.** Take off the tine hood to make access to the tines easier. First remove the hair pin clip (A, Figure 2) from the hood release pin (B). Slide the hood release pin out of the hood bracket (C). Then lift up the hood flap at the rear of the hood and tilt the tine hood (D) backward so the bracket at the rear of the hood disengages from the transmission. Lift the hood assembly off and put it aside. Keep the hardware close by.

**4.** Remove all four tine sets (E, Figure 2) from both ends of the tine shaft. Save all mounting hardware for later installation. Please mark the tine sets so they are reinstalled in the same positions later. (**IMPORTANT: The “cutting” edges of the tines must enter the soil first.**)

**5.** Clean the tine shaft (F, Figure 2) and inspect for any rust or burrs (use fine-grade sandpaper to remove light rust or burrs). Apply a thin coating of general purpose oil along the tine shaft.

**6.** The four aerator tines (G, Figure 3) are identical. Slide one aerator tine on either the right-side or left-side of the tine shaft. The hub (H, Figure 3) on the tine must face to the *outside*.

**7.** Place a second aerator tine next to the first tine. Its hub (I) must face to the *inside* (toward the transmission case). If installed correctly, the two tine hubs will face each other.

**8.** Secure each of these two aerator tines with a clevis pin (B, Figure 3) and a hair pin clip (C, Figure 3).

**9.** Repeat Steps 6, 7 and 8 with the other two aerator tines.

**10.** Replace the tine hood securely.

**11.** Swivel the handlebar around so it extends over the tine hood—in the rear tine tiller mode.

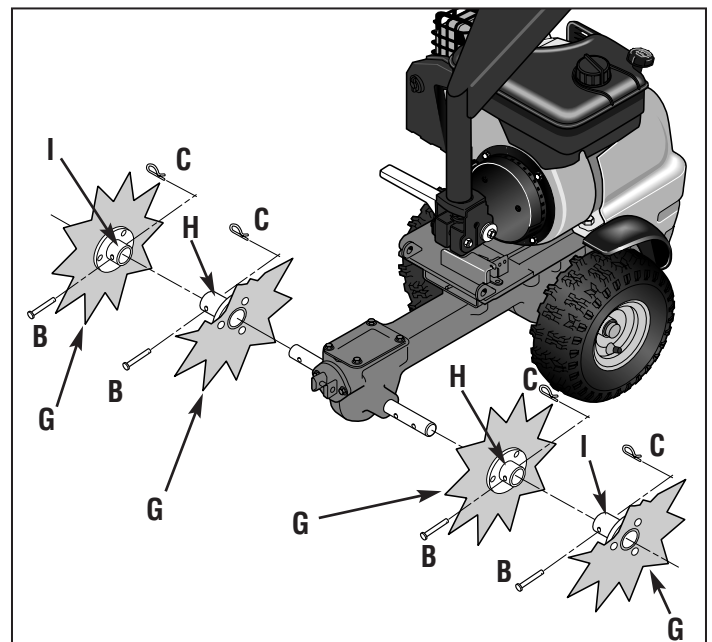

**Figure 3: On each end of the tine shaft, the inside aerator tine goes on with the tine hub facing out (away from the transmission case). The second aerator tine must have the tine hub facing inward. Secure all four tines with clevis pins and hair pin clips.**

## Operation Tips



### CAUTION

#### TO AVOID INJURY:

- Do not operate machine when you are barefoot or when wearing sandals, sneakers, or similar lightweight footwear. Wear footwear that will protect your feet and improve footing on all surfaces.
- Always stop the engine before “freewheeling” the machine to another location.
- Stop engine, allow it to cool, and disconnect the spark plug wire before unclogging the tines or performing any repairs or maintenance.

The aerator attachment helps develop healthy, dense lawns by loosening the soil to contribute to better, more vigorous root growth. The typical lawn should be aerated once or twice a year, usually in the spring and fall. Lawns with heavily compacted soil, or lawns with very hard soil may benefit from additional aeration cycles during the year, particularly during times of greatest potential growth.

- For best results:
  - Mow and rake the lawn before aeration.
  - The soil should be somewhat moist or soft, rather than very dry and hard.
  - You may wish to dethatch your lawn before aeration. The dethatcher attachment (check with your authorized dealer or the Factory as to availability) works well for this purpose.
- The depth of cut is determined by a number of factors, including: soil conditions, the ground travel speed, the engine speed, and the amount of pressure applied to the handlebars. Be patient while learning to use the aerator attachment – you may have to experiment to find that “just right” combination for your particular lawn and type of terrain.

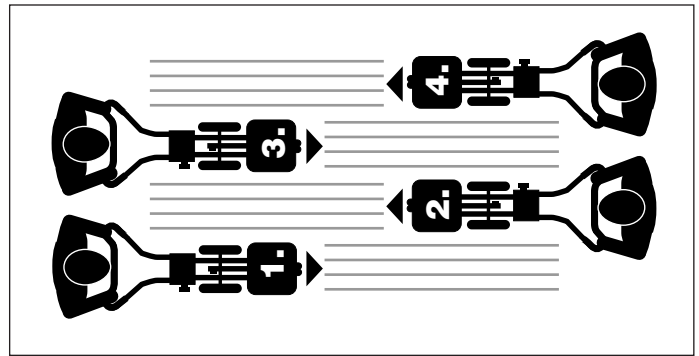

Figure 4

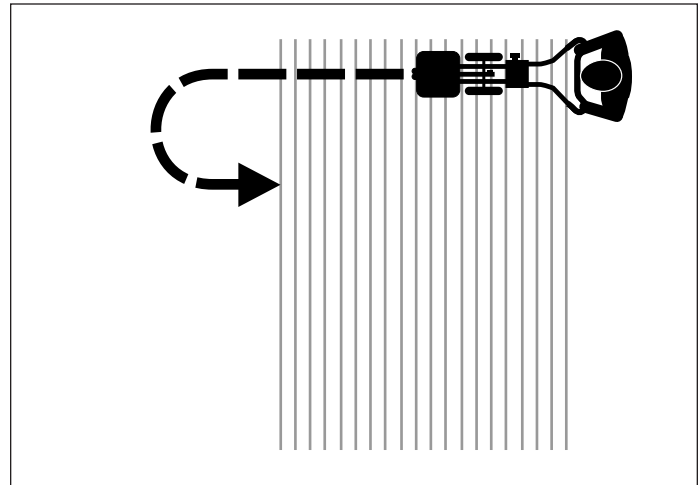

Figure 5

- Holding the Drive Bail closed against the handlebar engages the wheels and the aerator tines. Lift up on the handlebars and then slowly lower them until the rotating tines enter the soil.
- Allow the machine to move forward while the aerator blades slice into the lawn and soil. Allow enough time for the tines to dig deeply enough.
- Aerate the soil by making side-by-side passes (see Figure 4). For more thorough aeration, you may wish to make a second series of passes at a right angle to the first series of passes (see Figure 5).
- After aerating the soil, rake up any residue.
- Following aeration is usually a good time to fertilize the lawn. Follow application recommendations and instructions provided with the fertilizer. Or, if you have particularly troublesome spots, you may wish to reseed these areas after aeration.

**IMPORTANT:** When replacing the regular tines after removing the aerator tines, install them as shown in Figure 2. The cutting edges of the regular tines must enter the soil first— install the tine sets accordingly.

For Discount Troy Bilt Parts Call 606-678-9623 or 606-561-4983



*For customer assistance, visit [www.troybilt.com](http://www.troybilt.com), contact your nearest authorized dealer or:*

**TROY-BILT LLC, P.O. BOX 361131, CLEVELAND, OHIO 44136-0019, 1-866-840-6483**

Printed in U.S.A.

Form 769-00131 (03/2002)

[www.mymowerparts.com](http://www.mymowerparts.com)