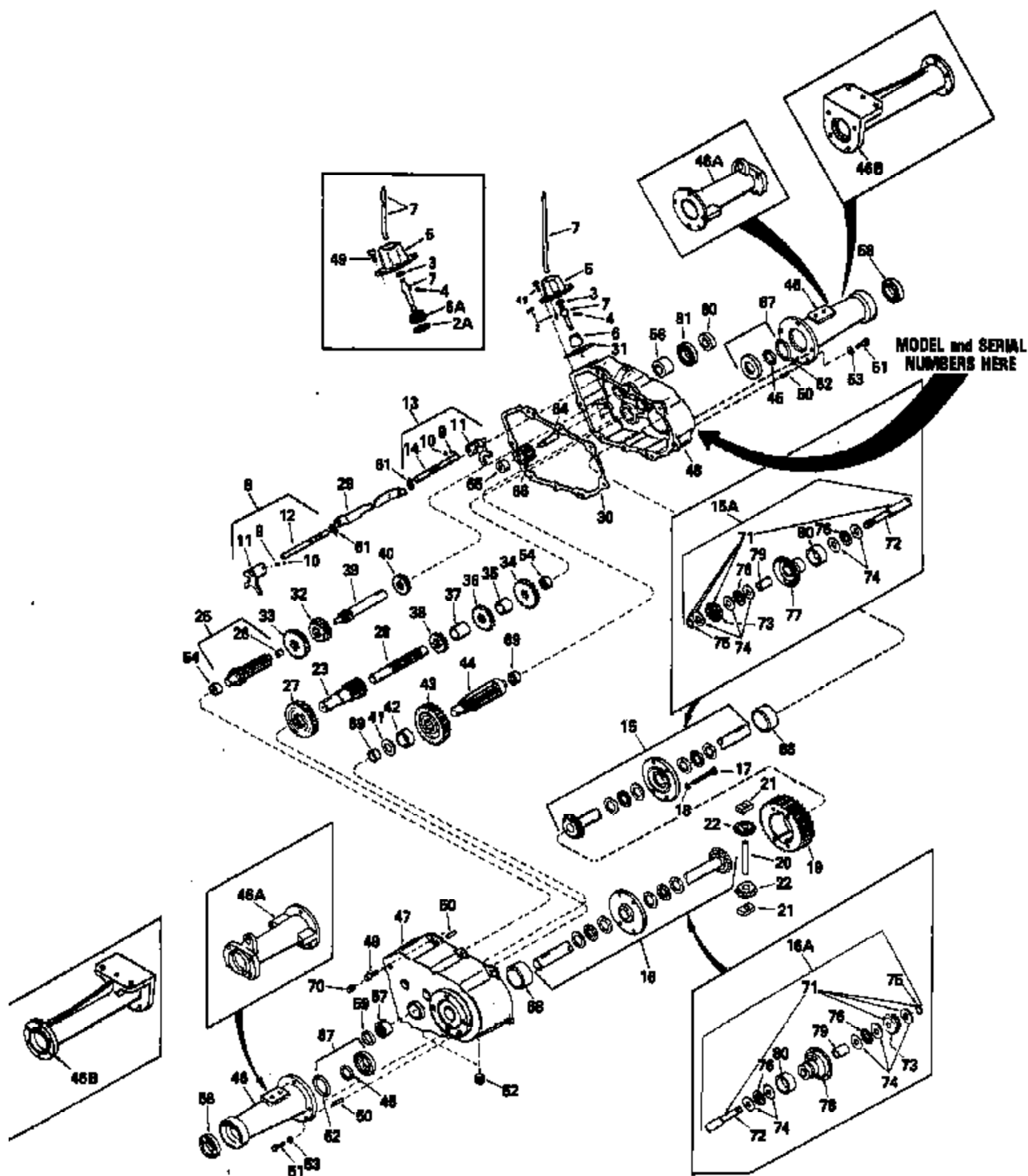

ILLUSTRATION SHOWS TYPICAL PARTS ONLY. ORDER BY PART NUMBER. PARTS NOT LISTED ARE SUPPLIED BY OEM.



| Ref # | Part Number | Qty | Description |
|-------|-------------|----------------------|--|
| 2 | 792000 | | Pin, 1/8 x 3/8 |
| 3 | 792001 | | "O" Ring |
| 4 | 792049 | | Pin, Drive |
| 5 | 784018A | | Housing, Shift lever |
| 6 | 784016 | | Keeper, Shift lever |
| 7 | 784035 | | Lever, Shift |
| 8 | 784056 | | Rod & Fork, Shift (Incl. 9 thru 12 & 61) |
| 9 | 792003 | | Spring |
| 10 | 792004 | | Ball, Steel |
| 11 | 784004 | | Fork, Shifter |
| 12 | 784057 | | Rod, Shifter (First & Reverse) |
| 13 | 784054 | | Rod & Fork, Shift (Incl. 9 thru 11, 14 & 61) |
| 14 | 784055 | | Rod, Shifter (Second & High) |
| 15 | | 2000-2001-4 Peerless | Axle Assy., RH(OLD STYLE) NOTE: Transaxle below was originally produced with OLD STYLE axle assembly, which had bevel gear rolled on axle. NEW STYLE axle assemblies are now available. Any combination of component parts can be purchased, Ref. Nos.71 thru 80. |
| 15A | 774020 | | Axle Assy., RH (NEW STYLE)(13.343 lon g) NOTE: Transaxle below was originally produced with OLD STYLE axle assembly, which had bevel gear rolled on axle. NEW STYLE axle assemblies are now available. Any combination of component parts can be purchased, Ref. Nos.71 thru 80. |
| 16A | 774021 | | Axle Assy., LH (NEW STYLE)(13.343 lon g) NOTE: Transaxle below was originally produced with OLD STYLE axle assembly, which had bevel gear rolled on axle. NEW STYLE axle assemblies are now available. Any combination of component parts can be purchased, Ref. Nos.71 thru 80. |
| 16 | | | Axle Assy., LH (OLD STYLE) NOTE: Transaxle below was originally produced with OLD STYLE axle assembly, which had bevel gear rolled on axle. NEW STYLE axle assemblies are now available. Any combination of component parts can be purchased, Ref. Nos.71 thru 80. |
| 17 | 792005 | | Screw, 1/4-20 x 2-1/2" |
| 18 | 792006 | | Lockwasher, Split 1/4" |
| 19 | 778033A | | Gear, Ring (1.500 wide, 31 teeth) |
| 20 | 786019 | | Pin, Drive (.497 dia. x 3.357 long) |
| 21 | 786027 | | Block, Drive |
| 22 | 778030 | | Bevel Pinion, Differential |
| 23 | 776022 | | Shaft & Bushing, Brake (3.687 long) |
| 25 | 776014 | | Shaft & Gear, Shifter (Incl. 26)(4.56 2 long) |
| 26 | 780018 | | Beaing, Needle |
| 27 | 778037 | | Gear, Idler |
| 28 | 776032 | | Shaft, Idler (.873 dia. x 5.750 long) |
| 29 | 784074 | | Stop, Shifter |
| 30 | 788026 | | Gasket, Case to cover |
| 31 | 788003 | | Gasket, Shift lever housing |
| 32 | 778019 | | Gear, Shifting (Second & High) |
| 33 | 778020 | | Gear, Shifting (First & Reverse) |
| 34 | 788021 | | Gear, Spur (26 tooth) |
| 35 | 786014 | | Spacer, Idler shaft |
| 36 | 778022 | | Gear, Idler shaft (22 tooth) |
| 37 | 786015 | | Spacer, Idler shaft |
| 38 | 778023 | | Gear, Idler shaft (16 tooth) |

| Ref # | Part Number | Qty | Description |
|-------|-------------|-------------|--|
| 39 | 776067 | | Shaft, Input (4.042 long) |
| 40 | 778024 | | Spur Gear, Input shaft |
| 41 | 780001 | | Washer, Output shaft |
| 42 | 786017 | | Spacer, Output shaft |
| 43 | 778036 | | Spur Gear, Output |
| 44 | 776023 | | Shaft, Output (6.00 long) |
| 45 | 788008 | | Seal, Oil |
| 46 | 782019 | | Housing, Axle (7.687 long) |
| 47 | 772032 | | Cover, Transaxle (Incl. 54, 57, 68 & 69) |
| 48 | 770024 | | Case, Transaxle (Incl. 54, 56, 68 & 69) |
| 49 | 792007 | | Screw, 1/4-20 x 3/4" |
| 50 | 792008 | | Pin, Dowel (.250 dia. x .750 long) |
| 51 | 792013 | 2000-2001-4 | Screw, 5/16-18 x 3/4" |
| 52 | 792010 | Peerless | Plug, Inspection & drain |
| 53 | 792015 | | Lockwasher, Shakeproof 5/16" |
| 54 | 780013 | | Bearing, Needle |
| 56 | 780011 | | Bearing (.750 ID x 1.250 OD x 1.00 long) |
| 57 | 780055 | | Bearing, Needle |
| 58 | 780050 | | Bearing, Ball |
| 59 | 788008 | | Seal, Oil |
| 60 | 788009 | | Seal, Oil |
| 61 | 792017 | | Ring, Snap |
| 62 | 788024 | | "O" Ring |
| 64 | 776008 | | Shaft, Reverse idler |
| 65 | 786008 | | Spacer, Reverse idler |
| 66 | 778016 | | Idler, Reverse |
| 67 | 788037 | | Retainer Assy., Seal (Incl. 45) |
| 68 | 780021 | | Bearing, Needle |
| 69 | 780014 | | Bearing, Needle (closed end) |
| 70 | 792012 | | Set Screw, 3/8-16 x 3/8" |
| 71 | 774059 | | Axle & Gear Assy. (Incl. 72 thru 75) |
| 72 | 774058A | | Axle (13.343 long) |
| 73 | 778032 | | Gear, Bevel |
| 74 | 780042 | | Washer, Thrust |
| 75 | 792018 | | Ring, Retainer |
| 76 | 780039 | | Bearing, Thrust |
| 77 | 774040 | | Carrier Assy., Differential (Incl. 79) |
| 78 | 774039 | | Carrier Assy., Differential (Incl. 79) |
| 79 | 780041 | | Bushing (.876 ID x 1.003 OD x 1.750 long) |
| 80 | 780038 | | Bushing (1.500 ID x 1.750 OD x 1.010 long) |