

Engine Parts List #1

| Ref # | Part Number | Qty | Description |
|-------|-------------|-----|--|
| 1 | 33867A | | Cylinder (Incl.3,4,5,9,67,70) (3-1/16 ") |
| 3 | 27642 | | Plug, Pipe (1/4-18) |
| 4 | 32630 | | Seal, Oil |
| 5 | 27652 | | Pin, Dowel |
| 6 | 29536 | | Blower Housing Baffle (No knock-out for electric start) (Use as required) |
| 6 | 35256A | | Blower Housing Baffle (With knock-out for electricstart) (Use as required) |
| 7 | 650561 | | Screw, 1/4-20 x 5/8" |
| 8A | 29783 | | Crankshaft Gear Pin (Used on early pr od.) |
| 8 | 33772A | | Crankshaft |
| 8B | 33245 | | Crankshaft Gear (Used on early produc tion) |
| 9 | 34540 | | Piston, Pin & Ring Set (Std.) (3-1/16 ") |
| 9 | 34541 | | Piston, Pin & Ring Set (.010" OS) |
| 9A | 33869B | | Piston & Pin Ass'y. (Std.)(Incl. 10)(3-1/16") |
| 9A | 33870B | | Piston & Pin Ass'y. (.010" OS) (Incl. 10) |
| 10 | 27888 | | Ring, Piston pin retaining |
| 11 | 33873 | | Ring Set (Std.) (3-1/16" Bore) |
| 11 | 33874 | | Ring Set (.010" OS) |
| 17 | 32591C | | Rod Assy., Connecting (Incl. 18 & 19) |
| 18A | 32590 | | Plate, Lock & Oil dipper (This plate may be replaced by No. 34242 oil dipper but No. 650662C screw must be used.) |
| 19 | 650662C | | Bolt, Connecting rod (2 pcs.) |
| 20 | 34034 | | Lifter, Valve |
| 21 | 33366 | | Camshaft |
| 22 | 33273A | | Extension, Blower housing |
| 23 | 650128 | | Screw, 10-24 x 1/2" |
| 24 | 35262 | | * Gasket, Cylinder cover |
| 25 | 33626B | | Cover, Cylinder (Incl. 27, 30, 31, 32 & 37) |
| 27 | 33625 | | Seal, Oil |
| 33 | 30699C | | Rod Assy., Governor (Incl. 34 & 35) |
| 33A | 30699B | | Rod, Governor (This one piece governor rod is no longer used. It is replaced by No. 30699C assembly, Ref. No. 5A.) |
| 34 | 30700 | | Yoke, Governor |
| 35 | 650494 | | Screw, 6-40 x 5/16" |
| 36 | 29642 | | Ring, Retaining |
| 37 | 31845 | | Shaft, Mechanical governor |
| 38 | 30588A | | Spool, Governor |
| 39 | 30590A | | Washer, Flat |
| 40 | 29193 | | Ring, Retaining |
| 41 | 30591 | | Gear Assy., Governor (Incl. 39) |
| 42 | 33369 | | Bracket, Governor gear |
| 43 | 650836 | | Screw, 10-24 x 1/2" |
| 49 | 29916 | | Clamp, Governor lever |
| 50 | 29826 | | Screw, 10-32 x 3/4" |
| 51 | 29216 | | Locknut, 10-32 |
| 52 | 33454 | | Lever Assy., Governor |
| 53 | 29918 | | Lockwasher, No. 8 E.T. |
| 54 | 650548 | | Screw, 8-32 x 5/16" |
| 55 | 30322 | | Locknut, 8-32 |
| 56 | 650832 | | Screw, 1/4-20 x 1-11/16" |
| 57 | 650833 | | Screw, 1/4-20 x 1-3/16" |
| 58B | 31297 | | Dipstick (Incl. 59) |
| 59 | 29673 | | * Gasket, Oil fill |
| 66 | 27878A | | Exhaust Valve (Std.) (Incl. 70) |
| 66 | 27880A | | Exhaust Valve (1/32" OS) (Incl. 70) |

Engine Parts List #1

| Ref # | Part Number | Qty | Description |
|-------|-------------|-----|--|
| 67 | 33242 | | Intake Valve (Std.) |
| 67 | 33243 | | Intake Valve (1/32" OS) |
| 68A | 27882 | | Cap, Upper valve spring |
| 68 | 27882 | | Cap, Upper valve spring |
| 69 | 27881 | | Spring, Valve |
| 70 | 32581 | | Cap, Lower valve spring |
| 76 | 32589 | | Key, Flywheel |
| 77A | 27275 | | Clip, Hi tension wire |
| 79 | 650815 | | Washer, Belleville |
| 80 | 8116 | | Nut, Hex |
| 82A | 610118 | | Cover, Spark plug (Use as required) |
| 83 | 650516 | | Screw, 1/4-20 x 1-1/8" |
| 95 | 30831 | | Ground Wire (Incl. 164) |
| 96 | 34041A | | * Gasket, Cylinder head |
| 97 | 34030 | | Head, Cylinder |
| 98 | 650692 | | Screw, 5/16-18 x 1-3/4" (Use as required) |
| 98 | 6021A | | Screw, 5/16-18 x 1-1/2" (Use as required, but do not use No. 650691 washer.) |
| 98 | 650711 | | Screw, 5/16-18 x 1-5/8" (Use as required) (Can use No. 6021A but discard No. 650691 washer.) |
| 99 | 33636 | | Resistor Spark Plug (RJ-8C) |
| 100 | 650691 | | Washer (Use as req.) (Do not use w/60 21A) |
| 101 | 650727 | | Screw, 5/16-18 x 1-3/4" (Use as required) |
| 104 | 27896A | | * Gasket, Breather |
| 105 | 28423 | | Body, Breather |
| 106 | 28424 | | Element, Breather |
| 107 | 28425 | | Cover, Breather |
| 108 | 35350 | | Tube, Breather |
| 109 | 650128 | | Screw, 10-24 x 1/2" |
| 114 | 29752 | | Nut, Whiz lock, 1/4-28 |
| 115 | 33263 | | * Gasket, Carburetor |
| 117 | 33370 | | Pipe, Intake |
| 118 | 650698 | | Screw, 1/4-28 x 7/8" |
| 119 | 650378 | | Screw, Torx T-30, 5/16-18 x 1-1/8" |
| 120 | 27915A | | * Gasket, Intake |
| 130 | 33375C | | Blower Housing (For electric starter) |
| 136 | 610973 | | Terminal Assy. (Use as required) |
| 140 | 33373 | | Link, Governor lever-to-throttle |
| 143A | 26073 | | Washer, Flat |
| 143 | 650713 | | Screw, 5/16-18 x 5/8" |
| 144 | 29747B | | Screw, 5/16-24 x 21/32" |
| 151 | 33356 | | Terminal, Ground |
| 158 | 34586 | | Rod, Choke |
| 168 | 33272A | | Cover, Cylinder head |
| 169 | 650737 | | Screw, 1/4-20 x 1/2" (Use as required) |
| 169 | 650738 | | Screw, 1/4-20 x 5/8" (Use as required) |
| 169 | 650713 | | Screw, 5/16-18 x 5/8" (Use as required) |
| 169 | 650802 | | Screw, 1/4-20 x 5/8" (Use as required) |
| 171 | 650713 | | Screw, 5/16-18 x 5/8" (Use as required) |
| 176 | 33032 | | Fuel Cap (Red Plastic) (Spurt Resistant, Low Profile) (Use as required) |
| 176 | 410144B | | Fuel Cap (White Plastic) (Std) (Use as required) |
| 176 | 34210 | | Fuel Cap (Ref Plastic) (Spurt Resistant, High Profile) (Use as required) |
| 176 | 35355 | | Fuel Cap (Red Plastic) (Use as required) |
| 177 | 29774 | | Fuel Line (Use as required) (8.25") (21 cm) |

| Ref # | Part Number | Qty | Description |
|-------|-------------|-----|---|
| 177 | 30705 | | Fuel Line (Use as required) (16.0") (41 cm) |
| 178 | 26460 | | Clamp, Fuel line (Use as required) |
| 186 | 27930A | | * Gasket, Exhaust (Use as required) |
| 195B | 33662 | | Hub & Screen Assy., Starter |
| 196 | 29752 | | Nut, Whiz lock, 1/4-28 |
| 260A | 550223 | | Decal, Name |
| 272 | 32255A | | Valve, Seal, Gasket & Spring Assy. |
| 274 | 631768 | | Carburetor (Incl. 115) (Refer to Division 5, Section A, page 120 for breakdown) |
| 276 | 590479 | | Rewind Starter (Refer to Division 5, Section C, page 30 for breakdown) |
| 280 | 33279G | | * Gasket Set (Incl. items marked *) |

ILLUSTRATION SHOWS TYPICAL PARTS ONLY. ORDER BY PART NUMBER, PARTS NOT LISTED ARE SUPPLIED BY OEM.

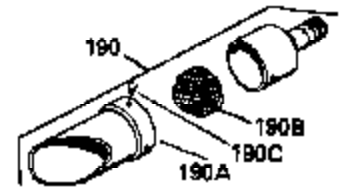
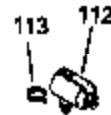
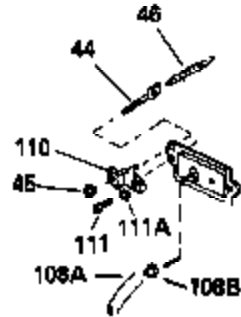
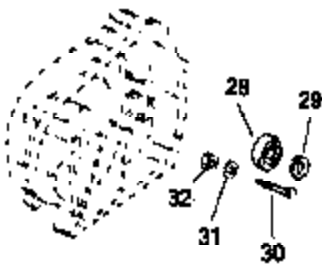

OPTIONAL
SPARK ARRESTOR MUFFLER

OPTIONAL SPARK ARRESTOR KIT

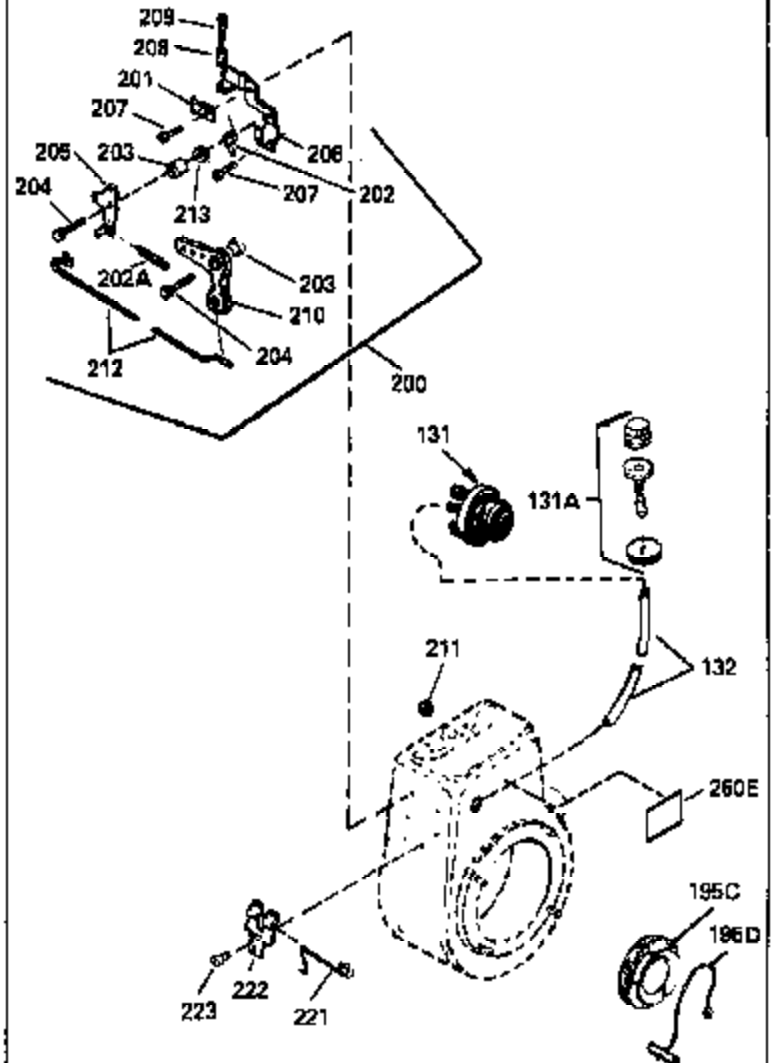
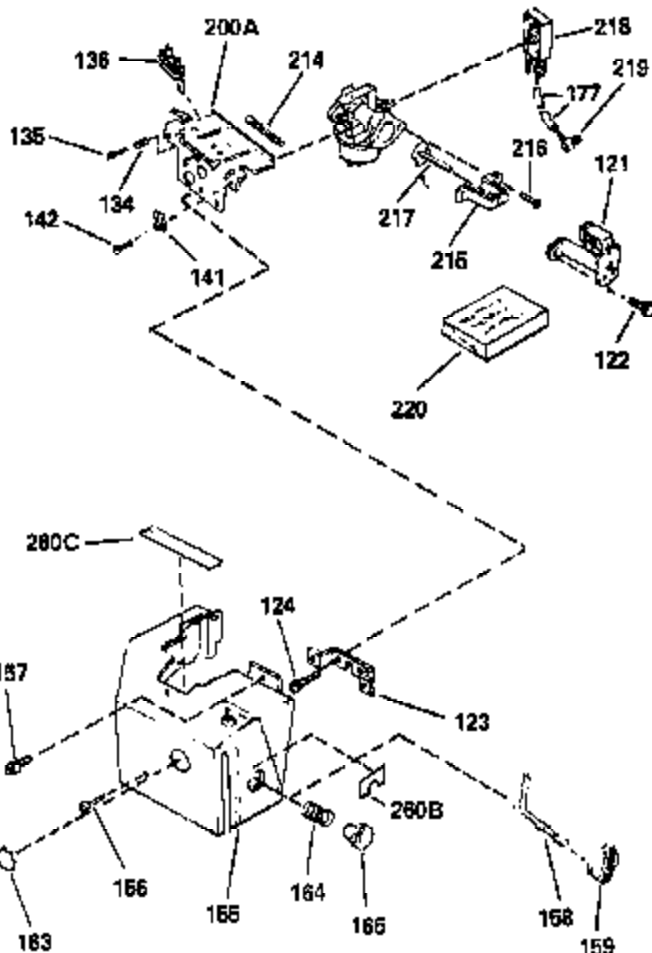
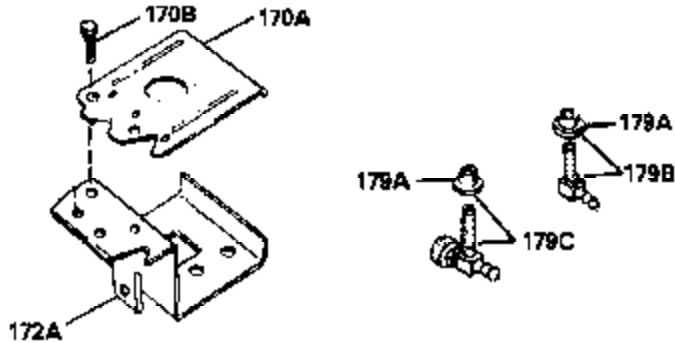
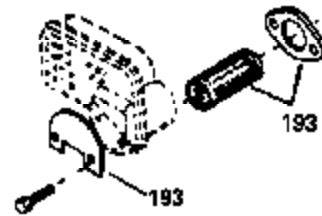

Engine Parts List #2

| Ref # | Part Number | Qty | Description |
|-------|-------------|-----|--|
| 28 | 33627 | | Bearing, Ball |
| 29 | 33628 | | Washer, Thrust |
| 30 | 31855 | | Retainer, Bearing |
| 31 | 650778 | | Nut, Lock, 10-24 |
| 32 | 650580 | | Nut, Lock, 10-23 |
| 136 | 610973 | | Terminal Assy. (Use as required) |
| 158 | 34586 | | Rod, Choke |
| 177 | 29774 | | Fuel Line (Use as required) (8.25") (21 cm) |
| 177 | 30705 | | Fuel Line (Use as required) (16.0") (41 cm) |
| 190C | 650578 | | Screw, 8-18 x 3/8" (Use as required) |
| 190A | 33700 | | Cover & Tube, Muffler (Use as required) |
| 190B | 33323 | | Screen, Muffler (Use as required) |
| 190 | 391026 | | Muffler (Incl. 190A, 190B & 190C) (This spark arrestor muffler can be used on any model) |
| 193 | 34479 | | Spark Arrestor Kit (Fits "L" shaped mufflers) |
| 200 | 730152 | | Control Bracket (Incl. 202 thru 210, 213) |
| 202A | 33578 | | Spring, Governor |
| 202 | 32977 | | Spring, Torsion |
| 203 | 29530 | | Bushing, Bellcrank |
| 204 | 30312 | | Screw, 10-32 x 1/2" |
| 205 | 30201A | | Lever, Speed control |
| 206 | 30199A | | Bracket, RPM adjusting (Incl. 208 & 209) |
| 207 | 650399 | | Screw, 10-32 x 5/8" |
| 208 | 32924 | | Spring, RPM adjusting screw |
| 209 | 650688 | | Screw, 10-32 x 1" |
| 210 | 30712 | | Lever, Bellcrank |
| 211 | 33450 | | Nut, Lock, 10-32 |
| 212 | 33372 | | Link, Governor lever-to-bellcrank |
| 213 | 28562 | | Bushing, RPM adjusting lever |
| 260B | 31752 | | Decal, Air cleaner |

ILLUSTRATION SHOWS TYPICAL PARTS ONLY. ORDER BY PART NUMBER. PARTS NOT LISTED ARE SUPPLIED BY OEM.

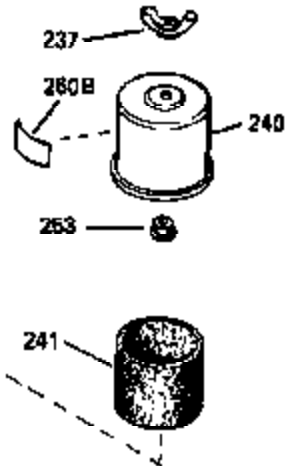
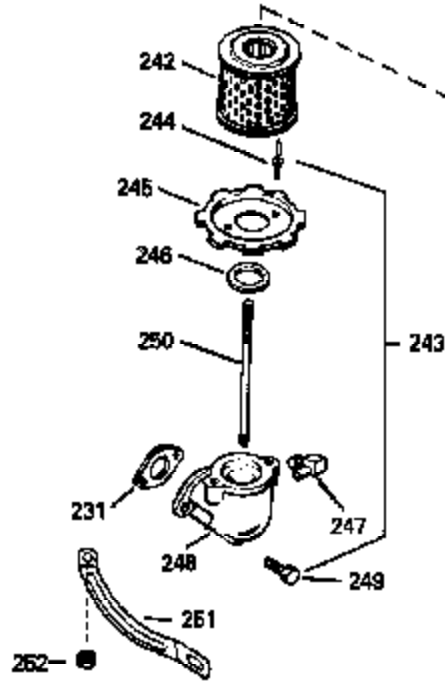
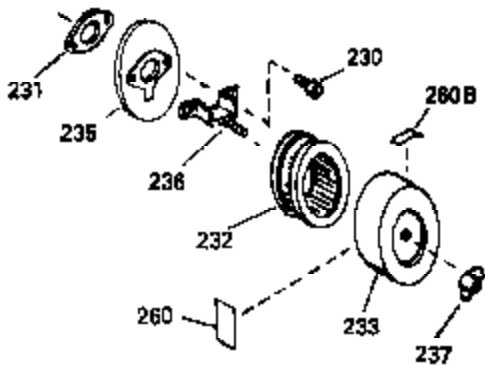
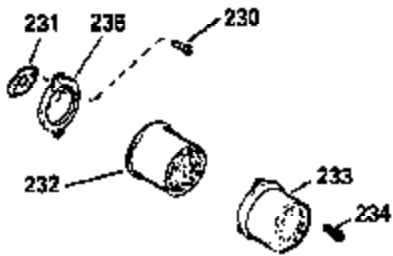

OPTIONAL 110 - 120 VOLT
STARTER MOTOR KIT

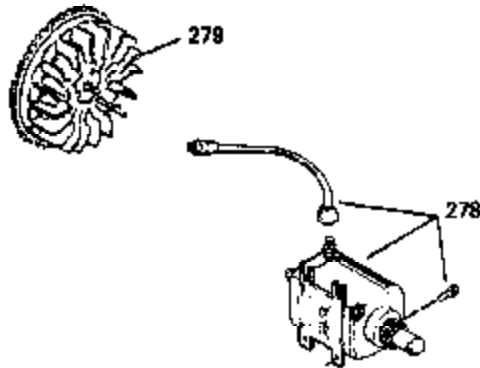

DEBRIS SCREEN KIT

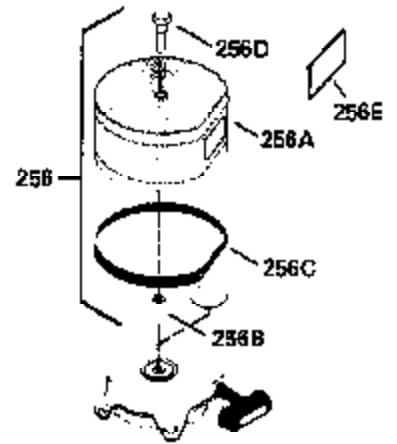

STARTER MUFF KIT

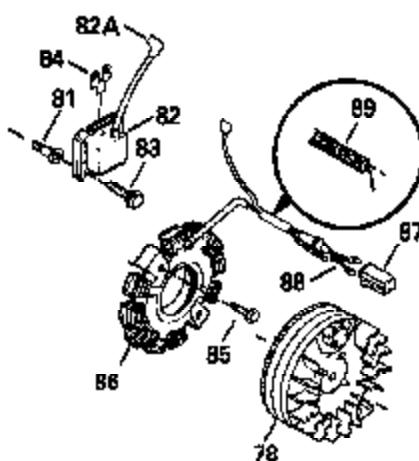
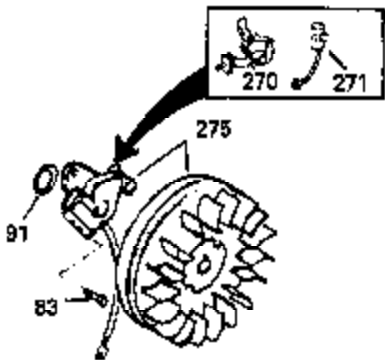
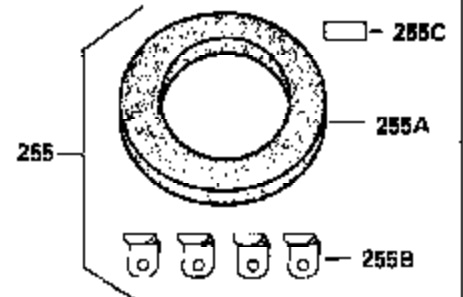

| Ref # | Part Number | Qty | Description |
|-------|-------------|-----|--|
| 82A | 610118 | | Cover, Spark plug (Use as required) |
| 83 | 650516 | | Screw, 1/4-20 x 1-1/8" |
| 90 | 610749 | | Regulator Assy., Rectifier (10 Amp) |
| 230 | 28820 | | Screw, 10-32 x 1/2" |
| 231 | 27272A | | * Gasket, Air cleaner |
| 232 | 33268 | | Element, Air cleaner |
| 233 | 33269A | | Cover, Air cleaner |
| 235 | 33266 | | Bracket, Air cleaner |
| 236 | 33267 | | Bracket, Air cleaner |
| 237 | 650513 | | Nut, Wing, 1/4-20 |
| 254 | 30063 | | Screw, 1/4-20 x 1/2" |
| 255A | 34687 | | Air Cleaner, Starter Can be used on HM70 with diecast starter |
| 255B | 34869 | | Bracket, Starter air cleaner Can be used on HM70 with diecast starter |
| 255C | 34870 | | Instruction Decal Can be used on HM70 with diecast starter. |
| 255 | 730572 | | Starter Muff Kit (Incl. 255A, 255B, & 255C) Can be used on HM70 with diecast starter |
| 256A | 35568 | | Debris Screen Can be used on HM70 with stamped steel recoil starter |
| 256B | 35569 | | Spacer, Screen Can be used on HM70 with stamped steel recoil starter |
| 256E | 34387 | | Instruction Decal Can be used on HM70 with stamped steel recoil starter. |
| 256 | 730573 | | Debris Screen Kit (Incl. 256A thru 256E) Can be used on HM70 with stamped steel recoil starter |
| 256D | 650907 | | Screw, 5/16-18 x 1-5/8" Can be used on HM70 with stamped steel recoil starter |
| 256C | 35570 | | Seal, Screen Can be used on HM70 with stamped steel recoil starter |
| 260B | 31752 | | Decal, Air cleaner |
| 270 | 32434 | | Contact Assy., Breaker |
| 271 | 610767A | | Condenser |
| 275 | 610839 | | Magneto (w/ring gear) (12 Volt, 7 Amp) NOTE: The complete magneto is not available as an assembly. The magneto number is shown for reference purposes only. Order component parts individually, as shown in parts list. (Refer to Division 5, Section B, page 26 for breakdown) |
| 277 | 33605 | | Electric Starter Motor (12 Volt) (Refer to Division 5, Section D, page 20 for breakdown) |
| 278 | 33329D | | Starter Motor Kit (110-120 Volt) This 110-120 volt starter motor kit may have been added to this engine. It can be added only if cylinder has drilled and tapped starter mounting bosses and a ring gear flywheel has been added (see #279). Refer to service number stamped on end cap of motor, or decal for |
| 279 | 610847 | | Flywheel (Ring gear flywheel required on engine using 110-120 Volt starter motor kits listed above.) (Use on Std. point ignition) |

| Ref # | Part Number | Qty | Description |
|-------|-------------|-----|--|
| 279 | 611091 | | Flywheel (Minimum ring gear flywheel required on engine using 110-120 Volt starter motor kits listed above.) (Use on Solid State ignition) |