

RCL 120002
326-3000

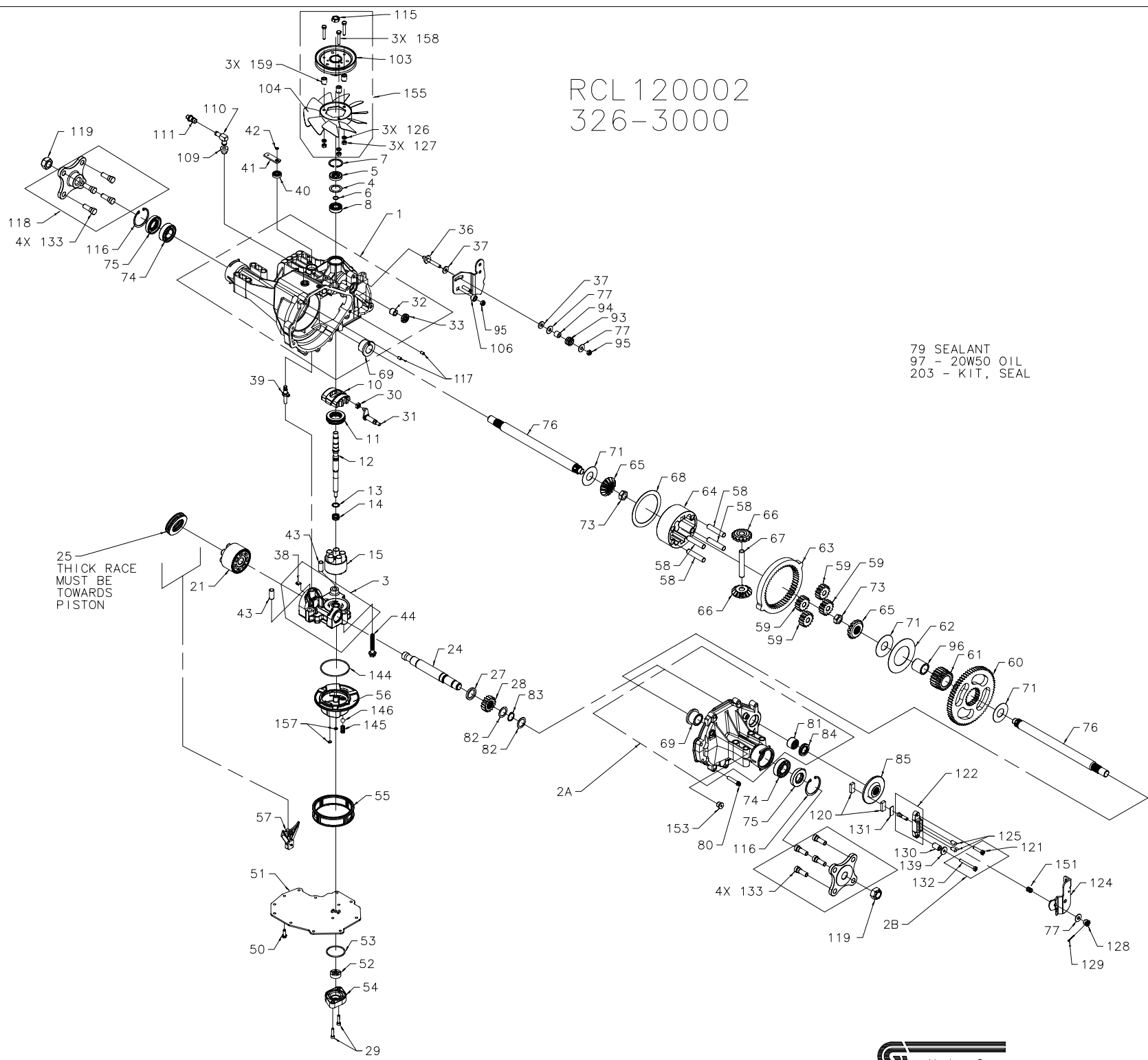

79 SEALANT
97 - 20W50 OIL
203 - KIT, SEAL

25 THICK RACE
MUST BE
TOWARDS
PISTON

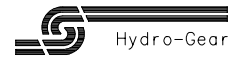

RCL120002 326-3000

ITEM#	PART #	QTY	DESCRIPTION
1	70297	1	MAIN HOUSING ASSEMBLY
		1	MAIN HOUSING
		1	LIP SEAL
		1	FLANGE BEARING
		1	TRUNNION BUSHING
		2	CRADLE BEARING
2A	71120	1	R.H. HOUSING ASSEMBLY
		1	R.H. HOUSING
		1	FLANGE BEARING
		1	NEEDLE BEARING (SCE1412)
		1	LIP SEAL (.875I.D.X1.300.D.X.25)
2B	71139	1	KIT, BRAKE BOLT
		1	BOLT, HEX HD 1/4-20 X 1.25 W/PATCH
		1	BOLT, HEX HD 1/4-20 X 2.25 W/PATCH
3	70683	1	KIT,CENTER SECTION
		1	CENTER SECTION
		1	BUSHING .50X.60X.50
		1	BUSHING .90X1.02X.75
		1	PLATE, BYPASS
		2	CHECK PLUG ASSEMBLY, .027
4	2003018	1	WASHER .98 X 1.37 X .04
5	9008000-0128	1	LIP, SEAL 15 X 35 X 7
6	2003016	1	RING, RETAINING WIRE .52ID
7	2003052	1	RING, RETAINING 37 INT
8	2003043	1	BEARING, BALL 15 X 35 X 11
10	2003087	1	SWASHPLATE, VARIABLE
11	50551	1	BEARING, THRUST 30 X 52 X 13
12	50795	1	SHAFT, INPUT
13	2003017	1	WASHER, THRUST .59 X.78 X .04
14	2003014	1	SPRING, BLOCK
15	70331	1	BLOCK ASSEMBLY, 5 PISTON 10cc
		1	BLOCK CYLINDER, 5 PISTON 10cc
		5	PISTON
		5	SPRING, PISTON
		5	WASHER, PISTON SEAT
21	70082	1	21cc CYLINDER BLOCK ASSEMBLY
		1	21cc CYLINDER BLOCK
		7	21cc PISTON
		7	21cc PISTON SPRING
		7	WASHER, PISTON SEAT
24	50662	1	SHAFT, MOTOR
25	50552	1	BEARING, THRUST 42 X 68 X 16
26	51013	1	ARM, CONTROL
27	50774	1	SPACER, 1.03 X 1.38 X .184
28	50661	1	GEAR, 16T PINION
29	50975	2	SCREW, CAP M6 X 1-25
30	2000015	1	GUIDE, SLOT
31	50807	1	ARM, TRUNNION TAPERED SQUARE
32	2003009	1	BUSHING, TRUNNION
33	9008000-0126	1	SEAL, LIP 12 X 25 X 7
36	50284	1	STUD, DB END 5/16-24 X 2.5 PATCH

ITEM#	PART #	QTY	DESCRIPTION
37	50281	2	PUCK, FRICTION
38	70680	1	KIT, BYPASS PLATE
39	2003555	1	ACTUATOR, BYPASS
40	45074	1	SEAL, LIP 10 X 25 X 7
41	44866	1	ARM, BYPASS
42	44870	1	RING, RETAINING .31 EXT
43	50002	2	PIN-HOLLOW .39 X .5 X 1.12
44	50016	3	HFHCS 3/8-24 X 2.5 PATCH
50	50752	11	HFHCS 1/4-20 X .75 BLK PHOS & OIL
51	50972	1	COVER, LOWER
52	50273	1	GEROTOR TANG X 1.15 S .39 (1.9cc)
53	9004101-1340	1	O-RING .103 X 1.862
54	50260	1	HSG, CHG PUMP
55	70538	1	KIT,FILTER
		2	GASKET, .10X.16X.24
		1	FILTER
56	51156	1	MANIFOLD, CHARGE
57	50796	1	BEARING, MOTOR RETAINER
58	50776	4	PIN, .5 X 2.43
59	50763	4	GEAR, PLANET 15T .5 ID
60	50646	1	GEAR, SPUR 67T 21T ID
61	50645	1	GEAR, SUN 21T 1.31 ID
62	50769	1	WASHER, 2.3 X 4.1 X .05
63	50764	1	GEAR, RING 51T 6.4 OD
64	50765	1	CARRIER, PLANETARY
65	50647	2	GEAR, BEVEL 14T SPLINE ID
66	50648	2	GEAR, BEVEL14T
67	50766	1	SHAFT, DIFFERENTIAL
68	50767	1	PLATE, THRUST 3.46 X 3.39 X .048
69	50768	2	BEARING, FLANGE 1.0 X 1.376 X .99
71	50788	3	WASHER 1.0 X 2.25 X .04
73	50791	2	NUT, HEX 5/8-18 PATCH
74	50771	2	BEARING, BALL 1.0 X 52 X 15
75	50772	2	SEAL, LIP 25 X 52 X 10 TC
76	50825	2	AXLE, 1.0 X 14.2 SPLINED
77	44130	3	WASHER .34 X .88 X .06
79	50928	1	GASKET MATERIAL (LOCTITE 5900)
80	50868	9	THCS-STAP 5/16-18 X 1.5
81	44752	1	BEARING, NEEDLE .875 X 1.125 X .75
82	50777	2	WASHER .88 X 1.25 X .04
83	50775	1	RING, RETAINING .87 EXT
84	50773	1	SEAL, LIP .875 X 1.38 X .25 TC
85	50779	1	DISK, BRAKE
93	50277	1	SPRING, HELICAL COMP
94	50278	1	SPACER, .32 X .59 X .50
95	50108	2	NUT, HEX LOCK 5/16-24 (LOCK)
96	50866	1	BUSHING 1.0 X 1.3 X 1.34
97		122oz	OIL, 20W-50
103	50302	1	PULLEY 4.5 X 1.625
104	50307	1	FAN 7.0 (10 BLADE)

ITEM#	PART #	QTY	DESCRIPTION
106	50850	1	SPACER, TRUNNION
109	50133	1	BUSHING-VENT RUBBER
110	50308	1	FITTING, METAL VENT
111	70109	1	VENT, CAP ASS'Y
		1	VENT, PLASTIC
		1	VENT, CAP
115	44133	1	NUT, HEX 1/2-20 PATCH
116	50859	2	RING, RETAINING 2.06 INT
117	9004800-2506	2	PIN .25 X .375
118	70276	2	KIT, 4 STUD HUB, 7/16-14
		4	HUB, 4 STUD
		1	WHEEL STUD, 7/16-14 X 1.35
119	50863	2	NUT, HEX 3/4-16 LOCK
120	44132	2	PUCK, BRAKE
121	51927	1	BOLT, HEX HD 1/4-20 X 1.25
122	70633	1	YOKE, BRAKE ASSEMBLY
124	50916	1	ARM, BRAKE
125	44127	2	PINS, BRAKE .31 X .73 PLATED
126	43177	3	WASHER, (LOCK) 1/4
127	43178	3	NUT, HEX 1/4-20
128	44142	1	NUT, CASTLE 5/16-24
129	44101	1	PIN, COTTER 3/32 X 3/4
130	23711	1	SPACER, .26 X .57 X .87
131	44134	1	PLATE, PUCK
132	51928	1	BOLT, HEX HD 1/4-20 X 2.25
133	50869	8	STUD 7/16-14 X 1.35 (RIB NECK)
139	44278	1	WASHER, .27 X .88 X .12
144	50974	1	O RING 1.03 X 2.987 70A
145	51157	1	SPRING, RELIEF .42 X .75
146	9001214-4400	1	BALL, STEEL 7/16
151	50919	1	COMP. SPRING, BRAKE ANTI-DRAG
153	9005110-5600	1	PLUG, 9/16-18 (METAL)
157	50977	2	O-RING, .07 X .239 70A
158	44276	3	HHCS 1/4-20 X 1.5 (PATCH)
159	50259	3	SPACER .26 X .57 X .62 (BLACK)
160	70243	1	KIT, FAN/PULLEY
		1	NUT, HEX 1/2-20 PATCH
		1	FAN
		1	PULLEY, 4.5 X 1.625
		3	HHCS1/4-20 X 1.5 (PATCH)
		3	NUT, HEX 1/4-20
		3	WASHER (LOCK) 1/4
		3	SPACER .26 X .57 X .62 (BLACK)
		1	KIT, SEAL
		1	SEAL-LIP 15X5X37
		1	SEAL-LIP 12X25X7
		1	SEAL-LIP 10X25X7
		1	O-RING, .103X1.862
		2	SEAL 25X52X10
		1	LIP SEAL (.875I.D.X1.30.D.X.25)
		4	O-RING, .070X.239
		1	KIT, O-RING, MANIFOLD
		1	PIN, SPRING 5/16 X 1.75
		1	PIN, SPRING 1/4 X 1.00
203	70492	1	

