

K1082-11111
315-2000

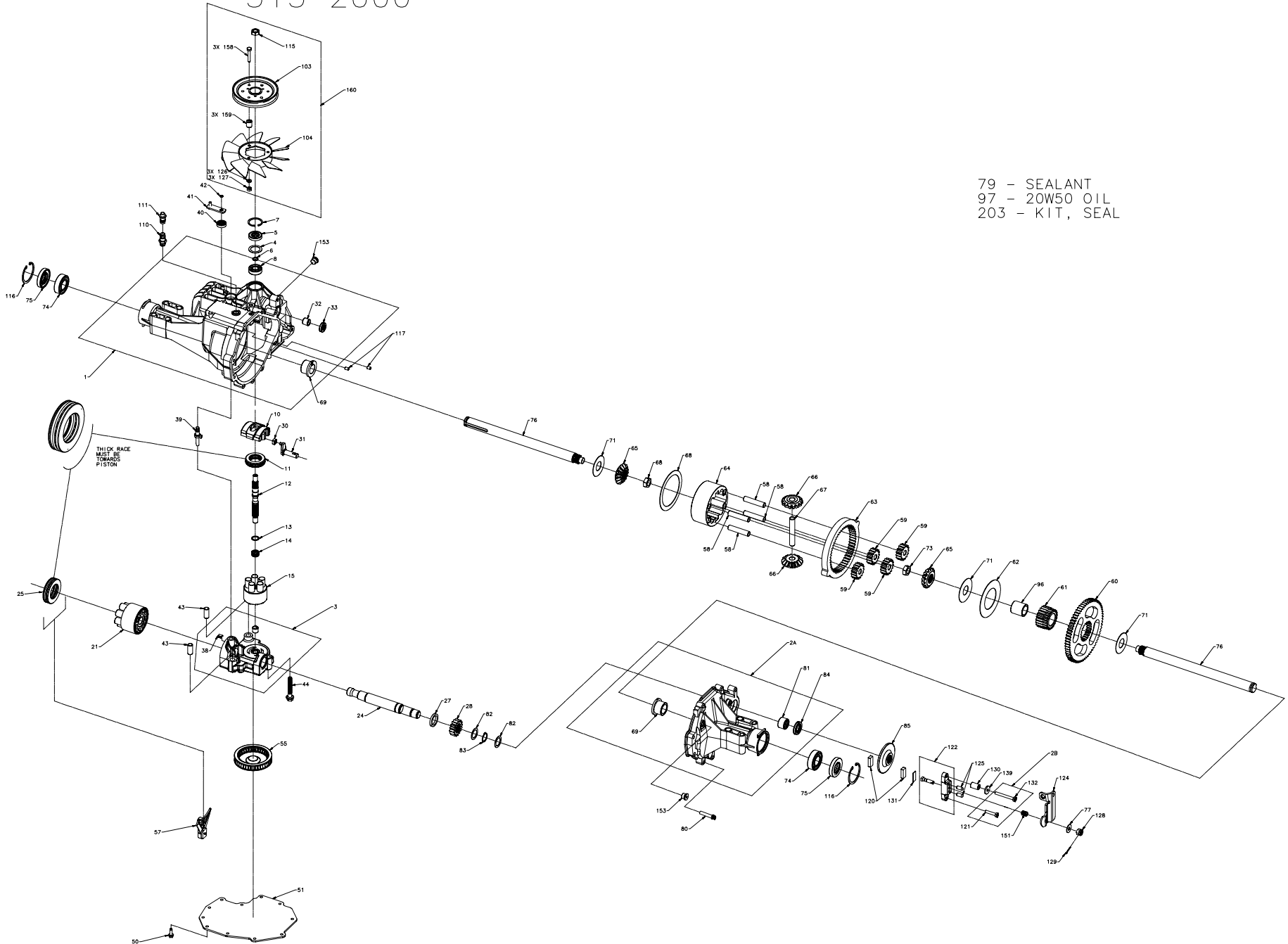

79 - SEALANT
97 - 20W50 OIL
203 - KIT, SEAL

THICK RACE
MUST BE
TOWARDS
PISTON

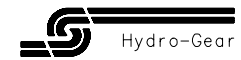

K1082-11111
315-2000

ITEM #	PART #	QTY	DESCRIPTION
1	70433	1	HOUSING, MAIN ASSEMBLY
		1	HOUSING, MAIN
		2	BEARING, CRADLE
		1	BUSHING, TRUNNION
		1	SEAL, LIP 12X25X7
		1	BEARING, FLANGE
2A	71120	1	HOUSING, R.H. ASSEMBLY
		1	SEAL, LIP .875X1.375X.250
		1	HOUSING, R.H
		1	BEARING, FLANGE
		1	BEARING, NEEDLE .875X1.125X.750
2B	71139	1	KIT, BRAKE BOLT
		1	BOLT, HEX HD 1/4-20 X 1.25 W/PATCH
		1	BOLT, HEX HD 1/4-20 X 2.25 W/PATCH
3	70682	1	CENTER SECTION ASSEMBLY
		1	CENTER SECTION
		1	BUSHING .90X1.02X.75
		1	PLATE, BYPASS
		2	CHECK PLUG ASSEMBLY, .027
4	2003018	1	SPACER
5	9008000-0128	1	SEAL, LIP 15X35X7
6	2003016	1	RING, WIRE RETAINING
7	2003052	1	RING, RETAINING
8	2003043	1	BEARING, BALL 15X25X11
10	2003087	1	SWASHPLATE, VARIABLE
11	50551	1	BEARING, THRUST 30X52X13
12	50005	1	SHAFT, INPUT
13	2003017	1	WASHER, BLOCK THRUST
14	2003014	1	SPRING, BLOCK
15	70331	1	BLOCK, 10cc CYLINDER ASSEMBLY
		1	BLOCK, 10cc CYLINDER
		5	PISTON, 10cc
		5	SPRING, 10cc PISTON
		5	WASHER, PISTON SEAT
21	70082	1	BLOCK, 21cc CYLINDER ASSEMBLY
		1	BLOCK, 21cc CYLINDER
		7	PISTON, 21cc
		7	SPRING, 21cc PISTON
		7	WASHER, PISTON SEAT
24	50662	1	SHAFT, OUTPUT
25	50552	1	BEARING, THRUST 42X68X16
27	50774	1	SPACER
28	50661	1	GEAR, 16T PINION
30	2000015	1	GUIDE, SLOT
31	2003005	1	ARM, TRUNNION
32	2003009	1	BUSHING, TRUNNION
33	9008000-0126	1	SEAL, LIP 12X25X7
38	70680	1	KIT, BYPASS PLATE
39	2003555	1	ACTUATOR, BYPASS
40	45074	1	SEAL, LIP 10X25X7
41	50126	1	ARM, BYPASS
42	44870	1	RING, RETAINING
43	50002	2	PIN
44	50016	3	SCREW 3/8-24X2.5
50	50752	11	SCREW 1/4-20X.75
51	51128	1	COVER, LOWER
55	50990	1	FILTER

ITEM #	PART #	QTY	DESCRIPTION
57	50796	1	RETAINER, MOTOR BEARING
58	50776	4	PIN, CARRIER
59	50763	4	GEAR, 15T PLANET
60	50646	1	GEAR, 67T SPUR
61	50645	1	GEAR, 21 TOOTH SUN
62	50769	1	PLATE, PLANET THRUST
63	50764	1	GEAR, 51T RING
64	50765	1	CARRIER, PLANETARY
65	50647	2	GEAR, MITER DIFF.(SPLINED)
66	50648	2	GEAR, MITER DIFF.
67	50766	1	SHAFT DIFFERENTIAL
68	50767	1	PLATE, DIFF. THRUST
69	50768	2	BEARING, FLANGE
71	50788	3	WASHER 1.0X2.25X.04
73	50791	2	NUT, HEX JAM 5/8-18
74	50771	2	BEARING, BALL 25.4X52X15
75	50772	2	SEAL, 1.000X2.049X.375
76	50663	2	SHAFT, AXLE
77	44130	1	WASHER .34X.88X.06
79	50928	1	SEALANT
80	50868	9	SCREW, TORX HEAD 5/16-18
81	44752	1	BEARING, NEEDLE .875X1.125X.750
82	50777	2	WASHER .88X1.25X.04
83	50775	1	RING, RETAINING
84	50773	1	SEAL, LIP .875X1.375X.250
85	50779	1	DISK, BRAKE
96	50866	1	BEARING, SLEEVE 1.0X1.31X1.34
97		126.7oz	20W-50 OIL
103	51597	1	PULLEY, 4.75" ASS'Y
104	50307	1	FAN, 7.0" (10 BLADE)
110	70110	1	FITTING, O-RING ASS'Y
		1	FITTING, PLASTIC HOSE
		1	O-RING
111	70109	1	VENT, CAP ASS'Y
		1	VENT, PLASTIC
		1	VENT, CAP
115	44133	1	NUT, JAM
116	50859	2	RING, RETAINING
117	9004800-2506	2	PIN STD HDLS
120	44132	2	PUCK, BRAKE
121	51927	1	BOLT, HEX HD 1/4-20 X 1.25 W/PATCH
122	70633	1	YOKE, BRAKE ASSEMBLY
124	50911	1	ARM, BRAKE
125	44127	2	PINS, BRAKE
126	43177	3	LOCKWASHER, 1/4"
127	43178	3	NUT, 1/4-20
128	44142	1	NUT, CASTLE
129	44101	1	PIN, COTTER
130	23711	1	SPACER
131	44134	1	PLATE, PUCK
132	51928	1	BOLT, HEX HD 1/4-20 X 2.25 W/PATCH
139	44278	1	WASHER, .875X.265X.125
151	50919	1	SPRING, COMP. BRAKE ANTI-DRAW
153	9005110-5600	2	PLUG, STRAIGHT THREAD
158	44276	3	BOLT, 1/4-20 X 1.50 W/PATCH
159	50259	3	SPACER
160	71166	1	KIT, FAN/PULLEY
		1	PULLEY, 4.75" ASS'Y
		1	FAN, 7.0" (10 BLADE)
		1	NUT, JAM
		3	LOCKWASHER, 1/4"
		3	NUT, 1/4-20
		3	BOLT, 1/4-20 X 1.50 W/PATCH
		3	SPACER
203	70492	1	KIT, SEAL

