

178892
333-3000

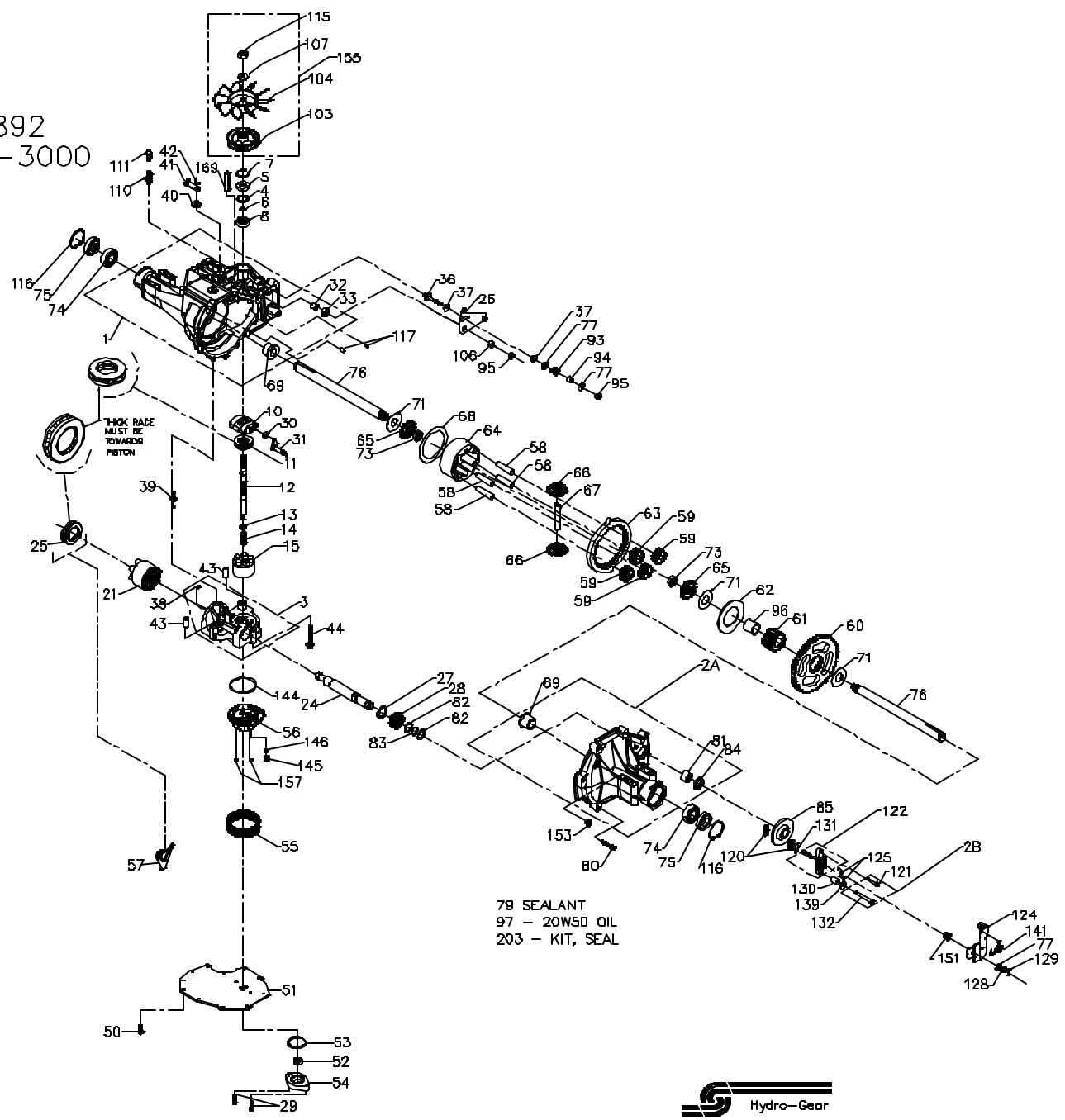

178892
333-3000

ITEM #	PART #	QTY	DESCRIPTION
1	70297	1	HOUSING, MAIN ASSEMBLY
		1	HOUSING, MAIN
		1	SEAL, LIP 1.25X25X7
		1	BEARING, FLANGE
		2	CRADLE BEARING
		1	BUSHING, TRUNNION
2A	7112D	1	HOUSING, R.H. ASSEMBLY
		1	HOUSING, R.H.
		1	BEARING, FLANGE
		1	BEARING, NEEDLE .875X1.125X.75D
		1	SEAL, LIP .875X1.375X.250
2B	7113D	1	KIT, BRAKE BOLT
		1	BOLT, HEX HD 1/4-20 X 1.25 W/PATCH
		1	BOLT, HEX HD 1/4-20 X 2.25 W/PATCH
3	70684	1	KIT, CENTER SECTION
		1	CENTER SECTION
		1	BUSHING .50X.80X.5D
		1	BUSHING .90X1.02X.75
		1	PLATE, BYPASS
		1	CHECK PLUG ASSEMBLY, .044
		1	CHECK PLUG ASSEMBLY, NO BLEED
4	2003018	1	SPACER
5	8008000-D12B	1	SEAL, LIP 15X35X7
6	2003016	1	RING, WIRE RETAINING
7	2003052	1	RING, RETAINING
8	2003043	1	BEARING, BALL 15X35X11
10	2003067	1	SWASHPLATE, VARIABLE
11	50551	1	BEARING, THRUST 30X52X13
12	50785	1	SHAFT, INPUT
13	2003017	1	WASHER, BLOCK THRUST
14	2003014	1	SPRING, BLOCK
15	70331	1	BLOCK, 10cc CYLINDER ASSEMBLY
		1	BLOCK, 10cc CYLINDER
		5	PISTON, 10cc
		5	SPRING, 10cc PISTON
		5	WASHER, PISTON SEAT
21	70082	1	BLOCK, 21cc CYLINDER ASSEMBLY
		1	BLOCK, 21cc CYLINDER
		7	WASHER, PISTON SEAT
		7	PISTON, 21cc
		7	SPRING, 21cc PISTON
24	50662	1	SHAFT, MOTOR
25	50552	1	BEARING, THRUST 42X68X16
26	80887	1	ARM, CONTROL
27	50774	1	SPACER
28	50681	1	GEAR, 18T PINION
29	50875	2	CAPSCREW, MBX1-22
30	20001015	1	GUIDE, SLOT
31	50897	1	ARM, TRUNNION
32	2003009	1	BUSHING, TRUNNION
33	8008000-D12B	1	SEAL, LIP 1.25X25X7
36	80284	1	STUD 5/16-24
37	80281	2	PLUG, FRICTION
38	70680	1	KIT, BYPASS PLATE
39	2003555	1	ACTUATOR, BYPASS
40	45074	1	SEAL, LIP 1.0X25X7
41	5027D	1	ARM, BYPASS
42	4487D	1	RING, RETAINING
43	30002	2	PIN
44	80016	3	SCREW 3/8-24X2.5

ITEM #	PART #	QTY	DESCRIPTION
50	50752	11	SCREW 1/4-20X.75
51	50872	1	COVER, LOWER
52	50275	1	GEROTOR ASSEMBLY
53	8004101-1340	1	O-RING .03X1.862
54	5026D	1	GEROTOR COVER
55	7063B	1	KIT, FILTER
		2	BASKET .10X.16X4.24
		1	FILTER
56	51158	1	MANIFOLD, CHARGE
57	50798	1	RETAINER, MOTOR BEARING
58	50778	4	PIN, CARRIER
59	50763	4	GEAR, 15T PLANET
60	50848	1	GEAR, 8T SPUR
61	80846	1	GEAR, 21 TOOTH SUN
62	50769	1	PLATE, PLANET THRUST
63	50764	1	GEAR, 51T RING
64	50785	1	CARRIER, PLANETARY
65	50847	2	GEAR, MITER DIFF. (SPLINED)
66	50848	2	GEAR, MITER DIFF.
67	50768	1	SHAFT, DIFFERENTIAL
68	50767	1	PLATE, DIFF. THRUST
69	80768	2	BEARING, FLANGE
71	80788	3	WASHER 1.0X2.25X.04
73	50791	2	NUT, HEX JAM 5/8-18
74	50771	2	BEARING, BALL 25.4X52X15
75	50772	2	SEAL 1.00X2.048X.375
76	50663	2	SHAFT, AXLE
77	4413D	3	WASHER .34X.68X.06
78	50825	1	SEALANT
80	80868	9	SCREW, TORX HEAD 8/16-18
81	44782	1	BEARING, NEEDLE .875X1.125X.75D
82	50777	2	WASHER .88X1.25X.04
83	50775	1	RING, RETAINING
84	50773	1	SEAL, LIP .875X1.30X.25
85	50778	1	DISK, BRAKE
86	50277	1	SPRING, FRICTION PACK
87	50275	1	SPACER, FRICTION PACK
88	80108	2	NUT, HEX LDGK 8/16-24
89	80866	1	BEARING, SLEEVE 1.0X1.31X1.34
97		12Z OZ	Oil-20W50
103	51231	1	PULLEY 3.88
104	5123D	1	FAN 7.0, 10 BLADE
106	50850	1	SPACER, TRUNNION
107	51523	1	WASHER, OD SLOTTED .53X1.63X.06
110	70110	1	FITTING, O-RING ASS'Y
		1	FITTING, PLASTIC HOSE
		1	O-RING
111	70109	1	VENT, CAP ASS'Y
		1	VENT, PLASTIC
		1	VENT, CAP
		1	HEX NUT 1/2-20
115	44133	1	HEX NUT 1/2-20
118	50859	2	RING, RETAINING
117	9004800-2508	2	PIN, STD HDLS
120	44132	2	PLUG, BRAKE
121	51827	1	BOLT, HEX HD 1/4-20 X 1.25 W/PATCH
122	70633	1	YOKK, BRAKE ASSEMBLY
124	50916	1	ARM, BRAKE
125	44127	2	PINS, BRAKE

ITEM #	PART #	QTY	DESCRIPTION
128	44142	1	NUT, CASTLE
129	44101	1	PIN, COTTER
130	23711	1	SPACER
131	44134	1	PLATE, PUCK
132	81528	1	BOLT, HEX HD 1/4-20 X 2.25 W/PATCH
139	44278	1	WASHER .875X.265X.125
141	50884	1	SPRING, BRAKE
144	50974	1	O RING .103X2.987
145	51157	1	SPRING, RELIEF
146	8001214-4400	1	BALL 7/16
151	80919	1	SPRING, COMP. BRAKE ANTI-DRAW
153	9008110-8500	1	PLUG, STRAIGHT THREAD
155	7048D	1	KIT, FAN/PULLEY
		1	NUT, JAM 1/2-20
		1	WASHER .531 X 1.25 X 0.92 (BELLEVILLE)
		1	PULLEY
		2	FAN
157	80877	2	O-RING .070X.238
169	51483	1	PIN, SPRING 5/16 x 1.75
203	70482	1	KIT, SEAL
		1	SEAL-LIP 15X35X7
		1	SEAL-LIP 12X20X7
		1	SEAL-LIP 10X25X7
		1	O-RING .103X1.862
		2	SEAL 25X52X10
		1	LIP SEAL .875 ID X 1.3 O.D. X .25)
		4	O-RING .070X.238
		1	KIT, O-RING, MANIFOLD

