

176056
331-3000

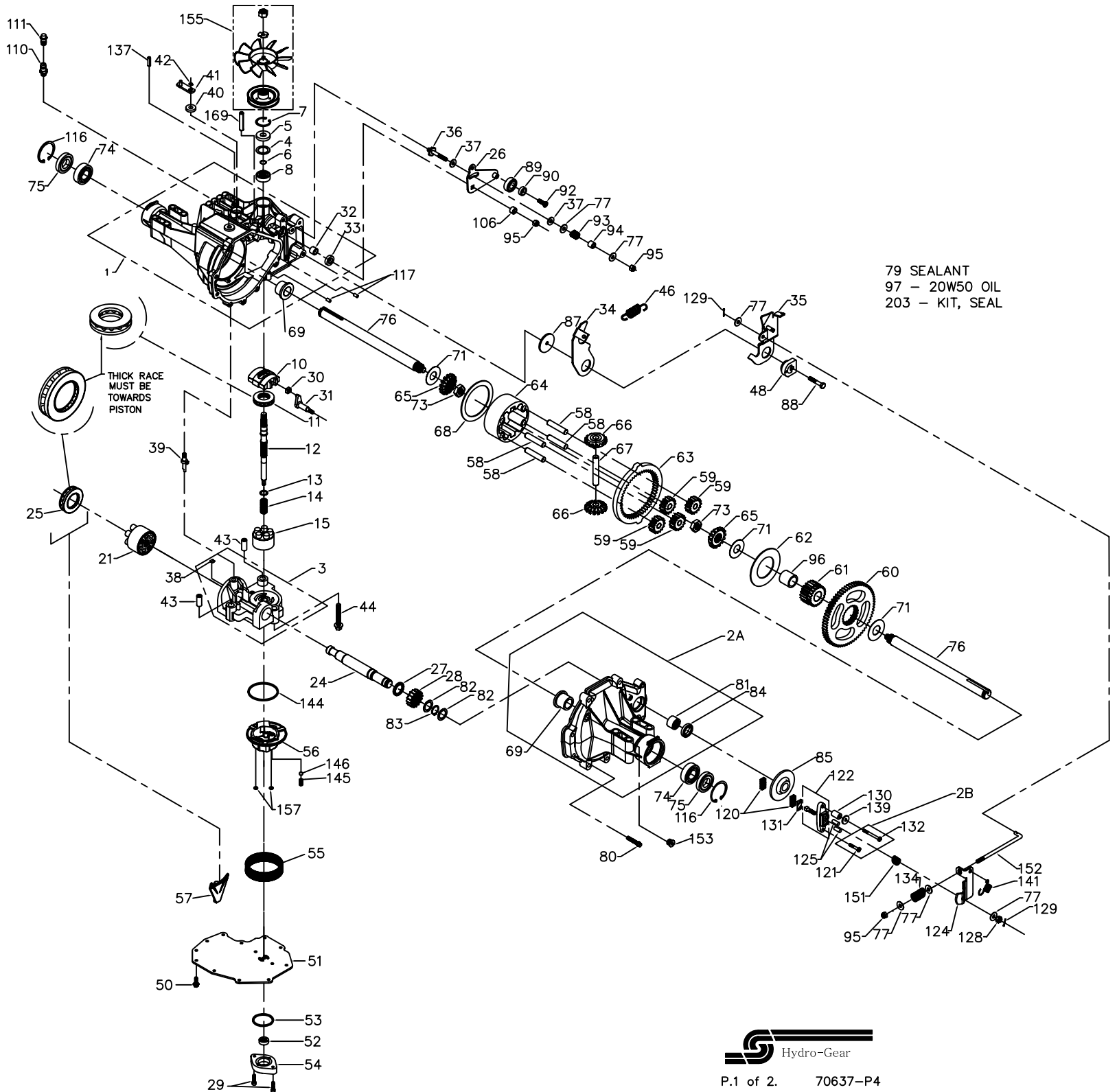

79 SEALANT
97 - 20W50 OIL
203 - KIT, SEAL

THICK RACE
MUST BE
TOWARDS
PISTON

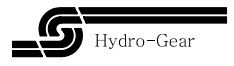

For Hydro-Gear Parts Call K&T 606-678-9623 or 606-561-4983

www.mymowerparts.com

176056
331-3000

For Hydro-Gear Parts Call K&T 606-678-9623 or 606-561-4983

www.mymowerparts.com

| ITEM # | PART # | QTY | DESCRIPTION |
|--------|--------------|-----|------------------------------------|
| 1 | 70297 | 1 | MAIN HOUSING ASSEMBLY |
| | | 1 | MAIN HOUSING |
| | | 1 | LIP SEAL |
| | | 1 | FLANGE BEARING |
| | | 1 | TRUNNION BUSHING |
| 2A | 71120 | 2 | CRADLE BEARING |
| | | 1 | KIT, R.H. HOUSING |
| | | 1 | R.H. HOUSING |
| | | 1 | FLANGE BEARING |
| | | 1 | NEEDLE BEARING (SCE1412) |
| | | 1 | LIP SEAL (.875I.D.x1.30.D.x.25) |
| 2B | 71139 | 1 | KIT, BRAKE BOLT |
| | | 1 | BOLT, HEX HD 1/4-20 X 1.25 W/PATCH |
| | | 1 | BOLT, HEX HD 1/4-20 X 2.25 W/PATCH |
| 3 | 70684 | 1 | KIT, CENTER SECTION |
| | | 1 | CENTER SECTION |
| | | 1 | BUSHING .50X.60X.50 |
| | | 1 | BUSHING .90X1.02X.75 |
| | | 1 | PLATE, BYPASS |
| | | 1 | CHECK PLUG ASSEMBLY, .044 |
| | | 1 | CHECK PLUG ASSEMBLY, NO BLEED |
| 4 | 2003018 | 1 | SPACER |
| 5 | 9008000-0128 | 1 | LIP, SEAL 15 X 35 X 7 |
| 6 | 2003016 | 1 | RING, WIRE RETAINING |
| 7 | 2003052 | 1 | RING, RETAINING |
| 8 | 2003043 | 1 | BEARING, BALL .59 X 1.38 X .43 |
| 10 | 2003087 | 1 | SWASHPLATE, VARIABLE |
| 11 | 50551 | 1 | BEARING, THRUST 30 X 52 X 13 |
| 12 | 50795 | 1 | SHAFT, INPUT |
| 13 | 2003017 | 1 | WASHER, THRUST .591X.787X.040 |
| 14 | 2003014 | 1 | SPRING, BLOCK |
| 15 | 70331 | 1 | 10cc CYLINDER BLOCK ASSEMBLY |
| | | 1 | 10cc CYLINDER BLOCK |
| | | 5 | 10cc PISTON |
| | | 5 | 10cc PISTON SPRING |
| | | 5 | PISTON SEAT WASHER |
| 21 | 70082 | 1 | 21cc CYLINDER BLOCK ASSEMBLY |
| | | 1 | 21cc CYLINDER BLOCK |
| | | 7 | PISTON SEAT WASHER |
| | | 7 | 21cc PISTON |
| | | 7 | 21cc PISTON SPRING |
| 24 | 50662 | 1 | SHAFT, MOTOR |
| 25 | 50552 | 1 | BEARING, THRUST 42 X 68 X 16 |
| 26 | 50857 | 1 | ARM, CONTROL |
| 27 | 50774 | 1 | SPACER |
| 28 | 50661 | 1 | GEAR, 16T PINION |
| 29 | 50975 | 2 | CAPSCREW, M6 X 1-25 |
| 30 | 2000015 | 1 | SLOT GUIDE |
| 31 | 50807 | 1 | ARM, TRUNNION TAPERED SQUARE |
| 32 | 2003009 | 1 | BUSHING, TRUNNION |
| 33 | 9008000-0126 | 1 | SEAL, LIP 12 X 25 X 7 |
| 34 | 50831 | 1 | ARM, RETURN |
| 35 | 50832 | 1 | ARM, ACTUATING |
| 36 | 50284 | 1 | STUD, 5/16-24 |
| 37 | 50281 | 2 | PCK, FRICTION |
| 38 | 70680 | 1 | KIT, BYPASS PLATE |
| 39 | 2003555 | 1 | ACTUATOR, BYPASS |
| 40 | 45074 | 1 | SEAL, LIP 10 X 25 X 7 |
| 41 | 50270 | 1 | ARM, BYPASS |

| ITEM # | PART # | QTY | DESCRIPTION |
|--------|--------------|-------|--------------------------------|
| 42 | 44870 | 1 | RING, RETAINING |
| 43 | 50002 | 2 | PIN |
| 44 | 50016 | 3 | SCREW 3/8-24 X 2.5 |
| 46 | 50833 | 1 | SPRING, NEUTRAL |
| 48 | 50835 | 1 | PUCK, ADJUSTING |
| 50 | 50752 | 11 | SCREW, 1/4-20 X .75 |
| 51 | 50972 | 1 | COVER, LOWER |
| 52 | 50273 | 1 | GEROTOR ASSEMBLY |
| 53 | 9004101-1340 | 1 | O-RING |
| 54 | 50260 | 1 | COVER, GEROTOR |
| 55 | 70538 | 1 | KIT, FILTER |
| | | 2 | GASKET .10X.16X4.24 |
| | | 1 | FILTER |
| 56 | 51156 | 1 | MANIFOLD, CHARGE |
| 57 | 50796 | 1 | BEARING, MOTOR RETAINER |
| 58 | 50776 | 4 | PIN, CARRIER |
| 59 | 50763 | 4 | GEAR, 15T PLANET |
| 60 | 50646 | 1 | GEAR, 67T SPUR |
| 61 | 50645 | 1 | GEAR, 21 TOOTH SUN |
| 62 | 50769 | 1 | PLATE, PLANET THRUST |
| 63 | 50764 | 1 | GEAR, 51T RING |
| 64 | 50765 | 1 | CARRIER, PLANETARY |
| 65 | 50647 | 2 | GEAR, MITER DIFF. (SPLINED) |
| 66 | 50648 | 2 | GEAR, MITER DIFF. |
| 67 | 50766 | 1 | SHAFT, DIFFERENTIAL |
| 68 | 50767 | 1 | PLATE, DIFF. THRUST |
| 69 | 50768 | 2 | BEARING, FLANGE |
| 71 | 50788 | 3 | WASHER 1.0 X 2.25 X .04 |
| 73 | 50791 | 2 | NUT, HEX JAM 5/8-18 |
| 74 | 50771 | 2 | BEARING, BALL 6205-1 |
| 75 | 50772 | 2 | SEAL 1"ID x 2.0472" x .375" |
| 76 | 50663 | 2 | SHAFT, AXLE |
| 77 | 44130 | 6 | WASHER .343 X .880 X .062 |
| 79 | 50928 | 1 | SEALANT |
| 80 | 50868 | 9 | SCREW, TORX HEAD 5/16-18 |
| 81 | 44752 | 1 | BEARING, NEEDLE (SCE1412) |
| 82 | 50777 | 2 | WASHER .885 X 1.250 X .038 |
| 83 | 50775 | 1 | RING, RETAINING |
| 84 | 50773 | 1 | SEAL, LIP .875I.D.x1.30.D.x.25 |
| 85 | 50779 | 1 | DISK, BRAKE |
| 87 | 50836 | 1 | WASHER .324 X 1.960 X .146 |
| 88 | 50837 | 1 | SCREW, 5/16-24 x 1-1/2 |
| 89 | 44147 | 1 | BEARING |
| 90 | 50839 | 1 | SPACER, LOCATING |
| 92 | 50870 | 1 | SCREW, COUNTERSUNK 5/16-18 |
| 93 | 50277 | 1 | SPRING |
| 94 | 50278 | 1 | SPACER |
| 95 | 50108 | 3 | NUT, HEX LOCK 5/16-24 |
| 96 | 50866 | 1 | BEARING, SLEEVE |
| 97 | | 122oz | 20W-50 OIL |
| 106 | 50850 | 1 | SPACER, TRUNNION |
| 108 | 9005200-5600 | 1 | PLUG, PLASTIC |

| ITEM # | PART # | QTY | DESCRIPTION |
|--------|--------------|-----|--------------------------------------|
| 110 | 70110 | 1 | FITTING, O-RING ASS'Y |
| | | 1 | FITTING, PLASTIC HOSE |
| | | 1 | O-RING |
| 111 | 70109 | 1 | VENT, CAP ASS'Y |
| | | 1 | VENT, PLASTIC |
| | | 1 | VENT, CAP |
| 116 | 50859 | 2 | RING, RETAINING |
| 117 | 9004800-2506 | 2 | PIN, STD HDLS |
| 120 | 44132 | 2 | PUCK, BRAKE |
| 121 | 51927 | 1 | BOLT, HEX HD 1/4-20 X 1.25 W/PATCH |
| 122 | 70633 | 1 | YOKE, BRAKE ASSEMBLY |
| 124 | 50911 | 1 | ARM, BRAKE |
| 125 | 44127 | 2 | PINS, BRAKE |
| 128 | 44142 | 1 | NUT, CASTLE 5/16-24 |
| 129 | 44101 | 2 | PIN, COTTER |
| 130 | 23711 | 1 | SPACER |
| 131 | 44134 | 1 | PUCK, PLATE |
| 132 | 51928 | 1 | BOLT, HEX HD 1/4-20 X 2.25 W/PATCH |
| 134 | 50915 | 1 | SPRING, BRAKE |
| 137 | 50882 | 1 | PIN, SPRING |
| 139 | 44278 | 1 | WASHER, 7/8OD X .265ID X .125 THK |
| 141 | 50884 | 1 | SPRING, BRAKE ARM BIAS |
| 144 | 50974 | 1 | O RING, 2.987 ID .103 THK |
| 145 | 51157 | 1 | SPRING, RELIEF |
| 146 | 9001214-4400 | 1 | BALL, 7/16 |
| 151 | 50919 | 1 | COMP. SPRING, BRAKE ANTI-DRAG |
| 152 | 50914 | 1 | BRAKE PULL ROD |
| 153 | 9005110-5600 | 1 | PLUG, STRAIGHT THREAD |
| 155 | 70460 | 1 | KIT, FAN/PULLEY |
| | | 1 | NUT, JAM 1/2-20 |
| | | 1 | WASHER, OD SLOTTED, .53 X 1.63 X .06 |
| | | 1 | PULLEY |
| | | 1 | FAN |
| 157 | 50977 | 2 | O-RING, .070 X .239 |
| 169 | 51463 | 1 | PIN, SPRING 5/16 X 1.75 |
| 203 | 70492 | 1 | KIT, SEAL |
| | | 1 | SEAL-LIP 15X5X37 |
| | | 1 | SEAL-LIP 12X25X7 |
| | | 1 | SEAL-LIP 10X25X7 |
| | | 1 | O-RING, .103X1.862 |
| | | 2 | SEAL 25X52X10 |
| | | 1 | LIP SEAL (.875 I.D.X1.3 O.D. X.25) |
| | | 4 | O-RING, .070X.239 |
| | | 1 | KIT, O-RING, MANIFOLD |
| | | 1 | PIN, SPRING 5/16 X 1.75 |
| | | 1 | PIN, SPRING 1/4 X 1.00 |

