

110421
317-2200R

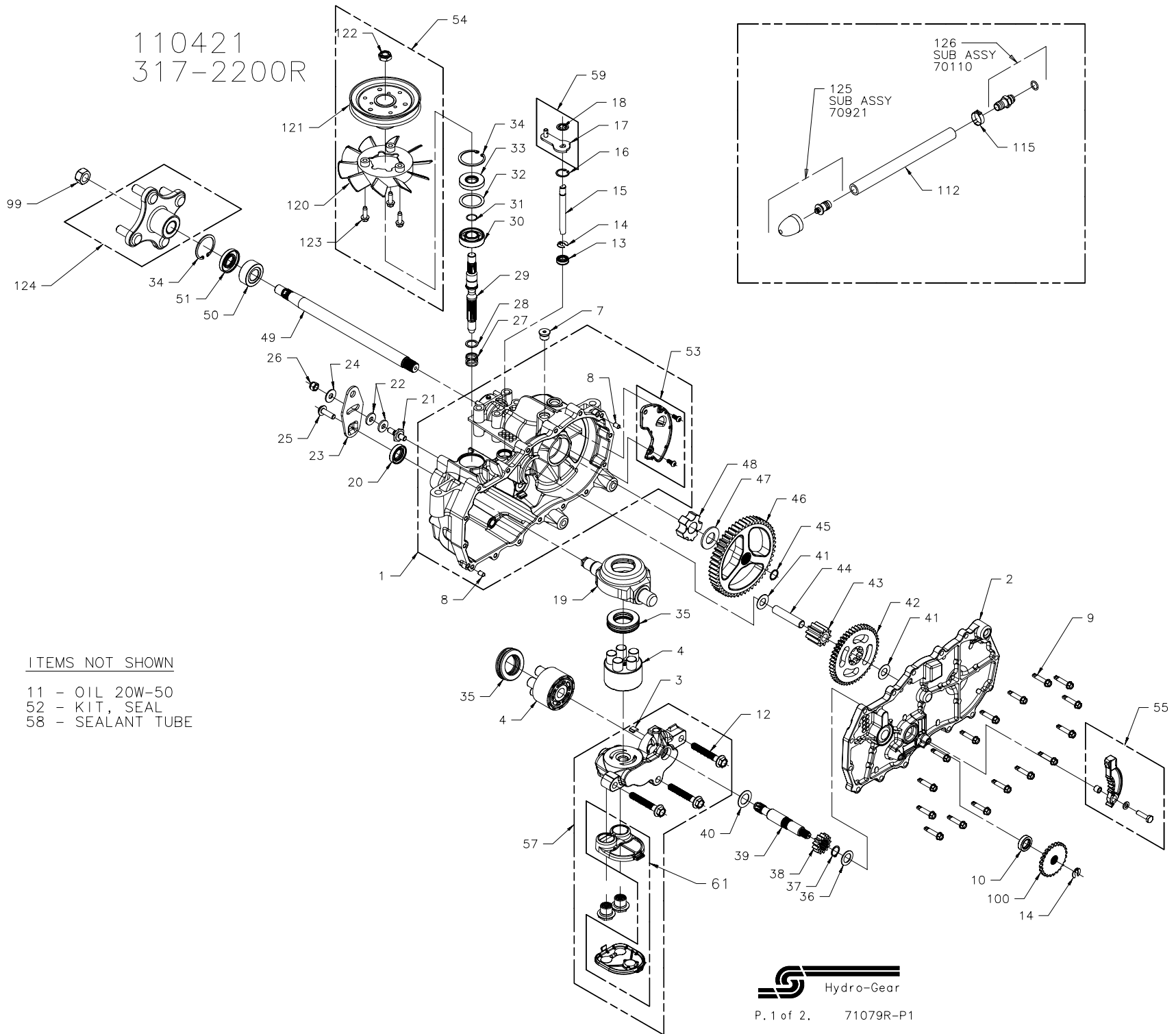

ITEMS NOT SHOWN

- 11 - OIL 20W-50
- 52 - KIT, SEAL
- 58 - SEALANT TUBE

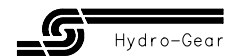

110421
317-2200R

ITEM	PART #	QTY	DESCRIPTION
1	70862R	1	ASSEMBLY, MAIN HOUSING-RH
		1	HOUSING, MAIN RH-MACHINED
		1	BUSHING, .865 X .985 X .790
		1	PLATE, EXPANSION RH
		1	SCREW, 10-32 X 1/2 (SELF-TAPPING)
		1	PIN, STANDARD, HEADLESS
		1	SEALANT TUBE, 10.3 oz
		1	SEAL, LIP .375 X .75 X .25
2	70863R	1	ASSEMBLY, SIDE-RH
		1	HOUSING, SIDE RH-MACHINED
		1	BUSHING, .624 X .719 X .562
		1	BUSHING, .865 X .985 X .790
3	51448	1	PLATE, BYPASS
4	70331	2	ASSEMBLY, BLOCK
		1	BLOCK, CYLINDER
		1	PISTON
		1	SPRING, COMPRESSION
		1	WASHER, THRUST
7	9005110-5600	1	PLUG, SAE #6
8	9004800-2506	2	PIN, STAINLESS, HEADLESS
9	51190	16	HFHCS 1/4-20 X 1.25 (SELF-TAPPING)
10	44761	1	SEAL, LIP .625 X 1.000 X .250
11		56 oz.	OIL, 20W-50
12	50016	3	BOLT, HEX FLANGE 3/8-24 X 2.5
13	51626	1	SEAL, LIP .375 X .75 X .25
14	51628	2	RING, RETAINING .375 EXT
15	51625	1	ROD, BYPASS
16	51627	1	RING, RETAINING .750 INT
17	51910	1	ARM, BYPASS
18	51630	1	RING, RETAINING .375 EXT (PUSHNUT)
19	51048	1	SWASHPLATE, TRUNNION, MACHINED
20	51140	1	SEAL, LIP 18 X 32 X 7
21	50426	1	STUD, SHORT 5/16-24
22	50281	2	PUCK, FRICTION
23	51631	1	ARM, CONTROL
24	44130	1	WASHER, FLAT 11/32 ID X 7/8 OD X 1/16
25	51812	1	TWHCS 5/16-24 X 1.0
26	50317	1	NUT, HEX LOCK 5/16-24 UNJF
27	2003014	1	SPRING-HELICAL COMPRESSION
28	2003017	1	WASHER .591 X .787 X .040
29	51062	1	SHAFT, INPUT
30	50315	1	BEARING, BALL 17MM ID X 40MM OD X 12MM
31	2000022	1	RING, RETAINING WIRE .561 ID
32	50951	1	SPACER
33	51161	1	SEAL, LIP 17 X 40 X 7
34	50329	2	RING, RETAINING
35	50551	2	BEARING, THRUST 30 X 52 X 13
36	44371	1	WASHER, FLAT 5/8 ID X 1.0 OD X .05
37	44145	1	RING, RETAINING
38	51130	1	GEAR, PINION, 13T
39	51632	1	SHAFT, MOTOR
40	51069	1	WASHER, MOTOR SHAFT .71 ID X 1.16 OD X .04
41	50132	2	WASHER, HT .5 ID X 1.0 OD X .032
42	51129	1	GEAR, 10T/48T
43	51043	1	GEAR, 10T JACKSHAFT
44	51083	1	PIN, JACKSHAFT
45	44871	1	RING, SPIRAL RETAINING
46	51633	1	GEAR, 52T BULL
47	44875	1	WASHER, 3/4 ID X 1-1/2 OD X .13
48	51088	1	BEARING, SLEEVE (INBOARD)
49	51954	1	SHAFT, AXLE, .75 X 12.4

ITEM	PART #	QTY	DESCRIPTION
50	51089	1	BUSHING, .752 X 1.571 X .625
51	51066	1	SEAL, LIP .750 X 1.577 X .250
52	70853	1	KIT, SEAL
		1	SEAL, LIP .625 X 1.000 X .250
		1	SEAL, LIP .375 X .75 X .25
		1	SEAL, LIP 18 X 32 X 7
		1	SEAL, LIP 17 X 40 X 7
		1	SEAL, LIP .750 X 1.577 X .250
		1	SEAL, LIP 1.00 X 1.577
		1	SEAL, LIP .50 X .88 X .25
		1	RING, RETAINING .375 EXT
		1	RING, RETAINING .750 INT
		1	RING, RETAINING .375 EXT
		1	RING, RETAINING 1.56 INT
		1	RING, RETAINING WIRE .561
		1	RING, RETAINING .62 EXT
		1	RING, RETAINING, SPIRAL
53	70868R	1	KIT, EXPANSION PLATE, RH
		1	PLATE, EXPANSION RH
		1	SCREW, 10-32 X 1/2 (SELF-TAPPING)
54	70591	1	KIT, FAN-PULLEY
		1	FAN, 6", 10 BLADE
		1	PULLEY, 4.5"
		1	HEX LOCK NUT, 1/2-20 (NYLON INSERT)
		3	HEX WASHER HEAD TAPPING SCREW 1/4-20 X.75
55	70865	1	KIT, BRAKE ARM
		1	ARM, PARKING BRAKE
		1	WASHER .28 X .50 X .063
		1	BOLT, 1/4-20 X 1 W/PATCH
		1	BUSHING, .260 X .394 X .330
57	70864R	1	KIT, CENTER SECTION-FILTER RH
		1	CENTER SECTION, RH-MACHINED
		1	BUSHING, .707 X .788 X .591
		1	PLATE, BYPASS
		1	BOLT, HEX FLANGE 3/8-24 X 2.5
		1	FILTER, BASE
		1	CHECK PLUG ASSEMBLY .027, WASHER
		1	ASSEMBLY, COVER
58	50928	1	SEALANT TUBE, 10.3 oz
59	70891	1	KIT, BYPASS ARM
		1	ARM, BYPASS
		1	RING, RETAINING .375 EXT (PUSHNUT)
61	70911	1	KIT, FILTER
		1	FILTER, BASE
		1	ASSEMBLY, COVER
99	51901	1	NUT, HEX LOCK
100	51635	1	DISC, COG BRAKE
112	50594	1	HOSE, .5 X 8.75
115	50590	1	PINCH CLAMP, SINGLE EAR
120	51365	1	FAN, 6", 10 BLADE
121	50302	1	PULLEY 4.5
122	51244	1	HEX LOCK NUT, 1/2-20 (NYLON INSERT)
123	50752	3	HEX WASHER HEAD TAPPING SCREW 1/4-20 X.75
124	70314	1	1/2-20 HUB ASSEMBLY
		1	HUB
		1	HUB, STUD, 1/2-20 X 1.5 (RIB NECK)
125	70921	1	CAP, VENT ASSEMBLY
		1	VENT, PLASTIC
		1	CAP, POPPET VALVE
126	70110	1	FITTING, O-RING ASSEMBLY
		1	PLASTIC HOSE FITTING
		1	O-RING

