

314-1700

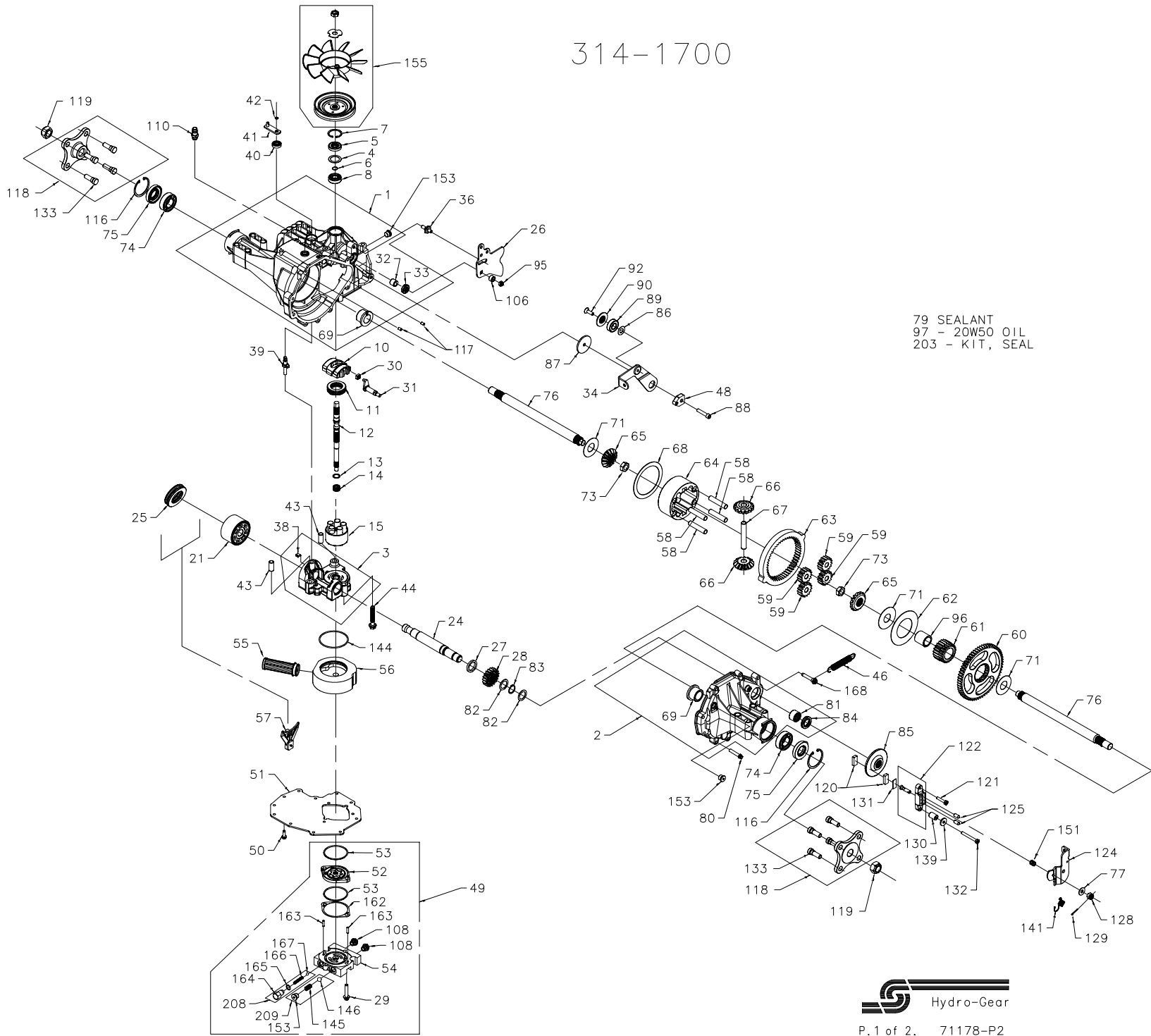

314-1700

ITEM#	PART #	QTY	DESCRIPTION
1	70433	1	MAIN HOUSING ASSEMBLY
		1	MAIN HOUSING
		1	LIP SEAL
		1	FLANGE BEARING
		1	TRUNNION BUSHING
		2	CRADLE BEARING
2	71120	1	R.H. HOUSING ASSEMBLY
		1	R.H. HOUSING
		1	FLANGE BEARING
		1	NEEDLE BEARING (SCE1412)
		1	LIP SEAL (.8751.D.X1.300.D.X.25)
3	71180	1	KIT,CENTER SECTION
		1	CENTER SECTION
		1	BUSHING .50X.60X.50
		1	BUSHING .90X1.02X.75
		1	PLATE, BYPASS
		1	CHECK PLUG ASSEMBLY, .027
		1	SHOCK VALVE ASSEMBLY, NO BLEED
		1	SPACER
4	2003018	1	LIP, SEAL 15 X 35 X 7
5	9008000-0128	1	RING, WIRE RETAINING
6	2003016	1	RING, RETAINING
7	2003052	1	RING, RETAINING
8	2003043	1	BEARING, BALL .59 X 1.38 X .43
10	2003087	1	SWASHPLATE, VARIABLE
11	50551	1	BEARING, THRUST 30 X 52 X 13
12	50960	1	SHAFT, INPUT
13	2003017	1	WASHER, THRUST .591X.787X.040
14	2003014	1	SPRING, BLOCK
15	70331	1	BLOCK ASSEMBLY, 5 PISTON 10cc
		1	BLOCK CYLINDER, 5 PISTON 10cc
		5	PISTON
		5	SPRING, PISTON
		5	WASHER, THRUST
21	70082	1	21cc CYLINDER BLOCK ASSEMBLY
		1	21cc CYLINDER BLOCK
		7	21cc PISTON
		7	21cc PISTON SPRING
		7	PISTON SEAT WASHER
		1	SHAFT, MOTOR
24	50662	1	BEARING, THRUST 42 X 68 X 16
25	50552	1	ARM, CONTROL
26	50857	1	SPACER
27	50774	1	GEAR, 19T PINION
28	51600	4	CAPSCREW, M6 X 1-25
29	51301	1	SLOT GUIDE
30	2000015	1	ARM, TRUNNION TAPERED SQUARE
31	50807	1	BUSHING, TRUNNION
32	2003009	1	SEAL, LIP 12 X 25 X 7
33	9008000-0126	1	ARM, RETURN
34	51127	1	STUD, 5/16-24
36	50426	1	KIT, BYPASS PLATE
38	70680	1	ACTUATOR, BYPASS
39	2003555	1	SEAL, LIP 10 X 25 X 7
40	45074	1	ARM, BYPASS
41	50270	1	RING, RETAINING
42	44870	1	PIN
43	50002	2	SCREW 3/8-24 X 2.5
44	50016	3	SPRING, NEUTRAL
46	51199	1	PUCK, ADJUSTING
48	51097	1	

ITEM#	PART #	QTY	DESCRIPTION
49	71201	1	KIT, AUX
		4	CAPSCREW, M6 X 1-25
		1	GEROTOR ASSEMBLY
		2	O-RING
		1	COVER, GEROTOR
		1	FILTER
		3	PLUG, PLASTIC
		1	O-RING, 2.967 ID X .103 THK
		1	SPRING, RELIEF
		1	BALL, 7/16
		1	PLUG, STRAIGHT THREAD
		1	SHIM
		2	PIN
		1	VALVE BODY
		1	O-RING, .078 X .468
		1	SPRING
		1	1/4" BALL
50	50752	11	SCREW, 1/4-20 X .75
51	51302	1	COVER, LOWER
52	51049	1	GEROTOR ASSEMBLY
53	9004100-1430	2	O-RING
54	50260	1	COVER, GEROTOR
55	70545	1	KIT, MANIFOLD, AUXILIARY
		1	MANIFOLD, AUXILIARY
		1	BUSHING .394 X .472 X .394
		1	FILTER
55	51308	1	MANIFOLD, CHARGE
56	51303	1	BEARING, MOTOR RETAINER
57	50796	1	PIN, CARRIER
58	50776	4	GEAR, 15T PLANET
59	50763	4	GEAR, 64T SPUR
60	51599	1	GEAR, 21 TOOTH SUN
61	50645	1	PLATE, PLANET THRUST
62	50769	1	GEAR, 51T RING
63	50764	1	CARRIER, PLANETARY
64	50765	1	GEAR, BEVEL (SPLINED)
65	50647	2	GEAR, BEVEL (CROSS SHAFT)
66	50648	2	SHAFT, DIFFERENTIAL
67	50766	1	PLATE, DIFF. THRUST
68	50767	2	BEARING, FLANGE
69	50768	2	WASHER 1.0 X 2.25 X .04
70	50788	3	NUT, HEX JAM 5/8-18
71	50791	2	BEARING, BALL 6205-1
72	50791	2	SEAL 1"ID x 2.0472" x .375"
73	50771	2	SHAFT, AXLE
74	50772	2	WASHER .343 X .880 X .062
75	50772	2	SEALANT
76	50825	1	SCREW, TORX HEAD 5/16-18
77	44130	1	BEARING, NEEDLE (SCE1412)
78	50928	1	WASHER .885 X 1.250 X .038
79	50928	1	RING, RETAINING
80	50868	8	SEAL, LIP .8751.D.x1.30.D.x.25
81	44752	1	DISK, BRAKE
82	50777	2	WASHER .5 X 1.0 X .03
83	50775	1	WASHER .324 X 1.960 X .146
84	50773	1	SCREW, 5/16-24 x 1-1/2
85	50779	1	BEARING
86	50132	1	SPACER, LOCATING
87	50836	1	SCREW, COUNTERSUNK 5/16-18
88	50837	1	NUT, HEX LOCK 5/16-24
89	44147	1	BEARING, SLEEVE
90	51200	1	BEARING, SLEEVE
92	50870	1	20W-50 OIL
95	50108	1	PULLEY
96	50866	1	FAN
97	51242	122oz	
103	51862	1	
104	51862	1	

ITEM#	PART #	QTY	DESCRIPTION
106	50850	1	SPACER, TRUNNION
107	51523	1	WASHER, OD SLOTTED .53 X 1.63 X .06
108	9005200-5600	3	PLUG, PLASTIC
110	70110	1	FITTING, O-RING ASS'Y
		1	FITTING, PLASTIC HOSE
		1	O-RING
115	44133	1	NUT, HEX 1/2-20
116	50859	2	RING, RETAINING
117	9004800-2506	2	PIN, STD HDLS
118	70314	2	HUB ASSEMBLY
		1	HUB, 4 STUD
		4	WHEEL STUD, 1/2-20 X 1.5
		2	NUT, HEX 3/4-16
119	50863	2	PUCK, BRAKE
120	44132	2	BOLT, HEX HD 1/4-20 X 1.25 W/PATCH
121	51927	1	YOKE, BRAKE ASSEMBLY
122	70633	1	ARM, BRAKE
124	50916	1	PINS, BRAKE
125	44127	2	NUT, CASTLE 5/16-24
128	44142	1	PIN, COTTER
129	44101	2	SPACER
130	23711	1	PLATE, PLATE
131	44134	1	BOLT, HEX HD 1/4-20 X 2.25 W/PATCH
132	51928	8	WHEEL STUD 1/2-20 X 1.5
133	44431	1	WASHER, 7/800 X .2651D X .125 THK
139	44278	1	SPRING, BRAKE ARM BIAS
141	50884	1	O RING, 2.987 ID .103 THK
144	50974	1	SPRING, RELIEF
145	51157	1	BALL, 7/16
146	9001214-4400	1	COMP. SPRING, BRAKE ANTI-DRAG
151	50919	1	PLUG, STRAIGHT THREAD
153	9005110-5600	1	KIT, FAN/PULLEY
155	70489	1	NUT, JAM 1/2-20
		1	WASHER, O.D SLOTTED, .53X1.63X.06
		1	PULLEY
		1	FAN
162	51148	1	SHIM
163	50408	2	PIN
164	50967	1	VALVE BODY
165	9004201-3700	1	O-RING .078 X .468
166	50968	1	SPRING
167	9001214-2500	1	1/4" BALL
168	51151	1	SCREW, SHOULDERED TORX 5/16-18X1.81
203	70492	1	KIT, SEAL
		1	SEAL-LIP 15X35X37
		1	SEAL-LIP 12X25X7
		1	SEAL-LIP 10X25X7
		2	O-RING, .103X1.862
		2	SEAL, LIP 1.000 X 2.049 X .375
		1	LIP SEAL (.8751.D.X1.30.D.X.25)
		2	O-RING, .070X.239
		1	KIT, O-RING, MANIFOLD
		1	SHIM, CHARGE PUMP (.002 RED)
208	2510082	1	KIT, VALVE, AUXILIARY RELIEF
		1	VALVE, AUXILIARY RELIEF BODY
		1	O-RING .078 X .468
		1	SPRING, AUXILIARY RELIEF
209	70544	1	BALL, 1/4
		1	KIT, CHARGE RELIEF
		1	PLUG, STRAIGHT THREAD
		1	SPRING, RELIEF
		1	BALL, 7/16

