

312-1700

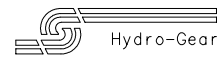

312-1700

ITEM#	PART #	QTY	DESCRIPTION	ITEM#	PART #	QTY	DESCRIPTION	ITEM#	PART #	QTY	DESCRIPTION
1	70875	1	MAIN HOUSING ASSEMBLY	46	51199	1	SPRING, NEUTRAL	113	70301	1	KIT, 90° FITTING & HOSE ASS'Y
		1	MAIN HOUSING-W/DIFF LOCK	48	51097	1	PUCK, ADJUSTING			1	FITTING, 90° METAL
		1	LIP SEAL	50	50752	13	SCREW, 1/4-20 X .75			1	CLAMP, PINCH
		1	FLANGE BEARING	51	50972	1	COVER, LOWER	115	44133	1	HOSE, .5" X 20" LONG
		1	TRUNNION BUSHING	52	50273	1	GEROTOR ASSEMBLY	116	50859	2	NUT, JAM 1/2-20 PATCH
2A	71120	2	CRADLE BEARING	53	9004101-1340	1	O-RING	117	9004800-2506	2	RING, RETAINING
		1	R.H. HOUSING ASSEMBLY	54	50260	1	COVER, GEROTOR	118	70276	2	PIN, STD HDLS
		1	R.H. HOUSING	55	70538	1	KIT, FILTER			2	HUB, ASSEMBLY
		1	FLANGE BEARING			2	GASKET, .10 X .16 X .24			4	STUD, 7/16-14
		1	NEEDLE BEARING (SCE1412)			1	FILTER			1	HUB
		1	LIP SEAL (.875 ID X 1.30 OD X .25)	56	51156	1	MANIFOLD, CHARGE	119	50863	2	NUT, HEX 3/4-16
2B	71139	1	KIT, BRAKE BOLT	57	50796	1	BEARING, MOTOR RETAINER	120	44132	2	PUCK, BRAKE
		1	BOLT, HEX HD 1/4-20 X 1.25 W/PATCH	58	50776	4	PIN, CARRIER	121	51927	1	BOLT, HEX HD 1/4-20 X 1.25 W/PATCH
		1	BOLT, HEX HD 1/4-20 X 2.25 W/PATCH	59	50763	4	GEAR, 15T PLANET	122	70633	1	YOKE, BRAKE ASSEMBLY
3	70686	1	KIT, CENTER SECTION	60	51599	1	GEAR, 64T SPUR	124	50916	1	ARM, BRAKE
		1	CENTER SECTION	61	50645	1	GEAR, 21 TOOTH SUN	125	44127	2	PINS, BRAKE
		1	BUSHING .50 X .60 X .50	62	50769	1	PLATE, PLANET THRUST	128	44142	1	NUT, CASTLE 5/16-24
		1	BUSHING .90 X 1.02 X .75	63	50764	1	GEAR, 51T RING	129	44101	1	PIN, COTTER
		1	PLATE, BYPASS	64	50765	1	CARRIER, PLANETARY	130	23711	1	SPACER
		1	CHECK PLUG ASSEMBLY, .027	65	50647	2	GEAR, BEVEL (SPLINED)	131	44134	1	PUCK, PLATE
		1	CHECK PLUG ASSEMBLY, BLANK	66	50648	2	GEAR, BEVEL (CROSS SHAFT)	132	51928	1	BOLT, HEX HD 1/4-20 X 2.25 W/PATCH
		1	SPACER	67	50766	1	SHAFT, DIFFERENTIAL	133	50869	8	STUD, 7/16-14 X 1.35 (RIB NECK)
4	2003018	1	LIP, SEAL 15 X 35 X 7	68	50767	1	PLATE, DIFF. THRUST	139	44278	1	WASHER, 7/8 OD X .265 ID X .125 THK
5	9008000-0128	1	RING, WIRE RETAINING	69	50768	2	BEARING, FLANGE	141	50884	1	SPRING, BRAKE ARM BIAS
6	2003016	1	RING, RETAINING	70	51642	1	WASHER 1.0 X 2.60 X .038	142	43064	1	NUT, HEX 5/16-18 LOCK
7	2003052	1	BEARING, BALL 15 X 35 X 11	71	50788	2	WASHER 1.0 X 2.25 X .04	143	50886	1	BOLT, 5/16-18 X 2.5
8	2003043	1	SWASHPLATE, VARIABLE	73	50791	2	NUT, HEX JAM 5/8-18	144	50974	1	O-RING, 2.987 ID .103 THK
10	2003087	1	BEARING, THRUST 30 X 52 X 13	74	50771	2	BEARING, BALL 6205-1	145	51157	3	SPRING, RELIEF
11	50551	1	SHAFT, INPUT	75	50772	2	SEAL 1 ID X 2.0472 X .375	146	9001214-4400	1	BALL, 7/16 STEEL
12	50795	1	WASHER, THRUST .591 X .787 X .040	76	50825	2	SHAFT, AXLE, 1 X 14.2 SPLINED	151	50919	1	COMP. SPRING, BRAKE ANTI-DRAW
13	2003017	1	SPRING, BLOCK	77	44130	1	WASHER .343 X .880 X .062	153	9005110-5600	1	PLUG, STRAIGHT THREAD
14	2003014	1	BLOCK ASSEMBLY, 5 PISTON 10cc	79	50928	1	SEALANT	155	70995	1	KIT, FAN/PULLEY
15	70331	1	BLOCK CYLINDER, 5 PISTON 10cc	80	50868	8	SCREW, TORX HEAD 5/16-18			1	NUT, JAM 1/2-20
		5	PISTON	81	44752	1	BEARING, NEEDLE (SCE1412)			1	ASSEMBLY, HUB/PULLEY 3.25
		5	SPRING, PISTON	82	50777	2	WASHER .885 X 1.250 X .038			1	FAN 7.0 (10 BLADE)
		5	WASHER, THRUST	83	50775	1	RING, RETAINING	157	50977	2	WASHER, OD SLOTTED .53 X 1.55 X .06
21	70082	1	21cc CYLINDER BLOCK ASSEMBLY	84	50773	1	SEAL, LIP .875 I.D. X 1.3 O.D. X .25	168	51151	1	O-RING, .070 X .239
		1	21cc CYLINDER BLOCK	85	50779	1	DISK, BRAKE	170	51644	1	SCREW, SHOULDERED TORX HEAD 5/16-18
		7	21cc PISTON	86	50132	1	WASHER .5 X 1.0 X .03	171	51645	1	CAM, STATIONARY
		7	21cc PISTON SPRING	87	50836	1	WASHER .324 X 1.960 X .146	172	51646	1	CAM, ROTATING
		7	PISTON SEAT WASHER	88	50837	1	SCREW, 5/16-24 X 1-1/2	173	51647	1	WASHER, LIP 2.78 X 3.60 X .035
24	50662	1	SHAFT, MOTOR	89	44147	1	BEARING	175	51648	1	PLATE, LOAD
25	50552	1	BEARING, THRUST 42 X 68 X 16	90	51200	1	SPACER, LOCATING	177	51649	2	DOG, ENGAGEMENT
26	51250	1	ARM, CONTROL	92	50870	1	SCREW, COUNTERSUNK 5/16-18	178	51650	1	WASHER, GUIDE
27	50774	1	SPACER	95	50108	1	NUT, HEX LOCK 5/16-24	179	51651	1	CAM, ACTUATING
28	51600	1	GEAR, 19T PINION	96	50866	1	BEARING, SLEEVE	180	51613	1	SHAFT, ACTUATING
29	50975	2	CAPSCREW, M6 X 1-25	97		109oz	20W-50 OIL	181	51652	1	SLEEVE
30	2000015	1	SLOT GUIDE	102	50813	1	BRACKET, TORQUE	182	51628	1	HANDLE, ACTUATING
31	50807	1	ARM, TRUNNION TAPERED SQUARE	103	51925	1	ASSEMBLY, HUB/PULLEY 3.25	183	9004101-0120	1	RING, RETAINING .375 EXTERNAL
32	2003009	1	BUSHING, TRUNNION	104	51862	1	FAN 7.0 (10 BLADE)	184	51654	1	O-RING, -.012, .364 X .070
33	9008000-0126	1	SEAL, LIP 12 X 25 X 7	106	50850	1	SPACER, TRUNNION	203	70492	1	O-RING, -.029, 1.489 X .070
34	51127	1	ARM, RETURN	107	51523	1	WASHER, OD SLOTTED .53 X 1.55 X .06			1	KIT, SEAL
36	50426	1	STUD, SHORT 5/16-24	109	50133	1	BUSHING-VENT (RUBBER)			1	SEAL-LIP 15 X 5 X 37
38	70680	1	KIT, BYPASS PLATE	110	70302	1	FITTING KIT			1	SEAL-LIP 12 X 25 X 7
39	2003555	1	ACTUATOR, BYPASS			1	BUSHING, RUBBER			1	SEAL-LIP 10 X 25 X 7
40	45074	1	SEAL, LIP 10 X 25 X 7			1	CAP-VENT ASSEMBLY			1	O-RING, .103 X 1.862
41	50270	1	ARM, BYPASS - STUD & HOLE	111	70109	1	KIT, 90° FITTING & HOSE ASSEMBLY			2	SEAL, LIP 1.000 X 2.049 X .375
42	44870	1	RING, RETAINING			1	VENT, CAP ASS'Y			1	SEAL, LIP (.875 I.D. X 1.375 O.D. X .25)
43	50002	2	PIN			1	VENT, PLASTIC			2	O-RING, .070 X .239
44	50016	3	SCREW 3/8-24 X 2.5			1	VENT, CAP			1	KIT, O-RING, MANIFOLD
								210	51656	8	NUT, LUG 7/16-14

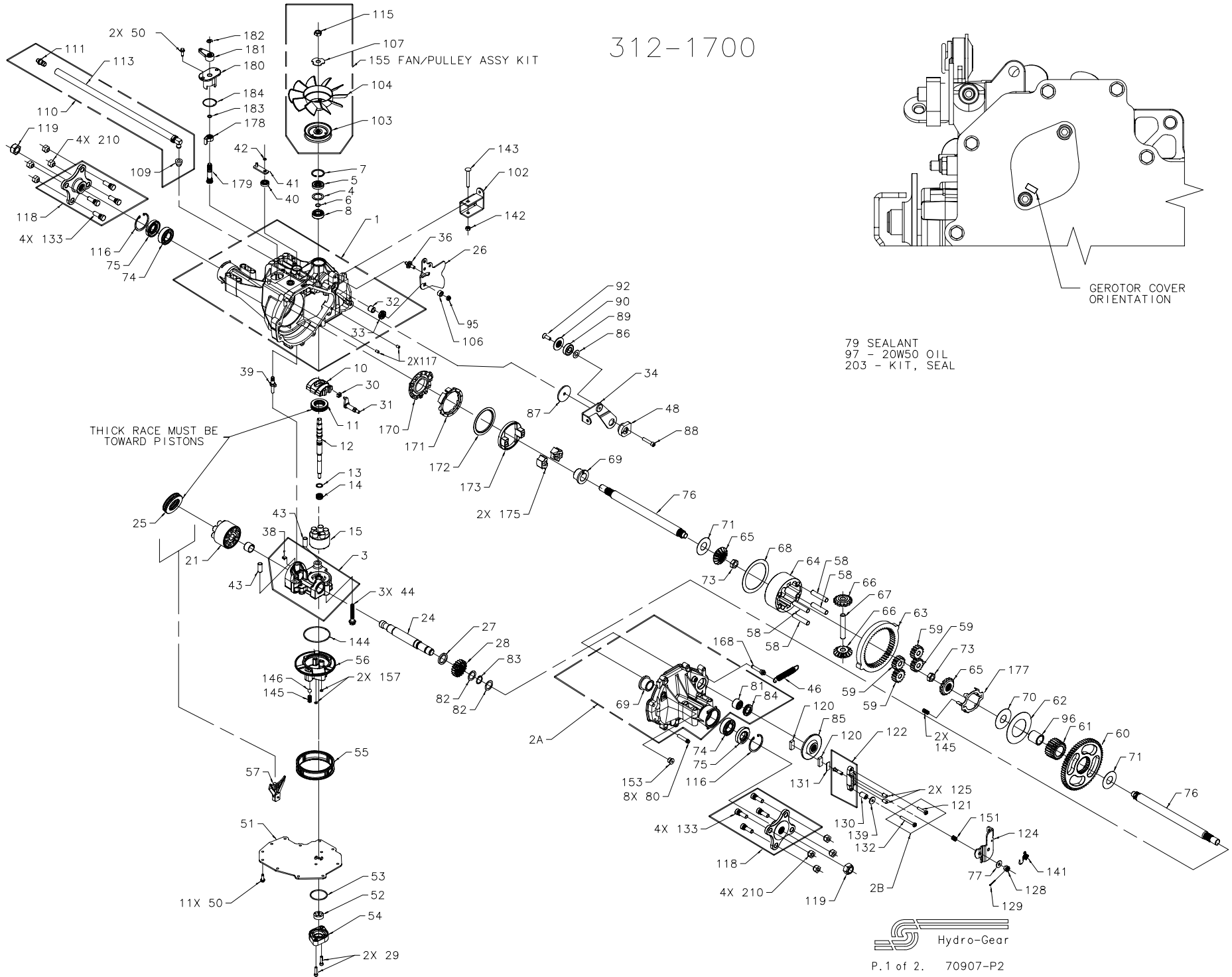