

312-1500

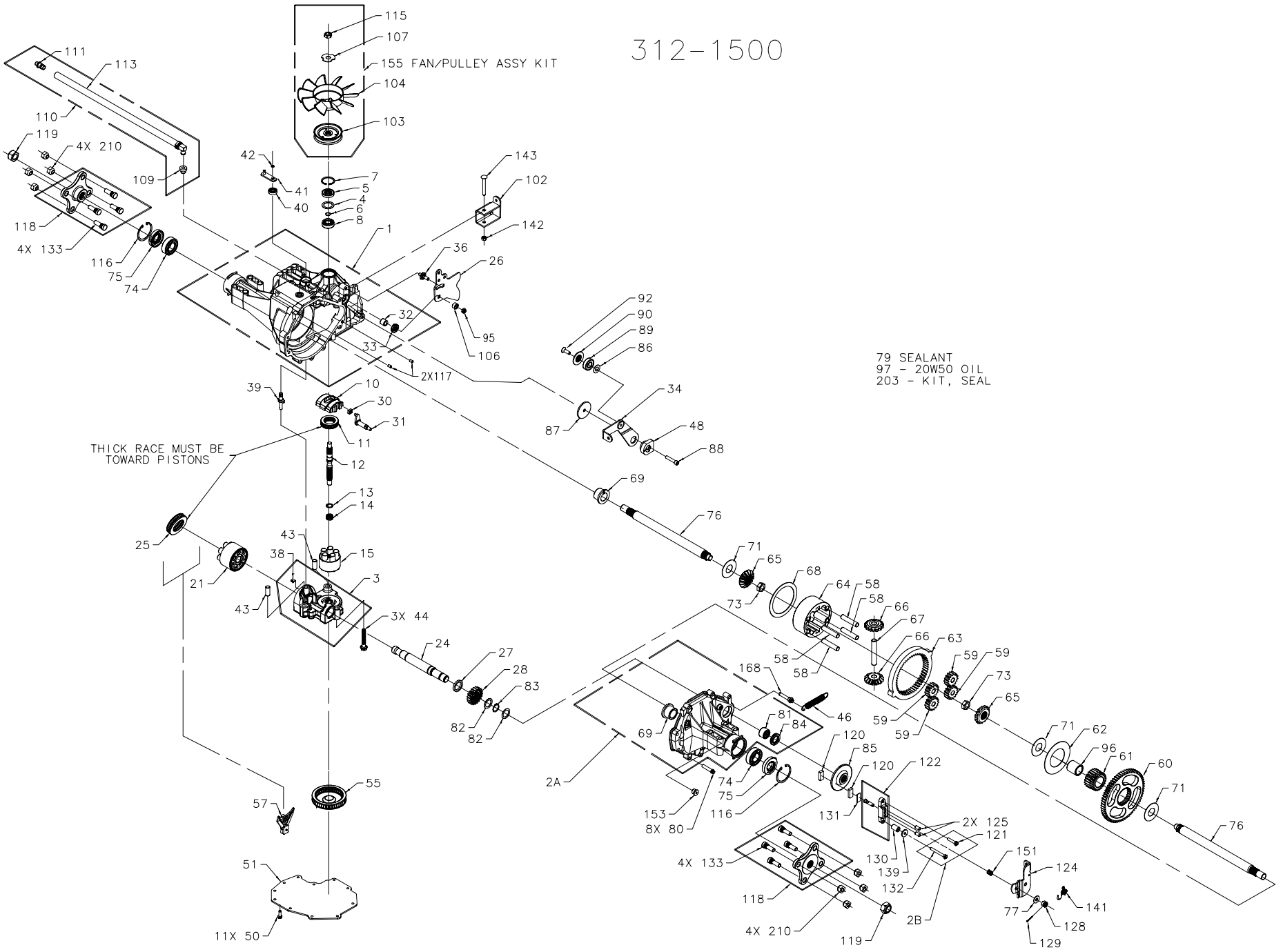

79 SEALANT
97 - 20W50 OIL
203 - KIT, SEAL

THICK RACE MUST BE TOWARD PISTONS

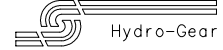

312-1500

ITEM#	PART #	QTY	DESCRIPTION	ITEM#	PART #	QTY	DESCRIPTION	ITEM#	PART #	QTY	DESCRIPTION
1	70297	1	MAIN HOUSING ASSEMBLY	46	51199	1	SPRING, NEUTRAL	113	70301	1	KIT, 90° FITTING & HOSE ASS'Y
		1	MAIN HOUSING	48	51097	1	PUCK, ADJUSTING			1	FITTING, 90° METAL
		1	LIP SEAL	50	50752	11	SCREW, 1/4-20 X .75			1	CLAMP, PINCH
		1	FLANGE BEARING	51	51128	1	COVER, LOWER W/O KIDNEYS			1	HOSE, .5" X 20" LONG
		1	TRUNNION BUSHING	55	50990	1	FILTER	115	44133	1	NUT, JAM 1/2-20 PATCH
		2	CRADLE BEARING	57	50796	1	RETAINER, MOTOR BEARING	116	50859	2	RING, RETAINING
2A	71120	1	R.H. HOUSING ASSEMBLY	58	50776	4	PIN, CARRIER	117	9004800-2506	2	PIN, STD HDLS
		1	R.H. HOUSING	59	50763	4	GEAR, 15T PLANET	118	70276	2	HUB, ASSEMBLY
		1	FLANGE HOUSING	60	51599	1	GEAR, 64T SPUR			4	STUD, 7/16-14
		1	NEEDLE BEARING (SCE1412)	61	50645	1	GEAR, 21 TOOTH SUN			1	HUB
		1	LIP SEAL (.875 ID X 1.30 OD X .25)	62	50769	1	PLATE, PLANET THRUST	119	50863	2	NUT, HEX 3/4-16
2B	71139	1	KIT, BRAKE BOLT	63	50764	1	GEAR, 51T RING	120	44132	2	PUCK, BRAKE
		1	BOLT, HEX HD 1/4-20 X 1.25 W/PATCH	64	50765	1	CARRIER, PLANETARY	121	51927	1	BOLT, HEX HD 1/4-20 X 1.25 W/PATCH
		1	BOLT, HEX HD 1/4-20 X 2.25 W/PATCH	65	50647	2	GEAR, BEVEL (SPLINED)	122	70633	1	YOKO, BRAKE ASSEMBLY
3	70913	1	KIT, CENTER SECTION	66	50648	2	GEAR, BEVEL (CROSS SHAFT)	124	50916	1	ARM, BRAKE
		1	CENTER SECTION	67	50766	2	SHAFT, DIFFERENTIAL	125	44127	2	PINS, BRAKE
		1	BUSHING .90 X 1.02 X .75	68	50767	1	PLATE, DIFF. THRUST	128	44142	1	NUT, CASTLE 5/16-24
		1	PLATE, BYPASS	69	50768	2	BEARING, FLANGE	129	44101	1	PIN, COTTER
		1	CHECK PLUG ASSEMBLY, .027	71	50788	3	WASHER 1.0 X 2.25 X .04	130	23711	1	SPACER
		1	CHECK PLUG ASSEMBLY, BLANK	73	50791	2	NUT, HEX JAM 5/8-18	131	44134	1	PUCK, PLATE
4	2003018	1	SPACER	74	50771	2	BEARING, BALL 6205-1	132	51928	1	BOLT, HEX HD 1/4-20 X 2.25 W/PATCH
5	9008000-0128	1	LIP, SEAL 15 X 35 X 7	75	50772	2	SEAL 1 ID X 2.0472 X .375	133	50869	8	STUD, 7/16-14 X 1.35 (RIB NECK)
6	2003016	1	RING, WIRE RETAINING	76	50825	2	SHAFT, AXLE, 1 X 14.2 SPLINED	139	44278	1	WASHER, 7/8 OD X .265 ID X .125 THK
7	2003052	1	RING, RETAINING	77	44130	1	WASHER .343 X .880 X .062	141	50884	1	SPRING, BRAKE ARM BIAS
8	2003043	1	BEARING, BALL 15 X 35 X 11	79	50928	1	SEALANT	142	43064	1	NUT, HEX 5/16-18 LOCK
10	2003087	1	SWASHPLATE, VARIABLE	80	50868	8	SCREW, TORX HEAD 5/16-18	143	50886	1	BOLT, 5/16-18 X 2.5
11	50551	1	BEARING, THRUST 30 X 52 X 13	81	44752	1	BEARING, NEEDLE (SCE1412)	151	50919	1	COMP. SPRING, BRAKE ANTI-DRAG
12	50005	1	SHAFT, INPUT	82	50777	2	WASHER .885 X 1.250 X .038	153	9005110-5600	1	PLUG, STRAIGHT THREAD
13	2003017	1	WASHER, THRUST .591 X .787 X .040	83	50775	1	RING, RETAINING	155	70995	1	KIT, FAN/PULLEY
14	2003014	1	SPRING, BLOCK	84	50773	1	SEAL, LIP .875 I.D. X 1.3 O.D. X .25			1	NUT, JAM 1/2-20
15	70331	1	BLOCK ASSEMBLY, 5 PISTON 10cc	85	50779	1	DISK, BRAKE			1	ASSEMBLY, HUB/PULLEY 3.25
		1	BLOCK CYLINDER, 5 PISTON 10cc	86	50132	1	WASHER 5 X 1.0 X .03			1	FAN 7.0 (10 BLADE)
		5	PISTON	87	50836	1	WASHER .324 X 1.960 X .146	168	51151	1	WASHER, OD SLOTTED .53 X 1.55 X .06
		5	SPRING, PISTON	88	50837	1	SCREW, 5/16-24 X 1-1/2	203	70492	1	SCREW, SHOULDERS TORX HEAD 5/16-18
		5	WASHER, THRUST	89	44147	1	BEARING			1	KIT, SEAL
21	70082	1	21cc CYLINDER BLOCK ASSEMBLY	90	51200	1	SPACER, LOCATING			1	SEAL-LIP 15 X 5 X 37
		1	21cc CYLINDER BLOCK	92	50870	1	SCREW, COUNTERSUNK 5/16-18			1	SEAL-LIP 12 X 25 X 7
		7	21cc PISTON	95	50108	1	NUT, HEX LOCK 5/16-24			1	SEAL-LIP 10 X 25 X 7
		7	21cc PISTON SPRING	96	50866	1	BEARING, SLEEVE			1	O-RING, .103 X 1.862
		7	PISTON SEAT WASHER	97	126.702	1	20W-50 OIL			2	SEAL, LIP 1.000 X 2.049 X .375
24	50662	1	SHAFT, MOTOR	102	50813	1	BRACKET, TORQUE			1	SEAL, LIP (.875 I.D. X 1.375 O.D. X .25)
25	50552	1	BEARING, THRUST 42 X 68 X 16	103	51925	1	ASSEMBLY, HUB/PULLEY 3.25	210	51656	8	NUT, LUG 7/16-14
26	51250	1	ARM, CONTROL	104	51862	1	FAN 7.0 (10 BLADE)			1	KIT, O-RING, MANIFOLD
27	50774	1	SPACER	106	50850	1	SPACER, TRUNNION			2	O-RING, .070 X .239
28	51600	1	GEAR, 19T PINION	107	51523	1	WASHER, OD SLOTTED .53 X 1.55 X .06			1	O-RING, .070 X .239
30	2000015	1	SLOT GUIDE	109	50133	1	BUSHING-VENT (RUBBER)			1	FITTING KIT
31	50807	1	ARM, TRUNNION TAPERED SQUARE	110	70302	1	BUSHING, RUBBER			1	CAP-VENT ASSEMBLY
32	2003009	1	BUSHING, TRUNNION			1	KIT, 90° FITTING & HOSE ASSEMBLY			1	VENT, CAP ASS'Y
33	9008000-0126	1	SEAL, LIP 12 X 25 X 7			1	VENT, PLASTIC			1	VENT, CAP
34	51127	1	ARM, RETURN	111	70109	1	VENT, PLASTIC				
36	50426	1	STUD, SHORT 5/16-24								
38	70680	1	KIT, BYPASS PLATE								
39	2003555	1	ACTUATOR, BYPASS								
40	45074	1	SEAL, LIP 10 X 25 X 7								
41	50270	1	ARM, BYPASS - STUD & HOLE								
42	44870	1	RING, RETAINING								
43	50002	2	PIN								
44	50016	3	SCREW 3/8-24 X 2.5								

