

166773  
325-3000

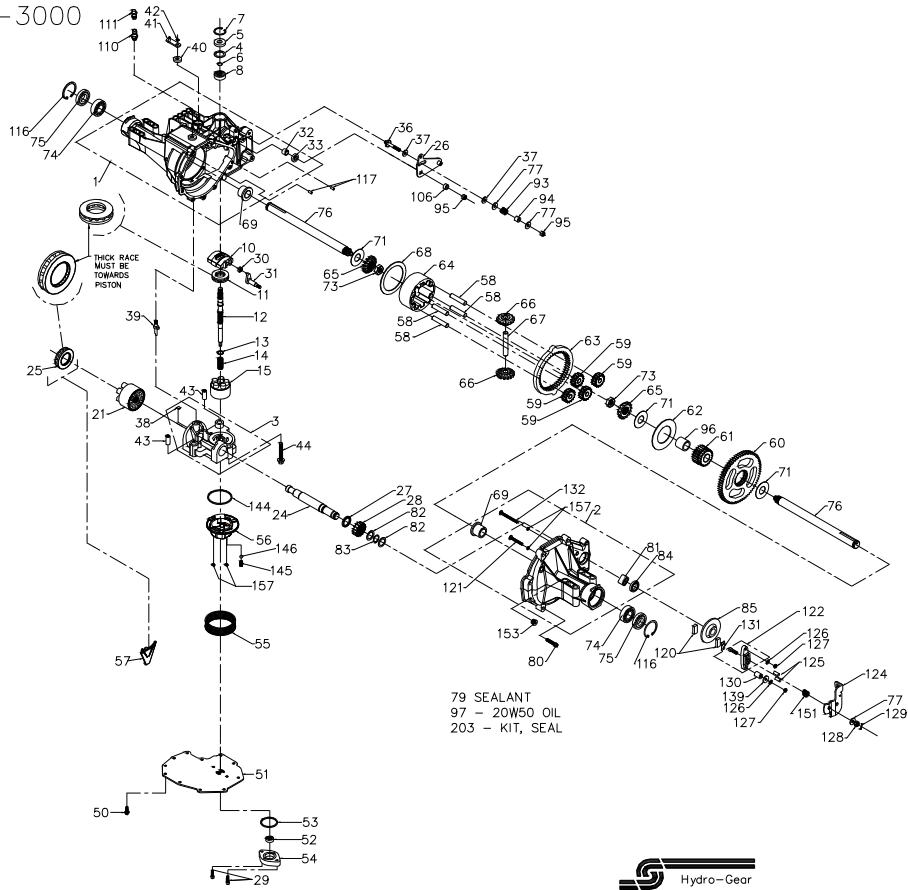

Hydro-Gear  
P.1 of 2. 70410-P5

166773  
325-3000

ITEM #	PART #	QTY	DESCRIPTION
1	70297	1	HOUSING, MAIN ASSEMBLY
		1	HOUSING, MAIN
		1	SEAL, LIP 12x25x7
		1	BEARING, FLANGE
		2	CRADLE BEARING
		1	BUSHING, TRUNNION
2	70298	1	HOUSING, R.H. ASSEMBLY
		1	HOUSING, R.H.
		1	BEARING, FLANGE
		2	O-RING .070X.239
		1	BOLT, 2" RIB NECK
		1	BOLT, 3" RIB NECK
		1	BEARING, NEEDLE .875X1.125X.750
		1	SEAL, LIP .875X1.375X.250
		1	KIT, CENTER SECTION
		1	CENTER SECTION
		1	BUSHING .50X.60X.50
		1	BUSHING .90X1.02X.75
		1	PLATE, BYPASS
		1	CHECK PLUG ASSEMBLY, .044
		1	CHECK PLUG ASSEMBLY, NO BLEED
4	2003018	1	SPACER
5	9008000-0128	1	SEAL, LIP 15X35X7
6	2003016	1	RING, WIRE RETAINING
7	2003052	1	RING, RETAINING
8	2003043	1	BEARING, BALL 15X35X11
10	2003087	1	SWASHPLATE, VARIABLE
11	50551	1	BEARING, THRUST 30X52X13
12	50795	1	SHAFT, INPUT
13	2003017	1	WASHER, BLOCK THRUST
14	2003014	1	SPRING, BLOCK
15	70331	1	BLOCK, 10cc CYLINDER ASSEMBLY
		1	BLOCK, 10cc CYLINDER
		5	PISTON, 10cc
		5	SPRING, 10cc PISTON
		5	WASHER, PISTON SEAT
21	70082	1	BLOCK, 21cc CYLINDER ASSEMBLY
		1	BLOCK, 21cc CYLINDER
		7	WASHER, PISTON SEAT
		7	PISTON, 21cc
		7	SPRING, 21cc PISTON
24	50662	1	SHAFT, MOTOR
25	50552	1	BEARING, THRUST 42X68X16
26	50857	1	ARM, CONTROL
27	50774	1	SPACER
28	50661	1	GEAR, 16T PINION
29	50975	2	CAPSCREW, M6X1-22
30	2000015	1	GUIDE, SLOT
31	50807	1	ARM, TRUNNION
32	2003009	1	BUSHING, TRUNNION
33	9008000-0126	1	SEAL, LIP 12X25X7
36	50284	1	STUD 5/16-24
37	50281	2	PUCK, FRICTION
38	70680	1	KIT, BYPASS PLATE
39	2003555	1	ACTUATOR, BYPASS
40	45074	1	SEAL, LIP 10X25X7
41	50270	1	ARM, BYPASS
42	44870	1	RING, RETAINING
43	50002	2	PIN
44	50016	3	SCREW 3/8-24X2.5

ITEM #	PART #	QTY	DESCRIPTION
50	50752	1	SCREW 1/4-20X.75
51	50972	1	COVER, LOWER
52	50273	1	GEROTOR ASSEMBLY
53	9004101-1340	1	O-RING .103X1.862
54	50260	1	GEROTOR COVER
55	70538	1	KIT, FILTER
		2	GASKET .10X.16X4.24
		1	MANIFOLD, CHARGE
56	51156	1	RETAINER, MOTOR BEARING
57	50796	1	PIN, CARRIER
58	50776	4	GEAR, 15T PLANET
59	50763	1	GEAR, 67T SPUR
60	50646	1	GEAR, 21 TOOTH SUN
61	50645	1	PLATE, PLANET THRUST
62	50769	1	GEAR, 51T RING
63	50764	1	CARRIER, PLANETARY
64	50765	1	GEAR, MITER DIFF. (SPLINED)
65	50647	2	GEAR, MITER DIFF.
66	50648	1	SHAFT, DIFFERENTIAL
67	50766	1	PLATE, DIFF. THRUST
68	50767	2	BEARING, FLANGE
69	50768	3	WASHER 1.0X2.25X.04
70	50788	2	NUT, HEX JAM 5/8-18
71	50791	2	BEARING, BALL 25.4X52X15
72	50771	2	SEAL 1.000X2.049X.375
73	50772	2	SHAFT, AXLE
74	50663	3	WASHER .34X.88X.06
75	44130	1	SEALANT
76	50850	9	SCREW, TORX HEAD 5/16-18
77	44130	1	BEARING, NEEDLE .875X1.125X.750
78	50777	2	WASHER .88X1.25X.04
79	50775	1	RING, RETAINING
80	50773	1	SEAL, LIP .875X1.30X.25
81	50779	1	DISK, BRAKE
82	50277	1	SPRING, FRICTION PACK
83	50278	1	SPACER, FRICTION PACK
84	50108	2	NUT, HEX LOCK 5/16-24
85	50866	1	BEARING, SLEEVE 1.0X1.31X1.34
86	50866	1	OIL-20W50
87	50850	1	SPACER, TRUNNION
88	70110	1	FITTING, O-RING ASS'Y
89	70110	1	FITTING, PLASTIC HOSE O-RING
90	70109	1	VENT, CAP ASS'Y
91	70109	1	VENT, PLASTIC
92	70109	1	VENT, CAP
93	50859	2	RING, RETAINING
94	9004800-2506	2	PIN, STD. HDLS
95	44132	1	PUCK, BRAKE
96	50874	1	BOLT, 2" RIB NECK
97	70633	1	YOKE, BRAKE ASSEMBLY
98	50916	1	ARM, BRAKE
99	44127	2	PINS, BRAKE
100	43177	2	LOCKWASHER 1/4"
101	43178	2	NUT, 1/4-20
102	44142	1	NUT, CASTLE
103	44101	1	PIN, COTTER
104	23711	1	SPACER

ITEM #	PART #	QTY	DESCRIPTION
131	44134	1	PLATE, PUCK
132	50865	1	BOLT, 3" RIB NECK
133	44278	1	WASHER .875X.265X.125
134	50974	1	O-RING .103X2.987
135	51157	1	SPRING, RELIEF
136	9001214-4400	1	BALL 7/16
137	50919	1	SPRING, COMP. BRAKE ANTI-DRAG
138	9005110-5600	1	PLUG, STRAIGHT THREAD
139	50977	4	O-RING .070X.239
140	70492	1	KIT, SEAL
141	51157	1	SEAL-LIP 15X5X37
142	51157	1	SEAL-LIP 12X25X7
143	51157	1	SEAL-LIP 10X25X7
144	51157	1	O-RING, .103X1.862
145	51157	2	SEAL 25X52X10
146	51157	1	LIP SEAL (.875 I.D.X1.3 O.D. X.25)
147	51157	4	O-RING, .070X.239
148	51157	1	KIT, O-RING, MANIFOLD

Hydro-Gear  
P.2 of 2. 70410-P5