

14566  
339-2400R

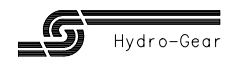
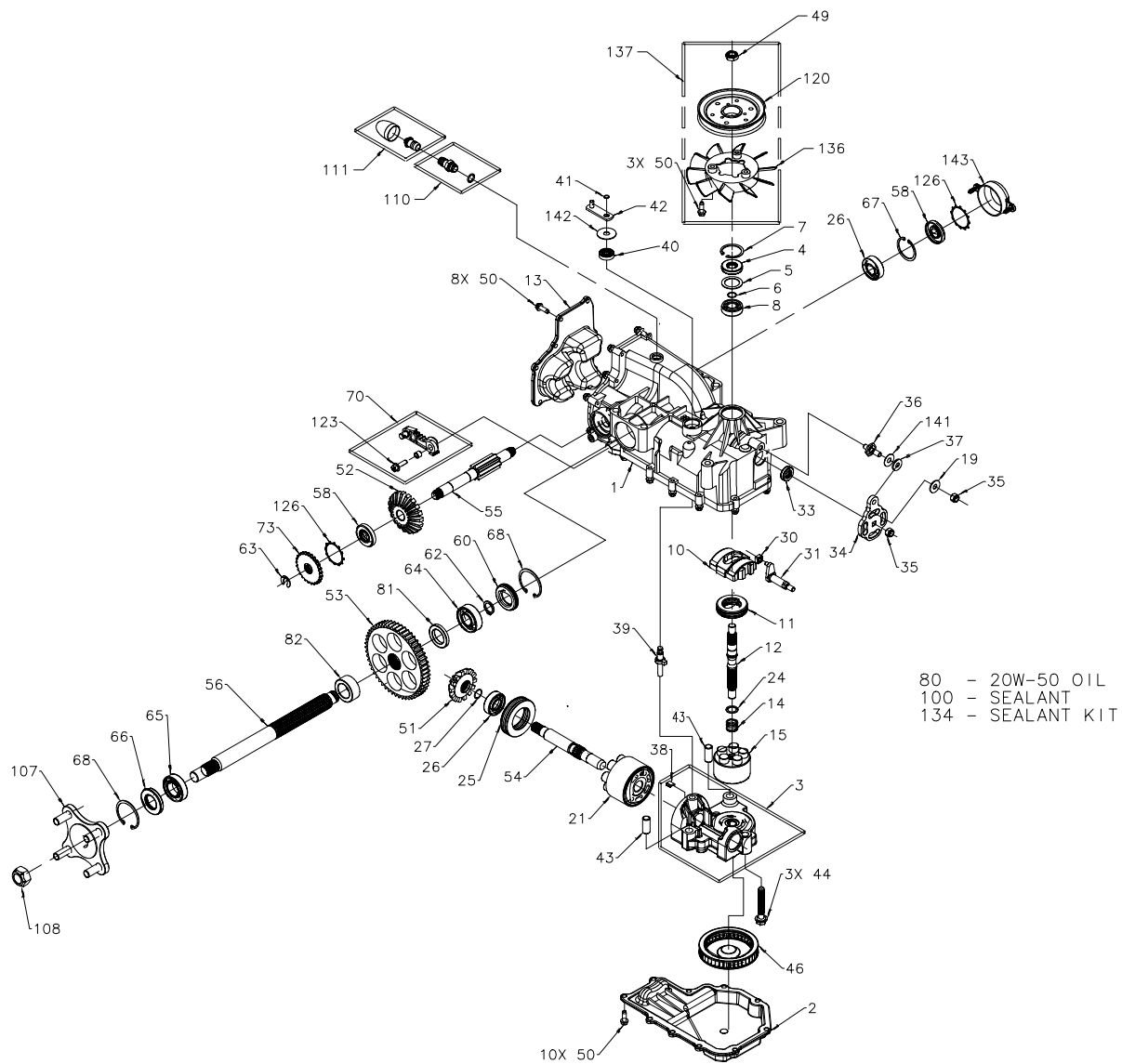

14566  
339-2400R

| ITEM # | PART #       | QTY | DESCRIPTION                        |
|--------|--------------|-----|------------------------------------|
| 1      | 70627        | 1   | KIT, HOUSING-MAIN                  |
|        |              | 1   | HOUSING, MAIN                      |
|        |              | 2   | CRADLE BEARING                     |
|        |              | 1   | TRUNNION BUSHING                   |
|        |              | 1   | SEAL, LIP 12 X 25 X 7              |
|        |              | 1   | SCREW, HFHC 1/4-28 X 7/8 (PATCH)   |
|        |              | 1   | WASHER .34 X .88 X .03             |
| 2      | 50890RM      | 1   | LOWER HOUSING                      |
| 3      | 70679        | 1   | KIT, CENTER SECTION                |
|        |              | 1   | CENTER SECTION                     |
|        |              | 1   | BUSHING .67 X 1.03 X .75           |
|        |              | 1   | PLATE, BYPASS                      |
|        |              | 3   | SCREW, 3/8-24 X 2.5                |
|        |              | 2   | CHECK PLUG ASSEMBLY, .044          |
| 4      | 9008000-0128 | 1   | LIP SEAL                           |
| 5      | 2003018      | 1   | SPACER                             |
| 6      | 2003016      | 1   | WIRE RETAINING RING                |
| 7      | 2003052      | 1   | RETAINING RING                     |
| 8      | 2003043      | 1   | BALL BEARING                       |
| 10     | 2003087      | 1   | VARIABLE SWASHPLATE                |
| 11     | 50551        | 1   | THRUST BEARING 30 X 52 X 13        |
| 12     | 50005        | 1   | INPUT SHAFT                        |
| 13     | 50891RM      | 1   | COVER-BACK                         |
| 14     | 2003014      | 1   | SPRING, BLOCK                      |
| 15     | 70331        | 1   | 10cc CYLINDER BLOCK ASS'Y          |
|        |              | 1   | 10cc CYLINDER BLOCK                |
|        |              | 5   | 10cc PISTON SPRING                 |
|        |              | 5   | PISTON SEAT WASHER                 |
|        |              | 5   | 10cc PISTON                        |
| 19     | 44130        | 1   | WASHER                             |
| 21     | 70082        | 1   | 21cc CYLINDER BLOCK ASS'Y          |
|        |              | 1   | 21cc CYLINDER BLOCK                |
|        |              | 7   | 21cc PISTON SPRING                 |
|        |              | 7   | PISTON SEAT WASHER                 |
|        |              | 7   | 21cc PISTON                        |
| 24     | 2003017      | 1   | WASHER, BLOCK THRUST               |
| 25     | 50552        | 1   | THRUST BEARING 42 X 68 X 16        |
| 26     | 50315        | 2   | BALL BEARING                       |
| 27     | 2000022      | 1   | WIRE RETAINING RING                |
| 30     | 2000015      | 1   | SLOT GUIDE                         |
| 31     | 50807        | 1   | TRUNNION ARM                       |
| 33     | 9008000-0126 | 1   | LIP SEAL                           |
| 34     | 50749        | 1   | CONTROL ARM                        |
| 35     | 50317        | 2   | NUT                                |
| 36     | 50426        | 1   | STUD - SHORT 5/16-24               |
| 37     | 50281        | 1   | FRICTION PUCK                      |
| 38     | 70680        | 1   | KIT, BYPASS PLATE                  |
| 39     | 2003555      | 1   | BYPASS ACTUATOR                    |
| 40     | 45074        | 1   | LIP SEAL                           |
| 41     | 50270        | 1   | BYPASS ARM                         |
| 42     | 44870        | 1   | RETAINING RING                     |
| 43     | 50002        | 2   | PIN                                |
| 44     | 50016        | 3   | SCREW                              |
| 46     | 50990        | 1   | FILTER                             |
| 49     | 51244        | 1   | HEX LOCK NUT 1/2-20 (NYLON INSERT) |
| 50     | 50752        | 21  | SCREW, 1/4-20 X .75 LONG           |
| 51     | 50744        | 1   | 14T BEVEL GEAR                     |
| 52     | 50745        | 1   | 19T BEVEL GEAR                     |
| 53     | 50746        | 1   | 53T SPUR GEAR                      |

| ITEM # | PART # | QTY | DESCRIPTION                        |
|--------|--------|-----|------------------------------------|
| 54     | 50757  | 1   | MOTOR SHAFT                        |
| 55     | 51298  | 1   | BRAKE SHAFT                        |
| 56     | 50748  | 1   | AXLE SHAFT                         |
| 58     | 51161  | 2   | SEAL, LIP 17 X 40 X 7              |
| 60     | 50995  | 1   | SEAL PLUG - SIDE                   |
| 62     | 50759  | 1   | RETAINING RING - AXLE              |
| 63     | 51109  | 1   | RETAINING RING                     |
| 64     | 50743  | 1   | BEARING-BALL 20X47X14(6204)        |
| 65     | 50740  | 1   | BEARING-BALL 25X47X12(6005)        |
| 66     | 50751  | 1   | SEAL                               |
| 67     | 50329  | 1   | RETAINING RING                     |
| 68     | 50760  | 2   | RETAINING RING-AXLE                |
| 70     | 70391  | 1   | LH, BRAKE ARM SERVICE ASSEMBLY     |
|        |        | 1   | BRAKE ARM                          |
|        |        | 1   | CLEVIS PIN                         |
|        |        | 1   | BUSHING .255 X .381 X .330         |
|        |        | 1   | SCREW, HFHC 1/4-28 X 7/8 (PATCH)   |
| 73     | 50754  | 1   | 79oz BRAKE DISC                    |
| 80     |        | 1   | 20W-50 OIL                         |
| 81     | 51939  | 1   | SPACER, AXLE 1.04 X 1.65 X .22     |
| 82     | 51940  | 1   | SPACER, AXLE 1.04 X 1.65 X .70     |
| 100    | 50928  | 1   | SEALANT                            |
| 107    | 70314  | 1   | HUB ASSEMBLY                       |
|        |        | 1   | HUB                                |
|        |        | 4   | LUG BOLT                           |
| 108    | 50863  | 1   | NUT, HEX 3/4-16                    |
| 110    | 70110  | 1   | FITTING O-RING ASSEMBLY            |
|        |        | 1   | PLASTIC HOSE FITTING               |
|        |        | 1   | O-RING .08 X .468                  |
| 111    | 70921  | 1   | CAP VENT ASSEMBLY                  |
|        |        | 1   | CAP, PLASTIC                       |
|        |        | 1   | VENT, PLASTIC                      |
| 120    | 50302  | 1   | PULLEY, 4.4                        |
| 123    | 51576  | 1   | SCREW, HFHC 1/4-28 X 7/8 (PATCH)   |
| 126    | 51316  | 2   | RING, RETAINING                    |
| 134    | 70553  | 1   | KIT, SEAL                          |
|        |        | 1   | SEAL, LIP 15 X 35 X 7              |
|        |        | 1   | RING, RETAINING 37 INT             |
|        |        | 1   | SEAL, LIP 12 X 25 X 7              |
|        |        | 1   | SEAL, LIP 10 X 25 X 7              |
|        |        | 1   | RING, RETAINING .31 EXT            |
|        |        | 18  | HFHCS 1/4-20 X .75                 |
|        |        | 1   | SEAL PLUG                          |
|        |        | 1   | RING, RETAINING .75 EXT            |
|        |        | 1   | RING, RETAINING .440 EXT           |
|        |        | 1   | SEAL, LIP 25 X 47 X 7              |
|        |        | 1   | RING, RETAINING 1.56 INT           |
|        |        | 2   | RING, RETAINING 1.87 INT           |
|        |        | 2   | RING, RETAINING 1.43               |
| 136    | 51365  | 1   | FAN, 6", 10 BLADE                  |
| 137    | 70591  | 1   | KIT, FAN-PULLEY                    |
|        |        | 1   | HFHCS 1/4-20 X .75                 |
|        |        | 1   | FAN, 6", 10 BLADE                  |
|        |        | 1   | HEX LOCK NUT 1/2-20 (NYLON INSERT) |
|        |        | 1   | PULLEY 4.5 X 1.625                 |
| 141    | 51575  | 1   | WASHER .34 X .88 X .03             |
| 142    | 51813  | 1   | WASHER .39 X 1.27 X .05            |
| 143    | 51774  | 1   | BRAKE COVER, PLASTIC               |

