

01597800  
346-2400L

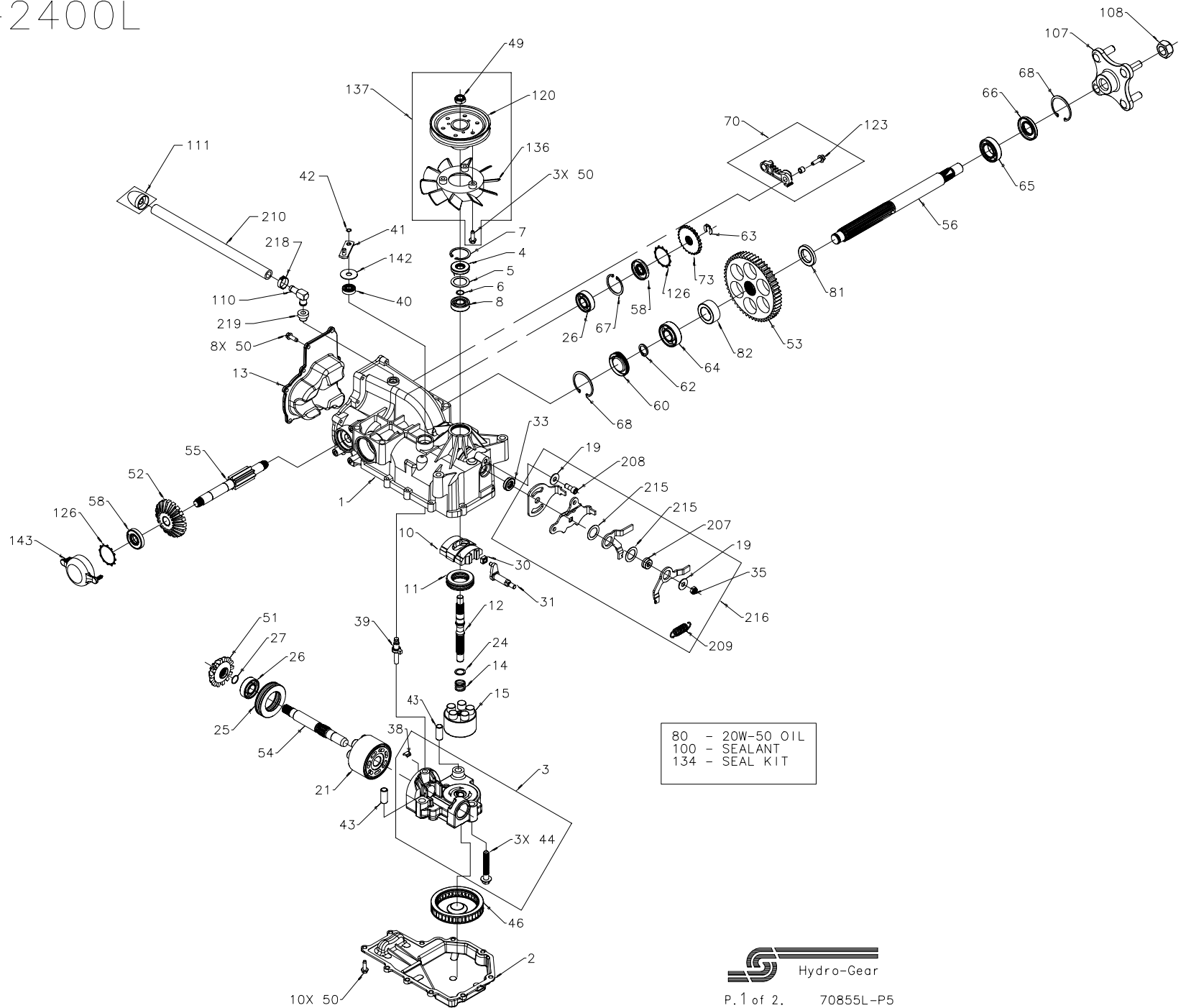

01597800  
346-2400L

| ITEM # | PART #       | QTY | DESCRIPTION                               |
|--------|--------------|-----|---|
| 1      | 70652        | 1   | KIT, HOUSING-MAIN                         |
|        |              | 1   | HOUSING, MAIN                             |
|        |              | 2   | BEARING, CRADLE                           |
|        |              | 1   | SEAL, LIP 12 X 25 X 7                     |
|        |              | 1   | BUSHING, TRUNNION                         |
|        |              | 1   | SHAFT, BRAKE                              |
|        |              | 1   | SCREW, HFHC 1/4-28 X 7/8 (PATCH)          |
|        |              | 1   | WASHER .34 X .88 X .03                    |
| 2      | 50890RM      | 1   | LOWER HOUSING                             |
| 3      | 70667        | 1   | KIT, CENTER SECTION                       |
|        |              | 1   | CENTER SECTION                            |
|        |              | 1   | BUSHING .67 X 1.03 X .75                  |
|        |              | 1   | PLATE, BYPASS                             |
|        |              | 3   | SCREW, 3/8-24 X 2.5                       |
|        |              | 2   | CHECK PLUG ASSEMBLY, .044                 |
| 4      | 9008000-0128 | 1   | LIP SEAL                                  |
| 5      | 2003018      | 1   | SPACER                                    |
| 6      | 2003016      | 1   | WIRE RETAINING RING                       |
| 7      | 2003052      | 1   | RETAINING RING                            |
| 8      | 2003043      | 1   | BALL BEARING                              |
| 10     | 2003087      | 1   | VARIABLE SWASHPLATE                       |
| 11     | 50551        | 1   | THRUST BEARING 30 X 52 X 13               |
| 12     | 50005        | 1   | INPUT SHAFT                               |
| 13     | 50891RM      | 1   | COVER-BACK                                |
| 14     | 2003014      | 1   | SPRING, BLOCK                             |
| 15     | 70331        | 1   | 10cc CYLINDER BLOCK ASSY                  |
|        |              | 1   | 10cc CYLINDER BLOCK                       |
|        |              | 5   | 10cc PISTON SPRING                        |
|        |              | 5   | PISTON SEAT WASHER                        |
|        |              | 5   | 10cc PISTON                               |
| 19     | 44130        | 2   | WASHER                                    |
| 21     | 70082        | 1   | 21cc CYLINDER BLOCK ASSY                  |
|        |              | 1   | 21cc CYLINDER BLOCK ASSY                  |
|        |              | 7   | 21cc PISTON SPRING                        |
|        |              | 7   | PISTON SEAT WASHER                        |
|        |              | 7   | 21cc PISTON                               |
| 24     | 2003017      | 1   | WASHER, BLOCK THRUST                      |
| 25     | 50552        | 1   | THRUST BEARING 42 X 68 X 16               |
| 26     | 50315        | 2   | BALL BEARING                              |
| 27     | 2000022      | 1   | WIRE RETAINING RING                       |
| 30     | 2000015      | 1   | SLOT GUIDE                                |
| 31     | 50807        | 1   | TRUNNION ARM                              |
| 33     | 9008000-0126 | 1   | LIP SEAL                                  |
| 35     | 50108        | 1   | HEX LOCK NUT, 5/16-24 UNJF (NYLON INSERT) |
| 38     | 70680        | 1   | KIT, BYPASS PLATE                         |
| 39     | 2003555      | 1   | BYPASS ACTUATOR                           |
| 40     | 45074        | 1   | LIP SEAL                                  |
| 41     | 50270        | 1   | BYPASS ARM                                |
| 42     | 44870        | 1   | RETAINING RING                            |
| 43     | 50002        | 2   | PIN                                       |
| 44     | 50016        | 3   | SCREW                                     |
| 46     | 50990        | 1   | FILTER                                    |
| 49     | 51244        | 1   | HEX LOCK NUT, 1/2-20 (NYLON INSERT)       |
| 50     | 50752        | 21  | SCREW, 1/4-20 X .75 LONG                  |
| 51     | 50744        | 1   | 14T BEVEL GEAR                            |
| 52     | 50745        | 1   | 19T BEVEL GEAR                            |
| 53     | 50746        | 1   | 53T SPUR GEAR                             |
| 54     | 50757        | 1   | MOTOR SHAFT                               |
| 55     | 51298        | 1   | BRAKE SHAFT                               |
| 56     | 50748        | 1   | AXLE SHAFT                                |
| 58     | 51161        | 2   | SEAL, LIP 17 X 40 X 7                     |
| 60     | 50995        | 1   | SEAL PLUG - SIDE                          |
| 62     | 50759        | 1   | RETAINING RING - AXLE                     |
| 63     | 51109        | 1   | RETAINING RING .440 EXTERNAL              |
| 64     | 50743        | 1   | BEARING-BALL 20X47X14(6204)               |
| 65     | 50740        | 1   | BEARING-BALL 25X47X12(6005)               |

| ITEM # | PART # | QTY   | DESCRIPTION                               |
|--------|--------|-------|---|
| 66     | 50751  | 1     | SEAL                                      |
| 67     | 50329  | 1     | RETAINING RING                            |
| 68     | 50760  | 2     | RETAINING RING-AXLE                       |
| 70     | 70392  | 1     | LH, BRAKE ARM SERVICE ASSEMBLY            |
|        |        | 1     | BRAKE ARM                                 |
|        |        | 1     | CLEVIS PIN                                |
|        |        | 1     | BUSHING .255 X .381 X .330                |
|        |        | 1     | SCREW, HFHC 1/4-28 X 7/8 (PATCH)          |
|        |        | 1     | SCREW, HEX WASHER HEAD 1/4-20 X 7/8       |
| 73     | 50754  | 1     | BRAKE DISC                                |
| 80     | 50006  | 6 GAL | 20W50 OIL                                 |
| 81     | 51939  | 1     | WASHER, AXLE 1.04 X 1.65 X .22            |
| 82     | 51940  | 1     | WASHER, AXLE 1.04 X 1.65 X .70            |
| 100    | 50928  | 1     | SEALANT                                   |
| 107    | 70314  | 1     | HUB ASSY                                  |
|        |        | 1     | HUB                                       |
|        |        | 4     | LUG BOLT                                  |
| 108    | 50863  | 1     | NUT, HEX 3/4-16                           |
| 110    | 50308  | 1     | FITTING, METAL VENT                       |
| 111    | 70921  | 1     | CAP-VENT ASSEMBLY                         |
|        |        | 1     | CAP-POPPET VALVE                          |
|        |        | 1     | ST .5 BARB VENT                           |
| 120    | 50302  | 1     | PULLEY, $\phi$ 4.50 X 1.625               |
| 123    | 51576  | 1     | SCREW, HFH 1/4-28 X 7/8 PATCH             |
| 126    | 51316  | 2     | RING, RETAINING                           |
| 134    | 70553  | 1     | KIT, SEAL                                 |
|        |        | 1     | SEAL, LIP 15 X 35 X 7                     |
|        |        | 1     | RING, RETAINING 37 INT                    |
|        |        | 1     | SEAL, LIP 12 X 25 X 7                     |
|        |        | 1     | SEAL, LIP 10 X 25 X 7                     |
|        |        | 1     | RING, RETAINING .31 EXT                   |
|        |        | 18    | HFHCS 1/4-20 X .75                        |
|        |        | 1     | SEAL PLUG                                 |
|        |        | 1     | RING, RETAINING .75 EXT                   |
|        |        | 1     | RING, RETAINING .440 EXTERNAL             |
|        |        | 1     | SEAL, LIP 25 X 47 X 7                     |
|        |        | 1     | RING, RETAINING 1.56 INT                  |
|        |        | 2     | RING, RETAINING 1.87 INT                  |
|        |        | 2     | RING, RETAINING 1.43                      |
| 136    | 51365  | 1     | FAN, 6', 10 BLADE                         |
| 137    | 70591  | 1     | KIT, FAN-PULLEY                           |
|        |        | 1     | FAN, 6', 10 BLADE                         |
|        |        | 1     | HEX LOCK NUT, 1/2-20 (NYLON INSERT)       |
|        |        | 1     | PULLEY, $\phi$ 4.50 X 1.625               |
| 142    | 51813  | 1     | WASHER, .39 X 1.27 X .05                  |
| 143    | 51774  | 1     | BRAKE CAP, PLASTIC                        |
| 207    | 51604  | 1     | SPACER, RTN                               |
| 208    | 51400  | 1     | SCREW, 5/16-24 X .75 (PATCH)              |
| 209    | 51399  | 1     | SPRING, EXTENSION                         |
| 210    | 51401  | 1     | HOSE $\phi$ .50 X 12.00                   |
| 215    | 51408  | 2     | WASHER, NYLON                             |
| 216    | 70609  | 1     | RTN, KIT                                  |
|        |        | 2     | WASHER                                    |
|        |        | 1     | HEX LOCK NUT, 5/16-24 UNJF (NYLON INSERT) |
|        |        | 1     | SPACER, RTN                               |
|        |        | 1     | SCREW, 5/16-24 X .75 (PATCH)              |
|        |        | 1     | SPRING, EXTENSION                         |
|        |        | 2     | WASHER, NYLON                             |
|        |        | 1     | CONTROL ARM                               |
|        |        | 1     | ARM, RTN SCISSOR, OUTER                   |
|        |        | 1     | ARM, RTN SCISSOR, INNER                   |
|        |        | 1     | ARM, RETURN                               |
| 218    | 50590  | 1     | PINCH CLAMP, SINGLE EAR, 13/16            |
| 219    | 50133  | 1     | VENT, BUSHING                             |

www.mymowerparts.com

For Hydro-Gear Parts Call K&T 606-678-9623 or 606-561-4983

