

MODEL: 365, 371

SUBJECT: Oil Worm Gear Field Repair

This repair can be made by removing the oil worm gear and modifying it as shown below. This will work with the white or black gear. Add one washer part number 503 23 00-59 to the existing washer as below and reinstall worm gear. This will make the oiler work as a direct drive, at idle the oil flow is minimal. To adjust oiler turn oil adjusting screw all the way in and then set oil adjusting screw to the chart.

Cut the wings off the oil gear at the dotted lines and smooth the edges.

Guide Bar	No. of turns out from fully in
-15"	1
15"-18"	2
18"-24"	3
24"-	4

Important Note!

Always use a Lubri-jet bar with this saw in this application.

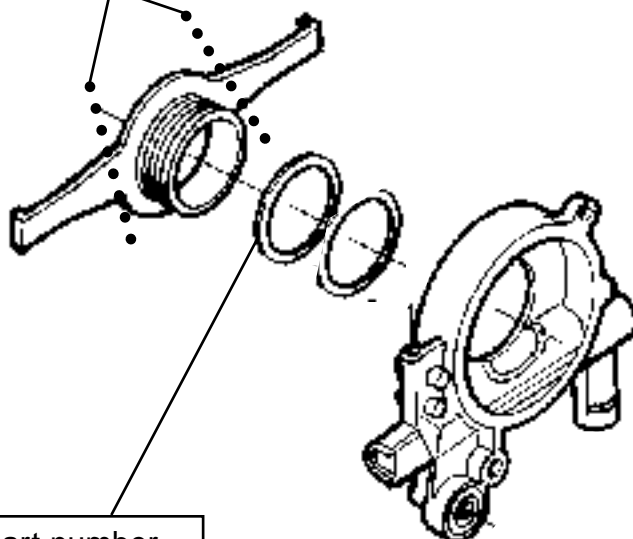

Add a second washer part number 503 23 00-59.

Note! Be sure that two washers are used and only with the wings removed.