

MODELS 281/288

New carburettor

Experiences from the field tell us that the carburettor for the models 281/288 works better without governor.

The carburettor HS 228 A with governor is therefore replaced by HS 228 B without governor.

New Ref. No.	Description	Excluded Ref. No.
503 28 01-18	Carburettor compl.	501 91 18-02
	Governor	504 86 00-05
	Washer	501 81 90-01
	Gasket	501 48 50-01

The change is introduced from serial number: 281-0170578
288-0170406

NOTE! It is very important that the maximum rpm does not exceed 12500 rpm/min. A leaner adjustment causes loss of power and overheating of the engine which leads to engine damage.

*compl 503 28 01-18

HS 228 B

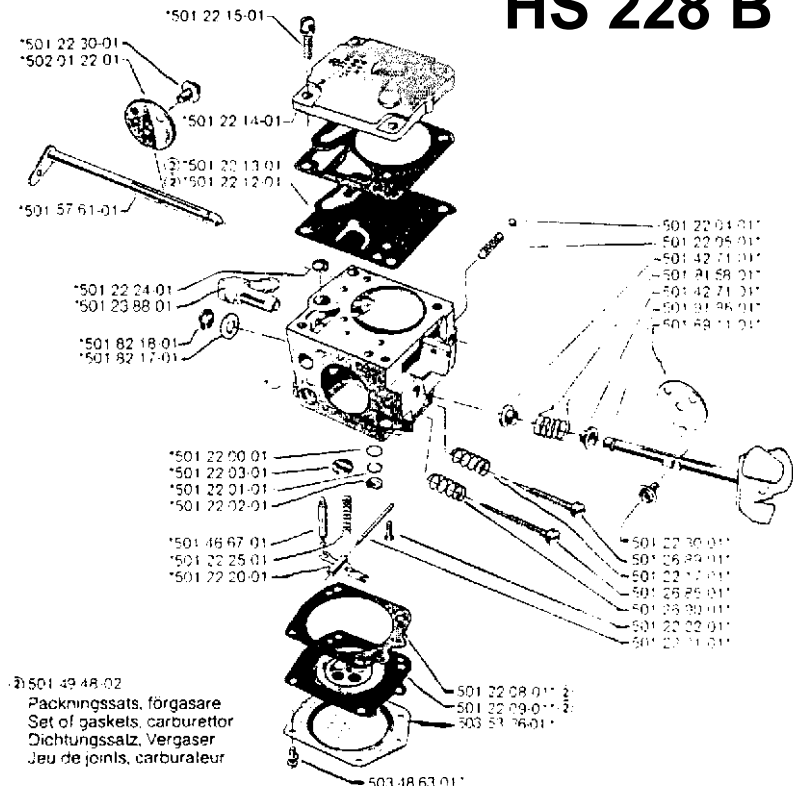

*501 48 48 02
Packingssats, förgasare
Set of gaskets, carburettor
Dichtungssatz, Vergaser
Jeu de joints, carburateur