

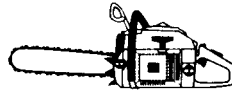



SERVICE 		9
		X 89.113-26

MODELS **61, 66, 266, 268**

A NEW SILENCER WITH SPARK ARRESTOR - NEW SPIKE - NEW WRAP-AROUND HANDLE

When changing to a new type of chain brake with knee link function Ref. No. compl. 503 57 28-01 and 503 57 28-03, anew silencer with so called spark arrestor, new spikes and new wrap-around handle are introduced also. The new chain brake can not be mounted on older saws which are not equipped with the new type of silencer with spark arrestor, new spikes and in some cases the new type of wrap-around handle. In that case the hand guard of the chainbrake will be destroyed and the saw can cause forest fire.

See separate service bulletins about this matter.

Saws with so called tube outlet silencer or jungle silencer are not affected.

New Ref. No.	Description	Excluded Ref. No.	Remark
503 59 03-02	Silencer SA	501 65 77-01	61,66,266
501 65 76-01	Silencer	501 65 77-02	only 61
503 59 03-01	Silencer XP SA	501 65 77-03	only 266
503 59 07-01	Spike, outer	501 53 14-01	
503 59 08-01	Spike, inner	501 52 81-01	remains as a spare part
503 44 57-01	Flat bumper, inner	501 53 79-01	only 266, 268
503 59 09-01	Fiat bumper, outer		only 266, 268
503 44 44-01	Bushing	503 27 90-03	remains as a spare part
503 59 92-01	Silencer XP SA	503 40 55-02	only 268
503 59 92-02	Silencer SA	503 40 65-01	only 268
503 40 64-02	Silencer, jungle	503 40 55-01	only 268
503 58 62-01	Wrap-around handle	501 69 95-01	only 266, 268
503 58 63-01	Holder-spacer	501 69 97-01	only 266, 268
503 20 00-03	Screw		only 266, 268
503 22 65-01	Nut		only 266, 268
503 21 90-08	Screw, deflector	503 21 21-01	
503 58 99-01	Deflector	501 81 72-01	61,66,266
503 40 56-01	Screen	501 81 59-01	61,66,266
503 59 90-01	Deflector	503 40 57-01	only 268

Important! If the above mentioned parts are not mounted with the new chain brake, the chain saw can cause forest fire.

Please turn over!

61, 66, 266

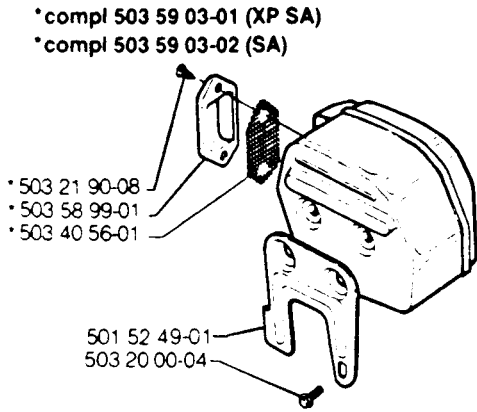

268

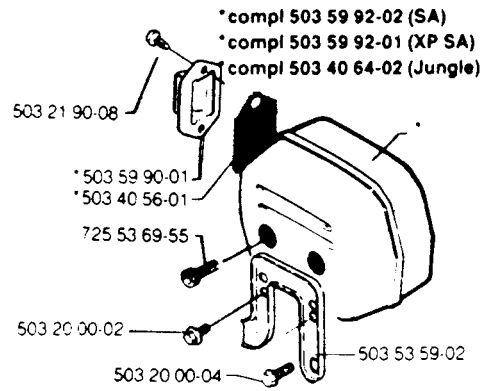

61, 66, 266, 268

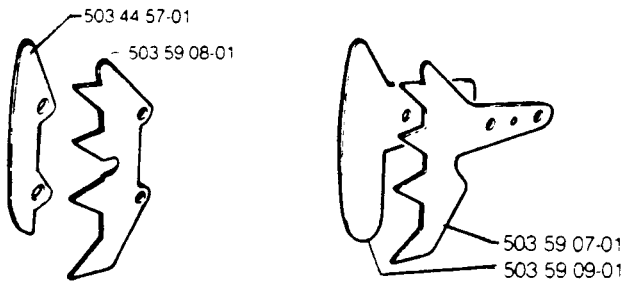

266, 268

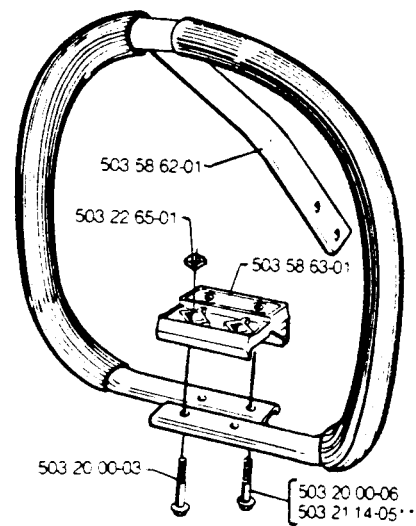

Note! The new wrap-around handle can only be mounted by using spacer Ref. No. 503 58 63-01.