

MODEL
61

CARBURETTOR SUPPORT + “VAPOUR LOCK KIT”

As on the model 266, a carburettor support is introduced. The air filter holder is therefore attached to the crankcase. At the same time, the material in the manifold is changed in order to improve the hot starting characteristics.

New Ref. No.	Description	Excluded Ref. No.	Remark
501 53 38-02	Manifold	501 53 38-01	
501 25 09-02	Gasket {carburetor}	501 25 09-01	
501 25 10-02	Gasket (manifold)	501 25 10-01	
725 52 91-56	Screw		
503 48 98-01	Clip		
—	Spacer	501 53 58-01	Remains as a spare part

The change is introduced from serial number 61 7140387.

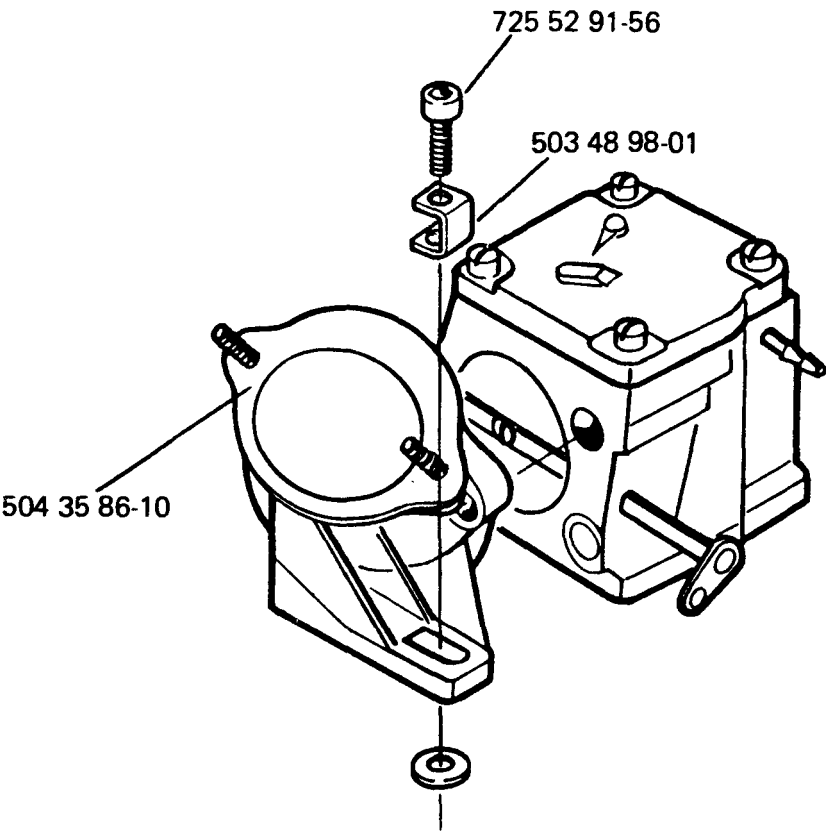

In order to assemble the new carburettor support (the Ref. No. 504 35 86-10 remains) on saws with lower serial number than the above, the following is required:

Mount carburettor and air filter holder without spacer 501 53 58-01. Use the new filter holder as a template, a hole, ø 3.3 mm (118”), should be drilled in the crankcase and be threaded with thread tap M4.

Please turn over

Mount screw 725 52 91-56 with clip 503 48 98-01. For saws without a prepared post in the crankcase, also a washer should be mounted between clip and crankcase.

The cylinder cover must also be exchanged to a new one with a modified middle wall. See below. New cover keeps its reference number.

Furthermore, under the Ref. No. 503 50 22-01 a so called "vapour lock kit" is introduced as an extra measure. This kit contains:

1	501 53 38-02	Manifold
2	503 20 21-09	Carburettor screw stainless
1	501 25 09-02	Gasket
1	501 25 10-02	Gasket

