



SERVICE	B0303026
BULLETIN	2004-01

Subject: Field restraint on Clutch for Broad Area Mower

Models Affected: 968999214,BZ6134D 968999216,BZ7234D, 968999218, BZ6127D, also included 968999221,222,223. All manufactured before 1/15/2004 (040200000)

Service Information: The field restraint on the clutch should be replaced when servicing any of the above units. The new restraint uses a rubber isolator to prevent wear between parts. See the following page for details on installation. The new parts are available as a kit, PN 539110654.

Warranty information: ½ hour labor is allowed for replacement.

Please see following page for complete installation instructions.

INSTRUCTION SHEET RESTRAINT KIT 110654

1. Remove and discard old restraint. Retain the fasteners for re-use.
2. Using 5/16C Hex Flanged Nut Item 3 (not shown), install Isolator Item 2 in hole in clutch restraint tab as shown.
3. Using fasteners from original restraint, install new Restraint Item 1 in original mounting holes as shown.
Position to straddle isolator item 2 in notch, and install with hex nuts on inside.

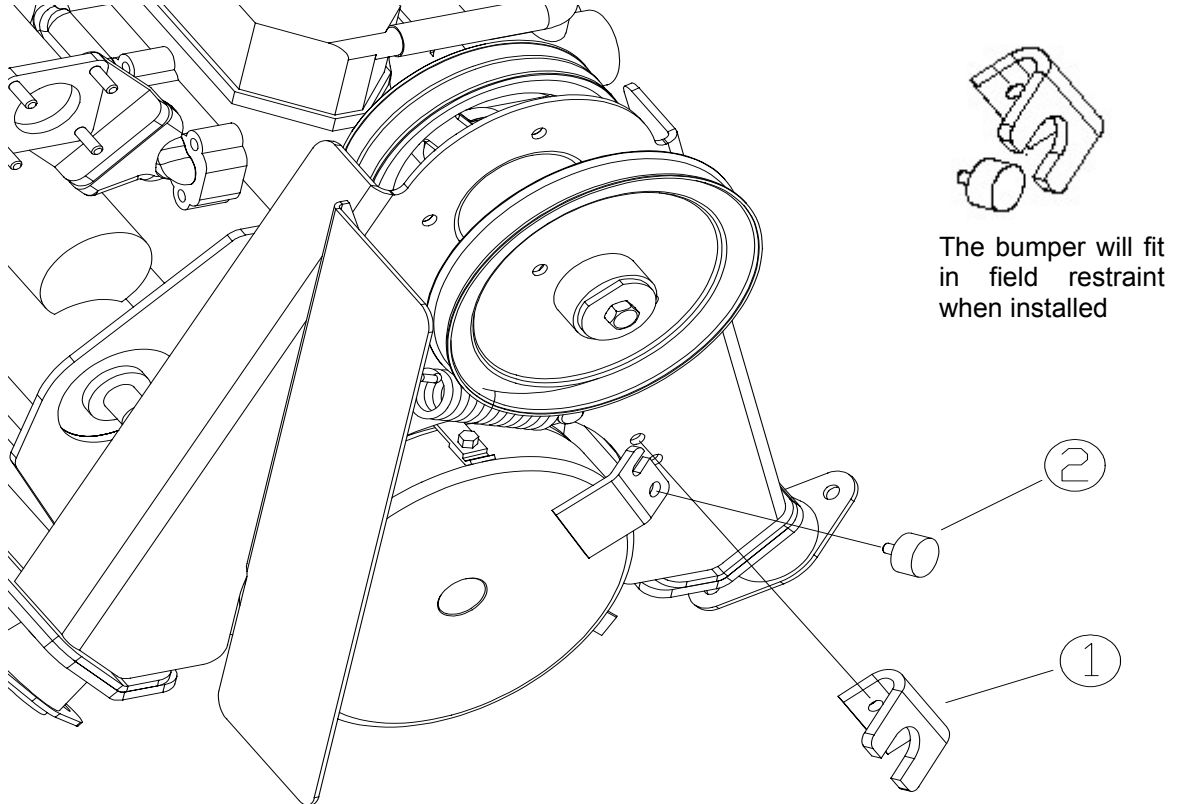

Restraint Kit 110654

For use on models 968999214, 968999216, 968999218, 968999221, 968999222, 968999223,

Kit Includes

Item	Part Number	Description	Quantity
1	110651	Restraint	1
2	110652	Bumper	1
3	990585	HFLN 5/16C	1
4	110653	Instruction Sheet	1