



**Service  
Bulletin**

**B0303015  
2003-7**

**Subject:** Wrapped Belt Kit for WHF Walk Behind Hydro Mowers.

**Affected Model/Serial Numbers:**

968999127	WHF4215ETS	All S/N's up to 032700133
968999129	WHF4818ETS	All S/N's up to 032700133
968999130	WHF5218ETS	All S/N's up to 032700143

**Service Information:**

A service kit has been released that is designed to improve belt life on the above mowers when they are being operated in the 1 to 2 inch height of cut range.

The kit contains a wrapped belt which will greatly improve belt life. The kit also includes components to raise and realign deck pulleys, to lessen the chances the belt will come off while in operation..

**Parts Information:**

The applicable kit part number contains a new wrapped belt, a tall idler pulley, spacers and bushings, kit instructions (attached as pages 2 and 3), and all necessary hardware for the conversion.

42" Deck Belt Kit, P/N 539 109258  
48" Deck Belt Kit, P/N 539 109257  
52" Deck Belt Kit. P/N 539 109256

**Warranty Information:**

Normal warranty applies.

## INSTRUCTIONS FOR INSTALLING WRAPPED BELT KIT FOR

52" DECK BELT KIT, PART NO. 539109256

48" DECK BELT KIT, PART NO. 539109257

42" DECK BELT KIT, PART NO. 539109258

1. Set the mower on a hard level surface, remove the ignition key, and remove the 3 belt shields.
2. Remove the front deck drive belt.
3. Place a block of wood or similar object under the deck to stop the blades from rotating. Remove the 3 pulleys on the blade drive spindles. Install (1) combo spacer under each pulley. This combo spacer must be installed with the small raised shoulder facing down, toward the ground. This will space the pulleys up 3/16" each. Re-install the pulley with the same hardware in the same order as it came off, and torque the bolt to 45 ft/lbs.
4. Remove the (2) fixed idler pulleys. Add (3) 3/8" flat washers each under the bushing that the idlers are mounted on. This will raise the fixed idlers 1/4" each. Re-install the idlers with the 3/8-16 x 3" long bolts in the kit. Be sure to install all the parts as shown in the picture.
5. Remove the swinging idler pulley from the idler arm, and set the pulley aside. A taller pulley will replace this. Get the taller idler pulley from the kit. Install the (3) small machinery bushings under the pulley. This will space the taller pulley up so it does not rub on the arm it mounts to. Replace the bolt and washer that you removed, and tighten.
6. You are now finished with pulleys on the front deck. Move to the back of the machine, and unclip the wire from the electric clutch. Remove the clutch from the engine shaft. You will be adding (1) combo spacer between the top pulley and the electric clutch. IT IS CRITICAL THAT THIS SPACER HAS THE SMALL RAISED SHOULDER FACING DOWN, TOWARD THE CLUTCH. If this spacer is upside down, the outside of the spacer will rub on the clutch and damage both the clutch and possibly the engine shaft. Installing this spacer will move the clutch 3/16" toward the ground. Install the clutch back on with the longer 7/16-20 x 3 capscrew and the existing washer. Torque to 45 ft/lbs. The clutch tie down must be in the slot of the clutch, same as it came off. When finished, the clutch must have enough clearance to rattle on the clutch tie down. If the clutch tie down is tight against the clutch, the clutch will wear too fast or be damaged. Some mowers will have a new style tie down that is not adjustable, and mounts in 2 holes. Re-install the wiring to the clutch.
7. Install the new deck belt from the kit. Replace the belt shields.
8. Raise the back of the rear deck 1/8". Do this by loosening the chains in the slot of the 2 rear chains, and raising the chain mount bolt 1/8. This will slope the deck slightly toward the front. This will enhance belt life, and often gives a better cut, depending on the grass type. You may skip this step if you prefer a flat deck, or if you experience grass blowout in your particular area.
9. Your mower gives the very best belt life when it is operated with the quick height adjust lever around 1/2 way down. If all of your mowing is done between 1.5" and 4", your mower frame should be set in the lowest setting, the 1.5" to 4" range.

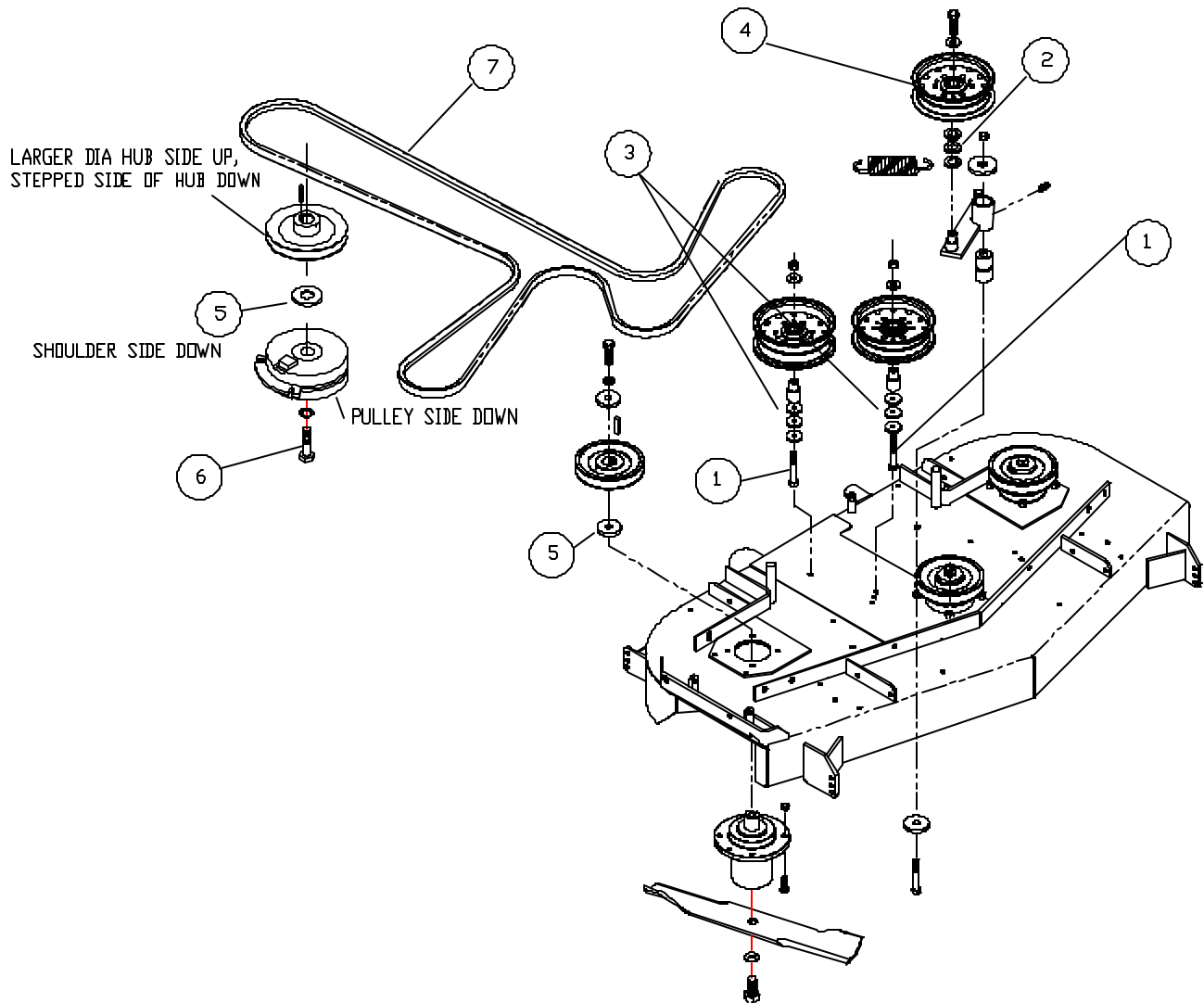

Item	Qty	Part Number	Description
1	2	539101341	HCS 3/8-16 x 3
2	3	539991043	Machinery Bushing
3	6	539990517	3/8" Flatwasher
4	1	539103258	Tall Idler Pulley
5	4	539107272	Combo Spacer
6	1	539923388	HCS 7/16-20 x 3
7	1	539109244	Belt, 42" Deck
7	1	539109243	Belt, 48" Deck
7	1	539109242	Belt, 42" Deck