



SERVICE 		2
		B0200015

English 1 (3)

SB, 340, 345, 350, Crankcase, Ball bearing, 2002-02



The fitting of the bearing and bearing holder has been improved. A modified fitting procedure prevents misalignment of the bearing. The bearing holder has been replaced with a more heat-resistant material (Viton). The bearing holder, which was previously black, is now brown.

Introduced from serial number:	340	012500001
	345	012500001
	350	012303701

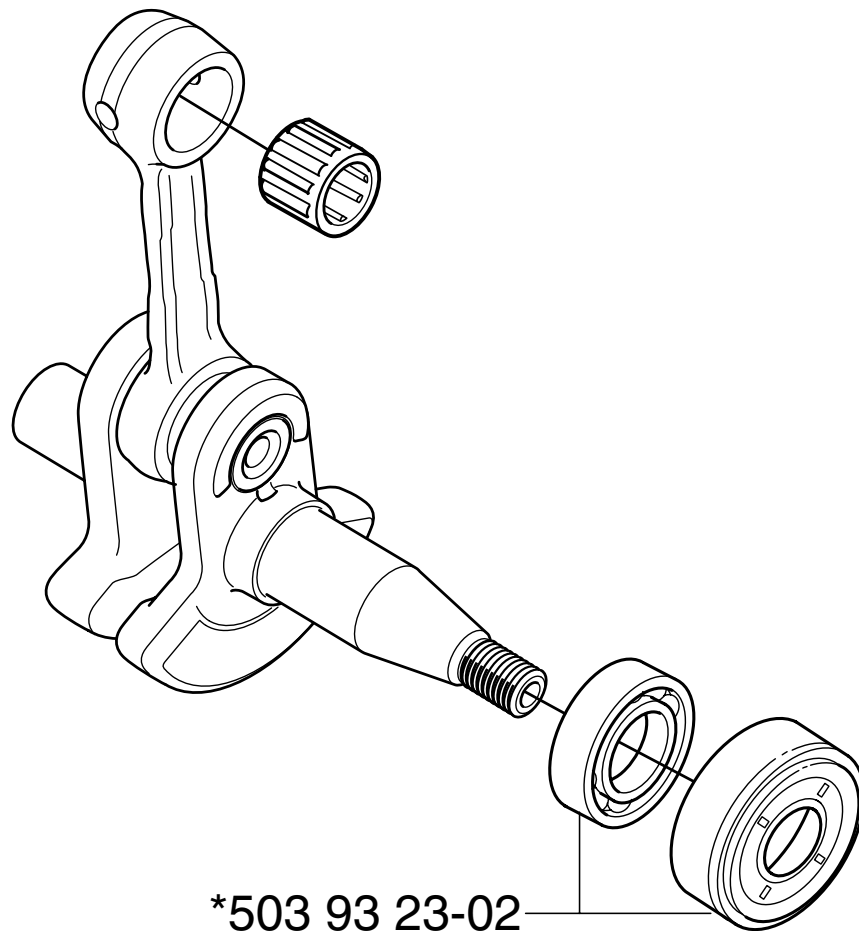
New part no.	Description	Excl. part no.	Remark
503 93 23-02	Bearing holder	503 93 23-01	





SERVICE 		2
		B0200015

English 2 (3)

Crankcase

Increased space in the crankcase allows the rubber part of the bearing holder to expand.

Introduced from serial number:	340	012200961
	345	012203011
	350	012201261

New part no.	Description	Excl. part no.	Remark
537 17 20-01	Crankcase assy.	503 85 15-02	

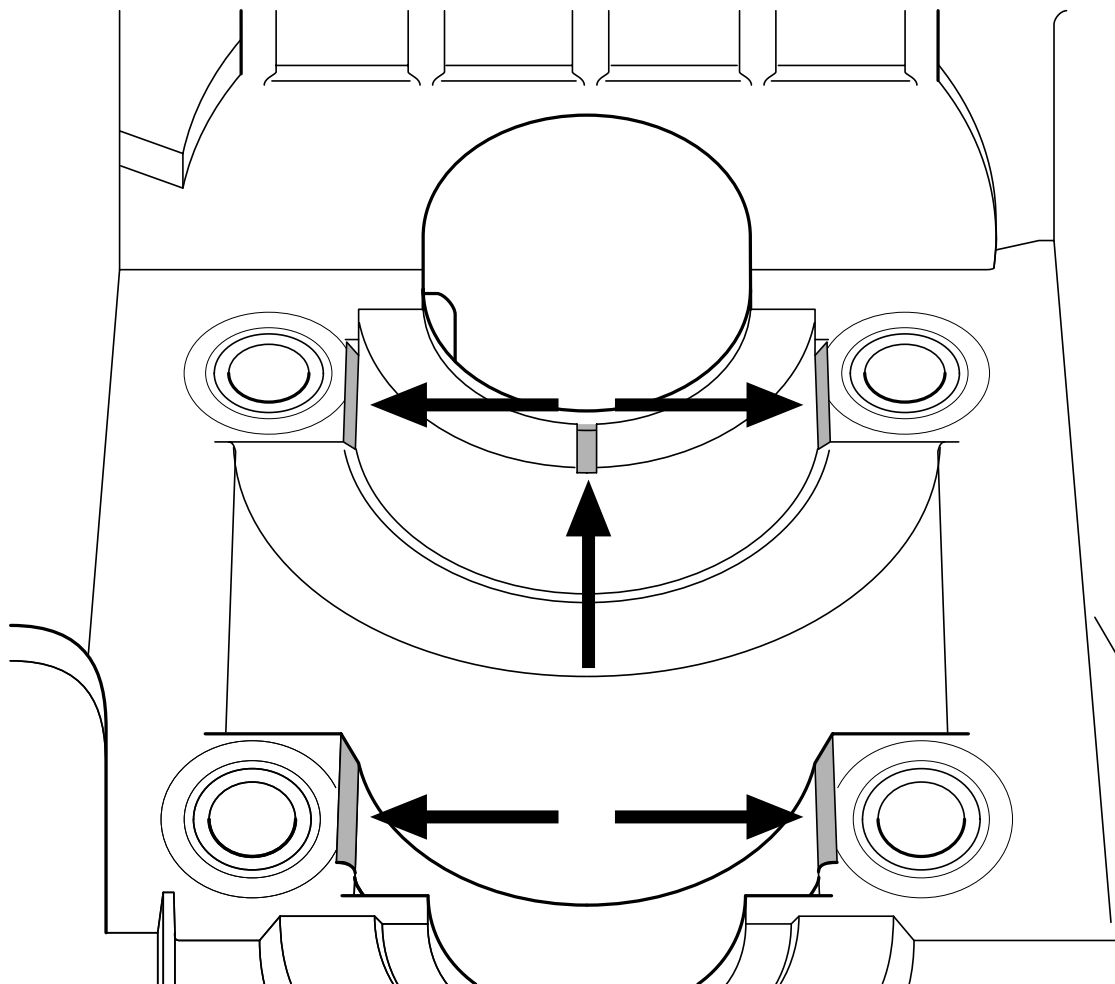



SERVICE 		2
		B0200015

English 3 (3)

Cylinder

The bearing seats on the cylinders have been widened to provide additional space for the expansion of the rubber part of the bearing holders. This change means a further reduction in temperature.

Introduced from serial number: 340 014203601

New part no.	Description	Excl. part no.	Remark
503 87 00-76	Cylinder assy.	503 87 00-73	340

