



SERVICE 		1
		B0100022

English 1 (2)

SB, 225 H, 225 HBV, Crankcase, 2001-03

A new crankcase with plugged holes for the fuel pump (air-purge) is now available. This crankcase should be used on older machines without a fuel pump, manufactured up to 1997.

Also included with the crankcase is a fuel cap with venting valve, as the tank venting is moved from a separate venting valve to the fuel cap.

On machines with a fuel pump, manufactured from 1998, the earlier crankcase 503 77 11-04 should be used.

New part number	Description	Old part number	Remarks
503 77 11-05	Crankcase complete	{ 503 77 11-03 503 77 11-01	

***compl 503 77 11-05**

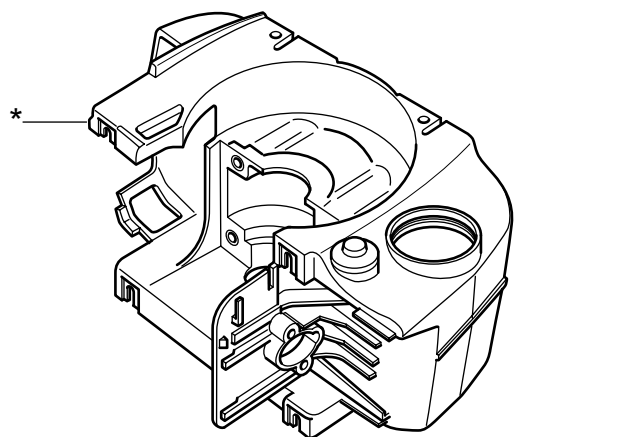

*503 82 80-04

501 27 82-01



Up To Serial Number 7129999



SERVICE 		1
		B0100022

English 2 (2)

503 77 11-04

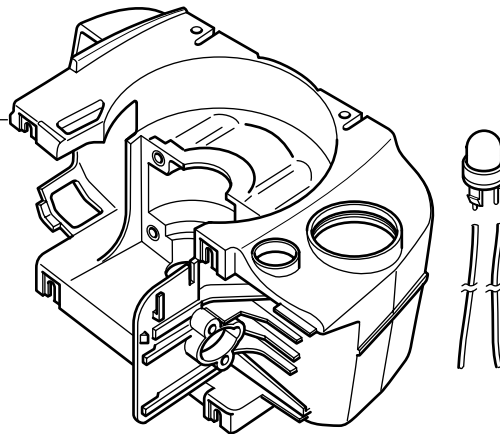

After Serial Number 8010000