

MODEL NO. 2010

Three Speed

MANUFACTURED AFTER NOV., 1977

GEAR RATIO: 1ST. 3.93:1
 2ND. 2.62:1
 3RD. 1.75:1
 REV. 2.62:1

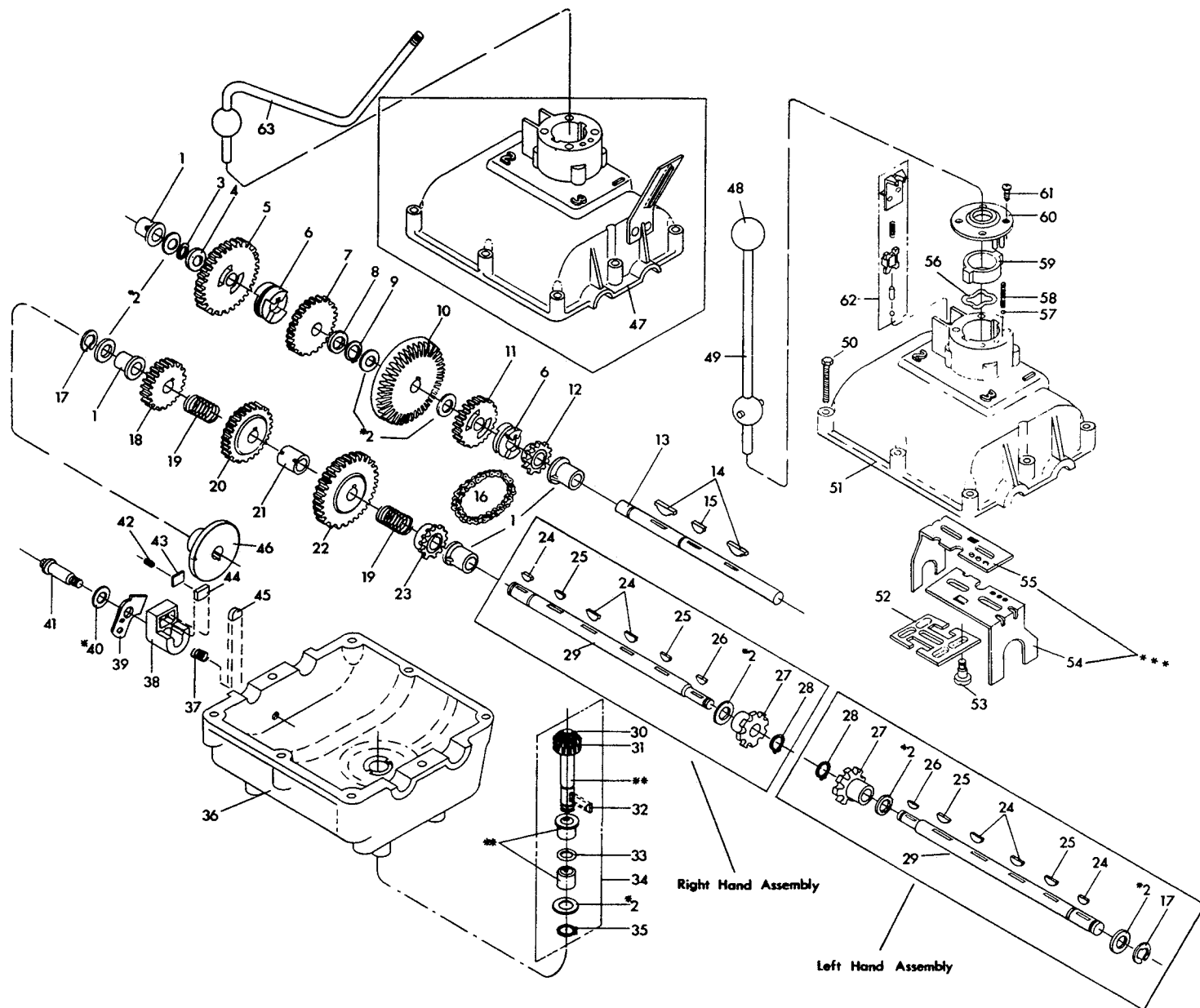

Note: * Use in various combinations to maintain proper clearances.
 ** Order Key No. 34.

*** In servicing all 2010 series transmissions manufactured after September, 1968 care must be taken to reassemble the shifter forks correctly. There must be a left hand and a right hand shifter fork for all units and they must be installed so as to have the three detent holes in the shifter fork in a position relative to the detent hole in the upper housing.

PARTS LIST

Key No.	Footo Part No.	No. Req'd.	Description	Transmission Models Parts Used On	Key No.	Footo Part No.	No. Req'd.	Description	Transmission Models Parts Used On
1	1101	4	Flange Bearing	All models	31	1105	1	16 T. Bevel Pinion	All models
2	1068	*	Washer (.040)	All models	32	1369	1	No. 3 Wdrf. Key	All models
2	1082	*	Washer (.030)	All models	33	1926	1	O-Ring	All models
2	1358	*	Washer (.050)	All models	34	2567	1	Input Shaft Kit Assembly	All models except 2010-73
2	1423	*	Washer (.025)	All models	34	2571	1	Input Shaft Kit Assembly	Model 2010-73
2	1424	*	Washer (.035)	All models	35	1099	1	Retaining Ring	All models
2	1425	*	Washer (.045)	All models	36	1064-A	1	Lower Housing	Model 2010-73
2	1441	*	Washer (.020)	All models	36	1064-N	1	Lower Housing	Model 2010-74
3	3395	1	Spirolox® Retaining Ring	All models	36	1064-R	1	Lower Housing	Model 2010-75
4	3215	1	Spacer, .630 x 1.00 x .203	All models	37	1479	1	Compression Spring	Model 2010-74
5	3142	1	30 T. Spur Gear	All models	38	2618	1	Brake Jaw Assembly	Model 2010-74
6	1083	2	Clutch Collar	Models 2010-73, 2010-74	39	2315	1	Actuating Lever Assembly	Model 2010-74
6	1574	2	Clutch Collar	Model 2010-75	40	1546	*	Washer (.006)	Model 2010-74
7	3141	1	25 T. Spur Gear	All models	41	1477	1	Shoulder Bolt	Model 2010-74
8	3216	1	Spacer, .630 x 1.00 x .277	All models	42	1606	1	No. 8-32 Set Screw	No models
9	1099	1	Retaining Ring	All models	43	3293	1	Spacer, .045	Model 2010-74
10	1085	1	42 T. Bevel Gear	Models 2010-73, 2010-74	44	3295	1	Friction Puck	Model 2010-74
10	3075	1	42 T. Bevel Gear	Model 2010-75	45	3294	1	Friction Puck	Model 2010-74
11	1071	1	20 T. Spur Gear	All models	46	3276	1	Brake Disc	Model 2010-74
12	1087	1	12 T. Special Sprocket	All models	47	2390	1	Upper Housing Assembly	Model 2010-74
13	1443	1	Drive Shaft	All models	48	1318	1	Shift Knob	All models
14	3068	2	Special Hi-Pro Key	All models	49	2683	1	Shift Lever Assembly	Model 2010-73
15	1374	1	No. 9 Wdrf. Key	All models	49	2723	1	Shift Lever Assembly	Model 2010-75
16	1090	1	Chain	All models	50	1360	8	Hx. Hd. S.T. Bolt (1/4-20 x 1 5/16)	All models
17	1106	1	Retaining Ring	All models	51	1065-J	1	Upper Housing	Models 2010-73, 2010-75
18	3149	1	20 T. Spur Gear	All models	52	1074	1	Lock-Out Plate	All models
19	1095	2	Compression Spring	All models	53	1073	4	Shoulder Screw	All models
20	3147	1	25 T. Spur Gear	All models	54	1070	1	Shifter Fork (L.H.)	All models except 2010-75
21	3214	1	Spacer	All models	54	3417	1	Shifter Fork (L.H.)	Model 2010-75
22	3153	1	30 T. Spur Gear	All models	55	1657	1	Shifter Fork (R.H.)	All models except 2010-75
23	1104	1	12 T. Sprocket	All models	55	3418	1	Shifter Fork (R.H.)	Model 2010-75
24	1375	3	No. 61 Alloy Wdrf. Key	All models	56	1096	1	Wave Washer	All models
25	1369	2	No. 3 Alloy Wdrf. Key	All models	57	1037	2	Detent Ball	All models
26	1371	1	No. 4 Alloy Wdrf. Key	All models	58	1475	2	Detent Spring	All models
27	1084	1	8 T. Sprocket	Model 2010-75	59	1091	1	Nylon Insert	All models
27	1089	1	7 T. Sprocket	Model 2010-74	60	1670	1	Nylon Cover	All models
27	3344	1	8 T. Sprocket	Model 2010-73	61	1357	4	Tr. Hd. St. Screw (No. 10-24 x 1/2)	All models
28	1300	1	Retaining Ring	All models	62	2844	1	Switch Kit Assembly	Model 2010-74
29	1094	1	Output Shaft	Models 2010-73, 2010-75	63	2761	1	Shift Lever Assembly	Model 2010-74
29	1473	1	Output Shaft	Model 2010-74					
30	1100	1	Retaining Ring	All models					