

**233400 to 233499**

# Illustrated Parts List

## Model Series 233400 to 233499

TYPE NUMBERS  
0010 through 0061  
0110 through 0350

### TO FIND

**THE CORRECT NUMBER OF THE PART YOU NEED:**

**FOLLOW THE INSTRUCTIONS BELOW**

- A. Refer to Engine Model, Type and Code Number that is stamped on the blower housing of engine. Engine type numbers such as 012301 are listed herein only as 0123. The two digits (01 or 02, etc.) to the right of the space are not needed for parts identification. Then use the Illustrated Parts List covering the Model Series.
- B. Refer to Illustrated Parts section and compare the old part with illustration. The number on the illustration is the Reference Number. Assemblies include all parts shown in frames. All parts shown in assembly frames on which individual reference numbers are given can be purchased separately.
- C. After the Reference Number has been identified, refer to the Numerical Parts List, where Reference and Master Part Number are listed. **THE MASTER PART IS USED ON ALL TYPE NUMBERS EXCEPT THOSE TYPE NUMBERS UNDER "NOTE".**
- D. If a "Note" appears below the Master Part Number, this means that this part differs from the Master Part for certain types. If the Type number is listed under "Note", order the part referred to.
- E. If the Engine Type Number does not appear after any part number listed under "Note", use the Master Part Number.
- F. For Type Numbers higher than those covered by this book, please refer to the factory if you are unable to identify the part by comparison.

PRINTED IN U.S.A.

COPYRIGHT®



# 233400 to 233499

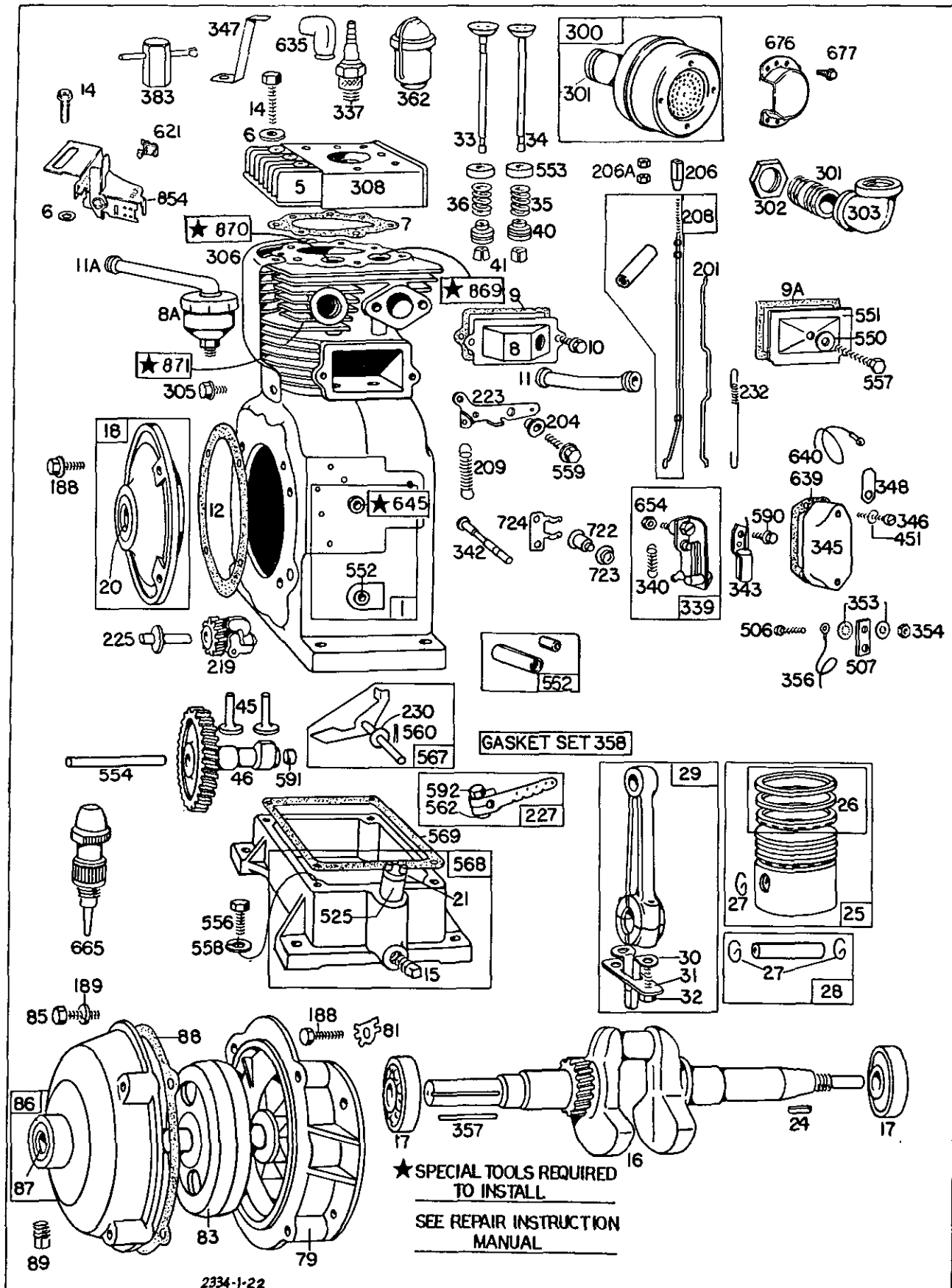

Assemblies include all parts shown in frames.

**233400 to 233499**

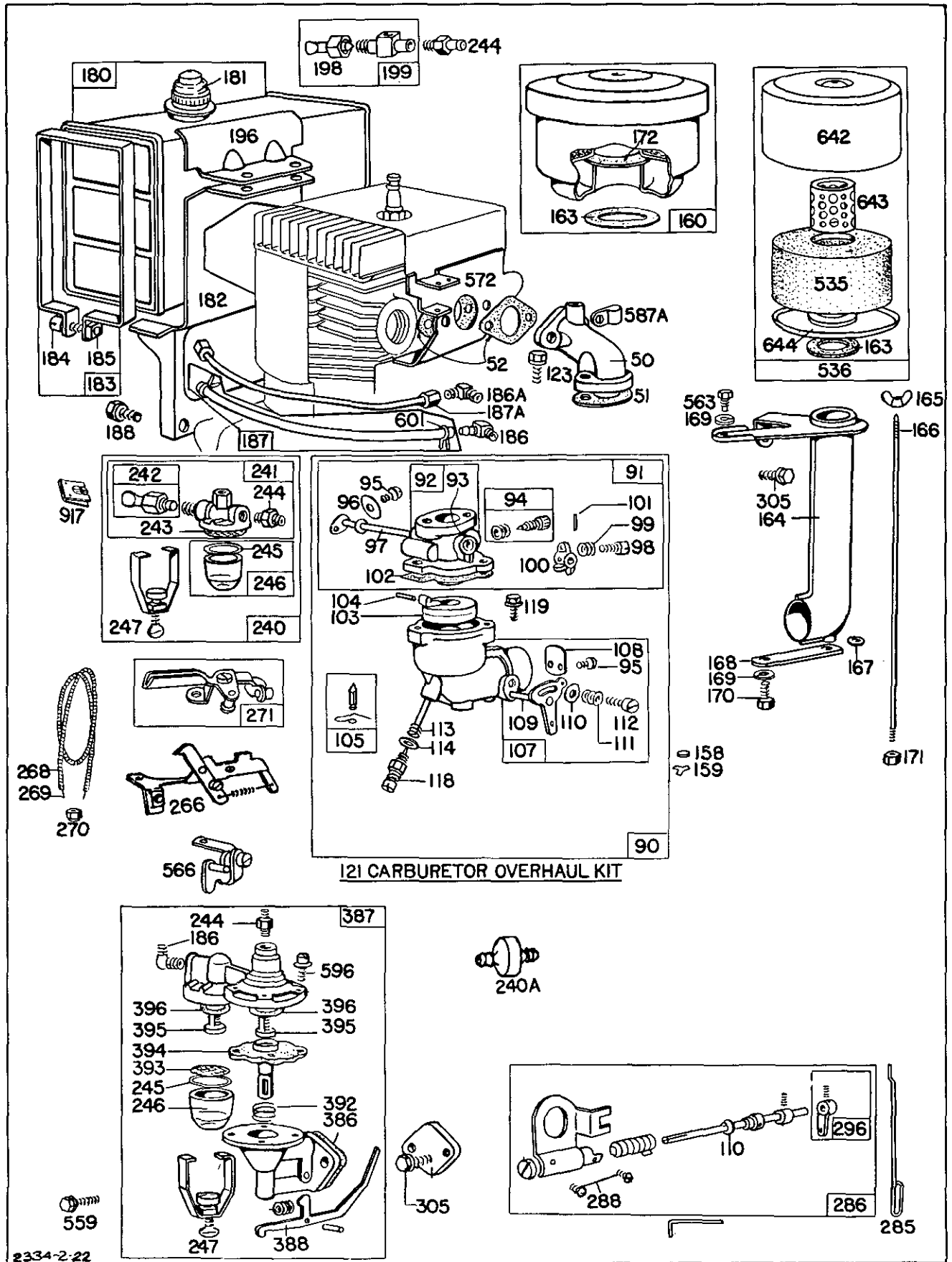

**121 CARBURETOR OVERHAUL KIT**

**387**

Assemblies include all parts shown in frames.





## 233400 to 233499

REF. NO.	PART NO.	DESCRIPTION	REF. NO.	PART NO.	DESCRIPTION	REF. NO.	PART NO.	DESCRIPTION
1	393668	Cylinder Assembly Used after Code No. 7806201. <b>Note:</b> 298202 Cylinder Assy. Used before Code No. 7806211.		280000	Tube— Breather (as Air Cleaner) Used on Type No. 0238.		260764	Crankshaft Used on Type Nos. 0030, 0116, 0128, 0138, 0148, 0150, 0176, 0181, 0184, 0187, 0194, 0195, 0205, 0206, 0214, 0215, 0217, 0223, 0224, 0230, 0235, 0241, 0245, 0258, 0259, 0267, 0272, 0274, 0279, 0285, 0285, 0296, 0304, 0310, 0313, 0324, 0329, 0333, 0335, 0340, 0343.
5	210580	Head—Cylinder <b>Note:</b> 211660 Head—Cyl. Used on Type Nos. 0027, 0031, 0127, 0128, 0147, 0155, 0213, 0221, 0266, 0271, 0281, 0282, 0297, 0299, 0312, 0313, 0318, 0329, 0330, 0334, 0344, 0345, 0346, 0350.	12	*27350	Gasket—Crankcase Cover		260765	Crankshaft Used on Type Nos. 0040, 0185, 0196, 0219.
6	22963	Washer—Cylinder Head	14	92674	Screw—Cylinder Head <b>Note:</b> 93583 Stud—Cylinder Head Used on Type No. 0338.		260776	Crankshaft Used on Type Nos. 0166, 0168, 0228, 0237, 0260, 0275.
7	*270273	Gasket—Cylinder Head	15	91084	Plug—Pipe—3/8"		260777	Crankshaft Used on Type Nos. 0200, 0203, 0227, 0240, 0257.
8	299328	Breather Used after Serial No. 6608081.	16	260761	Crankshaft <b>Note:</b> 260510 Crankshaft Used on Type Nos. 0210, 0305, 0311.		260780	Crankshaft Used on Type Nos. 0126, 0131, 0139, 0144, 0174, 0341.
8A	297704	Breather Used before Serial No. 6608091. <b>Note:</b> 294630 Breather Used on Type Nos. 0152, 0177, 0182, 0187.		260580	Crankshaft Used on Type Nos. 0060, 0182.		260781	Crankshaft Used on Type Nos. 0132, 0140, 0177, 0244, 0247, 0308, 0321.
9	*27803	Gasket—Valve Cover Used after Serial No. 6608081.		260581	Crankshaft Used on Type No. 0323.		260782	Crankshaft Used on Type No. 0161.
9A	*66214	Gasket—Valve Cover Used before Serial No. 6608091.		260760	Crankshaft Used on Type Nos. 0021, 0112, 0137, 0162, 0226, 0236, 0251, 0261, 0271, 0281, 0299, 0344.		260804	Crankshaft Used on Type Nos. 0022, 0268.
10	93394	Screw—Breather Mtg. Sem Used after Serial No. 6608081.		260762	Crankshaft Used on Type Nos. 0026, 0114, 0136, 0141, 0180, 0198, 0209, 0213, 0220, 0255, 0264, 0266, 0282, 0297, 0298, 0318, 0332, 0341.		260806	Crankshaft Used on Type No. 0133.
11	68818	Tube—Breather Used after Serial No. 6608081.		260763	Crankshaft Used on Type Nos. 0024, 0115, 0120, 0121, 0124, 0125, 0130, 0143, 0155, 0160, 0165, 0169, 0175, 0178, 0192, 0199, 0211, 0222, 0231, 0253, 0263, 0277, 0283, 0284, 0293, 0294, 0316, 0350.		260807	Crankshaft Used on Type Nos. 0191, 0278, 0337.
11A	67068	Tube—Breather Used before Serial No. 6608091. <b>Note:</b> 221984 Clamp— Breather Tube Used on Type Nos. 0135, 0168, 0192, 0225, 0237, 0240, 0305.					261174	Crankshaft Used on Type Nos. 0039, 0289, 0301, 0315, 0322.

\*Included in Gasket Set—  
Part No. 291728.

**233400 to 233499**

REF. NO.	PART NO.	DESCRIPTION	REF. NO.	PART NO.	DESCRIPTION	REF. NO.	PART NO.	DESCRIPTION
	<b>261275</b>	Crankshaft Used on Type No. 0307.	<b>21</b>	<b>66768</b>	Plug—Oil Filler	<b>28</b>	<b>298401</b>	Pin Assy.—Piston—Standard
	<b>261422</b>	Crankshaft Used on Type No. 0061.	<b>23</b>	<b>298975</b>	Flywheel—Magneto <b>391116</b> Flywheel—Magneto	<b>294681</b>		Pin Assembly—Piston— .005" O.S. <i>The above Piston Pins are used after Serial No. 6608151.</i>
	<b>261456</b>	Crankshaft Used on Type No. 0325.	<b>24</b>	<b>61760</b>	Key—Flywheel	<b>Note:</b>	<b>69925</b>	Pin Assy.—Piston—Standard
	<b>261457</b>	Crankshaft Used on Type No. 0326.	<b>25</b>	<b>294676</b>	Piston Assembly—Standard	<b>29103</b>		Pin Assy.—Piston— .005" O.S. <i>Part No. 69925 and 29103.</i> <i>Piston Pins are used before Serial No. 6608161.</i>
	<b>261458</b>	Crankshaft Used on Type Nos. 0041, 0327, 0328, 0331.	<b>294677</b>		Piston Assembly— .010" O.S.	<b>29</b>	<b>298400</b>	Rod Assy.—Connecting Used after Serial No. 6608151. For Connecting Rod with .020" Undersize Crankpin Bore—Order No. 390304.
	<b>261548</b>	Crankshaft Used after Code No. 77072400. ( <b>260778</b> Crankshaft Used before Code No. 77072500.)	<b>294678</b>		Piston Assembly— .020" O.S.	<b>Note:</b>	<b>291647</b>	Rod Assy.—Connecting Used before Serial No. 6608161. For Connecting Rod with .020" Undersize Crankpin Bore—Order No. 295362.
	<b>261548</b>	Crankshaft Used after Code No. 77072400. ( <b>260778</b> Crankshaft Used before Code No. 77072500.)	<b>294679</b>		Piston Assembly— .030" O.S. <i>The above Pistons are used after Serial No. 6608151.</i>	<b>30</b>	<b>220805</b>	Dipper—Connecting Rod
<b>17</b>	<b>291667</b>	Bearing—Ball	<b>Note:</b>	<b>99947</b>	Piston Assy.—Standard	<b>31</b>	<b>22946</b>	Lock—Conn. Rod Screw
<b>18</b>	<b>291283</b>	Cover Assy.—Crankcase (Plain Bearing) Used only on Models 233401 to 233409 Engines.	<b>99948</b>		Piston Assy.— .010" O.S.	<b>32</b>	<b>230557</b>	Screw—Connecting Rod <b>The Following Exhaust Valves are Used after Code No. 81082400.</b>
	<b>Note:</b>	<b>291665</b> Cover Assy.—Crankcase (Ball Bearing) Used only on Model 233431 to 233439 Engines.	<b>99949</b>		Piston Assy.— .020" O.S.	<b>33</b>	<b>261582</b>	Valve—Exhaust <b>Note:</b> <b>261584</b> Valve—Exhaust Used on Type Nos. 0024, 0025, 0122, 0140, 0143, 0152, 0166, 0169, 0173, 0174, 0182, 0191, 0201, 0202, 0207,
	<b>291710</b>	Cover Assy.—Crankcase (Ball Bearing) Used on Type Nos. 0131, 0133, 0136, 0141, 0160, 0162, 0207, 0209, 0263, 0264, 0266, 0277, 0281, 0293, 0294, 0299, 0318, 0319, 0323, 0326.	<b>99950</b>		Piston Assy.— .030" O.S. <i>The above Pistons under Note are used before Serial No. 6608161.</i>			
<b>20</b>	<b>391086</b>	Seal—Oil <b>Note:</b> <b>291675</b> Seal—Oil Used in Crankcase Covers on Model 233431 to 233436 Engines.	<b>PISTON RING SETS:</b>					
			<b>Note:</b>	<b>26</b>	<b>292100</b>	Ring Set—Piston—Std.		
				<b>292101</b>		Ring Set—Piston— .010" O.S.		
				<b>292102</b>		Ring Set—Piston— .020" O.S.		
				<b>292103</b>		Ring Set—Piston— .030" O.S.		
			<b>27</b>	<b>68546</b>	Lock—Piston Pin Used after Serial No. 6608152.			
			<b>Note:</b>	<b>65776</b>	Lock—Piston Pin Used before Serial No. 6608161.			

## 233400 to 233499

REF. NO.	PART NO.	DESCRIPTION	REF. NO.	PART NO.	DESCRIPTION	REF. NO.	PART NO.	DESCRIPTION
		0208, 0222, 0224, 0227, 0228, 0231, 0233, 0236, 0239, 0242, 0258, 0260, 0261, 0264, 0275, 0277, 0278, 0283, 0293, 0294, 0299, 0314, 0316, 0317, 0319, 0329, 0330, 0335, 0337, 0339, 0340.			0293, 0294, 0299, 0314, 0316, 0317, 0319, 0329, 0330, 0335, 0337, 0339, 0340.			<b>26833</b> Spring— Exhaust Valve Used on Type No. 0198.
		<b>The Following Exhaust Valves are Used before Code No. 81082500.</b>			<b>The Following Intake Valves are Used Before Code No. 81082500.</b>	<b>40</b>	<b>68293</b>	Retainer—Valve Spring Collar <b>Note:</b> <b>292260</b> Rotocoil—Exhaust Valve Used on Type Nos. 0021, 0024, 0025, 0026, 0120, 0122, 0136, 0137, 0140, 0141, 0143, 0152, 0160, 0166, 0168, 0169, 0173, 0174, 0178, 0180, 0182, 0191, 0201, 0202, 0204, 0207, 0208, 0222, 0224, 0227, 0228, 0231, 0233, 0235, 0236, 0239, 0242, 0258, 0260, 0261, 0263, 0264, 0275, 0277, 0278, 0283, 0293, 0294, 0298, 0299, 0314, 0316, 0317, 0319, 0329, 0330, 0335, 0337, 0339, 0340.
<b>23923</b>		Valve—Exhaust	<b>23922</b>		Valve—Intake			
<b>Note:</b>	<b>261207</b>	Valve—Exhaust Used on Type Nos. 0024, 0025, 0122, 0140, 0143, 0152, 0166, 0169, 0173, 0174, 0182, 0191, 0201, 0202, 0207, 0208, 0222, 0224, 0227, 0228, 0231, 0233, 0236, 0239, 0242, 0258, 0260, 0261, 0264, 0275, 0277, 0278, 0283, 0293, 0294, 0299, 0314, 0316, 0317, 0319, 0329, 0330, 0335, 0337, 0339, 0340.	<b>Note:</b>	<b>23923</b>	Valve—Intake Used on Type Nos. 0024, 0025, 0122, 0140, 0143, 0152, 0166, 0169, 0173, 0174, 0182, 0191, 0201, 0202, 0207, 0208, 0222, 0224, 0227, 0228, 0231, 0233, 0236, 0239, 0242, 0258, 0260, 0261, 0264, 0275, 0277, 0278, 0283, 0293, 0294, 0299, 0314, 0316, 0317, 0319, 0329, 0330, 0335, 0337, 0339, 0340.	<b>41</b>	<b>93630</b>	Collar—Valve Spring <b>Note:</b> <b>68283</b> Collar—Valve Spring Used before Code No. 81082500.
<b>34</b>	<b>261581</b>	Valve—Intake	<b>35</b>	<b>65906</b>	Spring—Intake Valve			
<b>Note:</b>	<b>261582</b>	Valve—Intake Used on Type Nos. 0024, 0025, 0122, 0140, 0143, 0152, 0166, 0169, 0173, 0174, 0182, 0191, 0201, 0202, 0207, 0208, 0222, 0224, 0227, 0228, 0231, 0233, 0236, 0239, 0242, 0258, 0260, 0261, 0264, 0275, 0277, 0278, 0283,	<b>36</b>	<b>65906</b>	Spring—Exhaust Valve			
		<b>The Following Intake Valves are Used After Code No. 81082400.</b>	<b>Note:</b>	<b>26828</b>	Spring—Exhaust Valve Used on Type Nos. 0021, 0024, 0025, 0026, 0120, 0122, 0136, 0137, 0140, 0141, 0143, 0152, 0160, 0166, 0168, 0169, 0173, 0174, 0178, 0180, 0182, 0191, 0201, 0202, 0204, 0207, 0208, 0222, 0224, 0227, 0228, 0231, 0233, 0235, 0236, 0239, 0242, 0258, 0260, 0261, 0263, 0264, 0275, 0277, 0278, 0283, 0293, 0294, 0298, 0299, 0314, 0316, 0317, 0319, 0329, 0330, 0335, 0337, 0339, 0340.	<b>45</b>	<b>26670</b>	Tappet—Valve
						<b>46</b>	<b>211335</b>	Gear—Cam
						<b>50</b>	<b>21920</b>	Elbow—Carburetor Intake
						<b>51</b>	<b>†*270684</b>	Gasket—Intake Elbow
						<b>52</b>	<b>*27381</b>	Gasket—Intake Elbow Mounting
						<b>55</b>	<b>298402</b>	Housing—Rewind Starter <b>Note:</b> <b>392589</b> Housing—Rewind Starter <b>Uses:</b> <b>90356</b> Nut—Hex. <b>92290</b> Lockwasher Used on Type Nos. 0041, 0061, 0325, 0326, 0327, 0328, 0331.

\*Included in Gasket Set—  
Part No. 291728.

†Included in Carburetor Overhaul  
Kit—Part No. 291763.



**233400 to 233499**

REF. NO.	PART NO.	DESCRIPTION	REF. NO.	PART NO.	DESCRIPTION	REF. NO.	PART NO.	DESCRIPTION		
56	392630	Pulley—Rewind Starter Includes 63" Rope <b>Note:</b> If longer Rope is required, Order Rope No. 66894 and cut to length.	68	63770	Ball—Clutch		92909	Screw—Link Anchor Mounting Used on Type Nos. 0023, 0135, 0139, 0144, 0145, 0153, 0164, 0170, 0173, 0186, 0187, 0188, 0202, 0211, 0225, 0311, 0317.		
57	294303	Spring—Rewind Starter	69	66718	Washer—Starter Clutch Thrust		291354	Cover Assy.—Gear Case <b>Note:</b> 290574 Cover Assy.—Gear Case <b>Includes:</b> 22723 Shim—.003" thick 22724 Shim—.010" thick 63899 Cup—Bearing 69858 Seal—Oil Used on Type Nos. 0040, 0185, 0196, 0219.		
58	66884	Rope—63" for use with Plastic Pulley <b>Note:</b> If longer Rope is required, Order Rope No. 66894 and cut to length.	70	298799	Ratchet—Rewind Starter Clutch		86	291354	Cover Assy.—Gear Case <b>Note:</b> 290574 Cover Assy.—Gear Case <b>Includes:</b> 22723 Shim—.003" thick 22724 Shim—.010" thick 63899 Cup—Bearing 69858 Seal—Oil Used on Type Nos. 0040, 0185, 0196, 0219.	
	66564	Rope—63" for use with Metal Pulley <b>Note:</b> If longer Rope is required, Order Rope No. 66574 and cut to length.	71	221653	Washer—Retainer		87	391086	Seal—Oil	
59	230228	Pin—Starter Grip	74	93042	Screw—Sem		88	27328	Gasket—Gear Case Cover <b>Note:</b> 68247 Gasket—Gear Case Cover Used on Type Nos. 0040, 0185, 0196, 0219.	
60	66728	Grip—Starter Rope	74A	93808	Screw—Rotating Screen Mounting			89	91488	Plug—Sq. Hd., 1/8", Pipe
61	68848	Bumper—Starter Pulley	75	93824	Washer	81	220790	Lock—Gear Case Mounting Screw		
62	93254	Screw—Pulley Bumper Mounting Sem	76	68238	Seal—Ratchet Sealing			90	293950	Carburetor Assembly <b>Note:</b> 291427 Carburetor Assembly Used on Type Nos. 0200, 0203, 0227, 0228, 0257, 0320, 0338. 291746 Carburetor Assy. Used on Type Nos. 0166, 0168, 0237, 0240.
63	260414	Spring—Ratchet	79	291357	Case Assembly—Gear <b>Note:</b> 291712 Case Assy.—Gear <b>Includes:</b> 63382 Cup—Bearing 230012 Pin—Washer Retainer 220064 Washer—Thrust Used on Type Nos. 0040, 0185, 0196, 0219.					
64	230543	Adapter—Ratchet Spring <b>Note:</b> 231118 Adapter—Ratchet Spring Used on Type Nos. 0041, 0061, 0325, 0326, 0327, 0328, 0331.				83	291762	Shaft Assembly—Drive <b>Note:</b> 290638 Drive Shaft, Gear and Bearing Assembly Used on Type Nos. 0040, 0185, 0196, 0219. 292470 Shaft Assy.—Drive Used on Type No. 0215.		
65	93686	Screw—Rewind Starter Housing Mtg. Sem								
66	298798	Clutch Assembly—Rewind Starter <b>Note:</b> 393127 Clutch Assy.—Rewind Starter Used on Type Nos. 0041, 0061, 0325, 0326, 0327, 0328, 0331.	85	91386	Screw—Gear Case Cover and Link Anchor Mtg. (2" long) <b>Note:</b> 92279 Screw—Gear Case Cover (1-1/2" long) Used on Type Nos. 0040, 0185, 0196, 0219.					
67	212132	Housing—Rewind Starter <b>Note:</b> 261455 Housing—Rewind Starter Used on Type Nos. 0041, 0061, 0325, 0326, 0327, 0328, 0331.								

## 233400 to 233499

REF. NO.	PART NO.	DESCRIPTION	REF. NO.	PART NO.	DESCRIPTION	REF. NO.	PART NO.	DESCRIPTION
	<b>292106</b>	Carburetor Assembly Used on Type Nos. 0027, 0031, 0127, 0128, 0147, 0155, 0213, 0221, 0266, 0271, 0281, 0282, 0297, 0299, 0312, 0313, 0318, 0329, 0330, 0334, 0344, 0345, 0346, 0350.	<b>108</b>	<b>62872</b>	Valve—Choke <b>Note:</b> <b>22954</b> Valve—Choke Used on Type Nos. 0135, 0166, 0168, 0192, 0225, 0237, 0240, 0305.	<b>158</b>	<b>27590</b>	Filter—Carburetor Drin
	<b>293948</b>	Carburetor Assembly Used on Type Nos. 0135, 0192, 0225, 0305.	<b>109</b>	<b>89531</b>	Shaft and Lever—Choke <b>Note:</b> <b>291747</b> Shaft, Vane and Lever Assembly—Automatic Choke <b>291776</b> Lever Assy.—Automatic Choke Used on Type Nos. 0135, 0166, 0168, 0192, 0225, 0237, 0240, 0305.	<b>159</b>	<b>220521</b>	Retainer—Filter
	<b>297498</b>	Carburetor Assembly Used on Type Nos. 0125, 0160, 0277, 0293, 0294.	<b>110</b>	<b>62899</b>	Washer—Choke Lever and Thermostat	<b>160</b>	<b>393858</b>	Cleaner Assembly—Air
<b>91</b>	<b>291655</b>	Body Assembly—Upper Carburetor	<b>111</b>	<b>26155</b>	Spring—Choke Lever	<b>163</b>	<b>*67247</b>	Gasket—Air Cleaner Mounting
<b>92</b>	<b>99375</b>	Body—Upper Carburetor	<b>112</b>	<b>23123</b>	Screw—Choke Lever	<b>164</b>	<b>299504</b>	Pipe—Air Cleaner Used after Serial No. 6608081. <b>Note:</b> <b>291462</b> Pipe—Air Cleaner Used before Serial No. 6608091.
<b>93</b>	<b>23108</b>	Bushing—Throttle Shaft	<b>113</b>	<b>†390395</b>	Nozzle—Carburetor			<b>294632</b> Pipe—Air Cleaner Used before Serial No. 6608091.
<b>94</b>	<b>†292681</b>	Valve Assembly—Carburetor Idle	<b>114</b>	<b>†68667</b>	Gasket—Nozzle			
<b>95</b>	<b>93499</b>	Screw—Choke and Throttle Valve Mtg. Sem	<b>118</b>	<b>†99525</b>	Valve Assy.—Needle <b>Note:</b> <b>391213</b> Valve Assy.—Needle <b>Uses:</b> <b>292226</b> Retainer Assy.—Needle Valve <b>68677</b> Packing—Needle Valve <b>23118</b> Nut—Needle Valve Packing Used on Type Nos. 0027, 0031, 0127, 0128, 0147, 0155, 0213, 0221, 0266, 0271, 0281, 0282, 0297, 0299, 0312, 0313, 0318, 0329, 0330, 0334, 0344, 0345, 0346, 0350.	<b>165</b>	<b>93453</b>	Nut—Wing
<b>96</b>	<b>62940</b>	Valve—Throttle	<b>119</b>	<b>93496</b>	Screw—Hex. Hd.	<b>166</b>	<b>297749</b>	Stud—Air Cleaner <b>Note:</b> <b>295145</b> Stud—Air Cleaner Used on Type Nos. 0123, 0131, 0152, 0182, 0253, 0256, 0261, 0265, 0266, 0269, 0281, 0282, 0297, 0299.
<b>97</b>	<b>291300</b>	Shaft Assembly—Throttle	<b>121</b>	<b>291763</b>	Carburetor Overhaul Kit			<b>295947</b> Stud—Air Cleaner Used on Type Nos. 0138, 0259, 0267, 0289, 0301, 0327, 0333.
<b>98</b>	<b>91920</b>	Screw—Machine, Fill. Hd.—8-32 x 5/8"	<b>123</b>	<b>93415</b>	Screw—Sem <b>Note:</b> <b>93587</b> Screw—Sem (1) Used to mount Carburetor and Idling Device on Type Nos. 0142, 0177, 0188, 0189, 0191, 0218, 0280.	<b>167</b>	<b>65978</b>	Seal—Air Cleaner Stud
<b>99</b>	<b>26157</b>	Spring—Throttle Adjustment				<b>168</b>	<b>222707</b>	Strap—Air Cleaner Pipe
<b>100</b>	<b>61967</b>	Stop—Throttle						
<b>101</b>	<b>93043</b>	Pin—Throttle Lever						
<b>102</b>	<b>†27034</b>	Gasket—Carburetor Body						
<b>103</b>	<b>99333</b>	Float—Carburetor						
<b>104</b>	<b>†230896</b>	Pin—Float Hinge						
<b>105</b>	<b>†299096</b>	Valve—Fuel Inlet						
<b>107</b>	<b>89915</b>	Body Assembly—Lower Carburetor <b>Note:</b> <b>291745</b> Body Assy.—Lower Carburetor Used on Type Nos. 0135, 0166, 0168, 0192, 0225, 0237, 0240, 0305.						

\*Included in Gasket Set—Part No. 291728.

†Included in Carburetor Overhaul Kit—Part No. 291763.

**233400 to 233499**

REF. NO.	PART NO.	DESCRIPTION	REF. NO.	PART NO.	DESCRIPTION	REF. NO.	PART NO.	DESCRIPTION
169	90832	Washer—Lock— 1/4 x 3/32 x 5/64"	181	392301	Cap—Fuel Tank <b>Note:</b> 69221 Cap—Fuel Tank Used on Type No. 0318.	187A	391498	Pipe—Fuel <b>Note:</b> All Fuel Pipes listed below are metal pipes.
170	91468	Screw—Cap, Hex. Hd.— 1/4-20 x 3/8"			297866 Cap—Fuel Tank Used on Type No. 0287.			291703 Pipe—Fuel Used between Carburetor and Fuel Pump on Type Nos. 0166, 0168, 0200, 0203, 0227, 0228, 0237, 0257.
171	92129	Nut—Hex.—1/4-28	182	22813	Bracket—Fuel Tank			291704 Pipe—Fuel— 18" long
172	27401	Gasket—Air Cleaner	183	291490	Strap Assy.—Fuel Tank <b>Note:</b> 291367 Strap Assy.— Fuel Tank Used on Type Nos. 0135, 0217.			89248 Pipe—Fuel— 2-1/4" long
180	291488	Tank Assembly— Fuel (6 Quart) <b>Note:</b> 290816 Tank Assy.— Fuel (4 Quart) Used on Type Nos. 0135, 0217. 291513 Tank Assy.— Fuel (Gasoline-Kerosene) Used on Type Nos. 0027, 0031, 0127, 0128, 0147, 0155, 0213, 0221, 0266, 0271, 0281, 0282, 0297, 0299, 0312, 0313, 0318, 0329, 0330, 0334, 0344, 0345, 0346, 0350. 292415 Tank Assy.— Fuel (8 Quart) Used on Type Nos. 0025, 0129, 0138, 0140, 0146, 0187, 0200, 0206, 0208, 0214, 0220, 0234, 0259, 0267, 0269, 0273, 0288, 0289, 0292, 0294, 0296, 0301, 0327, 0333. 293024 Tank Assy.— Fuel (8 Quart) <b>Uses:</b> 92958 Plug 293007 Strainer—Fuel Used on Type No. 0258. 293600 Tank Assy.— Fuel (6 Quart) <b>Uses:</b> 92958 Plug 293007 Strainer—Fuel Used on Type Nos. 0227, 0228.	184	91257	Screw—Machine, Fill. Hd.—1/4-20 x 1-1/4"			92655 Tee Used on Type Nos. 0027, 0031, 0127, 0128, 0147, 0155, 0213, 0221, 0266, 0271, 0281, 0282, 0297, 0299, 0312, 0313, 0318, 0329, 0330, 0334, 0344, 0345, 0346, 0350. 293756 Pipe—Fuel Used on Type No. 0258. 296541 Pipe—Fuel Used on Type No. 0240. 296576 Pipe—Fuel Used on Type No. 0165.
			185	90970	Nut—Square—1/4-20	188	93535	Screw—Sem
			186	67218	Connector—Fuel Pipe (For Flexible Tubing)	189	90366	Washer—Lock— 5/16 x 1/8" x 1/16"
			186A	63377	Connector—Fuel Pipe (For Metal Fuel Pipe) <b>Note:</b> 93017 Connector—Fuel Pipe Used on Type No. 0258.	192	91397	Nut—Hex. 5/16-18
			187	296004	Pipe—Fuel (Flexible) (23" long) <b>Note:</b> 293646 Pipe—Fuel (Flexible) 293059 Cap Assy.— Elbow 292370 Valve—Fuel Shut-Off 93037 Elbow 90° (At Lower Pipe and Valve) 92953 Elbow—90° (At Lower Shut-Off Valve Outlet) The above Fuel Pipe and Fittings are used between the Fuel Tank and Fuel Pump on Type Nos. 0203, 0227, 0228, 0257. 299146 Pipe—Fuel (Flexible—28" long) Used on Type Nos. 0129, 0200.	196	22907	Support—Upper Fuel Tank
						198	293934	Valve—Fuel Shut-Off
						199	297563	Connector—Fuel Pipe
						201	26725	Link—Throttle
						204	23849	Bushing—Control Lever
						204A	231193	Bushing—Governor Crank
						206	21772	Nut—Governor Adjusting
						206A	93422	Stopnut—Hexagon
						208	393613	Rod—Governor Control
						209	26764	Spring—Governor

**233400 to 233499**

REF. NO.	PART NO.	DESCRIPTION	REF. NO.	PART NO.	DESCRIPTION	REF. NO.	PART NO.	DESCRIPTION
219	393720	Gear Assembly—Governor Used after Code No. 7806201. <b>Note:</b> 291192 Gear Assy.—Governor Used before Code No. 7806211.		293896	Cover Assy.—Fuel Filter Used on Type No. 0258.			<b>Note:</b> If longer wire is required, specify length in inches; if shorter wire is needed, Order No. 26633 and cut to required length.
223	22814	Lever—Governor Control <b>Note:</b> Lever-Governor Control Used on Type Nos. 0138, 0267, 0289, 0301, 0327, 0333 is furnished by the Equipment Manufacturer. 299428 Lever Assy.—Governor Control <b>Uses:</b> 92287 Screw—Swivel Used on Type No. 0140.	242	295913	Valve and Cover—Fuel Shut-Off	270	63426	Locknut—Control Wire Casing
225	393467	Shaft—Governor Gear Used after Code No. 7806201. <b>Note:</b> 291177 Shaft—Gov. Gear Used before Code No. 7806211.	243	22547	Screen—Fuel Filter	271	290568	Lever Assembly—Control <b>Note:</b> 93469 Screw—Sem Used to mount Control Lever on Type Nos. 0126, 0131, 0134, 0144, 0150, 0153, 0162, 0181, 0190, 0197, 0198, 0229, 0230, 0246, 0249, 0250, 0272, 0307, 0325.
227	291365	Lever Assy.—Governor	244	230318	Connector—Fuel Pipe Used with Flexible Fuel Pipe <b>Note:</b> 231238 Connector—Fuel Pipe Used with Metal Fuel Pipe 63377 Connector—Fuel Pipe Used on Type No. 0240. 92780 Connector—Fuel Pipe Used to connect Fuel Pipe to Fuel Pump on Type Nos. 0203, 0227, 0228, 0257.	285	26684	Link—Choke
230	22826	Washer—Governor Crank	245	*68477	Gasket—Fuel Filter Bowl	286	291445	Thermostat Assy.
232	260584	Spring—Governor Link	246	298683	Bowl—Fuel Filter	288	93141	Screw—Sem
240	393169	Filter Assembly—Fuel Used with Flexible and Metal Fuel Pipe. <b>Note:</b> 293895 Filter Assy.—Fuel Used on Type No. 0258.	247	99665	Yoke Assembly—Fuel Filter	296	291044	Lever Assembly—Thermostat
240A	394358	Filter—Fuel	258	93062	Screw—Sem	300	299477	Muffler and Pipe Assy. (For Muffler only, Order No. 392989) <b>Note:</b> 291519 Muffler—Exhaust Used on Type Nos. 0121, 0129, 0195, 0200, 0238, 0241, 0248, 0262, 0280, 0308, 0309, 0310, 0320, 0338. 293459 Muffler—Exhaust Used on Type Nos. 0228, 0258, 0261.
241	296005	Cover Assembly—Fuel Filter Used with Flexible Fuel Pipe <b>Note:</b> 99909 Cover Assy.—Fuel Filter Used with Metal Fuel Pipe	266	392150	Control—Throttle <b>Uses:</b> 261322 Spring—Return <b>Note:</b> 291460 Control—Throttle (Disc Type)	301	92107	Nipple—Exhaust Pipe (4" long) <b>Note:</b> 91416 Nipple—Exhaust Pipe (1-1/2" long)
			268	65616	Casing—Control Wire—72" long <b>Note:</b> If longer casing is required, specify length in inches; if shorter casing is needed, Order No. 65616 and cut to required length.	302	91310	Locknut—Muffler
			269	260769	Wire—Control—78" long	303	91296	Elbow—Exhaust 90°, Pipe <b>Note:</b> 91415 Elbow—Exhaust 45°, Pipe Used on Type Nos. 0172, 0228, 0238, 0258, 0267, 0289, 0297, 0301, 0327, 0333.

\*Included in Gasket Set—Part No. 291728.

**233400 to 233499**

REF. NO.	PART NO.	DESCRIPTION	REF. NO.	PART NO.	DESCRIPTION	REF. NO.	PART NO.	DESCRIPTION
304	291407	<p>91308 Elbow—Exhaust, 90° Street Used on Type No. 0335.</p> <p>Housing—Blower <b>Note:</b> 294698 Housing—Blower Used on Type Nos. 0133, 0138, 0140, 0239, 0259, 0262, 0267, 0314, 0321, 0333, 0338.</p> <p>297010 Housing—Blower Used on Type Nos. 0039, 0060, 0182, 0289, 0301, 0307, 0315, 0322, 0323, 0331.</p> <p>297453 Housing—Blower Used on Type Nos. 0023, 0135, 0139, 0144, 0145, 0153, 0164, 0170, 0173, 0186, 0187, 0188, 0202, 0211, 0225, 0250, 0254, 0268, 0300, 0305, 0311, 0317.</p> <p>297766 Housing—Blower Used on Type Nos. 0010, 0020, 0210, 0303, 0335, 0341,</p> <p>392343 Housing—Blower Used on Type Nos. 0041, 0061, 0325, 0326, 0327, 0328.</p>	323	67918	<p>V-Belt (For low position mtg.) <b>Note:</b> 68878 V-Belt (For high position mounting) Used on Type No. 0296.</p> <p>323A 296499 V-Belt Set (Consists of Matched Set of 2) <b>Note:</b> 296500 V-Belt Set (Consists of Matchet Set of 2) Used on Type Nos. 0129, 0200, 0206, 0240.</p> <p>324 392349 Screen and Support Assembly <b>Note:</b> 220802 Screen (Mounted to Flywheel) 220803 Support—Screen 230397 Spacer (4) 93415 Screw (4) 67632 Washer—Plain (4) Used on Type Nos. 0039, 0060, 0133, 0140, 0152, 0158, 0182, 0239, 0259, 0262, 0267, 0289, 0301, 0307, 0314, 0315, 0322, 0323.</p> <p>324A 221851 Screen—Rotating <b>Note:</b> 222044 Screen—Rotating Used on Type No. 0296.</p> <p>325 299308 Pulley—Starter (With Screen)</p> <p>328 221531 Guard—Belt</p> <p>329 93158 Screw—Belt Guard Mounting Sem</p> <p>332 230674 Nut—Flywheel</p> <p>333 298968 Armature Assembly <b>Note:</b> 299700 Armature Assy. Used on Type Nos. 0227, 0228, 0231, 0258, 0261.</p>	334	93381	<p>Screw—Armature to Mounting Bracket Sem <b>Note:</b> 92791 Washer—Lock—Shakeproof Used to mount Ground Wire and Shielding Terminals to Back Plate on Type Nos. 0227, 0228, 0231, 0258, 0261.</p> <p>337 298809 Plug—Spark (1-1/2" High—37-42 M.M.) <b>Note:</b> 29693 Plug—Spark (2" High—51 M.M.) 291954 Plug—Spark (2-25/32" High—71 M.M.) Used on Type Nos. 0227, 0228, 0231, 0258, 0261. 293918 Plug—Spark (1-1/2" High—37-42 M.M.) (Resistor Type) 391919 Plug—Spark (2-5/16" High—59 M.M.) Used on Type Nos. 0027, 0031, 0127, 0128, 0147, 0155, 0213, 0221, 0266, 0271, 0281, 0282, 0297, 0299, 0312, 0313, 0318, 0329, 0330, 0334, 0344, 0345, 0346, 0350.</p> <p>339 298185 Breaker Assy.—Ignition</p> <p>340 26018 Spring—Breaker Arm</p> <p>342 298125 Plunger—Contact</p> <p>343 298060 Condenser</p> <p>345 211327 Cover—Breaker</p> <p>346 93400 Screw—Breaker Cover Mounting Sem <b>Note:</b> 93550 Screw—Breaker Cover Mtg. (Upper Hole) Used on Type Nos. 0227, 0228, 0231, 0258, 0261.</p>

## 233400 to 233499

REF. NO.	PART NO.	DESCRIPTION	REF. NO.	PART NO.	DESCRIPTION	REF. NO.	PART NO.	DESCRIPTION
347	220197	Switch—Stop <b>Note:</b> 29372 Switch—Stop Used on Type Nos. 0216, 0267, 0289, 0301, 0327, 0333. 298926 Switch—Stop Used on Type Nos. 0180, 0198, 0293. 390785 Switch—Stop Used on Type Nos. 0162, 0334.	394	290622	Diaphragm—Fuel Pump	507	66895	Insulator <b>Note:</b> 299598 Insulator Used on Type Nos. 0227, 0228, 0231, 0256, 0258, 0261.
348	221976	Switch—Stop	395	290623	Valve—Fuel Pump	517	22809	Pulley—Rope Starter
353	92791	Washer—Lock— Shakeproof	396	66204	Gasket—Fuel Pump Valve	518	69932	Rope—Starter 296512 Rope—Starter Used on Type Nos. 0191, 0278.
354	90576	Nut—Hex.—8-32 (2)	423	93410	Screw—Cable Clamp	521	291508	Shielding—Ignition Cable
356	391115	Wire—Ground <b>Note:</b> 299500 Wire—Ground Used on Type Nos. 0344, 0345. 299579 Wire—Ground Used on Type Nos. 0227, 0228, 0231, 0258, 0261. 299656 Wire—Ground Used on Type Nos. 0023, 0170, 0173, 0186, 0187, 0211, 0250, 0268, 0300, 0305, 0311, 0317. 299907 Wire—Ground Used on Type Nos. 0256, 0265, 0269, 0288, 0335.	478	221745	Panel—Instrument	525	230472	Nipple—Oil Filler <b>Note:</b> 295108 Nipple—Oil Filler Used on Type Nos. 0227, 0228, 0240, 0258, 0261.
			492	297779	Starter—Generator (Delco-Remy No. 1101864 and Pulley— Delco-Remy No. 1949358)	535	270093	Element—Air Cleaner <b>Note:</b> 270209 Element—Air Cleaner Used on Type Nos. 0138, 0259, 0267, 0289, 0301, 0327, 0333.
			493	211169	Bracket—Lower Starter <b>Note:</b> 211785 Bracket Starter Mounting Used on Type No. 0296.	536	297869	Cleaner Assembly—Air <b>Note:</b> 393616 Cleaner Assy.— Air Used on Type Nos. 0138, 0259, 0267, 0289, 0301, 0327, 0333.
			493A	294815	Bracket—Lower Starter <b>Note:</b> 294806 Bracket— Lower Starter Used on Type Nos. 0129, 0200, 0206, 0240.	550	*22353	Washer—Valve Cover Used before Serial No. 6608091.
357	91540	Key—Pulley Mounting <b>Note:</b> 91816 Key—Pulley Mounting Used on Type No. 0332.	496	294779	Bracket—Guard <b>Note:</b> 294807 Bracket— Guard Used on Type Nos. 0129, 0200, 0206.	551	22795	Cover—Valve Used before Serial No. 6608091.
358	291728	Gasket Set	498	220881	Link—Adjusting	552	393666	Bushing and Spacer— Governor Crank Used after Code No. 7806201. <b>Note:</b> 23837 Bushing— Governor Crank Used before Code No. 7806211.
362	291630	Shield—Spark Plug (With Stop Switch)	500	91325	Washer—Plain	553	62222	Cup—Valve Spring
363	19203	Puller—Flywheel (Optional Accessory)	501	297196	Regulator—Voltage (Delco-Remy No. 1118988)	554	66203	Shaft—Cam
383	89838	Wrench—Spark Plug	501A	295924	Regulator—Voltage (Delco-Remy No. 1119577)	556	90887	Screw—Cap, Hex. Hd.—3/8-16 x 1-1/4"
386	27314	Gasket—Fuel Pump Mounting	506	90200	Screw—Machine, Fil. Hd.—8-32 x 1/2" <b>Note:</b> 90072 Screw—Machine, Rd. Hd.—8-32 x 5/8" Used on Type Nos. 0227, 0228, 0231, 0258, 0261.	557	90931	Screw—Cap, Hex. Hd.—1/2-20 x 2-1/4" Used to Mount Valve Cover before Serial No. 6608091.
387	291493	Pump Assembly—Fuel						
388	220431	Lever—Fuel Pump						
392	26588	Spring—Fuel Pump Diaphragm						
393	22740	Screen—Fuel Pump Filter						

\*Included in Gasket Set—  
Part No. 291728.

**233400 to 233499**

REF. NO.	PART NO.	DESCRIPTION	REF. NO.	PART NO.	DESCRIPTION	REF. NO.	PART NO.	DESCRIPTION
558	92268	Washer—Lock— 3/8 x 1/8 x 3/32"	569	*27351	Gasket—Engine Base	598	*27349	Gasket—Plain or Ball Bearing Sup.— .020" thick
559	93294	Screw—Sem		<b>Note:</b> 27551	Gasket Engine Base		*27374	Gasket—Plain or Ball Bearing Sup.— .005" thick
560	93306	Pin—Cotter— 1/16 x 11/16" long			Used on Type Nos. 0040, 0185, 0196, 0219.		*27375	Gasket—Plain or Ball Bearing Sup.— .009" thick
561	92278	Nut—Hex.—1/4-20 <b>Note:</b> For 5/16-18 Nut, Order No. 91397 and use 90366 Lockwasher. For 3/8-16 Nut, Order No. 93390 and use 92268 Lockwasher.	571	291662	Support Assy.—Plain Bearing <b>Note:</b> 291672 Support Assy.—Ball Bearing Used only on Model 233431 to 233436.	594	91449	Screw—Pulley Mounting <b>Note:</b> 92909 Screw—Pulley Mounting Used on Type Nos. 0206, 0240.
562	92613	Bolt—Governor Lever	572	291871	Guide—Front Air	595	230603	Pulley—Starter Generator (Delco-Remy No. 1945744)
563	93158	Screw—Self Tapping, Hex. Hd.—1/4-20 x 5/8"	573	298159	Plate—Back <b>Note:</b> 299626 Plate—Back Used on Type Nos. 0227, 0228, 0231, 0258, 0261.	596	93347	Screw—Fuel Pump Head Mounting Sem
564	92980	Screw—Cap Hex. Hd.—1/4-20 x 1/2"	574	295158	Ammeter (Stewart Warner No. 375-W)	601	93053	Clamp—Fuel Pipe (2)
565	93142	Screw—Bracket to Base Mounting	575	299139	Switch—Starter (Includes (2) Terminal Nuts)	605	297171	Bracket—Guard
566	99458	Idling Device <b>Uses:</b> 92747 Screw—Sem (For Mounting)	576	298579	Wire—Ignition Switch to Indicator Lamp	606	221442	Strap—Adjusting <b>Note:</b> 221931 Strap— Adjusting 221932 Bracket—Upper Starter 221933 Bracket— Angle 93535 Screw—Sem (3) (Bracket Mtg.) 91397 Nut—Hex.— 5/16-18 (2) 91325 Washer—Flat Used on Type No. 0296.
567	291364	Crank Assy.— Governor	576A	295160	Wire—Ammeter to Switch	608	298340	Starter Assy.— Rewind <b>Note:</b> 392677 Starter Assy.— Rewind Used on Type Nos. 0041, 0061, 0325, 0326, 0327, 0328, 0331.
568	291404	Base Assembly— Engine <b>Note:</b> 21895 Base—Engine Used on Type Nos. 0191, 0227, 0228, 0240, 0258, 0261, 0337. 294751 Base Assy.— Engine Used on Type Nos. 0010, 0020, 0023, 0135, 0139, 0144, 0145, 0153, 0158, 0164, 0170, 0173, 0186, 0187, 0188, 0202, 0210, 0211, 0225, 0250, 0254, 0268, 0300, 0303, 0305, 0311, 0317, 0335, 0341. 298866 Base Assy.— Engine Used on Type Nos. 0138, 0259, 0267, 0289, 0301, 0327, 0333.	577	298582	Wire—Starter Switch to Ignition Switch and "Bat." on Regulator	621	297472	Switch—Stop
			577A	295161	Wire—Ammeter to Regulator	635	66538	Elbow—Spark Plug
			578	298583	Wire—Starter Switch to Generator Terminal and Regulator and Indicator Light Terminal	636	92864	Washer—Lock
			578A	295162	Wire—Starter Switch	637	66154	Washer—Backplate Terminal
			586	22906	Lock—Flywheel Nut	638	26404	Washer—Backplate Terminal
			587	221340	Clamp—Ignition Cable	639	270176	Gasket—Breaker Cover
			587A	220509	Clamp—Ignition Cable			
			588	211440	Bracket—Armature Mounting			
			589	93473	Screw—Armature Bracket to Cylinder Mounting Sem			
			590	93171	Screw—Breaker Mtg. Sem			
			591	65932	Plug—Camshaft			
			592	231082	Nut—Hex.—10-24			

\*Included in Gasket Set—  
Part No. 291728.

## 233400 to 233499

REF. NO.	PART NO.	DESCRIPTION	REF. NO.	PART NO.	DESCRIPTION	REF. NO.	PART NO.	DESCRIPTION
640	298141	Lead—Primary	652	91162	Screw—Bracket to Bracket	795	298590	Switch—Ignition
642	221468	Cover—Air Cleaner	653	91442	Screw—Pulley Mtg.	824	298586	Holder—Charge Indicator
	<b>Note:</b>	221634 Cover—Air Cleaner Used on Type Nos. 0138, 0259, 0267, 0289, 0333.		<b>Note:</b>	91386 Screw—Pulley Mounting Used on Type No. 0296.	825	67245	Lamp—Charge Indicator (#1893 T3-1/4 Bulb, Miniature Bayonet Base, 12 Volt)
643	280001	Cup—Air Cleaner	654	230783	Nut—Contact Point Adjusting Screw	826	298580	Wire—Ignition Switch to Ground
	<b>Note:</b>	280002 Cup—Air Cleaner Used on Type Nos. 0138, 0259, 0267, 0289, 0301, 0333.	655	221014	Anchor—Spring	827	298581	Wire—Ignition Switch to Ground
644	221466	Base—Air Cleaner	661	91203	Screw—Cap, Hex. Hd.—5/16-18 x 1-3/4"	827	298581	Wire—Ignition Switch to Breaker Box
645	230775	Bushing—Plunger	664	93415	Screw—Sem	828	298578	Wire—Regulator to Generator
646	221472	Brace—Bracket	665	298860	Oil Minder	840	298561	Kit—Starter Generator Panel
647	211170	Link—Anchor	668	260647	Spacer (Used between end of Ratchet and Starter Pulley)	841	297197	Clamp—Regulator to Generator
648	91468	Screw—Cap, Hex. Hd.—1/4-20 x 3/8"	676	222573	Deflector—Muffler	851	221798	Terminal—Ignition Cable
649	93546	Screw—Cap, Hex. Hd.—5/16-18 x 1-1/4"	677	93705	Screw—Muffler Deflector	854	392884	Bracket Assembly—Stop Switch
	<b>Note:</b>	91203 Screw—Cap, Hex. Hd.—5/16-18 x 1-3/4" (1) Used on Type No. 0296.	694	220863	Washer—Guard to Bracket Mounting	869	21880	Seat—Intake Valve (Standard)
650	91814	Screw—Cap, Hex. Hd.—3/8-16 x 2"	722	68768	Seal—Plunger	870	21880	Seat—Exhaust Valve (Standard)
	<b>Note:</b>	93546 Screw—Starter Bracket to Cylinder Mounting (2) Used on Type No. 0296.	723	93516	Eyelet—Seal Retainer	871		Guide—Exhaust Valve
651	92034	Screw—Cap, Hex. Hd.—5/16-18 x 1/2"	724	221873	Retainer—Plunger Seal			231218 or 230655 <b>See Repair Manual</b>
			762	298865	Electric Starter—Generator and Panel Kit—12 Volt	917	223271	Valve Handle—Fuel Shut-Off
				<b>Note:</b>	The above Kits cannot be used on engines equipped with a fuel pump.			
				<b>Note:</b>	For Kit without Panel Order No. 297800.			