



12Q800

Illustrated Parts List

Model Series

12Q800

TYPE NUMBERS
0120 through 0282.

TABLE OF CONTENTS

Air Cleaner	4
Blower Housing/Shrouds	5
Camshaft	2
Carburetor	3
Controls	4
Crankshaft	2
Cylinder	2
Electrical	4
Engine Sump	2
Flywheel	5
Flywheel Brake	4
Exhaust System	4
Fuel Supply	4
Governor Spring	4
Ignition	4
Kits/Gaskets	2 & 3
Lubrication	2
Piston Group	2
Rewind Starter	5
Valves	2



PRINTED IN U.S.A.

COPYRIGHT by BRIGGS & STRATTON CORPORATION
All rights reserved. No part of this material may be reproduced or transmitted, in any form or by any means, electronic or mechanical, including photocopying, recording or by any information storage and retrieval system, without permission in writing from Briggs & Stratton Corporation.

12Q800

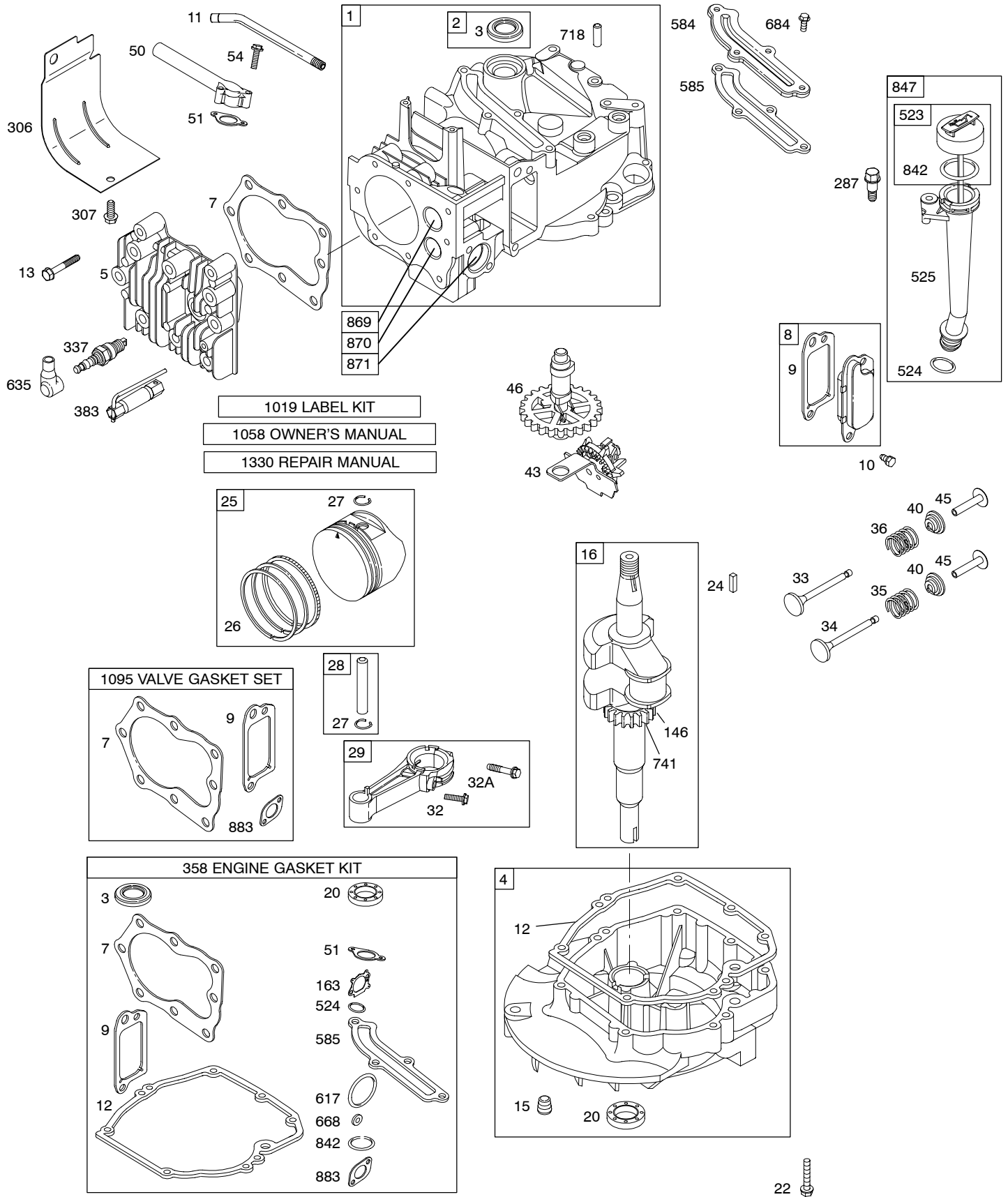

Illustrations cover a range of engines. Parts shown without corresponding text may not be used on your specific engine.
 5119-2 Assemblies include all parts shown in frames. 09/30/2005

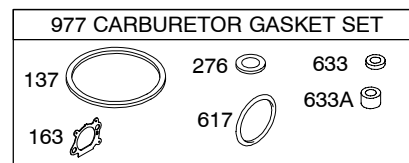
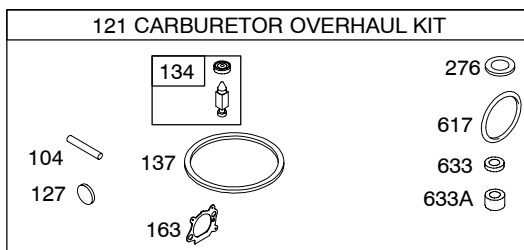
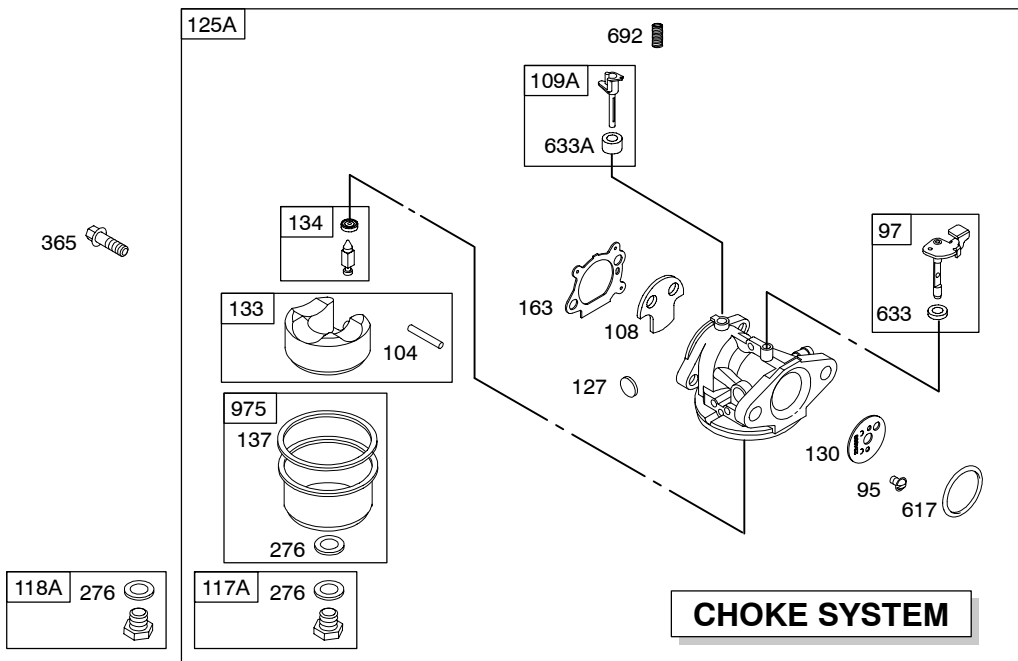
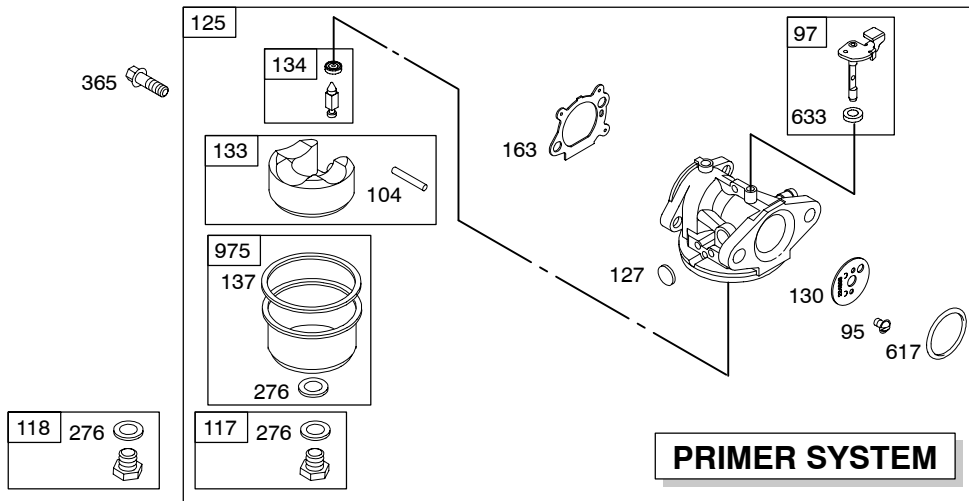

Illustrations cover a range of engines. Parts shown without corresponding text may not be used on your specific engine.
 5119-3 Assemblies include all parts shown in frames. 09/30/2005

12Q800

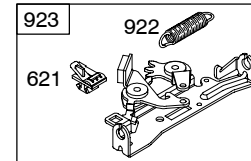
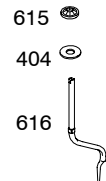
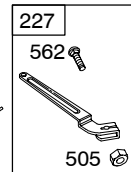
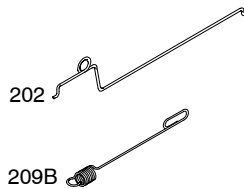
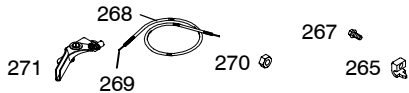
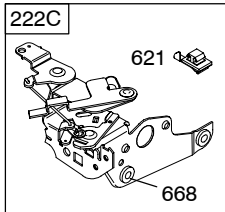
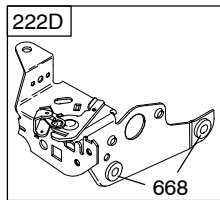
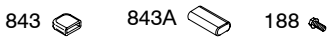
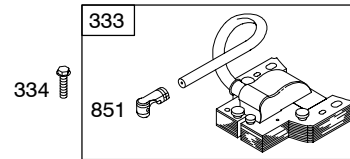
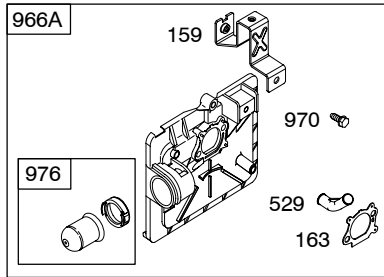
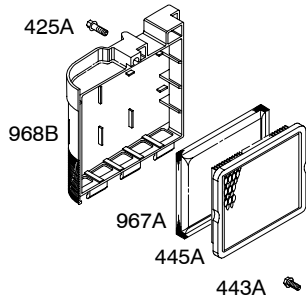
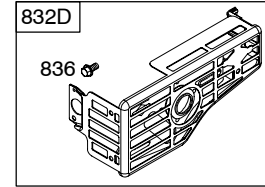
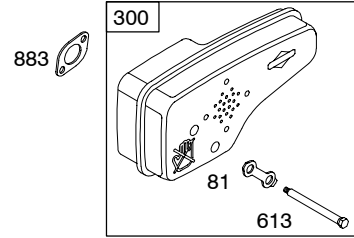
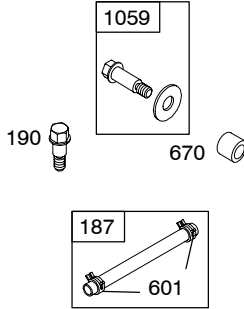
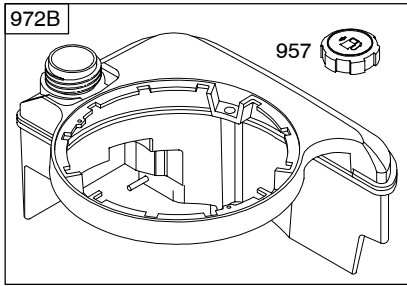

Illustrations cover a range of engines. Parts shown without corresponding text may not be used on your specific engine.
 5119-4 Assemblies include all parts shown in frames. 09/30/2005

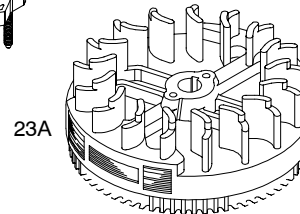
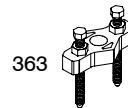
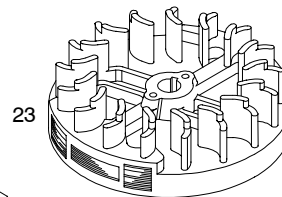
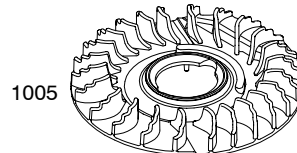
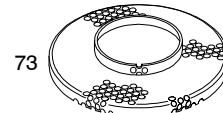
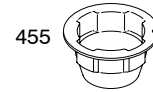
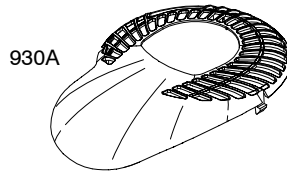
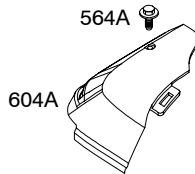
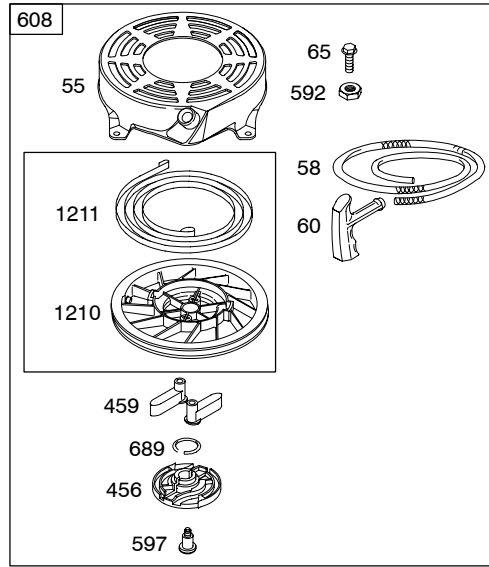
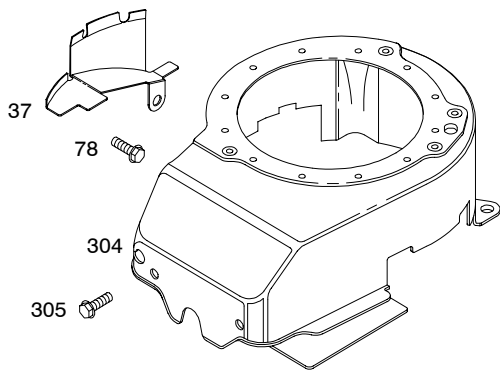
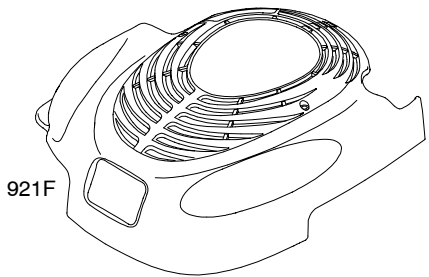
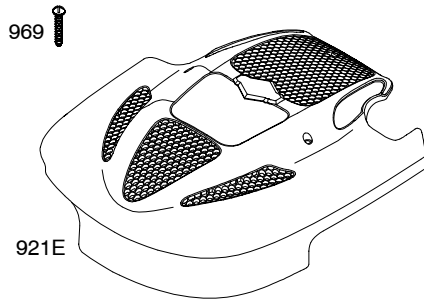
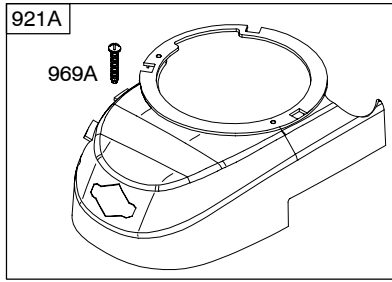

5119-5 *Illustrations cover a range of engines. Parts shown without corresponding text may not be used on your specific engine.* Assemblies include all parts shown in frames. 09/30/2005

12Q800

REF. NO.	PART NO.	DESCRIPTION	REF. NO.	PART NO.	DESCRIPTION	REF. NO.	PART NO.	DESCRIPTION
1	697322	Cylinder Assembly	25	790359	Piston Assembly (Standard)	27	691866	Lock-Piston Pin
2	399269	Kit-Bushing/Seal (Magneto Side)			(Used After Code Date 04031400).	28	499423	Pin-Piston (Standard)
3	*299819	Seal-Oil (Magneto Side)			----- Note -----	29	499424	Rod-Connecting (Standard)
4	493279	Sump-Engine			499429 Piston Assembly (Standard)	32	691664	Screw (Connecting Rod)
5	691160	Head-Cylinder			(Used Before Code Date 04031500).	32A	695759	Screw (Connecting Rod)
7	*Ø692249	Gasket-Cylinder Head			499430 Piston Assembly (.010" Oversize)	33	262651	Valve-Exhaust
8	695250	Breather Assembly			791326 Piston Assembly (.020" Oversize)	34	262652	Valve-Intake
9	*Ø272481	Gasket-Breather			(Used After Code Date 04102100).	35	691270	Spring-Valve (Intake)
10	691125	Screw (Breather Assembly)			697341 Piston Assembly (.020" Oversize)	36	691270	Spring-Valve (Exhaust)
11	691781	Tube-Breather			(Used Before Code Date 04102200).	37	694086	Guard-Flywheel
12	*692232	Gasket-Crankcase			499432 Piston Assembly (.030" Oversize)	40	692194	Retainer-Valve
13	690912	Screw (Cylinder Head)			----- Note -----	43	691997	Slinger-Governor/Oil
15	691680	Plug-Oil Drain (Square Socket)			691450 Crankshaft Used on Type No(s). 0272.	45	690548	Tappet-Valve
16	691451	Crankshaft			694849 Crankshaft Used on Type No(s). 0120.	46	691449	Camshaft
			26	790360	Ring Set (Standard)	50	497465	Manifold-Intake
20	*399781	Seal-Oil (PTO Side)			(Used After Code Date 04031400).	51	*272199	Gasket-Intake
22	691092	Screw (Crankcase Cover/Sump)			----- Note -----	54	691650	Screw (Intake Manifold)
23	692315	Flywheel (Rewind Starter)			499425 Ring Set (Standard)	55	691421	Housing-Rewind Starter
23A	691992	Flywheel (Electric Starter)			(Used Before Code Date 04031500).	58	697316	Rope-Starter (Cut To Required Length)
24	222698	Key-Flywheel			499426 Ring Set (.010" Oversize)	60	281434	Grip-Starter Rope
					791324 Ring Set (.020" Oversize)	65	690837	Screw (Rewind Starter)
					(Used After Code Date 04102100).	73	691222	Screen-Rotating
					499427 Ring Set (.020" Oversize)	78	691108	Screw (Flywheel Guard)
					(Used Before Code Date 04102200).	81	691740	Lock-Muffler Screw
					499428 Ring Set (.030" Oversize)	95	691636	Screw (Throttle Valve)
						97	696565	Shaft-Throttle (Plastic)
								----- Note -----
								493267 Shaft-Throttle (Metal)

* Included in Engine Gasket Set-Ref. No.358.

● Included in Carburetor Overhaul Kit-Ref. No. 121.

◆ Included in Carburetor Gasket Set-Ref. No. 977.

Ø Included in Valve Gasket Set-Ref. No 1095.

Illustrations cover a range of engines. Parts shown without corresponding text may not be used on your specific engine.

REF. NO.	PART NO.	DESCRIPTION	REF. NO.	PART NO.	DESCRIPTION	REF. NO.	PART NO.	DESCRIPTION
104	●691242	Pin-Float Hinge	190	690940	Screw (Fuel Tank)	306	690450	Shield-Cylinder
108	691182	Valve-Choke				307	690345	Screw (Cylinder Shield)
109A	498593	Shaft-Choke	202	691829	Link-Mechanical Governor	332	690662	Nut (Flywheel)
117	498978	Jet-Main (Standard)	209B	699056	Spring-Governor	333	802574	Armature-Magneto
117A	498978	Jet-Main (Standard) Used on Type No(s). 0120.			----- Note ----- 691290 Spring-Governor Used on Type No(s). 0120.	334	691061	Screw (Magneto Armature)
118	497466	Jet-Main (High Altitude)	222C	692150	Bracket-Control (Remote/Manual Friction)(Variable Speed and 5 Position Manual Choke)	337	802592	Plug-Spark
118A	498975	Jet-Main (High Altitude) Used on Type No(s). 0120.				356	692390	Wire-Stop
121	498260	Kit-Carburetor Overhaul	222D	692467	Bracket-Control (Fixed Speed)	358	497316	Gasket Set-Engine
125	498170	Carburetor	227	690783	Lever-Governor Control	363	19069	Puller-Flywheel
125A	499059	Carburetor	265	690798	Clamp-Casing	365	691688	Screw (Carburetor)
127	●694468	Plug-Welch (3/8" Diameter)	267	691044	Screw (Casing Clamp)	383	89838	Wrench-Spark Plug
130	696564	Valve-Throttle (Used With Plastic Throttle Shaft) ----- Note ----- 691203 Valve-Throttle	268	691025	Casing-Control Wire (Cut to Required Length)	404	690272	Washer (Governor Crank)
133	398187	Float-Carburetor	269	691026	Wire-Control (Cut to Required Length)	425A	690670	Screw (Air Cleaner Cover)
134	●398188	Kit-Needle/Seat	270	691027	Nut (Control Wire Casing)	443A	692523	Screw (Air Cleaner Primer Base)
137	●◆693981	Gasket-Float Bowl	271	691028	Lever-Control	445A	491588	Filter-Air Cleaner Cartridge
146	690979	Key-Timing	276	◆271716	Washer-Sealing	455	695161	Cup-Flywheel
159	691753	Bracket-Air Cleaner Primer	287	690940	Screw (Dipstick Tube)	456	692299	Plate-Pawl Friction
163★◆	◆272653	Gasket-Air Cleaner	300	692038	Muffler (Tuned)	459	281505	Plate-Ratchet
187	791766	Line-Fuel (Cut to Required Length) (Used After Code Date 05063000). ----- Note ----- 691050 Line-Fuel (Cut to Required Length) (Used Before Code Date 05070100).	304	695892	Housing-Blower ----- Note ----- 493294 Housing- Blower Used on Type No(s). 0120.	505	691251	Nut (Governor Control Lever)
188	690877	Screw (Control Bracket)	305	691108	Screw (Blower Housing)	523	495264	Dipstick
						524	★692296	Seal-Dipstick Tube
						525	495265	Tube-Dipstick
						529	691923	Grommet
						562	92613	Bolt (Governor Control Lever)
						564A	691142	Screw (Control Cover)
						584	697734	Cover-Breather Passage
						585	★691879	Gasket-Breather Passage

★ Included in Engine Gasket Set-Ref. No.358.

● Included in Carburetor Overhaul Kit-Ref. No. 121.

◆ Included in Carburetor Gasket Set-Ref. No. 977.

⊘ Included in Valve Gasket Set-Ref. No 1095.

Illustrations cover a range of engines. Parts shown without corresponding text may not be used on your specific engine.

12Q800

REF. NO.	PART NO.	DESCRIPTION	REF. NO.	PART NO.	DESCRIPTION	REF. NO.	PART NO.	DESCRIPTION
592	690800	Nut (Rewind Starter)	745	691648	Screw (Brake)	967A	493537	Filter-Pre Cleaner
597	691696	Screw (Pawl Friction Plate)	832D	499034	Guard-Muffler	968B	692298	Cover-Air Cleaner
601	95162	Clamp-Hose (Green)	836	690664	Screw (Muffler Guard)	969	690700	Screw (Blower Housing Cover)
604A	691344	Cover-Control	842	*691031	Seal-O Ring (Dipstick Tube)	969A	691138	Screw (Blower Housing Cover)
608	497680	Starter-Rewind	843	691884	Sleeve-Lever (Control Bracket)	970	691681	Screw (Air Cleaner Primer Bracket)
613	691340	Screw (Muffler)	843A	691895	Sleeve-Lever (Choke)	972B	699374	Tank-Fuel (Plastic)
615	690340	Retainer-Governor Shaft	847	692017	Dipstick/Tube Assembly	975	493640	Bowl-Float
616	698801	Crank-Governor	851	493880	Terminal-Spark Plug	976	694395	Primer-Carburetor
617*♦270344		Seal-O Ring (Intake Manifold)	869	691155	Seat-Valve (Intake)	977	498261	Gasket Set-Carburetor
621	692310	Switch-Stop	870	690380	Seat-Valve (Exhaust)	1005	691346	Fan-Flywheel
633 ♦♦691321		Seal-Choke/Throttle Shaft	871	262001	Bushing-Valve Guide (Exhaust)	1019	696438	Kit-Label
633A ♦♦693867		Seal-Choke/Throttle Shaft	----- Note -----			1036		Label-Emission (Available From An Authorized Briggs & Statton Sevice Dealer)
635	66538	Boot-Spark Plug	883	*∅691881	Gasket-Exhaust	1058	276171	Owner's Manual
668	*493823	Spacer (Includes 2)	921A	695886	Cover-Blower Housing	1059	692311	Kit-Screw/Washer
670	692294	Spacer-Fuel Tank	921E	696262	Cover-Blower Housing	1095	498528	Gasket Set-Valve
684	690345	Screw (Breather Passage Cover)	921F	697343	Cover-Blower Housing	1210	498144	Pulley/Spring Assembly (Pulley)
689	691855	Spring-Friction	922	692135	Spring-Brake	1211	498144	Pulley/Spring Assembly (Spring)
692	690572	Spring-Detent	923	695891	Brake	1330	270962	+Manual-Repair
718	690959	Pin-Locating	930A	691345	Guard-Rewind (Tear Drop)			
741	790345	Gear-Timing (Use Without Woodruff Key)	957	397974	Cap-Fuel Tank (Plastic)			
		----- Note -----	966A	496116	Base-Air Cleaner Primer			
		691830 Gear-Timing (Uses Woodruff Key)						

★ Included in Engine Gasket Set-Ref. No.358.

● Included in Carburetor Overhaul Kit-Ref. No. 121.

♦ Included in Carburetor Gasket Set-Ref. No. 977.

∅ Included in Valve Gasket Set-Ref. No 1095.

Illustrations cover a range of engines. Parts shown without corresponding text may not be used on your specific engine.