



# Service Bulletin

**Date:** October 7, 2002

**Product Line:** Snowmobile

**Bulletin No:** 2003-1-09

**Subject:** Throttle Switch

**Affected Models / VIN:**

Affected Models:

All 2002 4-Stroke Models - See List Below

2002 4-Stroke Touring  
Model No. S2002ACFERUSG

2002 4-Stroke Trail  
Model No. S2002ACFLUSG

2002 4-Stroke Touring (International)  
Model No. S2002ACFEROSG

---

■ **NOTE:** Order only one upper throttle seal per affected snowmobile. The bottom seal does not have to be replaced.

**Condition:** It has been determined that the existing throttle switch on the affected models may operate intermittently. This condition will cause the headlights to flicker.

**Solution:** If the condition (described above) exists, first check the throttle cable tension to ensure that the tension is adjusted correctly according to the Throttle Cable section on page 4-59 in the 2002 Arctic Cat Snowmobile Service Manual Volume One. If the condition still exists after properly adjusting the cable tension, install Throttle Seal (p/n 0609-144) per illustration and instructions included with this bulletin.

**Parts:** Order an appropriate number of Throttle Seal (p/n 0609-144) through normal parts-ordering channels. Your dealership Parts Account will be charged and then credited upon receipt of a Warranty Claim Request form.

**Warranty:** A labor allowance of 0.2 hr will be paid per affected snowmobile.

Only one vehicle identification number (VIN) can be entered per claim. Do not submit a group claim.

CatTracker Claim: Enter BS200309 in the Complaint section.

Manual Claim: Enter 0309 in the Complaint section.

## Removing and Installing Instructions:

1. Remove the existing throttle lever and the upper throttle seal. Account for a lower throttle seal.
2. Grease the new seal bottom with Super-Lube (p/n 1056-054); then place the new throttle seal (black) into position on the top of the throttle switch making sure the protrusion on the underside of the seal is positioned downward and at the end of the slot nearest the rubber hand grip. See Fig. 1 for proper positioning of the seal.

■ **NOTE:** When installing the new seal, it is essential that the protrusion on the underside of the seal be positioned in the slot at the end closest to the hand grip. See Fig. 1.

Fig. 1

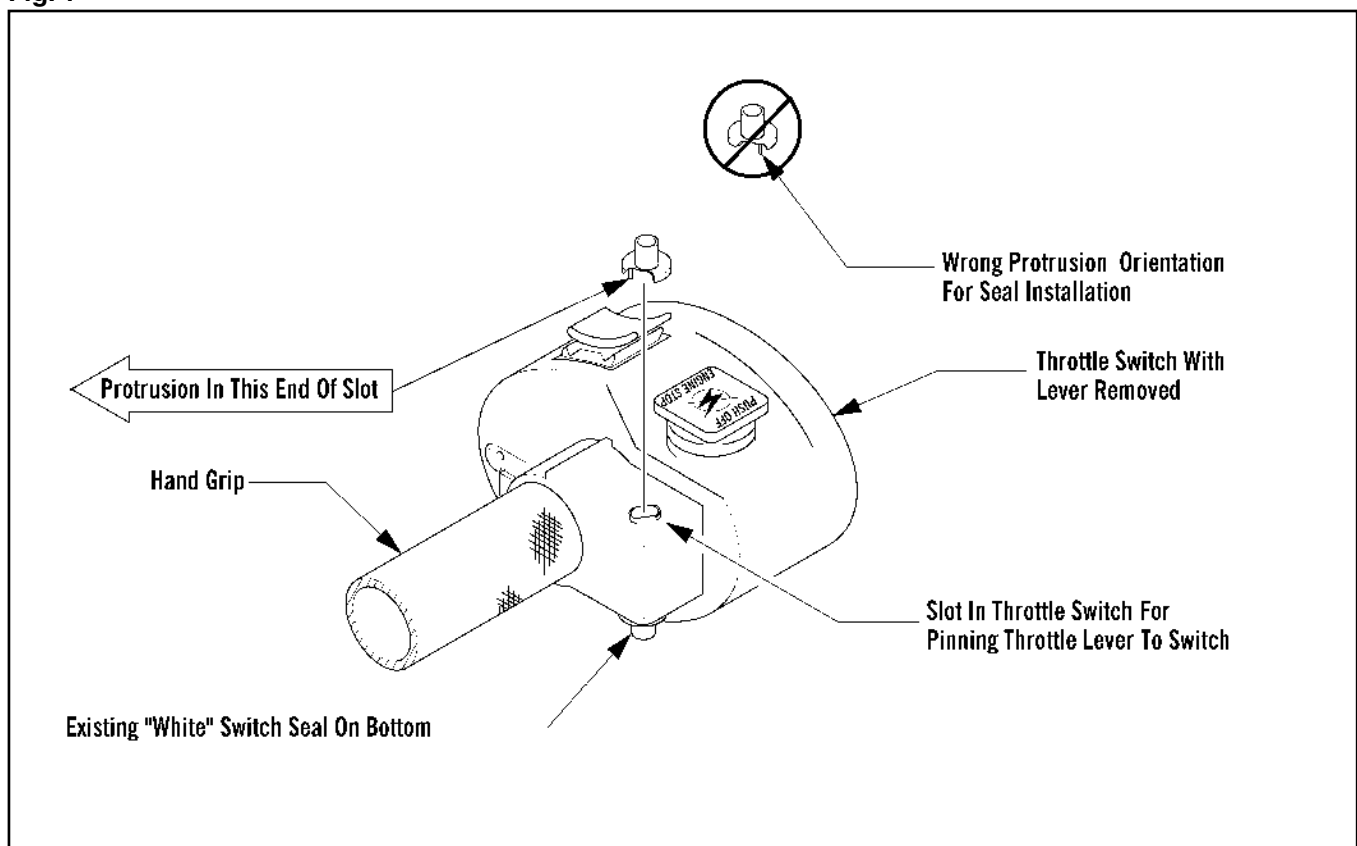

0737-940

3. Install the existing lower throttle seal (white) on the bottom of the throttle switch; then install and secure the throttle lever.
4. Adjust the throttle cable tension according to the Throttle Cable section on page 4-59 in the 2002 Arctic Cat Snowmobile Service Manual Volume One.