



Service Kit

753-06197

Date: July 09, 2009

Subject: Optional Rubber Strap

Models Affected: OEM-190-180, OEM-190-180A and 19A30002000

Read through and understand these instructions completely before proceeding with repair.

PURPOSE: This kit provides a rubber strap, hook, mounting hardware and installation instructions for the OEM-190-180, OEM-190-180A and 19A30002000 Twin Bagger discharge elbow chute.

NOTE: These materials are prepared for use by trained technicians who are experienced in the service and repair of equipment of the kind described in this publication, and are not intended for use by untrained or inexperienced individuals. Such individuals should seek the assistance of an authorized service technician or dealer.

NOTE: Save this Instruction Sheet. Refer to it when ordering replacement parts.

Service Kit Contents

ITEM NO.	PART NUMBER	QTY	DESCRIPTION
1	723-04008A	1	STRAP: CHUTE : 6.0 IN. LONG
2	732-04510A	1	HOOK: SPRING: TORSION
3	736-0204	1	WASHER: FLAT: .344 x .62 x .033
4	711-05063	1	PIN: CLEVIS: 5/16" x 3/4" LONG
5	714-04040	1	PIN: COTTER: BOW-TIE 72
6	750-0566A	1	SPACER: .260" x .372" x 1.030"
7	710-0778	1	SCREW: TAP-TITE: 1/4"-20 x 1.5" LG
8	*	1	THIS INSTRUCTION SHEET

* - Not Available Separately

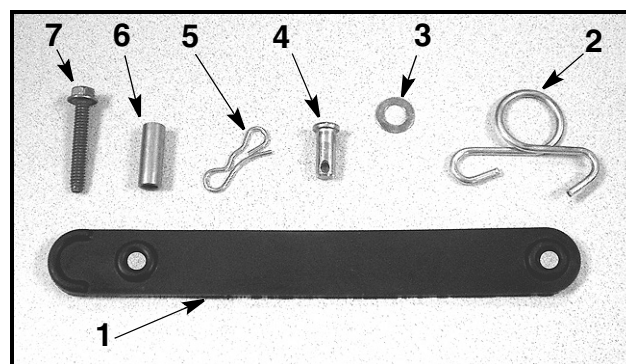

FIGURE 1

Required Tools:

5/16" Drill Bit
Portable Drill Motor
3/8" Socket and Ratchet

Assembly Instructions:

1. If the bagger's elbow discharge chute is installed on the deck, remove it from the deck.
2. Using the 5/16" drill bit and portable drill motor, drill a hole through the elbow discharge chute in the outside corner of the bump-out as shown in Figure 2.



FIGURE 2

3. Assemble the Chute Strap, Item 1, onto the Spring Hook, Item 2, smaller loop end as shown in Figure 3.

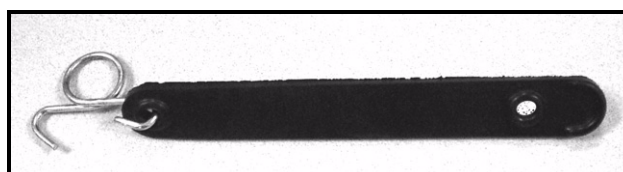

FIGURE 3

4. Using the Clevis Pin, Item 4, Flat Washer, Item 3, and the Bow-Tie Clip, Item 5, assemble the strap to the elbow discharge chute as shown in Figure 4.

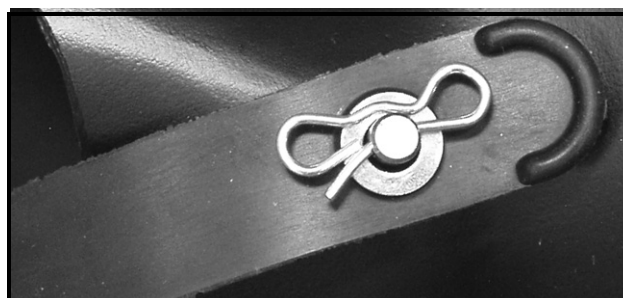

FIGURE 4

Installing Elbow Chute on a Manual PTO Deck:

5. When installing the elbow discharge chute onto the cutting deck, the spring hook connects to the brake spring attachment post at the right side belt cover. See Figure 5.

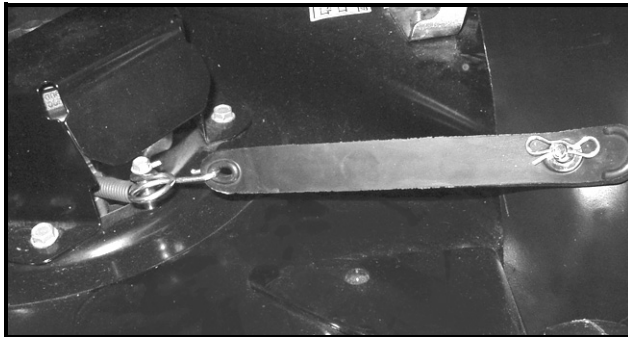

FIGURE 5

This completes the installation of the optional chute strap kit.

Installing Elbow Chute on an Electric PTO Deck:

6. Lower the cutting deck to its lowest cutting position.

7. Using a 9/16" socket and ratchet, remove the three (3) self-tapping screws securing the right side belt cover to the deck. See Figure 6.

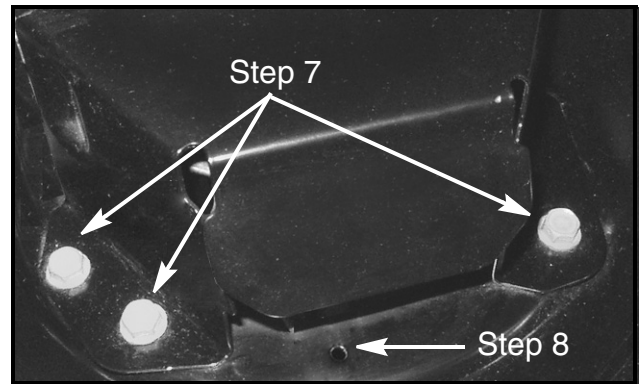

FIGURE 6

8. Locate the open hole by the right side belt cover shown in Figure 6.

9. Place the Spacer, Item 6, onto the Tap-Tite Screw, Item 7.

10. Using the 3/8" socket and ratchet, install the Tap-Tite screw with spacer in the hole. Ensure that the screw is perpendicular to the deck when installing. See Figure 7.

NOTE: Firm pressure is needed when installing the self-tapping screw. Do not over tighten screw which can result in stripping the threads.

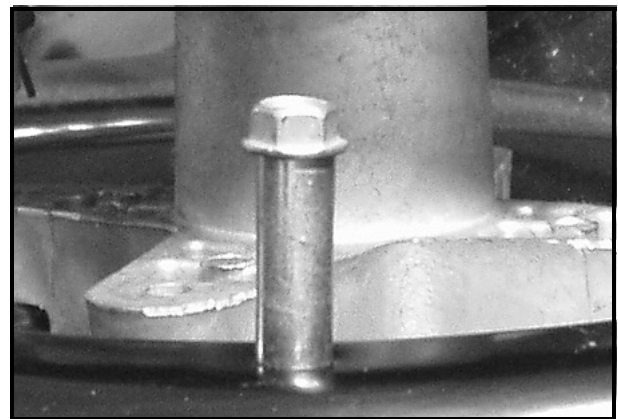

FIGURE 7

11. Replace the belt cover and hardware removed in Step 7.

12. When installing the elbow discharge chute onto the cutting deck, the spring hook connects to the newly installed post at the right side belt cover. See Figure 5.

This completes the installation of the optional chute strap kit.