



Service Kit

753-05862

Date: 3/05/2008

Subject: Service Replacement for the Right Hand (RH) Handle Bracket 687-02206

Models Affected: N/A

Read through and understand these instructions completely before proceeding with repair.

PURPOSE: This service kit supplies the new RH handle bracket, 687-02321, and new hardware to mount the handle bracket. The new handle bracket cannot use carriage bolts to mount as did the old 687-02206 which is no longer available.

NOTE: These materials are prepared for use by trained technicians who are experienced in the service and repair of equipment of the kind described in this publication, and are not intended for use by untrained or inexperienced individuals. Such individuals should seek the assistance of an authorized service technician or dealer.

NOTE: Save this Instruction Sheet. Refer to it when ordering replacement parts.

Service Kit Contents

(See Figure 1)

ITEM NO.	PART NUMBER	QTY	DESCRIPTION
1	687-02321-0637	1	BRACKET ASSEMBLY: HANDLE: RH
2	710-3025	3	HHCS: BOLT: 5/16"-18 x .62
3	712-04063	3	NUT: FLANG LOCK : 5/16"-18: GRF: NYLON
4	712-04065	1	NUT: FLANG LOCK: 3/8"-16: GRF: NYLON
5	736-0264	2	WASHER: FLAT: .330 x .630 x .063
6	*	1	THIS INSTRUCTION SHEET

* - Not Available Separately

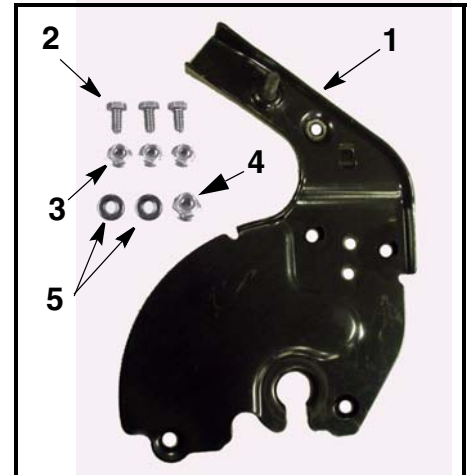

FIGURE 1

Pre-Service Preparation:

1. Place the mower on a flat and level surface.
2. Turn off the engine and allow the engine and muffler to cool before proceeding.
3. Remove the spark plug wire from the spark plug and ground the wire to the engine block.
4. Drain the fuel tank. Optional: Remove the fuel tank cap and place a thin sheet of plastic over the open fuel fill port. Replace the fuel tank cap tightly. Ensure the oil fill port cap/dipstick is tight.
5. Set the height adjuster to the highest cutting position.

Handle Bracket Removal:

NOTE: Left (LH) and right (RH) are determined from the operator's position at the rear of the mower and facing forward.

NOTE: Refer to the Operator's Manual - Illustrated Parts List for part nomenclature and location.

6. Place the mower on it's side so that the air filter/carburetor are up towards the sky.
7. From under the mower's deck, locate the retainer ring securing the transmission support bearing to the RH handle bracket. Using a flat blade screw drive, carefully

pry the retaining ring out of the groove of the support bearing. See Figure 2.

8. Using a 1/2" box/open end wrench, remove and discard the hex flange lock nut and carriage bolt from the handle bracket's lower mounting. See Figure 2.

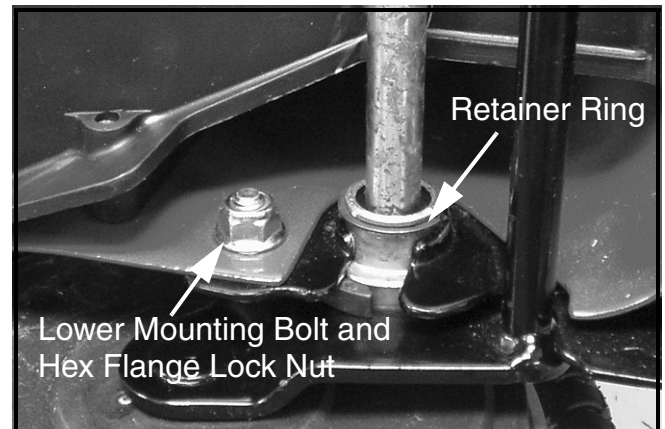

FIGURE 2

9. Return the mower to its normal upright position.
10. Place wood blocking (about 5-6" high) under the mower deck just in front of the right and left rear wheels to raise the wheels off the ground.
11. Remove the hub cap if so equipped. Using a 9/16" socket and ratchet, remove and discard the hex flange lock nut retaining the RH wheel to the pivot bracket assembly's axle stud. Remove the wheel.
12. Using a pair of vise grip pliers, securely clamp onto the transmission's drive axle as shown in Figure 3.



FIGURE 3

13. Using a T30 Torx bit and ratchet **and holding the vise grip pliers to keep the transmission axle from rotating**, remove the Torx head screw retaining the spur gear to the transmission's output shaft. Note the assembly sequence as you remove the spur gear, dowel pin, flat washer and wheel dust cover. See Figure 4.

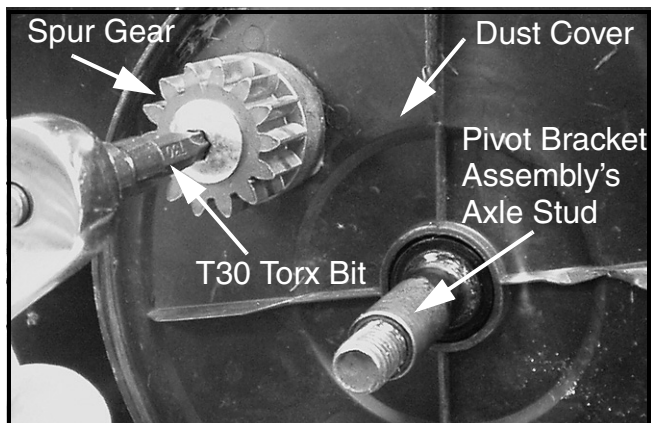

FIGURE 4

NOTE: To keep from damaging the left side transmission support bearing, place blocking under the right side transmission output shaft before the support bearing is removed in the next step.

14. Slide the transmission support bearing off of the transmission's output shaft and remove the plastic spacer clip. See Figure 5.

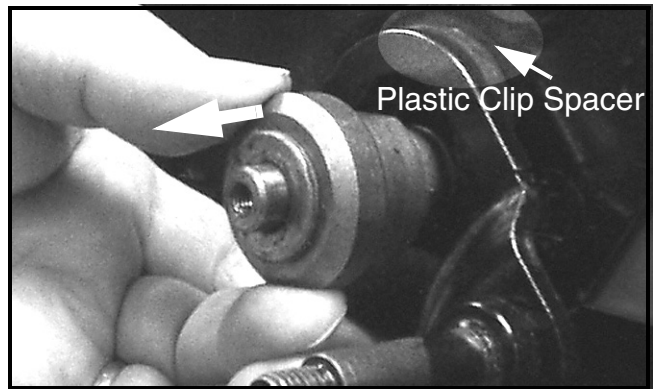

FIGURE 5

15. Remove the right side lower star knob securing the lower handle to the handle bracket.

16. Refer to Figure 6. Using two thin flat blade screw drivers, unhook the right side rear door torsion spring leg from the handle bracket slot.

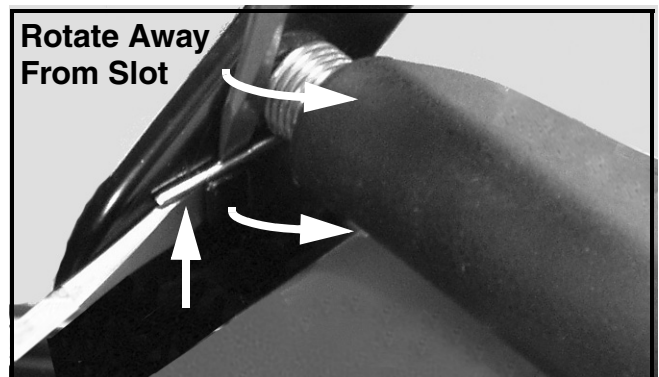

FIGURE 6

17. Using a 3/8" socket and ratchet, remove the right side screw securing the rear door pivot rod to the handle bracket and the screw securing the deck baffle. See Figure 7.

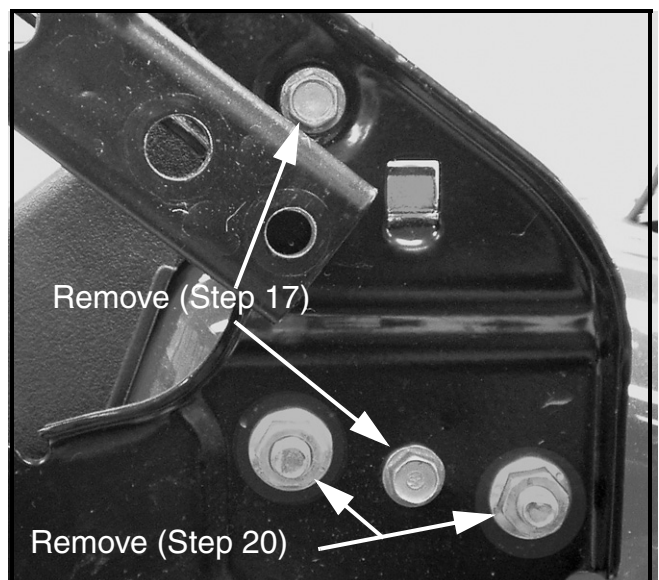

FIGURE 7

18. The ends of the trail shield may be attached to the handle bracket with screws. Remove the screws for reuse later.

19. Prop the rear door open and remove the mulch plug (if so equipped) to allow access to the carriage bolts through the rear bagger chute area. See Figure 8.

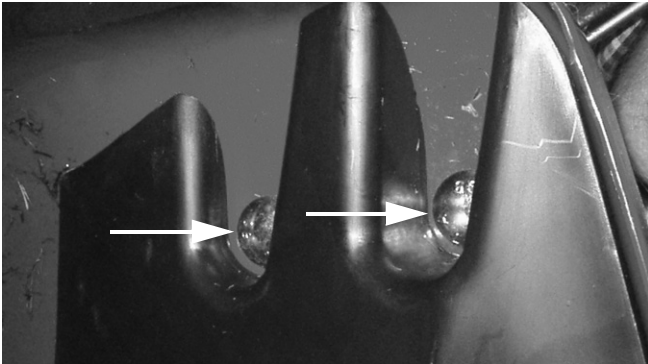

FIGURE 8

20 Using a 1/2" socket and ratchet, remove and discard the upper two hex flange lock nuts and carriage bolts securing the handle bracket to the deck. See Figure 7.

21. Lift the handle bracket up and rotate counter-clockwise to remove the handle bracket from between the deck and pivot rod assembly. Discard the handle bracket.

Installing the New Handle Bracket:

Read all reassembly instructions and NOTES before proceeding. This section does not provide complete step by step reassembly instruction. It does provide important NOTES that apply at different steps throughout the reassembly process.

22. Ensure that the trail shield is re-installed onto the handle bracket before positioning the handle bracket in the next step.

23. Insert the new Handle Bracket, Item 1, in the reverse motion that you removed the old handle bracket in Step 21.

24. Place a Flat Washer, Item 5, onto a new HHCS 5/16"-18 Bolt, Item 2. Align the new handle bracket with the holes in the deck. From the bracket side, insert the bolt/washer assembly in one of the upper mounting holes.

25. Repeat Step 24 for the remaining upper mounting hole.

26. From the bracket side, insert a HHCS 5/16"-18 Bolt, Item 2, (**without** a flat washer) in the bottom mounting hole.

NOTE: All three handle bracket mounting bolts are now in place aligning the bracket with the deck.

27. Using a 1/2" socket - with a 1/4" drive short extension and ratchet, place a new 5/16"-18 Hex Flange Lock Nut, Item 3, in the socket. Guide the socket with hex nut, into the rear discharge chute and align with one of the a upper handle bracket mounting holes. Hand start the bolt/washer assembly onto the nut. Tighten hardware.

28. Repeat step 27 for the other bracket's upper mounting hole and lower mounting hole. Tighten hardware.

29. Proceed to reassemble the right side components and hardware by reversing the removal procedure outlined above.

NOTE: Ensure that the end of the transmission's output shaft and transmission support bearing are clean and free of dirt and debris.

NOTE: Using a light weight lithium or silicone base grease, lubricate the end of the transmission's output shaft where the transmission support bearing will set.

NOTE: Using a light weight lithium or silicone base grease, lubricate the dowel pin prior to inserting it into the transmission's output shaft.

NOTE: Before installing the spur gear, clean off the old locking compound from the spur gear retaining Torx head screw. Apply Loctite 242 (Blue) or 246 (Red) or equivalent to the clean threads. Install the spur gear with the Loctite treated Torx screw.

NOTE: Use the new 3/8"-16 Hex Flange Lock Nut, Item 4, when installing the wheel.

NOTE: Remove the vise grip pliers from the transmission axle shaft.

NOTE: Remove the front axle restraint hardware.

NOTE: Remove the plastic sheet from under the fuel tank cap (if applicable).

This completes this service kit installation.