



# Service Kit 753-06038

Date: 11/04/2008

Subject: Service Replacement for the  
710-04770, 1/4"-20 PANTRXI Screw

Models Affected: N/A

**Read through and understand these instructions completely before proceeding with repair.**

**PURPOSE:** 710-04770 is no-longer-available. It has been replaced by 710-04531. The 710-04531 screw, with slightly different configuration, requires that the spur gears also be changed to ensure proper spur gear installation.

**NOTE:** These materials are prepared for use by trained technicians who are experienced in the service and repair of equipment of the kind described in this publication, and are not intended for use by untrained or inexperienced individuals. Such individuals should seek the assistance of an authorized service technician or dealer.

**NOTE:** Save this Instruction Sheet. Refer to it when ordering replacement parts.

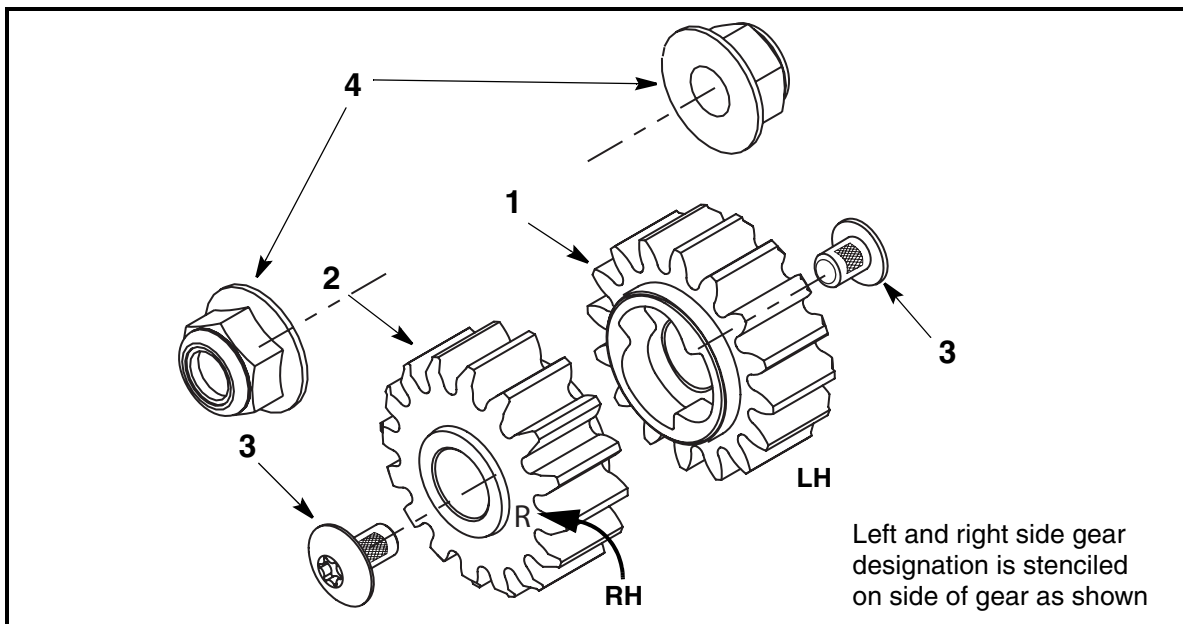

FIGURE 1

## Service Kit Contents (See Figure 1)

ITEM NO.	PART NUMBER	QTY	DESCRIPTION
1	717-04577A	1	GEAR: SPUR: 16T: BRNZ BUSHING: LH
2	717-04578A	1	GEAR: SPUR: 16T: BRNZ BUSHING: RH
3	710-04531	2	SCREW: PATCH: 1/4"-20 x .390: PANTRXI
4	712-04065	2	NUT: FLANGE LOCK: 3/8"-16: GRF:NYLON
5	*	1	THIS INSTRUCTION SHEET

\* - Not Available Separately

### Pre-Service Preparation:

1. Place mower on a flat and level surface, turn off engine and allow muffler and engine to cool before proceeding.

2. Remove spark plug wire from the spark plug and ground to the engine block.

3. Place sufficient wood blocking under rear edge of deck so the rear wheels are off the ground and that there is easy access under the deck to the transmission's output shaft.

### Removal Instructions:

**NOTE:** Left (LH) and right (RH) is determined from the operator's position at the handle bar and facing forward.

4. Using a 9/16" socket and ratchet, remove and discard the hex flange lock nuts retaining the wheels to the pivot bracket assembly's axle studs. Remove both wheels.

5. Using a pair of vise grip pliers, securely clamp onto the transmission's output shaft as shown in Figure 2.

**NOTE:** If the transmission output shaft has a plastic sleeve over it, additional clamping force is required to squeeze the sleeve sufficiently to ensure that the output shaft does not rotate in Step 6.

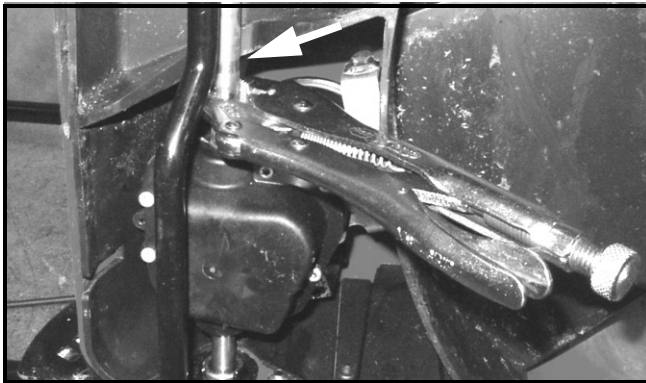

FIGURE 2

6. Using a T30 Torx bit and ratchet **and holding the vise grip pliers to keep the transmission output shaft from rotating**, remove the screw retaining the LH spur gear to the transmission's output shaft.

7. Repeat Step 6 for the RH spur gear.

**NOTE:** Be careful not to loose the drive dowel pin when removing the gears from the output shaft.

8. Discard both screws and spur gears.

9. Wipe clean the ends of the output shaft and both dowel pins from grease, dirt and debris.

### Installation Instructions:

10. Using a light weight lithium or silicone grease, lubricate the RH and LH ends of the transmission output shaft where the spur gears will set.

**NOTE:** Do not get lubricant into the threaded holes at the ends of the transmission's output shaft.

11. Using a light lithium or silicone base grease, lubricate a dowel pin and install it in the cross hole of the LH transmission output shaft.

12. Install the "L" marked spur gear onto the end of the LH output shaft.

13. Using a T30 Torx bit and small ratchet and **holding the vise grip pliers to keep the transmission output shaft from rotating**, install a new 1/4"-20 Torx Head Patch Screw, Item 3. Tighten screw securely.

14. Using a light lithium or silicone base grease, lubricate a dowel pin and install it in the cross hole of the RH transmission output shaft.

15. Install the "R" marked spur gear onto the end of the RH output shaft.

16. Using a T30 Torx bit and small ratchet and **holding the vise grip pliers to keep the transmission output shaft from rotating**, install a new 1/4"-20 Torx Head Patch Screw, Item 3. Tighten screw securely.

17. Replace both wheels and secure using new Hex Flange Lock Nuts, Item 4, with a 9/16" socket and ratchet.

18. Remove the vise grip pliers from the transmission's output shaft.

19. Remove the wood blocking.

20. Reconnect the spark plug wire to the spark plug.

This completes the installation of this service kit.