



SERVICE BULLETIN 405 4 CYCLE

ISSUED: April 1997

SUBJECT: OHV16 thru 17 Falters Due To Lean Fuel Mixture (With fuel shut-off solenoid)

MODELS AFFECTED: OHV16 thru 17 Specification Nos. 204216D, 204217D, 204224D, 204228D, 204604A, 204605A, D.O.M. (Date of Manufacture) Affected 6280 - 7091 Located on ID Tag.

We have received field comments regarding faltering or a lean condition on OHV16 thru 17 HP engines equipped with fuel shut-off solenoids. The manufacturers affected are Ariens and MTD products.

The engineering department has investigated this concern and verified this could occur after 20 - 30 minutes of warm up under the following conditions:

1. Winter/Spring fuel blends which are sensitive to warmer temperatures.
2. Under no load or light cutting conditions.

If you receive a customer comment regarding this condition please order carburetor bowl kit Part No. 730624. To minimize any possible mis-assembly, the kit will include a complete bowl assembly less the main nozzle tube, nozzle spring and gasket. These parts are to be transferred from the old bowl assembly to the new one.

PROCEDURE:

1. Turn off fuel supply or clamp line off from the tank stopping the fuel flow.
2. Remove fuel line clamp and hose from carburetor.
3. Disconnect solenoid wires from terminal on fuel shut-off.
4. Unclip and rotate the bowl retainer arm to the side.
5. Carefully drop the bowl assembly and dispose of the fuel into an approved safe container.
6. Remove the gasket, main nozzle tube, and main nozzle spring from the bowl. These parts will be transferred to the new assembly.



Install the bowl kit with transferred parts as noted in Item 6 above. NOTE the gasket has a notch which lines up with the "V" mark on the fuel bowl. The bowl must be reinstalled as shown with the locating pins properly engaged into the carburetor body. To identify repaired units look for or place a permanent black magic marker line across the flat steel portion of the solenoid facing out as shown. (See Illustration)

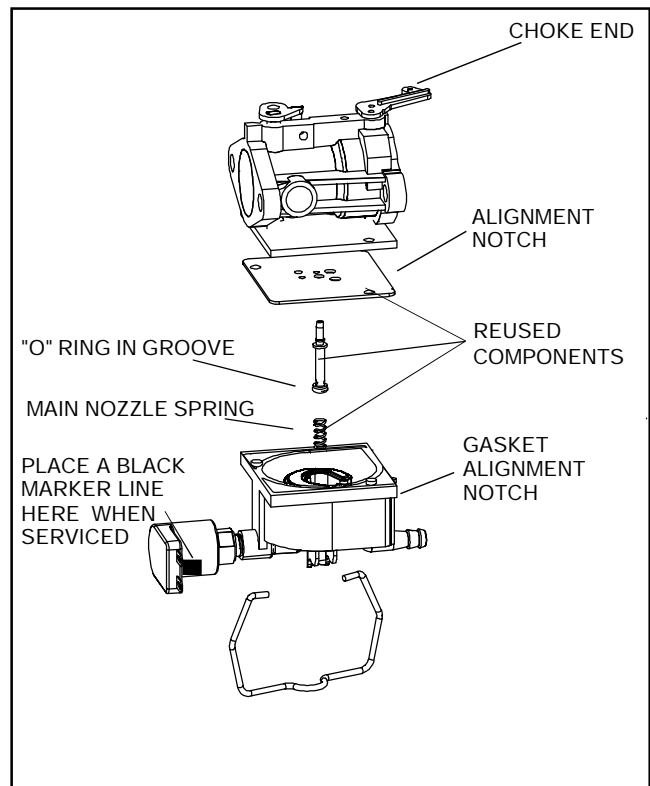

When the repair is complete, return the parts and a properly filled out ESA157 claim form to the address listed on the back of the claim form. The repair time is typically 20 minutes or less on a tractor with side panels and 10 minutes for standard tractors.

Thank you for your usual fine assistance in handling warranty if they occur