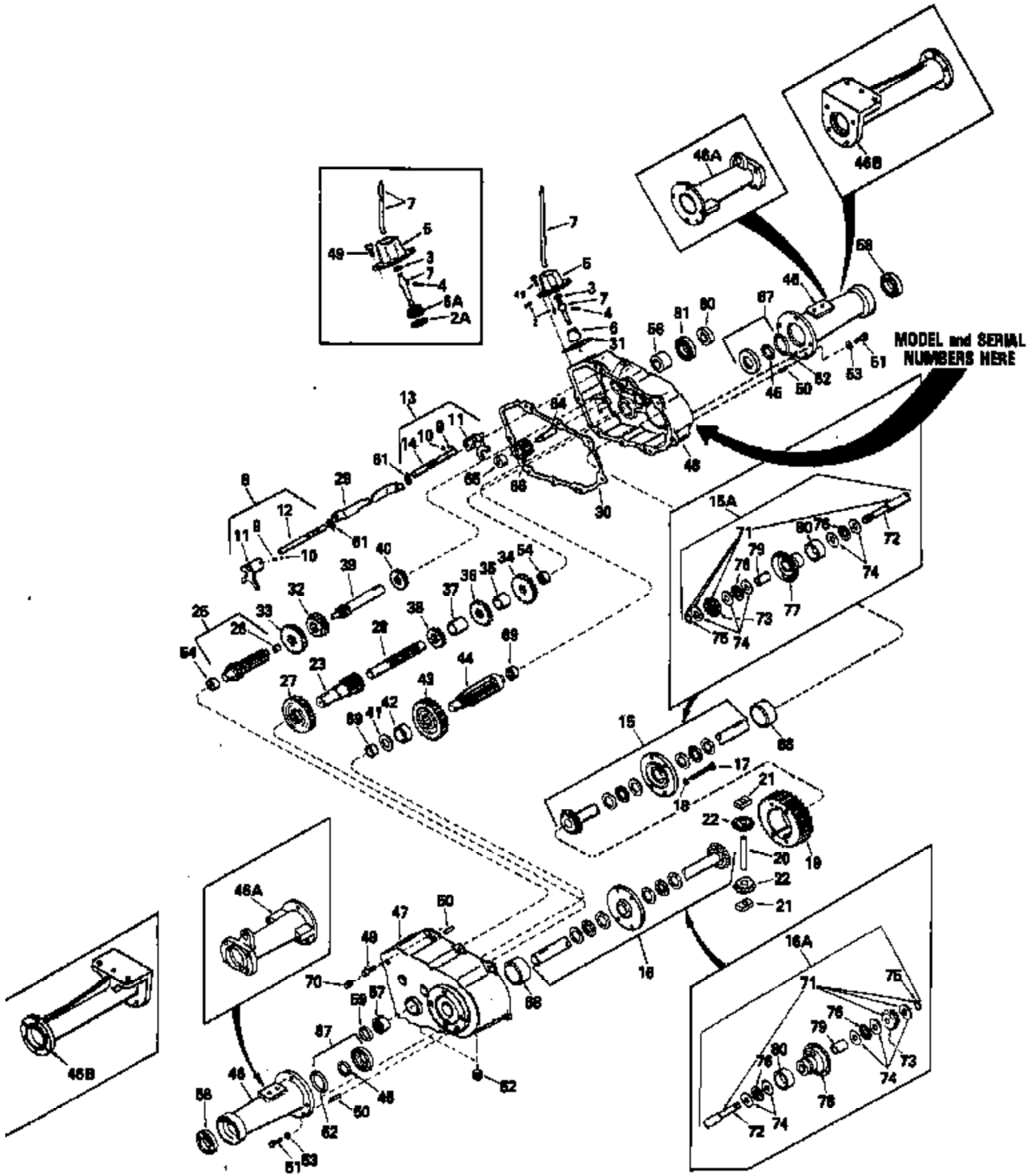

ILLUSTRATION SHOWS TYPICAL PARTS ONLY. ORDER BY PART NUMBER. PARTS NOT LISTED ARE SUPPLIED BY OEM.



Ref #	Part Number	Qty	Description
2	792000		Pin, 1/8 x 3/8
3	792001		"O" Ring
4	792049		Pin, Drive
6	784016		Keeper, Shift lever
7	784037		Lever, Shift
8	784056		Rod & Fork, Shift (Incl. 9 thru 12 & 61)
9	792003		Spring
10	792004		Ball, Steel
11	784004		Fork, Shifter
12	784057		Rod, Shifter (First & Reverse)
13	784054		Rod & Fork, Shift (Incl. 9 thru 11, 1 4 & 61)
14	784055		Rod, Shifter (Second & High)
15A	774022	2000-2003-4 Peerless	Axle Assy., RH (18.906 long) NOTE: Model 2003-4 was built with axle assemblies in which component parts could not be serviced due to bevel gear being rolled on axle. New style axles used on Model 2003 can be used to service earlier Model 2003-4. Retainer and thrust washer, Ref. Nos. 74 & 75 are
16A	774023		Axle Assy., LH (18.906 long) NOTE: Model 2003-4 was built with axle assemblies in which component parts could not be serviced due to bevel gear being rolled on axle. New style axles used on Model 2003 can be used to service earlier Model 2003-4. Retainer and thrust washer, Ref. Nos. 74 & 75 are
17	792005		Screw, 1/4-20 x 2-1/2"
18	792006		Lockwasher, Split 1/4"
19	778033A		Gear, Ring (1.500 wide, 31 teeth)
20	786019		Pin, Drive (.497 dia. x 3.357 long)
21	786027		Block, Drive
22	778030		Bevel Pinion, Differential
23	776022		Shaft & Bushing, Brake (3.687 long)
25	776014		Shaft & Gear, Shifter (Incl. 26)(4.56 2 long)
26	780018		Beaing, Needle
27	778037		Gear, Idler
28	776032		Shaft, Idler (.873 dia. x 5.750 long)
29	784074		Stop, Shifter
30	788026		Gasket, Case to cover
31	788003		Gasket, Shift lever housing
32	778019		Gear, Shifting (Second & High)
33	778020		Gear, Shifting (First & Reverse)
34	788021		Gear, Spur (26 tooth)
35	786014		Spacer, Idler shaft
36	778022		Gear, Idler shaft (22 tooth)
37	786015		Spacer, Idler shaft
38	778023		Gear, Idler shaft (16 tooth)
39	776024		Shaft, Input (4.950 long)
40	778024		Spur Gear, Input shaft
41	780001		Washer, Output shaft
42	786017		Spacer, Output shaft
43	778036		Spur Gear, Output
44	776023		Shaft, Output (6.00 long)
45	788008		Seal, Oil
46B	782012		Housing, LH axle (11.469 long)
47	772037		Cover, Transaxle (Incl. 54, 57, 68 & 69)
48	770028		Case, Transaxle (Incl. 54, 56, 68 & 6 9)

Ref #	Part Number	Qty	Description
49	792007		Screw, 1/4-20 x 3/4"
50	792008		Pin, Dowel (.250 dia. x .750 long)
51	792048		Srew, 3/8-16 x 1"
52	792010		Plug, Inspection & drain
53	792011		Lockwasher, 3/8"
54	780013		Bearing, Needle
56	780140		Bearing (.750 ID x 1.00 OD x .500 lon g)
57	780055		Bearing, Needle
58	780050		Bearing, Ball
59	788008		Seal, Oil
60	788025		Seal, Oil
61	792017		Ring, Snap
67	788037	2000-2003-4 Peerless	Retainer Assy., Seal (Incl. 45)
68	780021		Bearing, Needle
69	780014		Bearing, Needle (closed end)
70	792012		Set Screw, 3/8-16 x 3/8"
81	780024		Bearing, Ball

2000-2003-4 Peerless Page 3 of 3