

| Ref # | Part Number | Qty | Description                       |
|-------|-------------|-----|-----------------------------------|
|       | 1 37467     | 1   | Cylinder (Incl. 2 & 20)           |
|       | 2 27652     | 2   | Dowel Pin                         |
|       | 14 28277    | 2   | Washer                            |
|       | 15 35324    | 1   | Governor Rod                      |
|       | 16 36284A   | 1   | Governor Lever (Incl. 212A)       |
|       | 17 29916    | 1   | Governor Lever Clamp              |
|       | 18 651028   | 1   | Screw, T-15, 8-32 x 3/8"          |
|       | 19 35945    | 1   | Extension Spring                  |
|       | 20 35319    | 1   | Oil Seal                          |
|       | 25 36923    | 1   | Blower Housing Baffle             |
|       | 26 650561   | 2   | Screw, 1/4-20 x 19/32"            |
|       | 28 30322    | 1   | Lock Nut, 8-32                    |
|       | 35 29826    | 1   | Screw, 10-32 x 3/4"               |
|       | 36 29918    | 1   | Lock Washer                       |
|       | 37 29216    | 1   | Lock Nut, 10-32                   |
|       | 38 29642    | 1   | Retainer Ring                     |
|       | 52 31356    | 1   | Oil Pump Assembly                 |
|       | 60 36927A   | 1   | Blower Housing Extension          |
|       | 65 650128   | 1   | Screw, 10-24 x 1/2"               |
|       | 66 30063    | 1   | Screw, T-30, 1/4-20 x 1/2"        |
|       | 90 611240A  | 1   | Flywheel (Incl. 91 & 91A)         |
|       | 91 611241A  | 1   | Flywheel Fan                      |
|       | 91A 611242  | 1   | Flywheel Retainer                 |
|       | 92 651082   | 1   | Lock Washer                       |
|       | 93 650594   | 1   | Flywheel Nut                      |
|       | 100 36344A  | 1   | Solid State Ignition (Incl. 101)  |
|       | 101A 611284 | 1   | Spark Plug Shield                 |
|       | 101 610118  | 1   | Spark Plug Cover                  |
|       | 102 651024  | 2   | Solid State Mounting Stud         |
|       | 103 651007  | 2   | Screw, T-15, 10-24 x 15/16"       |
|       | 110 37494   | 1   | Ground Wire                       |
|       | 119 36932   | 1   | * Cylinder Head Gasket            |
|       | 120 37469   | 1   | Cylinder Head (Incl. 151A & 270A) |
|       | 125 36934   | 1   | Exhaust Valve (Std.)              |
|       | 125 36936   | 1   | Exhaust Valve (1/32" OS)          |
|       | 126 36935   | 1   | Intake Valve (Std.)               |
|       | 127 650691  | 6   | Washer                            |
|       | 128 650690  | 6   | Belleville Washer                 |
|       | 130 650697A | 6   | Screw, 5/16-18 x 2-1/2"           |
|       | 135 34645   | 1   | Spark Plug (RN4C)                 |
|       | 150 33507   | 2   | Valve Spring                      |
|       | 151 33508   | 2   | Valve Spring Keeper               |
|       | 151A 35862  | 1   | Intake Valve Seal                 |
|       | 153 35949   | 1   | Push Rod Guide                    |
|       | 154 650945  | 2   | Rocker Arm Stud                   |
|       | 155 35950   | 2   | Rocker Arm                        |
|       | 156 650890  | 2   | Lock Washer                       |
|       | 157 650947  | 2   | Lock Nut, 5/16-24                 |
|       | 158 35466   | 2   | Push Rod                          |
|       | 159 35952   | 1   | * Rocker Arm Cover Gasket         |
|       | 160 35953A  | 1   | Rocker Arm Housing                |
|       | 161 30063   | 4   | Screw, T-30, 1/4-20 x 1/2"        |
|       | 169 27896A  | 2   | * Breather Gasket                 |
|       | 170 28423   | 1   | Breather Body                     |
|       | 171 28424   | 1   | Breather Element                  |
|       | 172 37555   | 1   | Valve Cover                       |
|       | 173 37591   | 1   | Breather Tube                     |
|       | 174 650128  | 2   | Screw, 10-24 x 1/2"               |

| Ref # | Part Number | Qty | Description                                    |
|-------|-------------|-----|--|
| 180   | 37101       | 1   | Blower Housing Extension                       |
| 181   | 30200       | 2   | Screw, 10-24 x 9/16"                           |
| 186   | 36941       | 1   | Governor Link                                  |
| 186A  | 36991       | 1   | Choke Link                                     |
| 200   | 36360       | 1   | Control Bracket (Incl. 203, 204 & 212 A)       |
| 203   | 36482       | 1   | Compression Spring                             |
| 204   | 651019      | 1   | Screw, T-10, 6-32 x 41/64"                     |
| 209   | 650902      | 2   | Screw, 10-32 x 7/16"                           |
| 210   | 27793       | 1   | Conduit Clip                                   |
| 211   | 28942       | 1   | Screw, 10-32 x 3/8"                            |
| 212A  | 26288       | 1   | Bushing  |
| 260   | 36943       | 1   | Blower Housing                                 |
| 262   | 30063       | 2   | Screw, T-30, 1/4-20 x 1/2"                     |
| 263   | 36367       | 1   | Trim Ring                                      |
| 264   | 650273      | 1   | Screw, 5/16-18 x 17/32"                        |
| 265   | 36944       | 1   | Cylinder Head Cover                            |
| 269   | 35762       | 1   | * Exhaust Manifold Gasket                      |
| 270A  | 35829A      | 1   | Exhaust Port Liner                             |
| 275   | 36542       | 1   | Muffler  |
| 276   | 35348       | 1   | Locking Plate                                  |
| 276A  | 31588       | 1   | Locking Plate                                  |
| 277   | 650877      | 2   | Screw, 5/16-18 x 4-1/2"                        |
| 286   | 36343       | 1   | Cup & Screen                                   |
| 290   | 29774       | 1   | Fuel Line (5.88")                              |
| 291A  | 29774       | 1   | Fuel Line (2.00")                              |
| 291   | 30705       | 1   | Fuel Line                                      |
| 292   | 26460       | 6   | Fuel Line Clamp                                |
| 293A  | 650931      | 2   | Screw, 8-32 x 1-1/2"                           |
| 293   | 35787       | 1   | Pulse Pump (Incl. 294)                         |
| 294   | 35791       | 1   | Pulse Pump Repair Kit                          |
| 295   | 37147       | 1   | Fuel Shut-Off Valve (Incl. 292)                |
| 296   | 37768       | 1   | Fuel Filter (Incl. 292)                        |
| 303   | 29634       | 1   | Fuel Fitting                                   |
| 314   | 650873      | 2   | Screw, 1/4-20 x 3/4"                           |
| 315   | 611285      | 1   | Alternator Coil (3/5 Split)(Incl. 321 - 323)   |
| 321   | 611161      | 1   | Diode  |
| 322   | 611281      | 1   | Connector Body                                 |
| 323   | 611282      | 2   | Terminal                                       |
| 325   | 34246       | 1   | Wire Clip                                      |
| 326   | 36210       | 1   | Screen Plug                                    |
| 346   | 36413       | 1   | Pulse Pump Bracket                             |
| 346A  | 650561      | 1   | Screw, 1/4-20 x 19/32"                         |
| 347   | 650949      | 3   | Screw, 10-32 x 9/16"                           |
| 361   | 651072      | 2   | Screw, T-30, 5/16-18 x 1-21/32"                |
| 370   | 36261       | 1   | Name Decal                                     |
| 370G  | 35274       | 1   | Oil Instruction Decal                          |
| 395   | 37425       | 1   | Electric Starter Motor (Incl. 361)             |
| 400   | 36947B      | 1   | * Gasket Set (Incl. items marked PK i n notes) |
| 420   | 730225A     | 1   | SAE 30 4-Cycle Engine Oil (Quart)              |

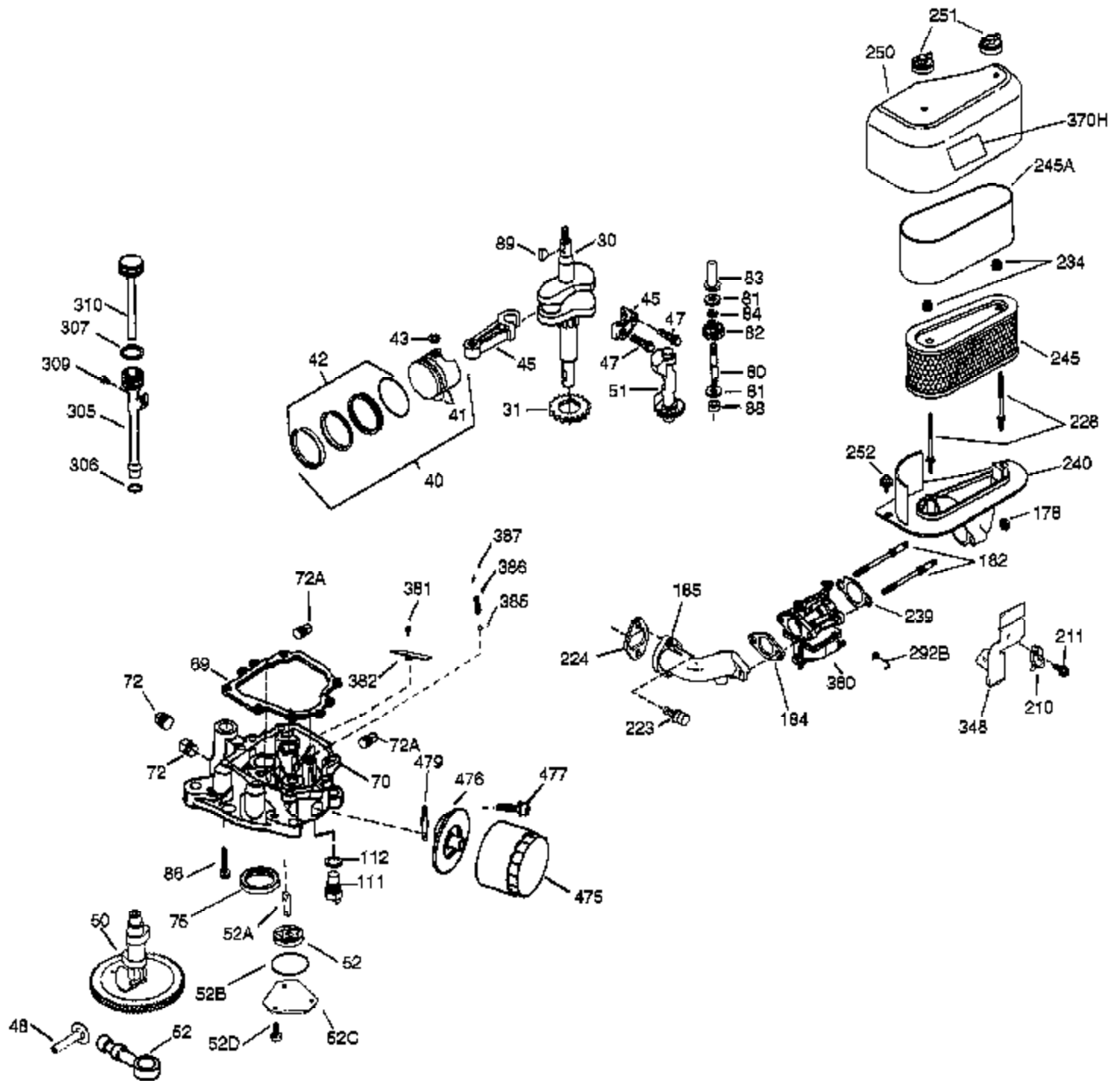

| Ref # | Part Number | Qty | Description                               |
|-------|-------------|-----|---|
| 30    | 36924       | 1   | Crankshaft                                |
| 31    | 35327       | 1   | Counterbalance Gear                       |
| 40    | 35776A      | 1   | Piston, Pin & Ring Set (Std.)             |
| 40    | 35777A      | 1   | Piston, Pin & Ring Set (.010" OS)         |
| 40    | 35778A      | 1   | Piston, Pin & Ring Set (.020" OS)         |
| 41    | 35773A      | 1   | Piston & Pin Ass'y. (Std.) (Incl. 43)     |
| 41    | 35774A      | 1   | Piston & Pin Ass'y. (.010" OS) (Incl. 43) |
| 41    | 35775A      | 1   | Piston & Pin Ass'y. (.020" OS) (Incl. 43) |
| 42    | 35779       | 1   | Ring Set (Std.)                           |
| 42    | 35780       | 1   | Ring Set (.010" OS)                       |
| 42    | 35781       | 1   | Ring Set (.020" OS)                       |
| 43    | 35772       | 2   | Piston Pin Retaining Ring                 |
| 45    | 36925       | 1   | Connecting Rod Ass'y. (Incl. 47)          |
| 47    | 651033      | 2   | Connecting Rod Bolt                       |
| 48    | 35313       | 2   | Valve Lifter                              |
| 50    | 37078       | 1   | Camshaft (MCR)                            |
| 51    | 35315A      | 1   | Counterbalance Weight                     |
| 52    | 31356       | 1   | Oil Pump Assembly                         |
| 69    | 35317       | 1   | * Mounting Flange Gasket                  |
| 70    | 36987       | 1   | Mounting Flange (Incl. 72, 75 & 80)       |
| 72    | 31927       | 1   | Oil Drain Plug                            |
| 75    | 35319       | 1   | Oil Seal                                  |
| 80    | 35712       | 1   | Governor Shaft                            |
| 81    | 35479A      | 2   | Washer                                    |
| 82    | 35321       | 1   | Governor Gear Ass'y.                      |
| 83    | 35322       | 1   | Governor Spool                            |
| 84    | 29193       | 1   | Retaining Ring                            |
| 86    | 650833      | 7   | Screw, 1/4-20 x 1-3/16"                   |
| 88    | 31707A      | 1   | Spacer                                    |
| 89    | 650592      | 1   | Flywheel Key                              |
| 101A  | 611284      | 1   | Spark Plug Shield                         |
| 178   | 650928      | 2   | Lock Nut, 1/4-20                          |
| 182   | 650925A     | 2   | Carburetor Mounting Stud                  |
| 184   | 36352       | 1   | * Carburetor To Intake Pipe Gasket        |
| 185   | 36940       | 1   | Intake Pipe                               |
| 210   | 27793       | 1   | Conduit Clip                              |
| 211   | 28942       | 1   | Screw, 10-32 x 3/8"                       |
| 223   | 650378      | 2   | Screw, T-30, 5/16-18 x 1-3/32"            |
| 224   | 36942       | 1   | * Intake Pipe Gasket                      |
| 228   | 650977      | 2   | Air Cleaner Stud                          |
| 234   | 650825      | 2   | Nut & Lock Washer, 1/4-20                 |
| 239   | 36358       | 1   | * Air Cleaner Gasket                      |
| 240   | 36355       | 1   | Air Cleaner Body (Incl. 228 & 239)        |
| 245   | 36356       | 1   | Air Cleaner Filter (Incl. 234)            |
| 250   | 36359       | 1   | Air Cleaner Cover                         |
| 251   | 650886      | 2   | Wing Nut, 1/4-20                          |
| 252   | 650976      | 1   | Screw, 1/4-20 x 19/32"                    |
| 276A  | 31588       | 1   | Locking Plate                             |
| 286   | 36343       | 1   | Cup & Screen                              |
| 292B  | 36946       | 2   | Fuel Line Clamp                           |
| 305   | 36945       | 1   | Oil Fill Tube                             |
| 306   | 34265       | 1   | Fill Tube Gasket                          |
| 307   | 35499       | 1   | "O" Ring                                  |
| 309   | 650976      | 1   | Screw, 1/4-20 x 19/32"                    |
| 309   | 650976      | 1   | Screw, 1/4-20 x 19/32"                    |
| 310   | 35973       | 1   | Dipstick                                  |
| 380   | 640065A     | 1   | Carburetor (Incl. 184)                    |