

| Ref # | Part Number | Qty | Description |
|-------|-------------|-----|--|
| | 1 xxxxx | 1 | Cylinder (Order S/B if replacement is needed) |
| 16B | 490291A | 1 | Air Vane |
| 19 | 570707 | 1 | Extension Spring |
| 24 | 530110 | 1 | Ball Bearing |
| 29A | 530104A | 1 | Cartridge Bearing |
| 29 | 530150 | 1 | Needle Bearing & Liner Set (37 Needle s) |
| 30 | 290609 | 1 | Crankshaft |
| 33A | 570644 | 1 | Cover Plate |
| 34A | 650579 | 4 | Screw, Torx T-25, 10-24 x 1/2" |
| 41 | 310283A | 1 | Piston & Pin Ass'y. (Incl. 43) |
| 42 | 310190 | 2 | Ring Set |
| 43 | 310167 | 2 | Piston Pin Retaining Ring |
| 45 | 310235B | 1 | Connecting Rod Ass'y. (Incl. 29, 29A, & 46) |
| 46 | 650633 | 4 | Connecting Rod Bolt |
| 69 | 510292A | 1 | * Cylinder Cover Gasket |
| 69A | 510323A | 1 | * Cover Plate Gasket |
| 75 | 510319 | 2 | Oil Seal |
| 77 | 530105 | 1 | Cartridge Bearing |
| 89A | 611032 | 1 | Adapter Sleeve |
| 90 | 611066 | 1 | Flywheel |
| 92 | 650815 | 1 | Belleville Washer |
| 93 | 650390 | 1 | Flywheel Nut |
| 100 | 34443A | 1 | Solid State Ignition (Incl. 101) |
| 101 | 610118 | 1 | Spark Plug Cover |
| 103 | 650814 | 2 | Screw, Torx T-15, 10-24 x 1" |
| 110 | 611141 | 1 | Ground Wire |
| 119 | 510274A | 1 | * Cylinder Head Gasket |
| 120 | 250240B | 1 | Cylinder Head |
| 131 | 650477 | 5 | Screw, Torx T-30, 1/4-20 x 3/4" |
| 135 | 611049 | 1 | Resistor Spark Plug (RCJ8Y) |
| 163 | 650838 | 1 | Washer |
| 169 | 510325A | 1 | * Compression Release Cover Gasket |
| 172A | 570708 | 1 | Compression Release Cover |
| 174 | 650579 | 1 | Screw, Torx T-25, 10-24 x 1/2" |
| 177 | 650959 | 2 | Screw, 5/32 Allen, 1/4-20 x 1" |
| 184 | 510326A | 2 | * Carburetor Gasket |
| 186 | 490322 | 1 | Governor Link |
| 187 | 570438A | 1 | Spacer |
| 216 | 570645 | 1 | R.P.M. Adjusting Lever |
| 239 | 35815 | 1 | Air Cleaner Gasket |
| 257 | 650911 | 4 | Screw, Torx T-30, 1/4-20 x 5/8" |
| 258 | 350422 | 1 | Blower Housing Base (Incl. 75) |
| 260 | 350454 | 1 | Blower Housing |
| 261 | 650737 | 4 | Screw, 1/4-20 x 1/2" |
| 274 | 510207A | 1 | * Exhaust Gasket |
| 277 | 650869 | 2 | Screw, 1/4-20 x 2-3/4" |
| 285 | 590551 | 1 | Starter Cup |
| 287 | 650926 | 3 | Screw, 8-32 x 21/64" |
| 325 | 29443 | 1 | Wire Clip |
| 351 | 32180C | 1 | Primer Line |
| 370 | 36261 | 1 | Lubrication Decal |
| 380 | 632410B | 1 | Carburetor (Incl. 184) |
| 390 | 590652 | 1 | Rewind Starter |
| 400 | 510324B | 1 | * Gasket Set (Incl. items marked PK i n notes) Incl. (1) each of part #'s 510207A, 510274A, 510292A, 510323A, 510325A, 510326A, 510346A, and (2) of part # 510110A |

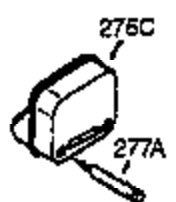
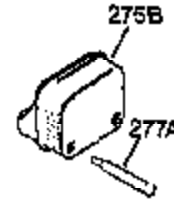
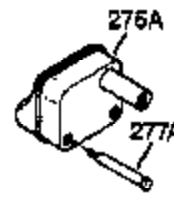
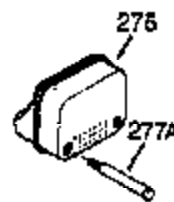
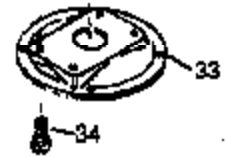
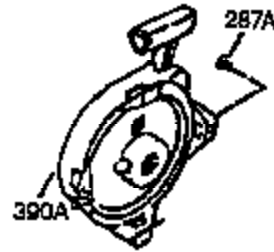
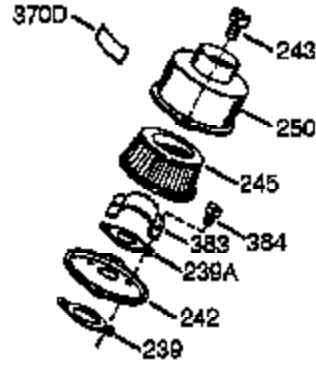
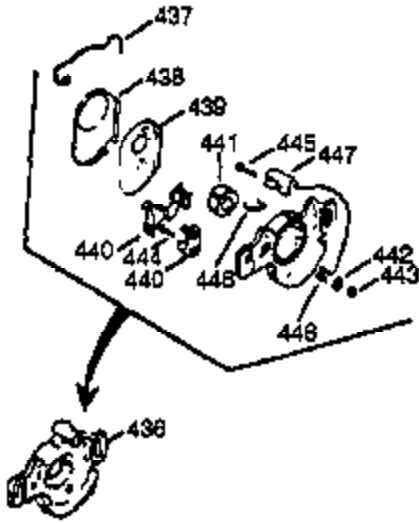

| Ref # | Part Number | Qty | Description |
|-------|-------------|-----|--------------------------------|
| 239 | 35815 | 1 | Air Cleaner Gasket |
| 275 | 390330 | 1 | Muffler (Incl. 274 & 277) |
| 383 | 570434 | 1 | Spit Cup |
| 384 | 650431 | 2 | Screw, Torx T-25, 10-32 x 5/8" |
| 420 | 730227A | 1 | 2-Cycle Oil (8 oz.) |