

Engine Parts List #1

| Ref # | Part Number | Qty | Description |
|-------|-------------|-----|---|
| 1 | 32668 | 0 | Cylinder Assy. (2-5/16" Bore) |
| 2 | 26727 | 0 | Pin, Dowel |
| 3 | 27642 | 0 | Plug, Drain |
| 3A | 27642 | 0 | Plug, Drain |
| 4 | 29183 | 0 | Seal, Oil |
| 5 | 29314A | 0 | Valve, Intake (Standard) |
| 5 | 29315B | 0 | Valve, Intake (1/32" oversize) |
| 6 | 29313B | 0 | Valve, Exhaust (Standard) |
| 6 | 29315B | 0 | Valve, Intake (1/32" oversize) |
| 7 | 31671 | 0 | Cap, Upper valve spring |
| 8 | 31672 | 0 | Spring, Valve |
| 9 | 31673 | 0 | Cap, Lower valve spring |
| 11 | 32555A | 0 | Crankshaft Assy. |
| 12 | 29783 | 0 | Pin, Crankshaft gear |
| 13 | 27613 | 0 | Gear, Crankshaft |
| 14 | 31761 | 0 | Piston & Pin Assy. (Standard) (2-5/16") |
| 14 | 32662 | 0 | Piston & Pin Assy. (.010 oversize) |
| 14 | 32663 | 0 | Piston & Pin Assy. (.020 oversize) |
| 15 | 27565 | 0 | Ring Set, Piston (Standard) (2-5/16") |
| 15 | 27566 | 0 | Ring Set, Piston (.010 oversize) |
| 15 | 27567 | 0 | Ring Set, Piston (.020 oversize) |
| 16 | 20381 | 0 | Ring, Piston pin retaining |
| 17 | 30963B | 0 | Rod Assy., Connecting |
| 18 | 26706 | 0 | Bolt, Connecting rod |
| 19 | 28594 | 0 | Dipper, Oil |
| 20 | 27573 | 0 | Nut, Connecting rod bolt |
| 21 | 31317 | 0 | Camshaft (No compression release) |
| 22 | 27241 | 0 | Lifter, Valve |
| 23 | 30941D | 0 | Cover, Cylinder |
| 24 | 30256 | 0 | Seal, Oil |
| 25 | 27625 | 0 | Plug, Oil filler |
| 26 | 29673 | 0 | Gasket, Filler plug |
| 27 | 27677 | 0 | Gasket, Cylinder cover |
| 28 | 30564 | 0 | Screw |
| 29 | 30981 | 0 | Bushing, Crankshaft |
| 30 | 650168 | 0 | Washer, Flat |
| 30 | 650675 | 0 | Washer, Flat |
| 31A | 650489 | 0 | Screw |
| 31 | 650489 | 0 | Screw |
| 32 | 29953B | 0 | Gasket, Cylinder head |
| 33 | 30579 | 0 | Head, Cylinder |
| 34 | 26073 | 0 | Washer, Connecting rod bolt |
| 35 | 6021 | 0 | Screw |
| 35 | 650694 | 0 | Screw, Hex hd. cap, 5/16-18 x 2 |
| 35 | 650695 | 0 | Screw, Hex hd. cap, 5/16-18 x 2-1/4 (Grade 8) |
| 37 | 33636 | 0 | Plug, Spark (Champion J-8 or equivalent) |
| 38 | 31619 | 0 | Gasket, Breather cover |
| 39 | 31337 | 0 | Breather Assy. |
| 40 | 31410 | 0 | Element, Breather |
| 42 | 650128 | 0 | Screw |
| 45 | 26754 | 0 | Gasket, Exhaust |
| 47 | 650664 | 0 | Screw, Phil. fil. hd. Sems, 1/4-20 x 1-19/32 |
| 48 | 30646 | 0 | Screw, Phil. fil. hd. Sems, 1/4-20 x 1-3/8 |
| 48 | 650517 | 0 | Screw, Fil. flex hd. self-locking, 1/4-20 x |
| 48 | 650664 | 0 | Screw, Phil. fil. hd. Sems, 1/4-20 x 1-19/32 |
| 50 | 650708 | 0 | Washer, Flat 5/16" |
| 50 | 8303 | 0 | Lockwasher |
| 53 | 650152 | 0 | Screw |

Engine Parts List #1

| Ref # | Part Number | Qty | Description |
|-------|-------------|-----|---|
| 53 | 650684 | 0 | Screw, Fil. hd mach., 8-32 x 5/16 |
| 58 | 31341 | 0 | Link, Throttle |
| 59 | 31336 | 0 | Lever, Governor |
| 63A | 31334 | 0 | Rod, Governor |
| 64 | 30658 | 0 | Baffle, Blower housing |
| 65 | 30200 | 0 | Screw |
| 65 | 650561 | 0 | Screw |
| 66 | 31345 | 0 | Plate, Identification |
| 67 | 29309 | 0 | Stud, Drive |
| 68 | 650548 | 0 | Screw, Hex washer hd., 8-32 x 5/16 |
| 69 | 29212 | 0 | Screw |
| 70 | 30655A | 0 | Housing, Blower |
| 71 | 650490 | 0 | Washer, Belleville |
| 72 | 650607 | 0 | Nut, Flywheel |
| 73 | 29716 | 0 | Screw |
| 74 | 16645 | 0 | Lockwasher |
| 75 | 30747 | 0 | Clip, Shorting |
| 76 | 30596 | 0 | Decal, Name & H.P. (2-1/4 H.P.) |
| 76 | 30597 | 0 | Decal, Name & H.P. (3 H.P.) |
| 76 | 30612 | 0 | Decal, Name & H.P. (3-1/2 H.P.) |
| 76 | 30631 | 0 | Decal, Name & H.P. (2-1/2 H.P.) |
| 76 | 31328 | 0 | Decal, Name & H.P. (4 H.P.) |
| 76A | 33306 | 0 | Decal, Mini-Bike (2-1/2 H.P.) |
| 76A | 33307 | 0 | Decal, Mini-Bike (3 H.P.) |
| 76A | 33308 | 0 | Decal, Mini-Bike (3-1/2 H.P.) |
| 78A | 30767 | 0 | Spacer, Air cleaner |
| 78 | 27272 | 0 | Gasket, Air cleaner |
| 83 | 28820 | 0 | Screw |
| 83 | 650163 | 0 | Screw, Fil. hd. Sems, 10-32 x 7/8 |
| 83 | 650399 | 0 | Screw, Phil. fil. hd. Sems, 10-32 x 5/8 |
| 83 | 650709 | 0 | Screw |
| 84 | 30564 | 0 | Screw |
| 84 | 6201 | 0 | Screw |
| 84 | 6202 | 0 | Screw |
| 84 | 650551 | 0 | Screw, Hex hd. cap, 1/4-28 x 1-1/4 |
| 87 | 31688 | 0 | Gasket, Carburetor (1/8 thick) |
| 89 | 29752 | 0 | Nut |
| 90 | 31432 | 0 | Bracket, Speed limit |
| 91 | 27793 | 0 | Clip, Conduit |
| 92 | 28942 | 0 | Screw |
| 95 | 28277 | 0 | Washer, Flat |
| 96 | 31349 | 0 | Spring, Extension |
| 106 | 30574 | 0 | Shaft, Mechanical governor |
| 107 | 30591 | 0 | Gear Assy., Governor |
| 107A | 30590A | 0 | Washer, Flat |
| 108 | 29193 | 0 | Ring, Retaining |
| 109 | 30588A | 0 | Spool, Governor |
| 110 | 28212 | 0 | Spacer |
| 111A | 32661 | 0 | Bracket, Upper fuel tank |
| 113 | 30688 | 0 | Screw, Hex hd. Sems, 1/4-20 x 1/2 |
| 113 | 650306 | 0 | Screw, Hex hd. cap, 1/4-20 x 1/2 |
| 113 | 650561 | 0 | Screw |
| 114 | 32660 | 0 | Tank Assy., Fuel (Charcoal Poly) (1 qt.) |
| 115 | 26027 | 0 | Cap, Fuel filler (Special bayonet type) |
| 115 | 30998B | 0 | Cap, Fuel filler (Red Plastic) (Sno Proof) |
| 115 | 32387A | 0 | Cap, Fuel filler (Charcoal Plastic) (Spurt) |
| 115 | 33032 | 0 | Cap, Fuel filler (Red Plastic) (Spurt) |
| 115 | 410144B | 0 | Cap, Fuel filler (White Plastic) (Std.) |

Engine Parts List #1

| Ref # | Part Number | Qty | Description |
|-------|-------------|-----|--|
| 116 | 650556 | 0 | Screw |
| 116 | 650665 | 0 | Screw |
| 116 | 650697 | 0 | Screw, Hex hd. cap, 5/16-18 x 2-1/2 |
| 117B | 29683 | 0 | Strainer & Shut-off |
| 117B | 32961 | 0 | Valve, Fuel shut-off |
| 117 | 28837 | 0 | Strainer & Fitting |
| 118 | 29774 | 0 | Line, Fuel (Braided 8.25") |
| 118 | 30705 | 0 | Line, Fuel (Braided 16") |
| 118 | 30962 | 0 | Line, Fuel (Braided 32") |
| 119A | 31778 | 0 | Spring, Coil |
| 119 | 28819 | 0 | Spring, Fuel line |
| 122 | 30002 | 0 | Decal, Air cleaner |
| 126 | 30322 | 0 | Nut & Lockwasher |
| 129 | 27247 | 0 | Key, Flywheel |
| 130 | 32576 | 0 | Seal, Snow guard |
| 131 | 31680 | 0 | Guard, Starter |
| 132 | 31875 | 0 | Baffle, Heat |
| 133 | 28763 | 0 | Screw, Hex washer hd. thread-forming, 10-24 |
| 137 | 31373 | 0 | Spacer, Carburetor |
| 155 | 32664 | 0 | Baffle, Heat |
| 161 | 30592 | 0 | Decal, Instruction |
| 161 | 31714 | 0 | Decal, Instruction |
| 161 | 33320 | 0 | Decal, Instruction Spec. Nos. 25205H, 212H, |
| 166 | 33356 | 0 | Terminal, Ground |
| 167 | 29117 | 0 | Screw |
| 167 | 30688 | 0 | Screw, Hex hd. Sems, 1/4-20 x 1/2 |
| 167 | 650561 | 0 | Screw |
| 167 | 650643 | 0 | Screw |
| 168 | 27675 | 0 | Nut, Conduit |
| 176 | 650116 | 0 | Nut, Lock |
| 178 | 30200 | 0 | Screw |
| 179 | 28539 | 0 | Ring, Retaining (All ball bearing models) |
| 180 | 28537 | 0 | Washer, Flat |
| 181 | 28458 | 0 | Bearing, Ball All ball bearing models except |
| 183 | 31861 | 0 | Clip, Shorting |
| 184 | 29443 | 0 | Clip, Fuel line |
| 185 | 31335 | 0 | Clamp, Governor lever |
| 203 | 30865 | 0 | Link, Bellcrank |
| 204 | 27275 | 0 | Clip, Hi-tension wire |
| 209A | 32187 | 0 | Decal, Super-start |
| 209 | 32179 | 0 | Decal, Super-start |
| 213 | 30595 | 0 | Decal, Ezee-start |
| 214 | 650518 | 0 | Lockwasher, No. 10 |
| 216 | 730127 | 0 | Cleaner Assy., Air (Poly) |
| 217 | 730512 | 0 | Kit, Pre-cleaner |
| 218 | 31668 | 0 | Bag, Pre-cleaner |
| 219 | 31667 | 0 | Spring, Pre-cleaner bag |
| 221 | 26460 | 0 | Clamp, Fuel line |
| 222 | 30980 | 0 | Bushing, Crankshaft |
| 231 | 30968 | 0 | Nipple, Oil (2-1/2") |
| 231 | 32678 | 0 | Nipple, Oil drain |
| 232 | 30969 | 0 | Cap, Oil drain |
| 233 | 28250 | 0 | Decal, H.P. (3 H.P.) |
| 233 | 30077 | 0 | Decal, H.P. (3-1/2 H.P.) |
| 233 | 31427 | 0 | Decal, H.P. (2-1/2 H.P.) |
| 234 | 590417 | 0 | Screen, Starter cup |
| 234A | 590416 | 0 | Cup, Starter |
| 235 | 28942 | 0 | Screw |

| Ref # | Part Number | Qty | Description |
|-------|-------------|-----|------------------------|
| 235 | 30200 | 0 | Screw |
| 238 | 28545 | 0 | Grommet, Plastic |
| 243 | 30879 | 0 | Bracket, Toggle switch |
| 244 | 610164 | 0 | Switch, Toggle |
| 259 | 30547A | 0 | Contact Assy., Breaker |
| 260 | 30548A | 0 | Condenser |
| 262 | 610690A | 0 | Magneto, Tecumseh |
| 263 | 590420 | 0 | Starter, Rewind |
| 264 | 33233 | 0 | Gasket Set |

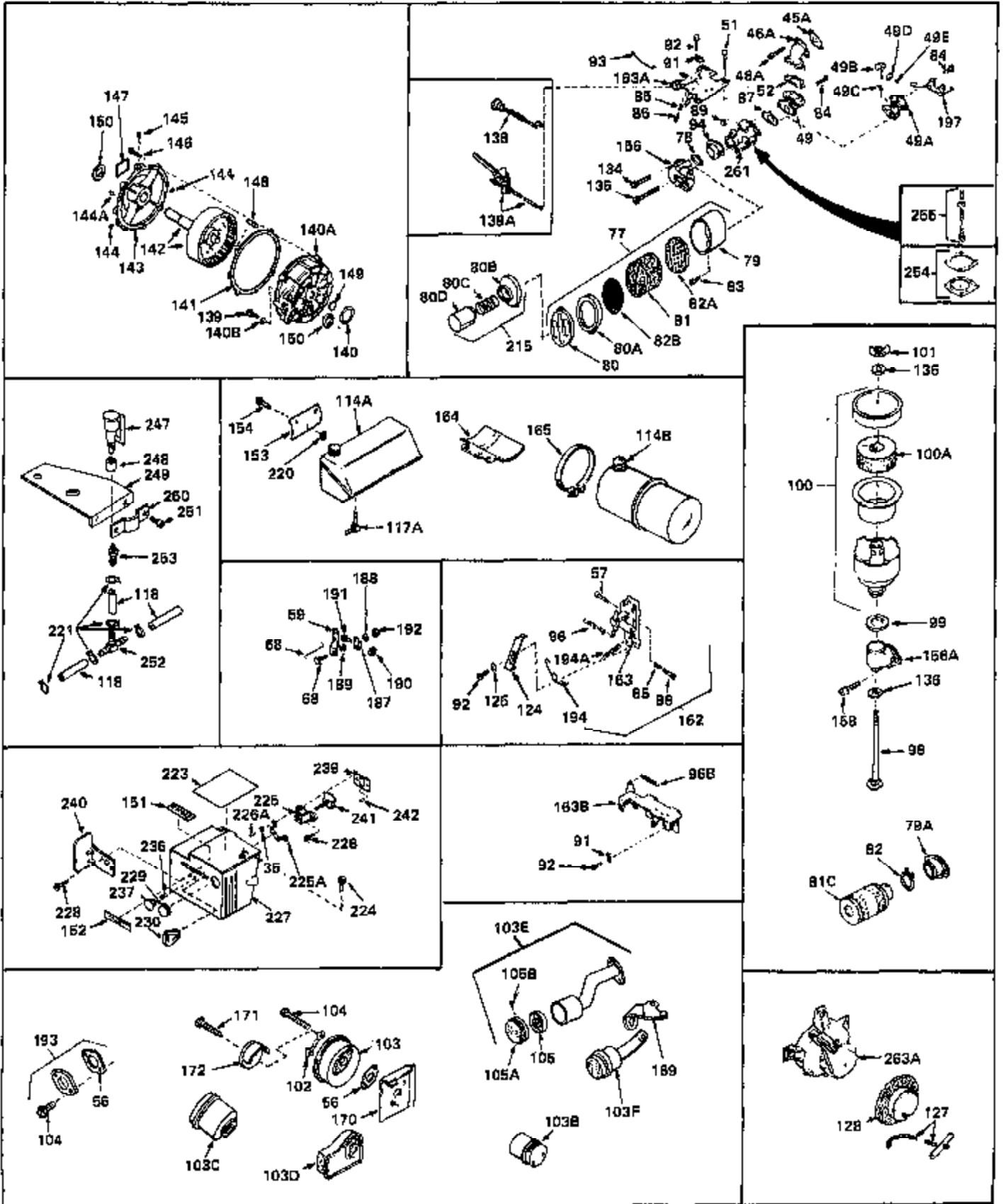

Engine Parts List #2

| Ref # | Part Number | Qty | Description |
|-------|-------------|-----|---|
| 36 | 8269 | 0 | Washer |
| 45A | 30188 | 0 | Gasket, Intake pipe |
| 46A | 31429 | 0 | Pipe, Upper intake |
| 48A | 650451 | 0 | Screw |
| 49 | 31430 | 0 | Pipe, Lower intake |
| 51 | 650454 | 0 | Screw, Fil. flex hd. 1/4-20 x 3/4 |
| 52 | 31340 | 0 | Gasket, Intake pipe |
| 56 | 30081 | 0 | Gasket, Exhaust |
| 57 | 28942 | 0 | Screw |
| 57 | 30091 | 0 | Screw, Hex slotted washer hd., 8-32 x 1/2 |
| 57 | 30200 | 0 | Screw |
| 59 | 31336 | 0 | Lever, Governor |
| 68 | 650548 | 0 | Screw, Hex washer hd., 8-32 x 5/16 |
| 77 | 31545 | 0 | Cleaner Assy., Air |
| 78 | 27272 | 0 | Gasket, Air cleaner |
| 79 | 31312 | 0 | Body, Air cleaner |
| 80D | 450124 | 0 | Bag, Pre-cleaner |
| 80 | 30585 | 0 | Cover, Air cleaner |
| 80C | 450150 | 0 | Spring, Pre-cleaner |
| 81 | 29961 | 0 | Element, Air cleaner |
| 82A | 29962 | 0 | Screen, Air cleaner |
| 83 | 28820 | 0 | Screw |
| 83 | 650163 | 0 | Screw, Fil. hd. Sems, 10-32 x 7/8 |
| 83 | 650399 | 0 | Screw, Phil. fil. hd. Sems, 10-32 x 5/8 |
| 83 | 650709 | 0 | Screw |
| 84 | 30564 | 0 | Screw |
| 84 | 6201 | 0 | Screw |
| 84 | 6202 | 0 | Screw |
| 84 | 650551 | 0 | Screw, Hex hd. cap, 1/4-28 x 1-1/4 |
| 85 | 28564 | 0 | Spring, Compression |
| 85 | 31342 | 0 | Spring, Compression |
| 85 | 32924 | 0 | Spring, Compression |
| 86 | 29500 | 0 | Screw, Fil. hd. mach., Sems, 8-32 x 3/4 |
| 86 | 650549 | 0 | Screw |
| 86 | 650688 | 0 | Screw, Hex hd., 10-32 x 1-5/16" (Drilled |
| 87 | 31688 | 0 | Gasket, Carburetor (1/8 thick) |
| 89 | 29752 | 0 | Nut |
| 91 | 27793 | 0 | Clip, Conduit |
| 92 | 28942 | 0 | Screw |
| 96 | 31349 | 0 | Spring, Extension |
| 101 | 9577 | 0 | Nut, Wing, 10-24 |
| 102 | 30083 | 0 | Plate, Locking |
| 103 | 30996 | 0 | Muffler |
| 103F | 33288 | 0 | Muffler |
| 104 | 27182 | 0 | Screw, Hex hd. cap, 1/4-20 x 3-3/8 |
| 104 | 650253 | 0 | Screw, Hex hd. cap, 1/4-20 x 2-1/4 |
| 104 | 650327 | 0 | Screw, Fil slotted hd. Sems, 114-20 x 2-1/2 |
| 104 | 650493 | 0 | Screw, Hex hd. Sems, 1/4-20 x 1-3/4 |
| 104 | 650561 | 0 | Screw |
| 104 | 650599 | 0 | Screw, Hex hd. cap, Sems, 1/4-20 x 1-1/2 |
| 104 | 650795 | 0 | Screw, Hex hd. cap, Sems, 1/4-20 x 2-5/16 |
| 105A | 33172 | 0 | Cover, Muffler |
| 105B | 650578 | 0 | Screw |
| 105 | 33171 | 0 | Screen, Muffler |
| 117A | 28584 | 0 | Strainer & Elbow |
| 118 | 29774 | 0 | Line, Fuel (Braided 8.25") |
| 118 | 30705 | 0 | Line, Fuel (Braided 16") |
| 118 | 30962 | 0 | Line, Fuel (Braided 32") |

Engine Parts List #2

| Ref # | Part Number | Qty | Description |
|-------|-------------|-----|---|
| 134 | 650163 | 0 | Screw, Fil. hd. Sems, 10-32 x 7/8 |
| 135 | 650520 | 0 | Screw |
| 135 | 650544 | 0 | Screw, Pan flex hd., 10-24 x 7/8 |
| 136 | 27183 | 0 | Washer, Fiber |
| 136 | 31905 | 0 | Washer, Paper |
| 138A | 24522 | 0 | Control, Throttle |
| 138 | 30985 | 0 | Control, Throttle |
| 139 | 28454 | 0 | Screw |
| 140B | 8274 | 0 | Lockwasher |
| 140 | 28451 | 0 | Gasket, Housing |
| 140A | 30516 | 0 | Housing, Reducer |
| 141 | 30517A | 0 | Gasket, Reduction cover |
| 143 | 30518 | 0 | Cover, Housing (All 6:1 gear reduction |
| 144 | 9556 | 0 | Plug, Oil drain (Sq. hd. pipe, 1/8-27) |
| 145 | 24590 | 0 | Plug, Pipe |
| 146 | 30564 | 0 | Screw |
| 148 | 32714 | 0 | Pin, Shaft & Gear (All 6:1 gear reduction |
| 149 | 28508 | 0 | Plug, Expansion |
| 150 | 30256 | 0 | Seal, Oil |
| 151 | 31268 | 0 | Decal, Choke |
| 154 | 650561 | 0 | Screw |
| 158 | 650163 | 0 | Screw, Fil. hd. Sems, 10-32 x 7/8 |
| 162 | 730136A | 0 | Control Assy., Mini Bike Speed |
| 163A | 31441 | 0 | Control Assy., Speed |
| 169 | 33127 | 0 | Bracket, Muffler |
| 170 | 31874 | 0 | Baffle, Heat |
| 171 | 650665 | 0 | Screw |
| 172 | 30997 | 0 | Cover, Muffler |
| 193 | 730162 | 0 | Kit, Muffler Adapter |
| 215 | 730510 | 0 | Kit, Pre-cleaner |
| 220 | 31266 | 0 | Spacer, Strip |
| 221 | 26460 | 0 | Clamp, Fuel line |
| 224 | 650687 | 0 | Screw, Pan hd. self-tap, 10-32 x 5/16 |
| 228 | 650257 | 0 | Screw, Pan hd. Sems, 8-32 x 5/16 |
| 229 | 31291 | 0 | Plug, Cover |
| 230 | 32410 | 0 | Knob, Speed control |
| 236 | 32399 | 0 | Spring, Choke knob |
| 237 | 32400 | 0 | Knob, Choke |
| 241 | 32397 | 0 | Plate Assy., Choke |
| 242 | 650571 | 0 | Screw, Flat trim hd. mach. , 10-32 x 7/16 |
| 254 | 630978 | 0 | Diaphragm & Gasket Assy. |
| 255 | 630932A | 0 | Inlet Needle, Seat, Gasket & Spring Assy. |
| 261 | 630982 | 0 | Carburetor |