

2XC 5210 RIDING MOWER

NO. 61-401  
MOM

### SECTION V

## RIDING MOWER MODEL MOM5210A07

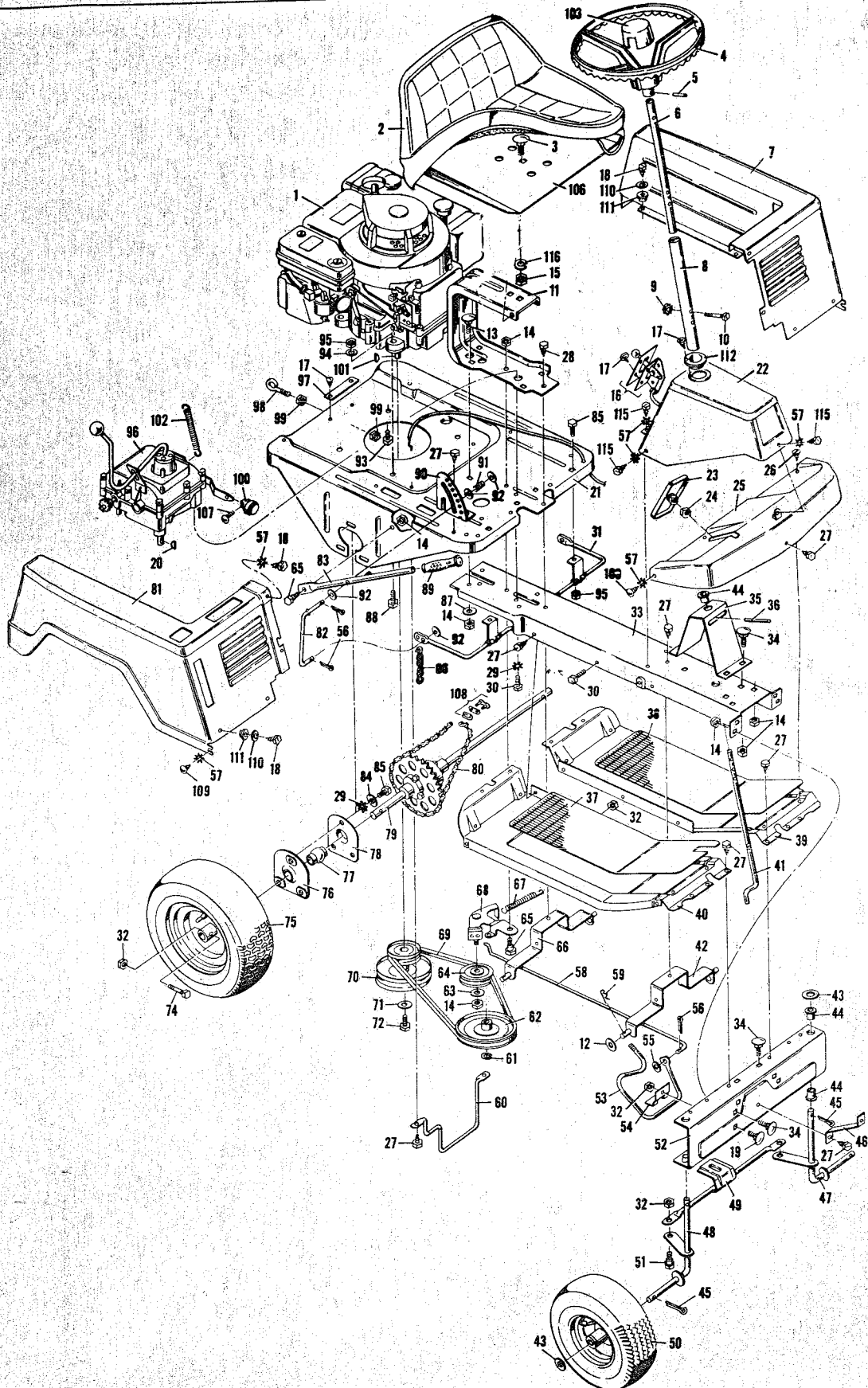

FIG. 23

NO. 61-401  
 MOM

### Section V (Continued) Riding Mower - Model MOM5210A07

When ordering repair parts, always give the following information as shown in this list:

1. The PART NUMBER
2. The PART NAME
3. The MODEL NUMBER - MOM 5210A07
4. The NAME of ITEM - Riding Mower

Do not use Ref. Number when ordering Repair Parts, always use Part Numbers.  
 Your lawn mower is right hand (R.H.) or left hand (L.H.) as you ride.

REF. NO.	PART. NO.	PART NAME	APPROX. SELL PRICE	REF. NO.	PART NO.	PART NAME	APPROX. SELL PRICE
1	20800	Engine	----	58	20669E	Brake Rod	.38
2	20722	Seat Pad	\$10.88	59	20692	Hair Pin Cotter	.20
3	2x55	Carriage Bolt 1/2-13x1	.44	60	20677E	Belt Guide	.42
4	20700	Steering Wheel	8.87	61	20698	Retainer Ring	.20
5	32x66	Spring Pin	.20	62	20614	Trans. Pulley	3.18
6	20652E	Steering Post Ass'y.	.87	63	17x53	Plain Washer	.20
7	20599	Shroud Ass'y. L. Half	5.29	64	20613	Idler Pulley	3.85
8	20656C	Sleeve Ass'y.	.70	65	20662	Shoulder Bolt	.33
9	15x66	Keys Nut 1/4-20	.25	66	20665E	RR. Hanger Brkt. Ass'y.	1.85
10	6x58	Hex Cap Screw 1/4-20-1 1/2	.20	67	20682	Spring - Drive Idler	.26
11	20630E	Seat Bracket	2.52	68	20670	Drive Idler Ass'y.	2.80
12	17x67	Plain Washer	.20	69	20716	Drive Belt	2.10
13	2x57	Carriage Bolt 3/8-16x7/8	.20	70	20626Z	Stack Pulley Ass'y.	3.12
14	15x12	Locknut 3/8-16	.20	71	10851Z	Plain Washer	.20
15	15x64	Hex Nut 1/2-13	.21	72	1x20	Hex Bolt 3/8-24-1	.20
16	20770	Remote Control Unit	2.01	74	1x75	Hex Bolt 5/16-18x1 3/4	.20
17	26x159	Self Tapping Scr. #8x3/8	.20	75	20751	RR. Wheel & Tire	24.66
18	26x184	Hex Tapping Scr. #10x5/8	.20		133x1	Tire Only	16.39
19	2x53	Carriage Bolt 5/16-18x5/8	.20		134x1	Tube W/Cap.	5.38
20	20697	Woodruff Key #9	.24		135x1	Wheel Only	11.63
21	20530E	Engine Base	10.97	76	21009Z	Outer Brg. Ret. Ass'y.	.50
22	20564E	Console Ass'y.	3.18	77	20568	Bronze Bearing	3.07
	20575E	Pedal Ass'y.	.55	78	20570Z	Retainer - Inner	.37
24	15x63	Hex Nut 7/16-14	.27	79	20685	Differential & Axle	28.49
25	20600E	Apron	2.12	80	20732	Roller Chain & Link #41	2.93
26	26x179	Tapping Scr. - Flat Hd. #10x1/2	.20	81	20792	Shroud Ass'y. - R. Half	4.29
27	26x50	Hex Tapping Scr. 5/16x5/8	.20	82	20672Z	Connector Rod	.45
28	26x51	Hex Tapping Scr. 5/16x3/4	.23	83	20658Z	Lever & Pin Ass'y.	.35
29	19x6	Sh. Pr. Washer	.20	84	17x45	Plain Washer	.20
30	1x45	Hex Bolt 5/16-18x5/8	.20	85	1x77	Hex Bolt 3/8-24x5/8	.20
31	20635Z	Lifting Rod & Hinge Ass'y.	1.64	86	20699	Chain Lifter	.21
32	15x43	Locknut 5/16-18	.23	87	17x104	Plain Washer	.20
33	20544E	Frame Channel	4.41	88	1x74	Hex Bolt 5/16-24-1 1/4	.20
34	2x56	Carriage Bolt 3/8-16x3/4	.20	89	20718	Grip	.25
35	21071	Steering Supt.	.86	90	20636E	Index Brkt.	.37
36	32x68	Spring Pin	.20	91	20680	Spring - Lifter	.20
37	20690	Mat R. H.	1.91	92	17x46	Plain Washer	.20
38	20691	Mat L. H.	1.76	93	20103	Engine Bolt 3/8-16x1	.33
	20541E	Running Brd. L. H.	3.47	94	17x47	Plain Washer	.20
	20540E	Running Brd. R. H.	3.47	95	15x42	Locknut 5/16-24	.20
41	20650Z	Lower Strg. Post	1.37	96	20843	Transmission - 3 Spd.	66.43
42	20664E	Frnt. Hanger Brkt. Ass'y.	1.79	97	94x19	Model No. Plate	.26
43	17x100	Plain Washer	.20	98	20696	Eye Bolt	.38
44	20587	Nylon Bearing	.20	99	15x33	Hex Nut 3/8-24	.20
45	30x49	Cotter Pin	.20	100	20841	Brake Lever Knob	.79
46	20639E	Apron Support	.27	101	20062	Woodruff Key #6	.25
47	20583E	Spindle & Arm Ass'y. - L. H.	1.71	102	21021	Brake Spring	.20
48	20582E	Spindle & Arm Ass'y. - R. H.	1.71	103	20704	Steering Wh'l. Cap	.47
49	20578E	Tie Bar Ass'y.	.70	106	20726	Seat Pan Ass'y.	6.90
50	20742	Frnt. Wheel & Tire	11.13	107	26x168	Self Tapping Scr. #8x1/4	.20
51	20660	Shoulder Bolt	.22	108	20730	Connecting Link - #41 Chain	.25
52	20545E	Frnt. Axle Beam	2.94	109	26x25	Truss Hd. Tap. Scr. #10x1/2	.20
	20645E	Clutch & Brake Lever	.85	110	17x106	Pl. Washer	.20
	20572	Clamp	.20	111	20720	Grommet	.20
55	17x37	Plain Washer	.20	112	21034	Nylon Bearing	.31
56	30x20	Cotter Pin	.20	115	26x185	Hex Tapping Scr. #10x3/8	.20
57	19x1	Sh. Pr. Washer	.20	116	18x27	Lock Washer	.20

Prices Shown are Approximate and Subject to Change Without Notice.

**2XC 5210 RIDING MOWER**

NO. 61-401  
MOM

**SECTION V (Continued)**  
**RIDING MOWER MODEL MOM5210A07**

When ordering repair parts, always give the following information as shown in this list:

1. The PART NUMBER
2. The PART NAME
3. The MODEL NUMBER - MOM 5210A07
4. The NAME OF ITEM - Riding Mower

Do not use Ref. Number when ordering Repair Parts, always use Part Numbers.

Your lawn mower is right hand (R.H.) or (L.H.) as you ride.

**BLADE HOUSING  
PARTS LIST**

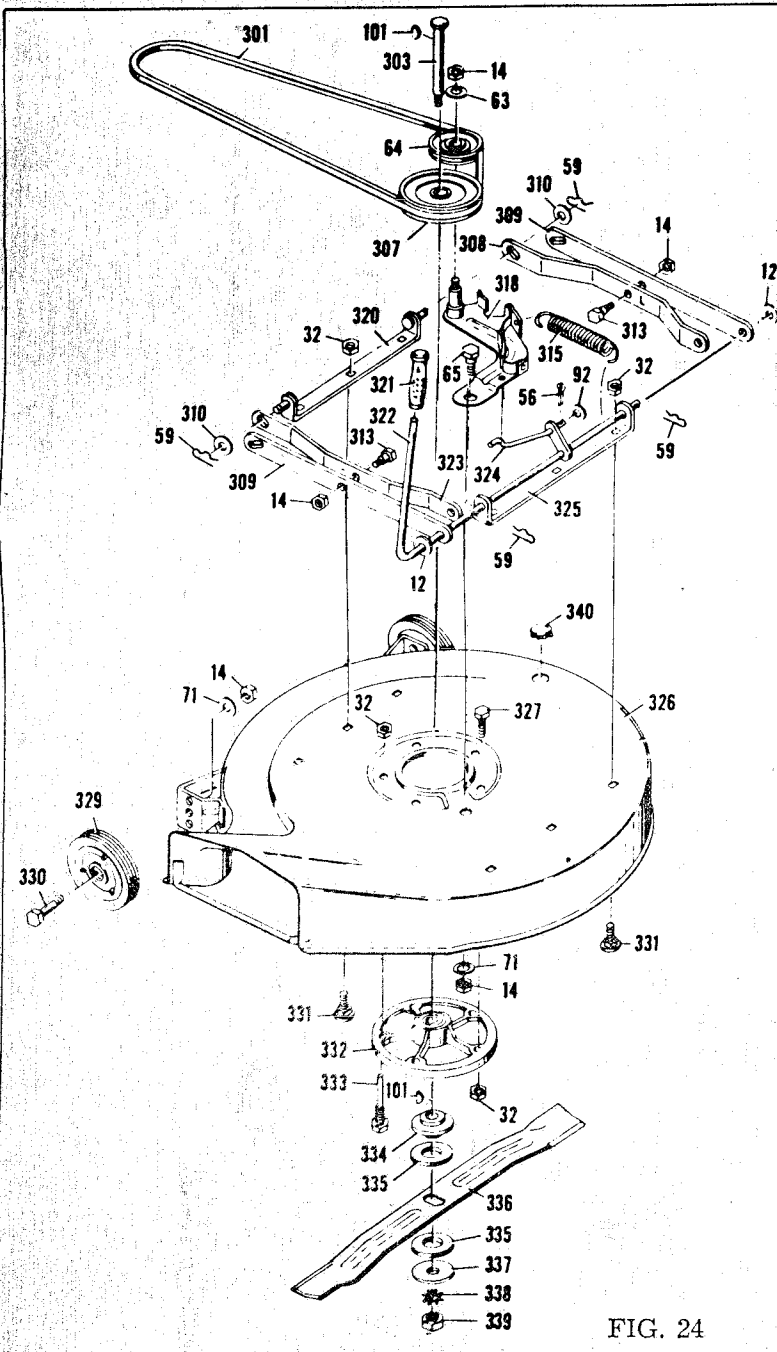

FIG. 24

REF. NO.	PART. NO.	PART NAME	APPROX. SELL PRICE
12	17x67	Plain Washer	.20
14	15x12	Locknut 3/8-16	.20
32	15x43	Locknut 5/16-18	.23
56	30x20	Cotter Pin	.20
59	20692	Hair Pin Cotter	.20
63	17x53	Plain Washer	.20
64	20613	Idler Pulley	3.85
65	20662	Shoulder Bolt	.33
71	10851	Plain Washer	.20
92	17x46	Plain Washer	.20
101	20062	Woodruff Key #6	.25
301	20717	Blade Belt	3.20
303	20616	Jack Shaft	2.58
307	20615	Jack Shaft Pulley	3.03
308	20643	Inner Arm L. H.	1.03
309	20644	Outer Arm	.88
310	17x67	Plain Washer	.20
313	20661	Shoulder Bolt	.32
315	20681	Spring	.34
318	20671	Idler Brk't. & Brake Assy.	3.11
320	20668	RR. Scissor Brk't. Assy.	1.15
321	20719	Grip -	.34
322	20676Z	Lever and Link Assy -	1.34
323	20642E	Inner Arm R. H.	1.00
324	20673Z	Rod-Blade Brake	.71
325	20666E	Fr't. Scissor Brk't.	.45
326	20559	Housing & Brk'ts. Assy.	4.20
327	1x73	Hex Bolt 5/16-18x7/8	.20
329	20629	Gauge Wheel	1.22
330	20086	Axle Bolt	.28
331	2x54	Step Bolt 5/16-18x5/8	.38
332	20551	Jackshaft Hsng. Assy.	6.90
333	20619	Guide Bolt	.22
334	20617	Blade Adapter	.65
335	20618	Blade Cushion	.25
336	20083	Blade	4.49
337	20663Z	Washer	.23
338	19x36	Sh. Pr. Washer	.20
339	15x72	Hex Nut 1/2-20	.20
340	20737	Plug Button	.20

Prices Shown are Approximate and Subject to Change Without Notice.