

**1-2251 22" Equipped
1-2253 22" Deluxe
Self-Propelled Rotary Mower**

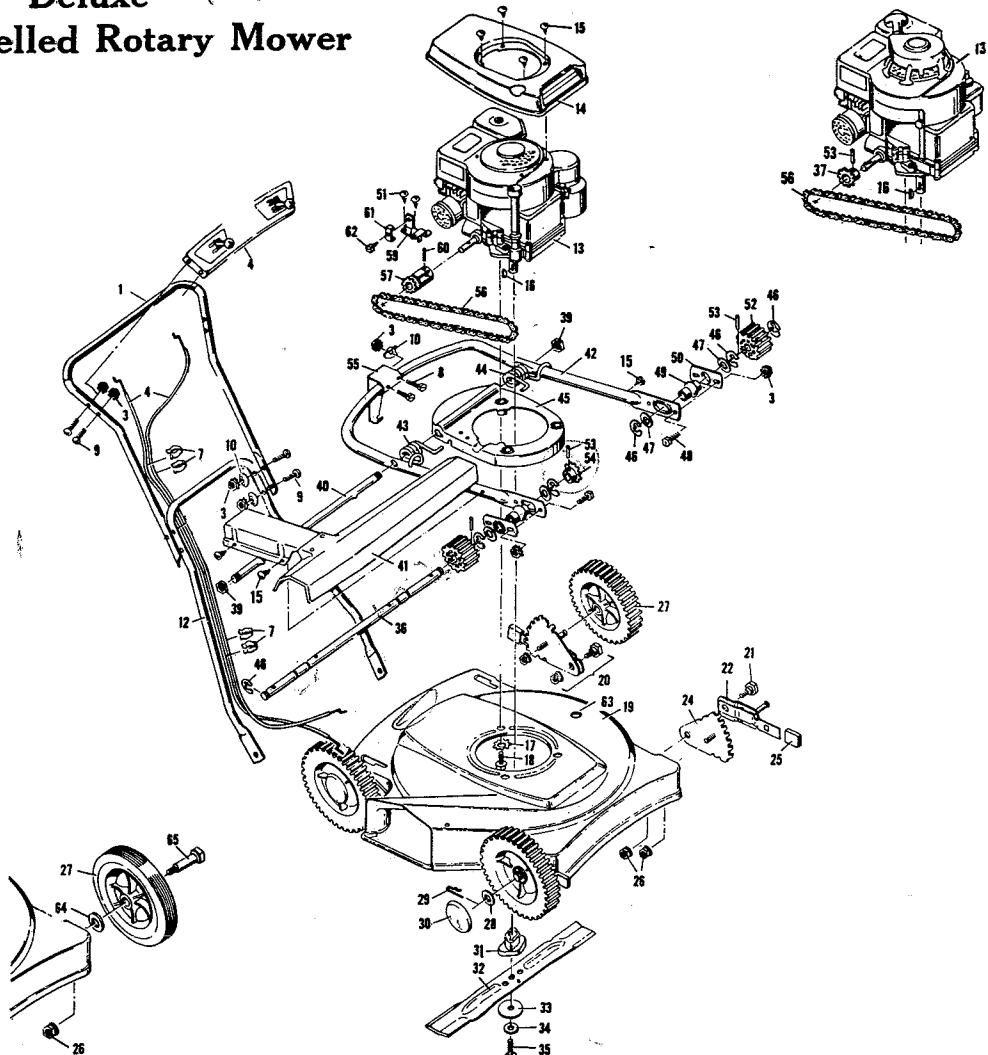

ITEM NO.	MODEL 1-2251 PART NO.	LIST PRICE EACH	MODEL NO. 1-2253 PART NO.	LIST PRICE EACH	DESCRIPTION	ITEM NO.	MODEL 1-2251 PART NO.	LIST PRICE EACH	MODEL NO. 1-2253 PART NO.	LIST PRICE EACH	DESCRIPTION
1	20248C	3.83	20246C	4.31	Upper Handle & Grip	35	.1x69	.41	1x69	.41	Adapter Bolt
3	15x66	.25	15x66	.25	Locknut (14)	36	20084	4.43	20084	4.43	Drive Shaft
4	400157	2.89	400156	4.22	Control Plate & Cable Assy.	37	20079	1.47	None	- - -	Engine Sprocket
7	20089	.26	20089	.26	Control Clamps (2 or 4)	39	15x64	.21	15x64	.21	Hex Nut (2)
8	1x71	.25	1x71	.25	Hex Bolt (2)	40	20085Z	1.16	20085Z	1.16	Pivot Shaft
9	3x136	.20	3x136	.20	Screw (8)	41	400153	3.52	400153	3.52	Pinion & Chain Guard Assy.
10	20087	.20	20087	.20	Formed Washer (6)	42	20013E	2.10	20013E	2.10	Drive Arm
12	20058C	3.42	20191C	3.84	Lower Handle	43	20067C	2.30	20067C	2.30	Torsion Spring R.H.
13	----	----	----	----	Engine - See Note*	44	20068C	2.30	20068C	2.30	Torsion Spring L.H.
14	None	----	20185C	3.98	Engine Shroud	45	20054E	2.83	20054E	2.83	Base & Spacer Assy.
15	26x159	.20	26x159	.20	Screw (7)	46	20100	.20	20100	.20	Retainer Ring (6)
16	20062	.30	20062	.30	Woodruff Key	47	17x100	.20	17x100	.20	Washer (4)
17	19x8	.20	19x8	.20	Shakeproof Washer (3)	48	1x38	.20	1x38	.20	Hex Bolt (8)
18	20102	.56	20102	.56	Engine Bolt (3)	49	20048	1.05	20048	1.05	Bearing (2)
19	20030	19.95	20030	19.95	Housing Assy.	50	20049Z	.30	20049Z	.30	Bearing Retainer (2)
20	None	----	400152	2.63	Wheel Adjuster Assy. (4)	51	None	----	26x12	.20	Screw (2)
21	None	----	20064	.35	Shoulder Bolt (4)	52	20066	1.25	20066	1.25	Drive Pinion (2)
22	None	----	20109Z	1.62	Arm, Axle & Spring Assy. (4)	53	32x64	.20	32x64	.20	Spring Pin (4 or 3)
24	None	----	20113Z	1.26	Index Plate Assy. (4)	54	20080	1.47	20080	1.47	Drive Shaft Sprocket
25	None	----	20065	.32	Lever Spring Knob (4)	55	20047	1.30	20047	1.30	Spring Latch
26	15x68	.20	15x68	.20	Flanged Locknut (4 or 8)	56	20108	1.95	20108	1.95	Chain & Link
27	20105SC	2.45	20105SC	2.45	Wheel & Tire (4)	57	None	----	20125	6.79	Clutch & Sprocket Assy.
28	None	----	17x102	.20	Washer (4)	59	None	----	20123	.50	Shifter Assy.
29	None	----	20101	.20	Hair Pin Cotter (4)	60	None	----	20128	.20	Spiral Pin
30	None	----	20090	.62	Hub Cap - (4)	61	None	----	20073	.25	Cable Clamp
31	20051	2.56	20051	2.56	Blade Adapter	62	None	----	26x181	.23	Hex Screw
32	20046	4.13	20046	4.13	Blade - 22"	63	20737	.20	20737	.20	Wash Out Plug
33	20094Z	.25	20094Z	.25	Washer	64	10851Z	.20	None	----	Washer
34	17x101	.41	17x101	.41	Cup Washer	65	20086	.28	None	----	Axle Bolt (4)

* Note: Your Engine Model, Type and Code Number is Stamped on the Blower Housing.