



Service
Note



N0203015

2002-05

Effectuated Models:

All 2002 Walk-Behind Hydro Units with ETS (Easy Touch System) Handles.

Subject:

Improving Operation and Handling.

Information:

To improve handling, slow down ground speed, and to make this unit less aggressive "off the line," hydro drive Husqvarna walk behind mowers with ETS handles can be easily modified. Instructions, and a drill template, are attached for this modification.

Important: *The drill template can be used for both the Right Paddle Weldment, P/N 539105824, and the Left Tab Weldment, P/N 539105880, and MUST be used as it is printed from its "Microsoft Publisher" document. If it is photocopied, or placed in any other format, its size may change. Otherwise, new weldments under the above part numbers should be ordered.*

There has also been a change in the pump arms which further enhance ease of operation. New pump arms can be ordered that have an additional spring slot that will reduce the amount of hand tension on the control padels. *(will also reduce top speed from 7mph to 6mph)*

Parts:

539105913 - Pump Arm (2)

Warranty:

Because this is an improvement only for those ETS hydro walk-behind mowers where unit aggressiveness is a concern, warranty will not apply.

Instructions for Improving Handling of Walk Hydro ETS

Several owners of new ETS handle walk hydro mowers have requested a change to lower the top speed and make the handling of the mower smoother. These instructions and template will assist you in making this change. The original setup can still be used if desired.

1. Move the mower to a level surface, shut off the mower and remove the key. Disconnect the drive linkages where they connect the levers underneath the handle console, and leave them connected to the pump arms on the rear deck.
2. Cut out the template on page 3, and using a sharp scribe, mark the location for the new hole on the Left Tab Weldment and on RH Paddle Weldment (see the illustration below). Be as accurate as possible so linkage readjustment will be minimal.
3. Center punch the new location deep enough to assist you in keeping the drill bit in the location you marked.
4. Drill the parts, using the center punch mark, with a 1/8" diameter drill bit. The smaller bit will better follow your mark.
5. To complete the drilling, drill open the smaller hole with a .391 (25/64") diameter drill bit. This will allow proper clearance for the 3/8" rod.
6. File off or deburr the sharp edges of the new holes so the linkages pivot smoothly.
7. Place the linkages into the newly drilled holes and replace the cotter pins.
8. **IMPORTANT! You must raise the rear tires off the ground and readjust the neutral setting of the pumps before operating!**
9. Raise the rear tires off the ground, place the mower frame of jackstands, and start the mower. Allow the mower to run a few minutes to warm the oil.
10. Engage the neutral bail and observe the rear tires to see if they are creeping. If a wheel is creeping, adjust the nuts on the lower end of the drive lever up or down until that wheel stops turning.

IMPORTANT: Any time you switch linkage/hole locations; you must check neutral adjustments by following steps 8 thru 10 above. Save this instruction sheet with the unit Operator's Manual for possible future use.

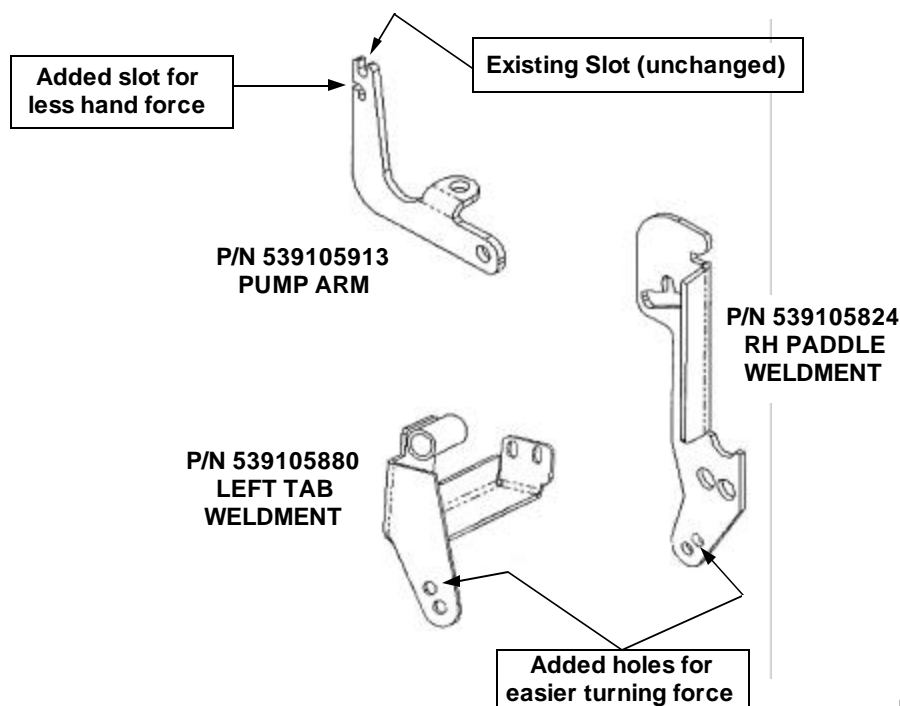

DRILL TEMPLATE

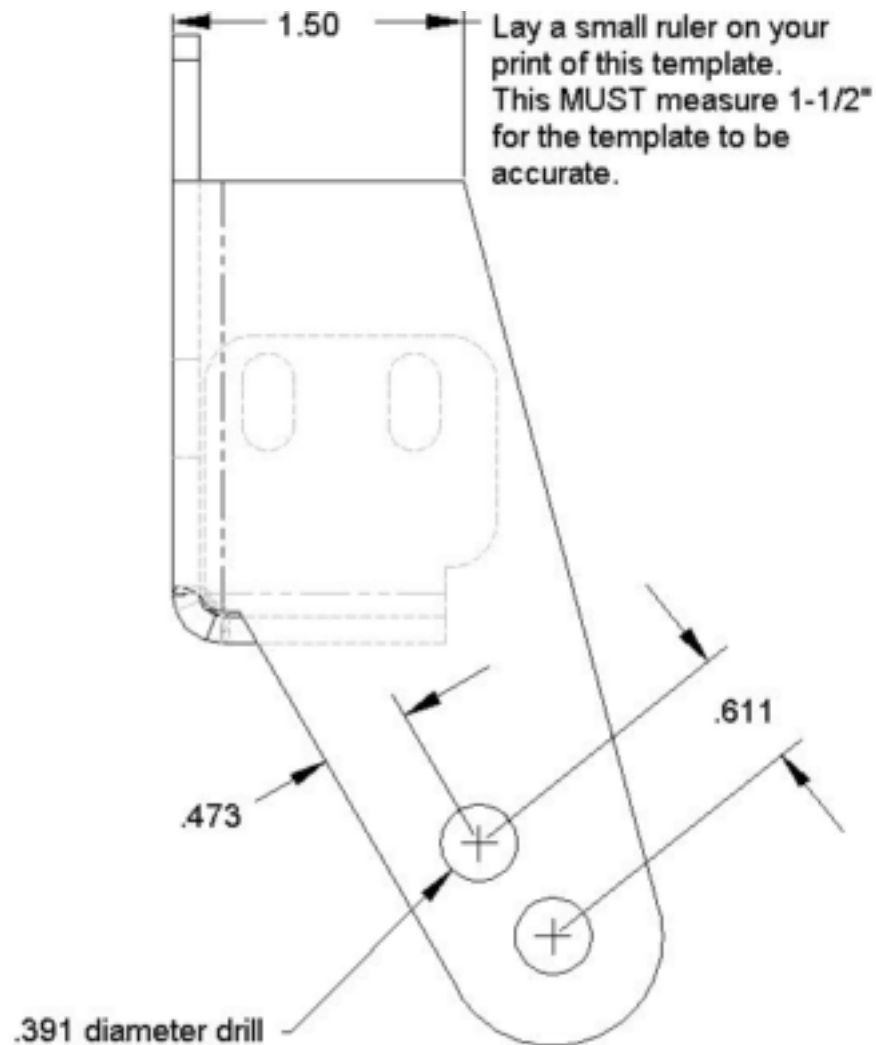

This artwork can be placed on a copy machine and size adjusted until the 1-1/2 inch width dimension above can be attained.