





SERVICE 		9
		X 89.115-26

INFORMATION FOR CHAIN BRAKE COMPL. REF. NO. 503 57 28-01 FOR THE MODELS 61, 66, 266 AND 268 WITH STANDARD FRONT HANDLE

NOTE!

This bulletin is only valid for chain saws equipped with silencer with a so called spark arrestor and with serial number lower than 9220001.

WARNING!

This chain brake should not be used on chain saws equipped with silencer with a so called spark arrestor and with serial number lower than 9220001 without first exchanging the following parts:

1. Silencer

Models 162, 266: Mount silencer Ref. No. 503 59 03-01 or 503 59 03-02.
 Models 61, 66: Mount silencer Ref. No. 503 59 03-02.

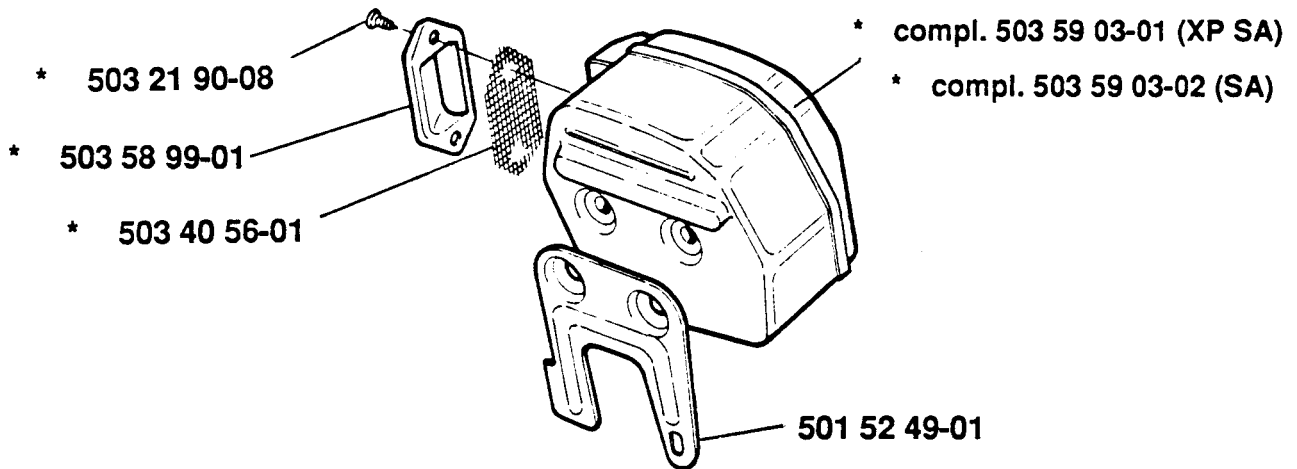

Model 268: Mount silencer Ref. No. 503 59 92-01 or 503 59 92-02.

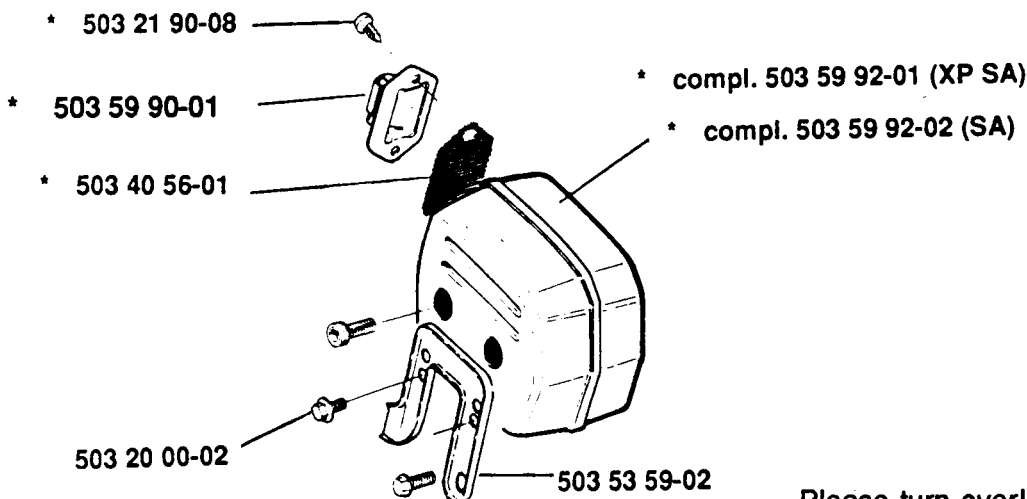

Please turn over!

2. Spike

- a) Mount the inner spike Ref. No. 503 59 08-01 or a flat bumper Ref. No. 503 44 57-01.

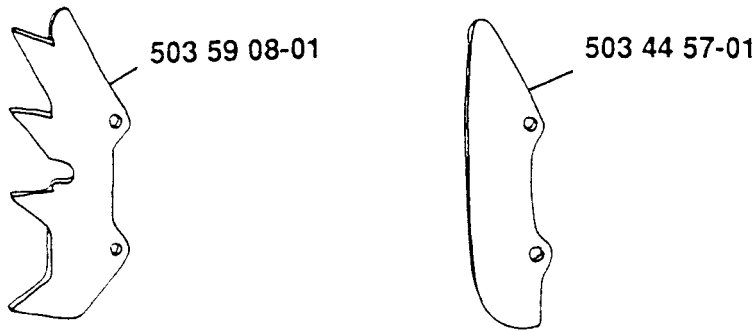

- b) Mount the outer spike Ref. No. 503 59 07-01 or a flat bumper Ref. No. 503 59 09-01 on the chain brake cover.

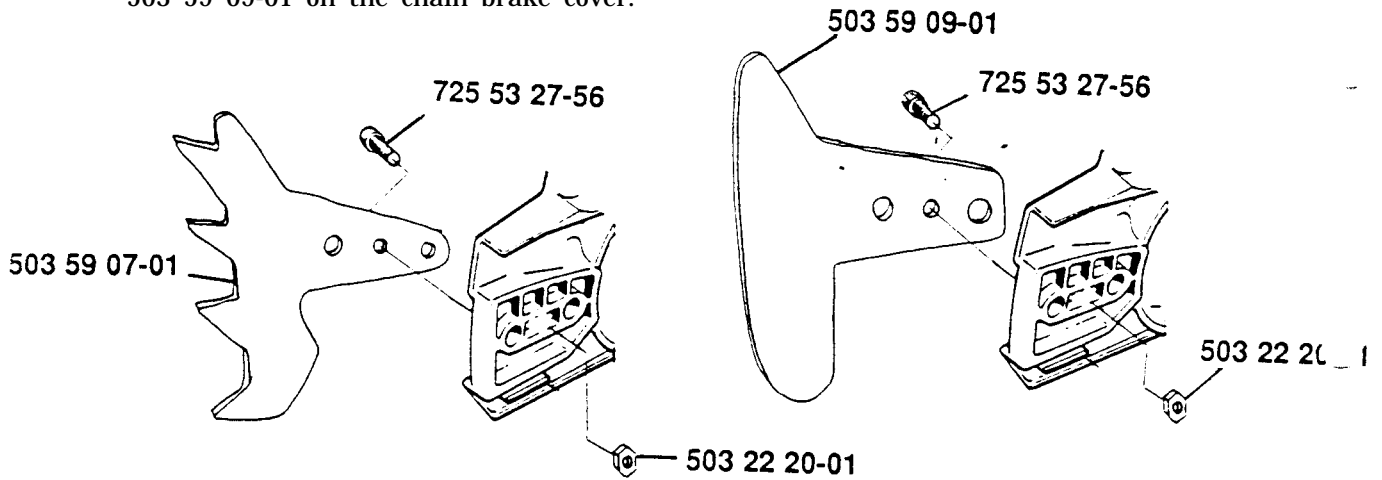

NOTE! Both inner and outer spike must be mounted.

The above mentioned steps must be followed or the chainsaw can cause forest fire.
Besides the hand guard of the chainbrake will be destroyed.