



**Service
Bulletin**

**B0103006
2001-10**

Subject: "Generation One" Rubber Hose Kit / Steel Line Replacement (Hydraulic Pump to Wheel Motor)

Effected Model Numbers:

All serial numbers of the following large frame "**Generation One**" mowers

968999153 - ZTH5222 968999154 - ZTH5225 968999155 - ZTH6125

Service Information:

If premature failure occurs with one or more of the steel lines between the hydraulic pumps and wheel motors on applicable "Gen One" units shown above, repairs should be made using the new rubber hose(s). These new hoses are available separately, or as a complete repair kit from Husqvarna. The repair kit includes all four (4) new hoses for the steel line/rubber hose exchange.

Instruction procedures for replacing failed steel line(s) with the new rubber hoses are attached to this bulletin.

Parts Information:

539106559 Rubber Hydraulic Hose Kit (includes all 4 hoses & instruction sheet)

Individual hoses are also available:

539106516 Hose #1 (11.625" Length)

539106517 Hose #2 (12.5" Length)

539106518 Hose #3 (13.625" Length)

539106519 Hose #4 (11.062" Length)



Large Frame 52" / 61" (Generation One) Mowers

539106559 Rubber Hydraulic Hose Kit Instructions (Hydraulic Pumps to Side Port Wheel Motors)

CAUTION: Raise the rear of the mower and place it on suitable jack stands. Remove both rear tires/wheels. Completely pressure wash and clean the wheel motor, hydraulic pump areas, before removing lines or replacing hoses. Any dirt or debris that gets into the hydraulic system will cause major hydraulic component damage.

Procedure for replacing steel lines with rubber hoses:

Starting on the right side, remove both steel lines from the right hydraulic pump to the right wheel motor. Any existing O-rings can be reused with the new hoses.

Loosen the 1" locknuts on the 90 degree fittings in the wheel motor side ports and turn the fitting to point toward the hydraulic pump, approximately 45 degrees to the motor. Do not tighten the fitting locknuts.

NOTE: All four hoses are unique, see next page for hose part numbers and lengths.

Install #2 hose first as shown, from the inward port on the pump, to the forward 90 degree fitting on the wheel motor. Tighten the fitting *on the pump* so the hose is in light contact with the frame.

Install #1 hose as shown, from the outward port on the pump, to the rearward 90 degree fitting on the wheel motor. This hose must cross over the #2 hose.

Tighten both hoses, and tighten the 1" locknuts on the wheel motor 90 degree fittings. The steel ends of the hoses should not be touching each other.

NOTE: Proceed to next page for instructions for the left side of the mower.

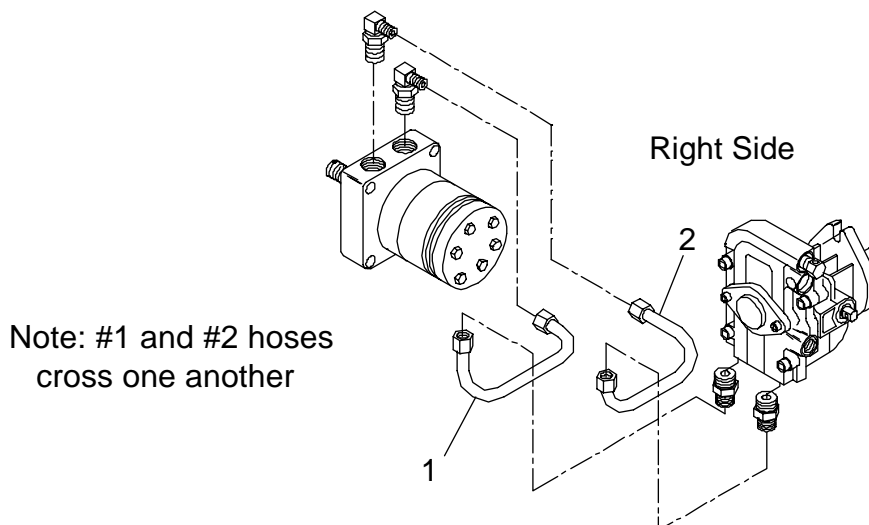

Large Frame 52" / 61" (Generation One) Mowers

539106559 Rubber Hydraulic Hose Kit Instructions (Hydraulic Pumps to Side Port Wheel Motors)

(Continued from previous page)

Remove both steel lines from the left hydraulic pump to the left wheel motor. Any existing O-rings can be reused with the new hoses.

Loosen the 1" locknuts on the 90 degree fittings in the wheel motor side ports and turn the fitting to point toward the hydraulic pump, approximately 45 degrees to the motor. Do not tighten the fitting locknuts.

Install #3 hose as shown, from the inward port on the pump, to the rearward 90 degree fitting on the wheel motor. Tighten the fitting on the pump so the hose is in light contact with the frame.

Install #4 hose as shown, from the outward port on the pump, to the forward 90 degree fitting on the wheel motor. These hoses lay side by side, and should not contact each other.

Tighten both hoses, and tighten the 1" locknuts on the wheel motor 90 degree fittings.

IMPORTANT: Double check and make sure all hydraulic pump and wheel motor hoses and fittings are tight. Air injected through loose fittings can cause serious damage to the hydraulic pumps.

Reinstall both drive tires/wheels. **DO NOT** remove the mower from the jack stands. The hydraulic system must be purged of air before putting the mower back in operation.

IMPORTANT: Follow all air purging instructions found on Husqvarna Service Bulletin Number B0103002.

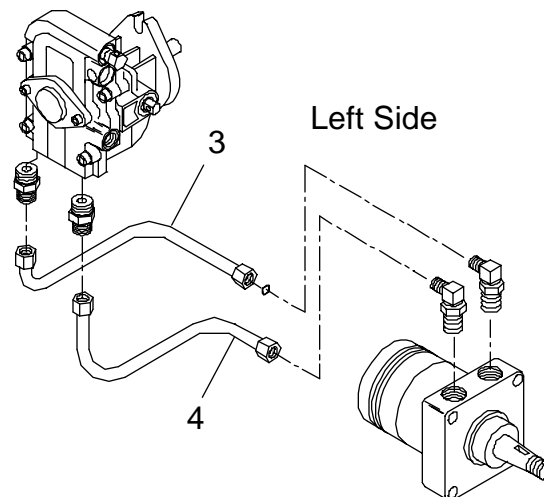

Complete Hose Kit

539106559 - All Four Hoses

Individual Hoses

539106516 - Hose #1 (11.625" Length)

539106517 - Hose #2 (12.5" Length)

539106518 - Hose #3 (13.625" Length)

539106519 - Hose #4 (11.062" Length)